

UNITED STATES
DEPARTMENT OF THE INTERIOR
BUREAU OF LAND MANAGEMENT

30-045-29048

APPLICATION FOR PERMIT TO DRILL, DEEPEN, OR PLUG BACK

1a. TYPE OF WORK

DRILL ☒

DEEPEN ☐

PLUG BACK ☐

b. TYPE OF WELL

OIL
WELL ☐

GAS
WELL ☒

OTHER

SINGLE
ZONE ☒

MULTIPLE
ZONE ☐

2. NAME OF OPERATOR

SG INTERESTS I LTD/MARALEX RESOURCES, INC. (303) 563-4000

3. ADDRESS OF OPERATOR

PO BOX 338, IGNACIO, COLORADO 81137

4. LOCATION OF WELL (Report location clearly and in accordance with any State requirements.)

At surface
1083' FNL, 805' FEL Sec 28-T31N-R10W
At proposed prod. zone
Same

14. DISTANCE IN MILES AND DIRECTION FROM NEAREST TOWN OR POST OFFICE*

Approx. 9 miles northeast of Aztec, NM

15. DISTANCE FROM PROPOSED*

LOCATION TO NEAREST
PROPERTY OR LEASE LINE, FT.
(Also to nearest drilg. unit line, if any)

1083'

16. NO. OF ACRES IN LEASE

1760.0

18. DISTANCE FROM PROPOSED LOCATION*

TO NEAREST WELL, DRILLING, COMPLETED,
OR APPLIED FOR, ON THIS LEASE, FT.

19. PROPOSED DEPTH

2990'

21. ELEVATIONS (Show whether DF, RL, GR, etc.)

6108' GL

This action is subject to BLM approval
and approval of the State of New Mexico
and approval of the State of New Mexico

17. NO. OF ACRES ASSIGNED
TO THIS WELL

320 315.14

20. ROTARY OR CABLE TOOLS

Rotary

22. APPROX. DATE WORK WILL START*

Upon BLM Approval

23. PROPOSED CASING AND CEMENTING PROGRAM

DRILLING OPERATIONS ARE
SUBJECT TO COMPLETION WITH ATTACHED
GENERAL CEMENTING PROGRAM

SIZE OF HOLE	SIZE OF CASING	WEIGHT PER FOOT	SETTING DEPTH	
12-1/4"	8-5/8"	23#	300'	200 sx Class B plus 2% CaCl ₂
7-7/8"	5-1/2"	15.5#	1990'	4665X CLASS "B"

Maralex Resources, Inc. proposes to drill a vertical well to develop the Fruitland Coal Formation at the above described site in accordance with the attached drilling and surface use programs.

An archaeological survey will be conducted to determine any potential sites.

All of the access road for this well is located on this lease, so no right-of-way application is required.

RECEIVED
DEC 23 1993
OIL CON. DIV.
DIST. 2

IN ABOVE SPACE DESCRIBE PROPOSED PROGRAM: If proposal is to deepen or plug back, give pertinent data on subsurface locations and measured and true vertical depths. Give blowout preventer program, if any.

24.

SIGNED

A.M. O'Hare / Dr. Dr.

TITLE President, Maralex Resources DATE December 6, 1993

A.M. O'Hare

(This space for Federal or State office use)

PERMIT NO.

APPROVAL DATE

APPROVED
AS AMENDED

APPROVED BY
CONDITIONS OF APPROVAL, IF ANY:

TITLE

NMOC

DEC 21 1993

DISTRICT MANAGER

*See Instructions On Reverse Side

RECEIVED
JAN 19 1961
U.S. AIR FORCE
OFFICE OF THE
JOINT CHIEFS OF STAFF
WASHINGTON, D.C.

Submit to Appropriate
District Office
State Lease - 4 copies
Fee Lease - 3 copies

DISTRICT I
P.O. Box 1930, Hobbs, NM 88240

DISTRICT II
P.O. Drawer DD, Artesia, NM 88210

DISTRICT III
1000 Rio Brazos Rd., Aztec, NM 87410

State of New Mexico
Energy, Minerals and Natural Resources Department

OIL CONSERVATION DIVISION
P.O. Box 2088
Santa Fe, New Mexico 87504-2088

Form C-102
Revised 1-1-89

88-050-7 AM 7:35
070 P.M. 12/31/93

WELL LOCATION AND ACREAGE DEDICATION PLAT

All Distances must be from the outer boundaries of the section

Operator <i>SG Int'l Ltd</i> MARLEX RESOURCES		Lease HART CANYON 28		Well No. 28-1
Unit Letter A	Section 28	Township 31 N.	Range R. 10 W.	County SAN JUAN
Actual Footage Location of Well: 1083 feet from the NORTH line and 805 feet from the EAST line				
Ground level Elev. 6108	Producing Formation Fruitland	Pool Basin Fruitland Coal	Dedicated Acreage: 320 3/5 Acres	

- Outline the acreage dedicated to the subject well by colored pencil or hatchure marks on the plat below.
- If more than one lease is dedicated to the well, outline each and identify the ownership thereof (both as to working interest and royalty).
- If more than one lease of different ownership is dedicated to the well, have the interest of all owners been consolidated by communization, unitization, force-pooling, etc?
☐ Yes ☐ No If answer is "yes" type of consolidation _____
If answer is "no" list the owners and tract descriptions which have actually been consolidated. (Use reverse side of this form if necessary).
No allowable will be assigned to the well until all interests have been consolidated (by communization, unitization, forced-pooling, or otherwise) or until a non-standard unit, eliminating such interest, has been approved by the Division.

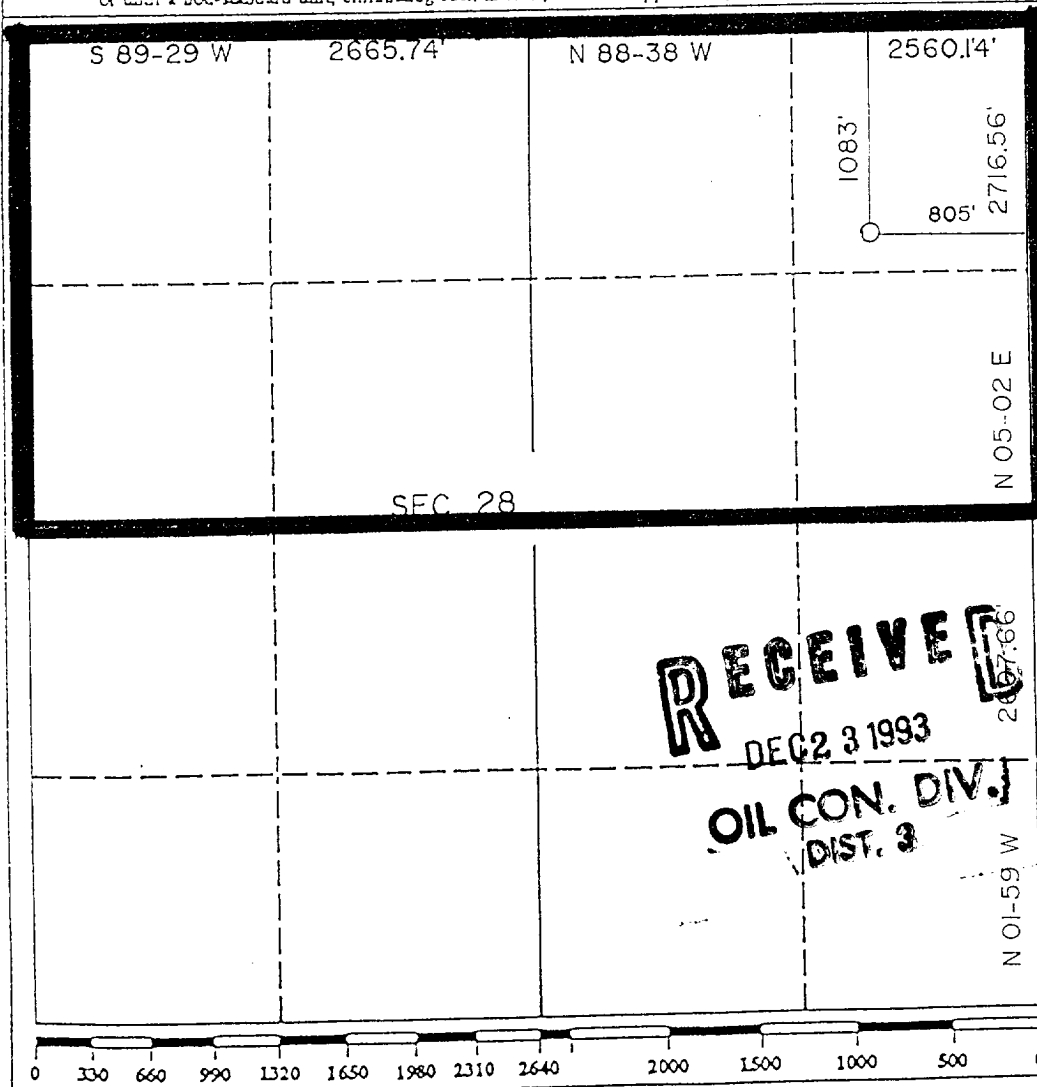

OPERATOR CERTIFICATION

I hereby certify that the information contained herein is true and complete to the best of my knowledge and belief.

Signature
A.M. O'Hare / Over
Printed Name
A. M. O'Hare
Position
President
Company
Maralex Resources, Inc.
Date
December 6, 1993

SURVEYOR CERTIFICATION

I hereby certify that the well location shown on this plat was plotted from field notes of actual surveys made by me or under my supervision, and that the same is true and correct to the best of my knowledge and belief.

Date Surveyed
11/30/1993
Signature & Seal of Professional Surveyor
ROY A. RUSH
Certificate No.
8804

RECEIVED
DEC 23 1993
OIL CON. DIV.
DIST. 3

NEW MEXICO-SAN JUAN CO.
7.5 MINUTE SERIES (TOPOGRAPHIC)

