

UNITED STATES
DEPARTMENT OF THE INTERIOR

BUREAU OF LAND MANAGEMENT

APPLICATION FOR PERMIT TO DRILL OR DEEPEN

Form approved.
Budget Bureau No. 1004-0136
Expires: December 31, 1991

1a. TYPE OF WORK b. TYPE OF WELL OIL WELL <input type="checkbox"/> GAS WELL <input checked="" type="checkbox"/> OTHER <input type="checkbox"/> SINGLE ZONE <input checked="" type="checkbox"/> MULTIPLE ZONE <input type="checkbox"/>		2. NAME OF OPERATOR Amoco Production Company 778 ✓ Attention: Patty Haebele		3. ADDRESS AND TELEPHONE NO. P.O. Box 800, Denver, Colorado 80201 (303) 830-4988	
4. LOCATION OF WELL (Report location clearly and in accordance with any State requirements.) At surface 625' FNL 2620' FEL Unit B At proposed prod. zone		5. LEASE DESIGNATION AND SERIAL NO. 14-20-604-62		6. IF INDIAN, ALLOTTEE OR TRIBE NAME Ute Mountain Utes	
7. UNIT AGREEMENT NAME		8. FARM OR LEASE NAME, WELL NO. Ute Indians A 28 ✓ 1183		9. API WELL NO. 30-045-29416 ✓	
10. FIELD AND POOL, OR WILDCAT Ute Dome Dakota 86720 ✓		11. SEC., T., R., M., OR BLK. AND SURVEY OR AREA Section 1 Township 31N Range 14W ✓		12. COUNTY OR PARISH San Juan ✓	
13. STATE New Mexico		14. DISTANCE IN MILES AND DIRECTION FROM NEAREST TOWN OR POST OFFICE 30 miles from Farmington, New Mexico		15. DISTANCE FROM PROPOSED LOCATION TO NEAREST PROPERTY OR LEASE LINE, FT. (Also to nearest drlg. unit line, if any)	
16. NO. OF ACRES IN LEASE 4200		17. NO. OF ACRES ASSIGNED TO THIS WELL 180 184.93 ✓		18. DISTANCE FROM PROPOSED LOCATION TO NEAREST WELL, DRILLING, COMPLETED, OR APPLIED FOR, ON THIS LEASE, FT. 2714'	
19. PROPOSED DEPTH		20. ROTARY OR CABLE TOOLS Rotary		21. APPROX. DATE WORK WILL START 09-01-96	
22. ELEVATIONS (Show whether DF, RT, GR., etc.) 6114' ✓		23. PROPOSED CASING AND CEMENTING PROGRAM		24.	

SIZE OF HOLE	GRADE, SIZE OF CASING	WEIGHT PER FOOT	SETTING DEPTH	QUANTITY OF CEMENT
8.75"	7.000" J-55	20#	350'	110 cu.ft. Std. cement, circ to surface
6.25"	4.500" J-55	11.8#	2714'	310 cu.ft 50/50 std cmt, tail w/ 86 cu.ft., circ to surface

Notice of Staking submitted on 7/16/96 as the Ute Indians A #26.

Lease Description:

T31N R14W: Sec 2: all, Sec 3: E/2, Sec 10: N/ENE/4, Sec 11: NW/4NW/4

T32N R14W: Sec 25: SW/4 NE/4 & S/2 NW/4 & NW/4 NW/4 & SW/4 & W/2 SE/4

Sec 26: all, Sec 27: SE/4, Sec 34: all, Sec 35: all, Sec 36: all

Approval of this agreement does not warrant or certify that the operator thereof and other holders of operating rights hold legal or equitable title to those rights in the subject lease which are committed hereto...

Venting / Flaring approved for 30 days per NTL-4A

SEE ATTACHED
CONDITIONS OF APPROVAL

IN ABOVE SPACE DESCRIBE PROPOSED PROGRAM: If proposal is to deepen, give data on present productive zone and proposed new productive zone. If proposal is to drill or deepen directionally, give pertinent data on subsurface locations and measured and true vertical depths. Give blowout preventer program, if any.

24.

SIGNED Patty Haebele TITLE Staff Assistant DATE 8/15/96

(This space for Federal or State office use)

PERMIT NO. _____ APPROVAL DATE _____

Application approval does not warrant or certify that the applicant holds legal or equitable title to those rights in the subject lease which would entitle the applicant to conduct operations thereon.

CONDITIONS OF APPROVAL, IF ANY:

APPROVED BY Ann Jovato TITLE Area Manager DATE 10-23-96

*See Instructions On Reverse Side

Title 18 U.S.C. Section 1001, makes it a crime for any person knowingly and willfully to make to any department or agency of the United States any false, fictitious or fraudulent statements or representations as to any matter within its jurisdiction.

☐ AMENDED REPORT

OIL CONSERVATION DIVISION
PO Box 2088
Santa Fe, NM 87504-2088

WELL LOCATION AND ACREAGE DEDICATION PLAT

' API Number	' Pool Code	' Pool Name
30-045-29416	86720	Ute Dome Dakota
' Property Code	' Property Name	' Well Number
1183	UTE INDIANS A	# 26
' OGRID No.	' Operator Name	' Elevation
000778	AMOCO PRODUCTION COMPANY	6114

¹⁰ Surface Location

UL or lot no. Lot 2	Section 1	Township 31 N	Range 14 W	Lot Idn	Feet from the 625	North/South line NORTH	Feet from the 2620	East/West line EAST	County SAN JUAN
------------------------	--------------	------------------	---------------	---------	----------------------	---------------------------	-----------------------	------------------------	--------------------

" Bottom Hole Location If Different From Surface

UL or lot no.	Section	Township	Range	Lot Idn	Feet from the	North/South line	Feet from the	East/West line	County
" Dedicated Acres		" Joint or Infill		" Consolidation Code		" Order No.			
160,84.93									

NO ALLOWABLE WILL BE ASSIGNED TO THIS COMPLETION UNTIL ALL INTERESTS HAVE BEEN CONSOLIDATED
OR A NON-STANDARD UNIT HAS BEEN APPROVED BY THE DIVISION

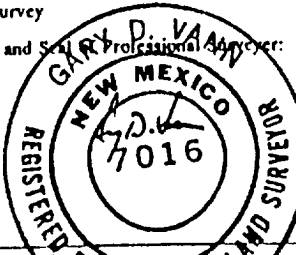
16	(3073'±)	1320' 1320' 1320'	1740.42' 2620'
<div style="display: flex; justify-content: space-around; align-items: center;"> <div style="text-align: center;">  625 </div> <div style="text-align: center;"> 1 </div> </div>			
<div style="display: flex; justify-content: space-between;"> <div style="width: 60%;"> <p style="font-size: 1.2em; margin: 0;">16</p> <p style="margin: 0;">(3073'±)</p> <p style="margin: 0;">1320'</p> <p style="margin: 0;">1320'</p> <p style="margin: 0;">1320'</p> <p style="margin: 0;">1740.42'</p> <p style="margin: 0;">2620'</p> </div> <div style="width: 35%; border-left: 1px solid black; padding-left: 10px;"> <p style="margin: 0;">17 OPERATOR CERTIFICATION</p> <p style="margin: 5px 0;">I hereby certify that the information contained herein is true and complete to the best of my knowledge and belief.</p> <div style="margin-top: 10px;"> <p style="margin: 0;"><i>Patty Haefele</i></p> <p style="margin: 0;">Signature</p> <p style="margin: 0;">Patty Haefele</p> <p style="margin: 0;">Printed Name</p> <p style="margin: 0;">Staff Assistant</p> <p style="margin: 0;">Title</p> <p style="margin: 0;">8/7/96</p> <p style="margin: 0;">Date</p> </div> </div> </div>			
<div style="display: flex; justify-content: space-between;"> <div style="width: 60%;"> <p style="font-size: 1.2em; margin: 0;">17</p> <p style="margin: 0;">1320'</p> <p style="margin: 0;">1320'</p> <p style="margin: 0;">1320'</p> <p style="margin: 0;">1740.42'</p> <p style="margin: 0;">2620'</p> </div> <div style="width: 35%; border-left: 1px solid black; padding-left: 10px;"> <p style="margin: 0;">18 SURVEYOR CERTIFICATION</p> <p style="margin: 5px 0;">I hereby certify that the well location shown on this plat was plotted from field notes of actual surveys made by me or under my supervision, and that the same is true and correct to the best of my belief.</p> <p style="margin: 0; text-align: center; font-size: 1.1em;">August 1, 1996</p> <p style="margin: 0;">Date of Survey</p> <p style="margin: 0;">Signature and Seal of Professional Surveyor:</p> <div style="margin-top: 10px; text-align: center;">  </div> <p style="margin: 0;">7016</p> <p style="margin: 0;">Certificate Number</p> </div> </div>			

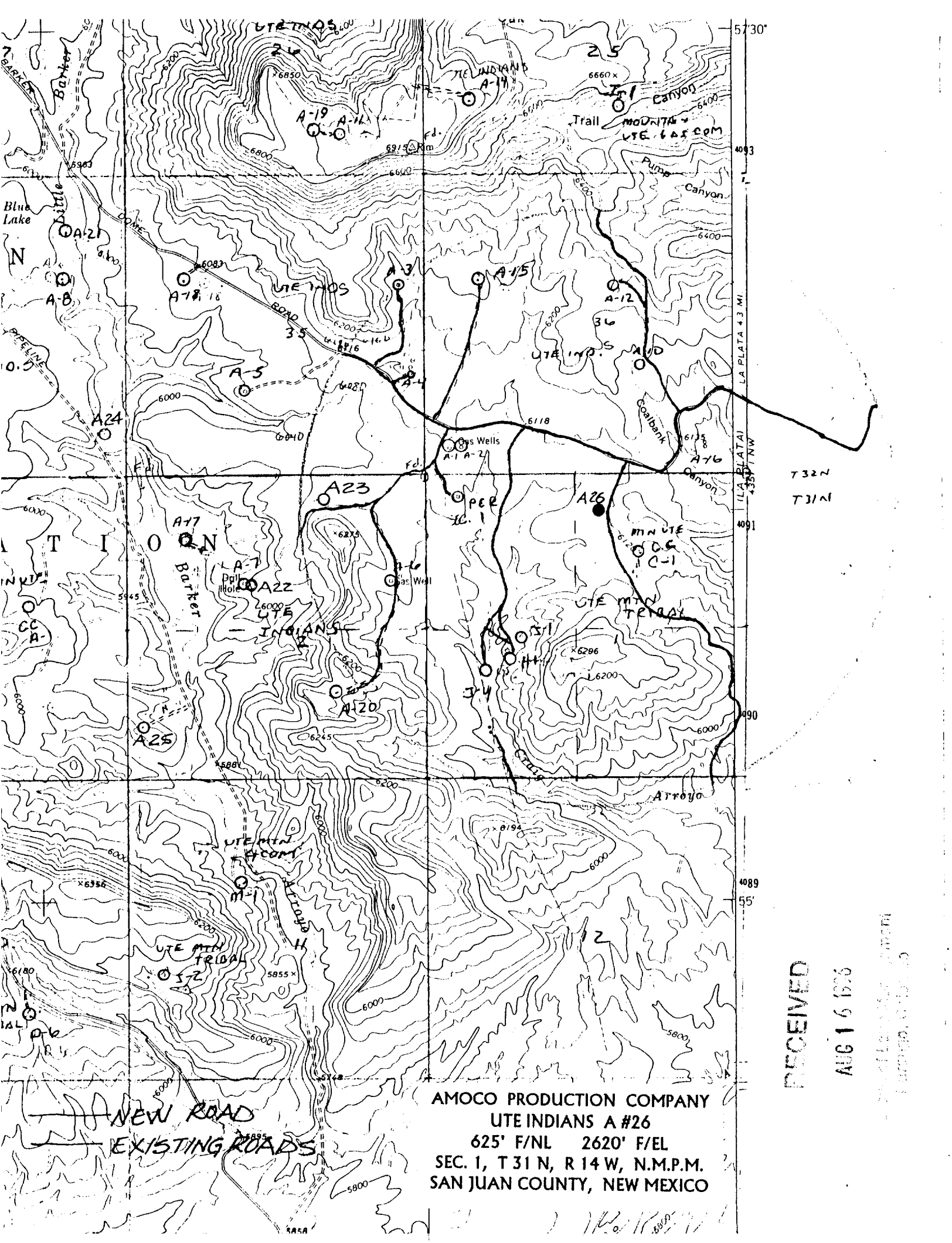

AMOCO PRODUCTION COMPANY
UTE INDIANS A #26
625' F/NL 2620' F/EL
SEC. 1, T 31 N, R 14 W, N.M.P.M.
SAN JUAN COUNTY, NEW MEXICO

RECEIVED

AUG 16 1976

