



NEW MEXICO ENERGY, MINERALS
& NATURAL RESOURCES DEPARTMENT

OIL CONSERVATION DIVISION
2040 South Pacheco Street
Santa Fe, New Mexico 87505
(505) 827-7131

Burlington Resources Oil & Gas Company
P. O. Box 4289
Farmington, New Mexico 87499-4289
Attention: Peggy Bradfield

July 21 1998
RECEIVED
JUL 29 1998
OIL CON. DIV.
DIST. 3

47
8-32N-6W

Administrative Order NSL-4103

Dear Ms. Bradfield:

Reference is made to your application dated July 20, 1998 for an exception to the well location requirements provided within the "Special Rules and Regulations for the Blanco-Mesaverde Pool/Special Rules and Regulations for the Basin-Dakota Pool," as promulgated by Division Order No. R-10987, for Burlington Resources Oil & Gas Company's ("Burlington") proposed Allison Unit Well No. 47 (API No. 30-045-29526) to be drilled at an unorthodox gas well location in both the Blanco-Mesaverde and Basin-Dakota Pools 600 feet from the South line and 790 feet from the West line (Unit M) of Section 8, Township 32 North, Range 6 West, NMPM, San Juan County, New Mexico.

Gas production attributed to the well from both pools is to be dedicated to the previously authorized 320-acre non-standard gas spacing and proration units, both of which comprise the following described area:

San Juan County, New Mexico
TOWNSHIP 32 NORTH, RANGE 6 WEST, NMPM
Section 8: SW/4 NE/4, SE/4 NW/4, SW/4, and W/2 SE/4.

By Division Order No. R-11003, issued in Case No. 11989 dated July 13, 1998, this 320-acre unit was approved for gas production from the Blanco-Mesaverde Pool. By Division Order No. R-2046, issued in Case No. 2327 dated August 14, 1961, as amended by Division Order No. R-2046-A, issued in Case No. 7479 dated March 2, 1982, the same acreage was designated a non-standard gas spacing and proration unit for Basin-Dakota Pool gas production.

The application has been duly filed under the provisions of Rules 104.F and 605.B of the Rules and Regulations of the New Mexico Oil Conservation Division ("Division").

By the authority granted me under the provisions of Division Rule 104.F(2), the above-described unorthodox Basin-Dakota/Blanco-Mesaverde gas well location for the Allison Unit Well No. 47 is hereby approved. This well and both previously authorized non-standard spacing units will be subject to all existing rules, regulations, policies, and procedures applicable to prorated gas pools in Northwest, New Mexico.

Sincerely,

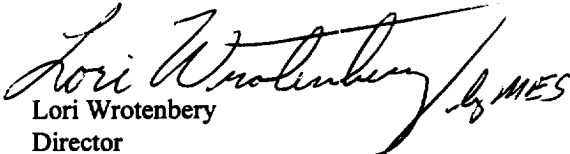
Lori Wrotenbery
Director

LW/MES/kv

cc: New Mexico Oil Conservation Division - Aztec
U. S. Bureau of Land Management - Farmington
File: Case No. 11989

BURLINGTON RESOURCES

SAN JUAN DIVISION

July 20, 1998

Sent Federal Express

Ms. Lori Wrotenbery, Director
New Mexico Oil Conservation Division
2040 South Pacheco
Santa Fe, New Mexico 87505

RECEIVED
JUL 21 1998
OIL CON. DIV.
DIST. 3

Re: Allison Unit #47
600'FSL, 790'FWL, Section 8, T-32-N, R-6-W, San Juan County, New Mexico
30-045-29526

Dear Ms. Wrotenbery:

Burlington Resources is applying for administrative approval of an unorthodox gas well location for both the Mesa Verde and Dakota pools. This application for the referenced location is due to terrain, the presence of archaeology, and a subdivision for housing.

Production from the Blanco Mesa Verde pool is to be included in a 320 acre gas spacing and proration unit comprising the SW/4, SE/4 NW/4, SW/4 NE/4 and the W/2 SE/4 of said Section 8. The non-standard proration unit for this well will come before the New Mexico Oil Conservation Division in hearing as Case #11989.

Production from the Basin Dakota pool is to be included in a 320 acre gas spacing and proration unit comprising the SW/4, SE/4 NW/4, SW/4 NE/4 and the W/2 SE/4 of said Section 8. Order R-2045 was issued for the non-standard proration unit for the Dakota pool in this Section.

The following attachments are for your review:

1. Application for Permit to Drill.
2. Completed C-102 at referenced location.
3. Offset operators/owners plat – Burlington is the operator of the unit.
4. 7.5 minute topographic map showing the orthodox windows, and enlargement of the map to define topographic features.

We appreciate your earliest consideration of this application.

Sincerely,



Peggy Bradfield
Regulatory/Compliance Administrator

xc: NMOCD - Aztec District Office
Bureau of Land Management – Farmington District Office

State of New Mexico
Energy, Minerals and Natural Resources Department
Oil Conservation Division

Sundry Notices and Reports on Wells

<p>1. Type of Well GAS</p> <hr/> <p>2. Name of Operator BURLINGTON RESOURCES OIL & GAS COMPANY</p> <hr/> <p>3. Address & Phone No. of Operator PO Box 4289, Farmington, NM 87499 (505) 326-9700</p> <hr/> <p>4. Location of Well, Footage, Sec., T, R, M 600' FSL, 790' FWL, Sec. 8, T-32-N, R-6-W, NMPM, San Juan County</p>	<p>API # (assigned by OCD) 30-045-29526</p> <p>5. Lease Number Fee</p> <p>6. State Oil & Gas Lease #</p> <p>7. Lease Name/Unit Name Allison Unit</p> <p>8. Well No. 47</p> <p>9. Pool Name or Wildcat Blanco MV/Basin DK</p> <p>10. Elevation:</p>
--	--

Type of Submission	Type of Action
<input type="checkbox"/> Notice of Intent	<input type="checkbox"/> Abandonment <input checked="" type="checkbox"/> Change of Plans
<input checked="" type="checkbox"/> Subsequent Report	<input type="checkbox"/> Recompletion <input type="checkbox"/> New Construction
<input type="checkbox"/> Final Abandonment	<input type="checkbox"/> Plugging Back <input type="checkbox"/> Non-Routine Fracturing
	<input type="checkbox"/> Casing Repair <input type="checkbox"/> Water Shut off
	<input type="checkbox"/> Altering Casing <input type="checkbox"/> Conversion to Injection
	<input checked="" type="checkbox"/> Other -

13. Describe Proposed or Completed Operations

The acreage dedication for the subject well has been changed. A new C-102 plat is attached. The Dakota dedication is covered under Order R-2045.

RECEIVED
JUL 21 1998
OIL CON. DIV.
DIST. 3

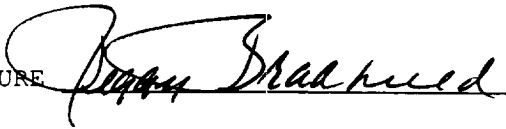
SIGNATURE  Regulatory Administrator July 20, 1998
no

(This space for State Use)

Approved by _____ Title _____ Date _____

District I
PO Box 1980, Hobbs, NM 88241-1980

District II
PO Drawer DD, Artesia, NM 88211-0719

District III
1000 Rio Brazos Rd., Aztec, NM 87410

District IV
PO Box 2088, Santa Fe, NM 87504-2088

State of New Mexico
Energy, Minerals & Natural Resources Department

OIL CONSERVATION DIVISION
PO Box 2088
Santa Fe, NM 87504-2088

Form C-10
Revised February 21, 1998
Instructions on back
Submit to Appropriate District Office
State Lease - 4 Copies
Fee Lease - 3 Copies

☐ AMENDED REPORT

WELL LOCATION AND ACREAGE DEDICATION PLAT

API Number		Pool Code		Pool Name	
30-045-29526		72319/71599		Blanco Mesaverde/Basin Dakota	
Property Code		Property Name			Well Number
6784		ALLISON UNIT			47
OGRID No.		Operator Name			Elevation
14538		BURLINGTON RESOURCES OIL & GAS COMPANY			6521'

10 Surface Location

UL or lot no.	Section	Township	Range	Lot 10	Feet from the	North/South line	Feet from the	East/West line	County
M	8	32N	6W		600	South	790	West	SAN JUAN

11 Bottom Hole Location If Different From Surface

UL or lot no.	Section	Township	Range	Lot 10	Feet from the	North/South line	Feet from the	East/West line	County

Dedicated Acres	Joint or Infill	Consolidation Code	Order No.
MV-320 DK-320			DK-R-2045

NO ALLOWABLE WILL BE ASSIGNED TO THIS COMPLETION UNTIL ALL INTERESTS HAVE BEEN CONSOLIDATED
JUL 21 1998 STANDARD UNIT HAS BEEN APPROVED BY THE DIVISION

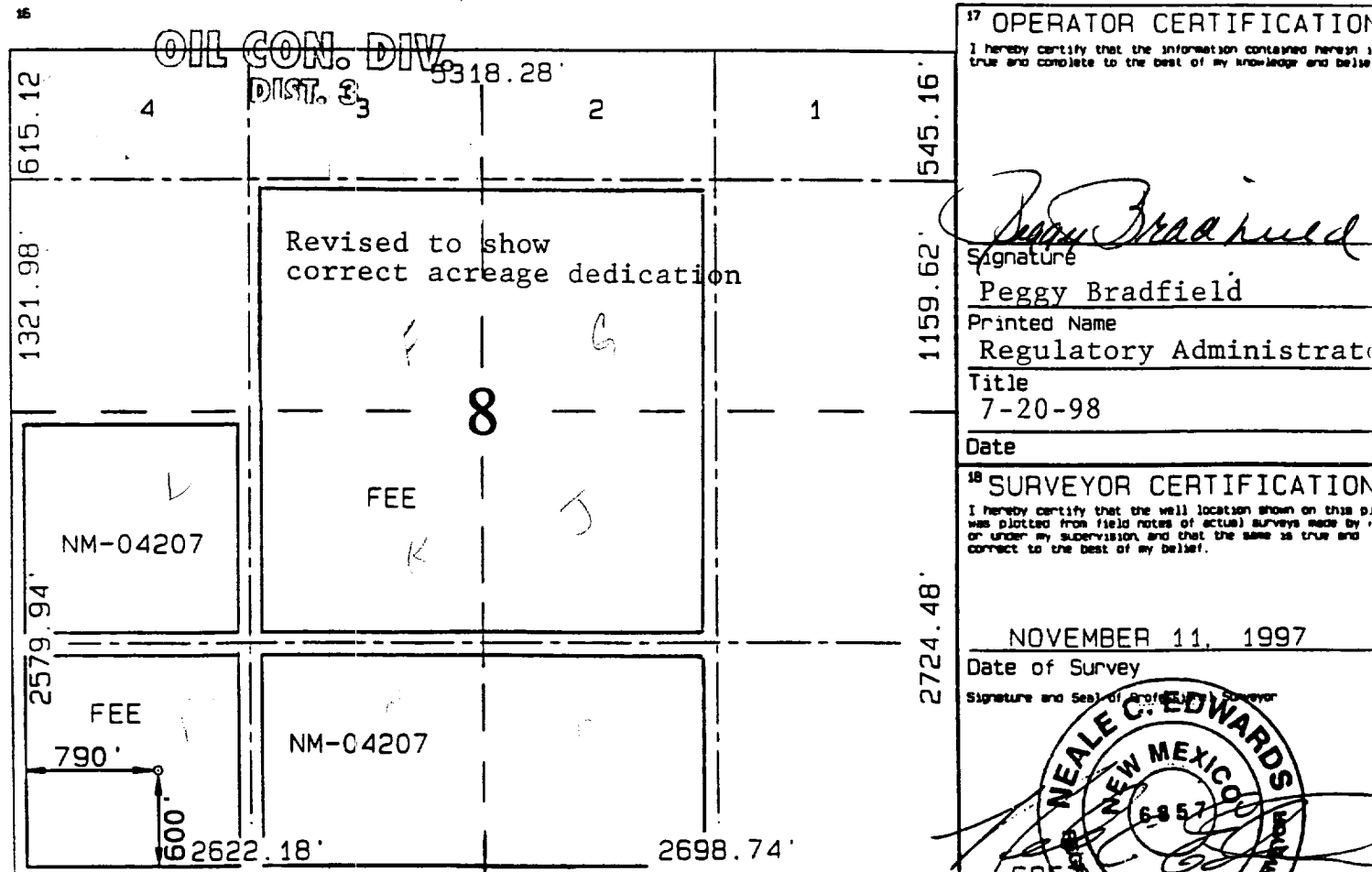

17 OPERATOR CERTIFICATION

I hereby certify that the information contained herein is true and complete to the best of my knowledge and belief.

Peggy Bradfield
Signature
Peggy Bradfield
Printed Name
Regulatory Administrator
Title
7-20-98
Date

18 SURVEYOR CERTIFICATION

I hereby certify that the well location shown on this plat was plotted from field notes of actual surveys made by me or under my supervision, and that the same is true and correct to the best of my belief.

NOVEMBER 11, 1997
Date of Survey
Signature and Seal of Professional Surveyor
NEALE C. EDWARDS
NEW MEXICO
6857
6857
Certificate Number
PROFESSIONAL SURVEYOR

District I

PO Box 1980, Hobbs, NM 88241-1980

District II

811 South First, Artesia, NM 88210

District III

1000 Rio Brazos Rd., Aztec, NM 87410

District IV

2040 South Pacheco, Santa Fe, NM 87505

State of New Mexico
Energy, Minerals & Natural Resources Department

OIL CONSERVATION DIVISION

2040 South Pacheco

Santa Fe, NM 87505

RECEIVED
FEB 12 1998OIL CON. DIV.
DIST. 3

Form C-101

Revised October 18, 1994

Instructions on back

Submit to Appropriate District Office

State Lease - 6 Copies

Fee Lease - 5 Copies

AMENDED REPORT

APPLICATION FOR PERMIT TO DRILL, RE-ENTER, DEEPEN, PLUGBACK, OR ADD A ZONE

¹ Operator Name and Address. Burlington Resources PO Box 4289, Farmington, NM 87499		² OGRID Number 14538
⁴ Property Code 6784		³ API Number 30-045-29524
⁵ Property Name Allison Unit		⁶ Well No. 47

⁷ Surface Location DIST. 3

UL or lot no.	Section	Township	Range	Lot Idn	Feet from the	North/South line	Feet from the	East/West line	County
M	8	32N	6W		600	S	790	W	SJ

⁸ Proposed Bottom Hole Location If Different From Surface

UL or lot no.	Section	Township	Range	Lot Idn	Feet from the	North/South line	Feet from the	East/West line	County
⁹ Proposed Pool 1 Blanco Mesa Verde 72319 W/277.31					¹⁰ Proposed Pool 2 Basin Dakota 71599 W/277.31				

¹¹ Work Type Code N	¹² Well Type Code G	¹³ Cable/Rotary Rotary	¹⁴ Lease Type Code Fee	¹⁵ Ground Level Elevation 1521
¹⁶ Multiple Y	¹⁷ Proposed Depth 8023	¹⁸ Formation MV/Dk	¹⁹ Contractor N/a	²⁰ Spud Date N/a

²¹ Proposed Casing and Cement Program

Hole Size	Casing Size	Casing weight/foot	Setting Depth	Sacks of Cement	Estimated TOC
12 1/4"	9 5/8"	32.3#	200'	188 cu.ft.	Surface
8 3/4"	7"	20.0#	3533'	1009 cu.ft.	Surface
6 1/4"	4 1/2"	10.5#	8023'	706 cu.ft.	3433'

²² Describe the proposed program. If this application is to DEEPEN or PLUG BACK give the data on the present productive zone and proposed new productive zone. Describe the blowout prevention program, if any. Use additional sheets if necessary.

11" 2000 psi minimum double gate BOP

Note: to facilitate higher hydraulic stimulation completion work, no liner hanger will be used. In its place, a long string of 4 1/2" casing will be run and cemented with a minimum of 100' of cement overlap between the 4 1/2" and 7" casing strings. After completion of the well, a 4 1/2" retrievable bridge plug will be set below the top of cement in the 4 1/2" x 7" overlap. The 4 1/2" casing will then be backed off above the top of cement in the 4 1/2" x 7" overlap and laid down. The liner top can then be pressure tested to ensure a seal between the liner top and the 7" casing has been achieved. The test pressure shall be the maximum anticipated pressure to which the seal will be exposed (700 psi for the Mesa Verde and 2500 psi for the Dakota). The 4 1/2" bridge plug will then be retrieved and the production tubing will be run to produce the well.

²³ I hereby certify that the information given above is true and complete to the best of my knowledge and belief.

Signature:

Printed name: Peggy Bradfield

Title: Regulatory/Compliance Administrator

Date: January 19, 1998

Phone: 505-326-9700

OIL CONSERVATION DIVISION

Approved by:

Title:

DEPUTY OIL & GAS INSPECTOR, DIST. #3

Approval Date:

FEB 12 1998

Expiration Date:

FEB 12 1999

Conditions of Approval:

Attached ☐

Hold C-104 for NSL

BURLINGTON RESOURCES OIL AND GAS COMPANY

Allison Unit #47

OFFSET OPERATOR/OWNER PLAT

Nonstandard Location

(Nonstandard Dedication covering SE/4 NW/4, SW/4 NE/4, SW/4, W/2 SE/4)

Mesaverde / Dakota Formations Well

Township 32 North, Range 6 West

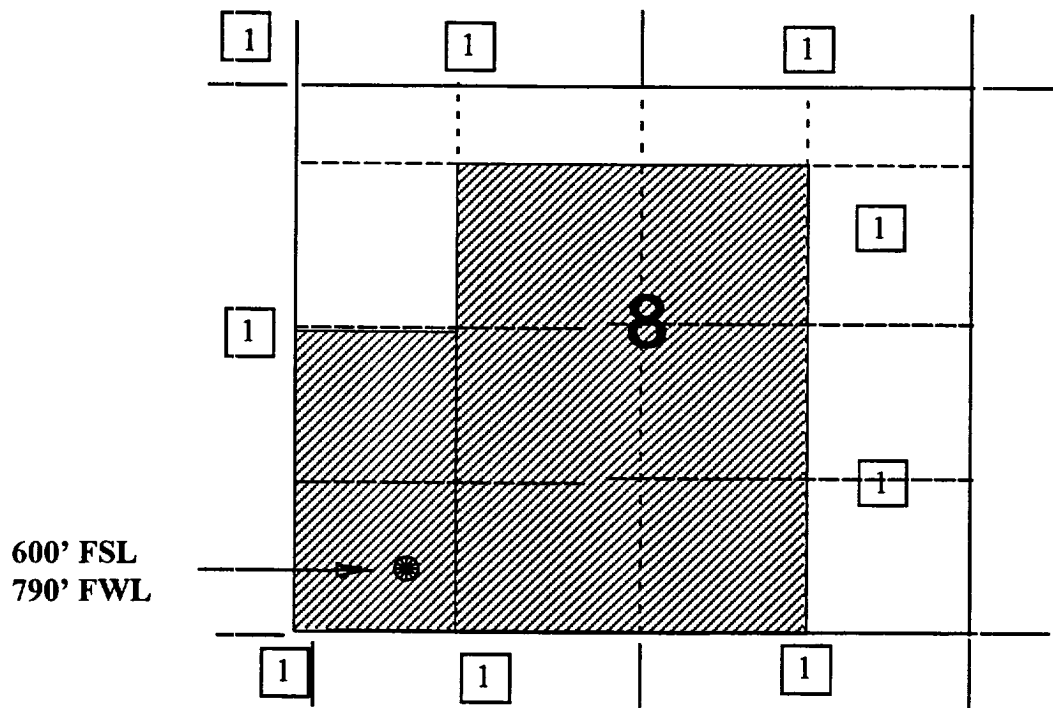

1) Burlington Resources

600' FSL & 790' FWL, SECTION 8, T32N, R6W, N.M.P.M.
SAN JUAN COUNTY, NEW MEXICO

