

STATE OF NEW MEXICO
ENERGY AND MINERALS DEPARTMENT

NO. OF COPIES RECEIVED	
DISTRIBUTION	
SANTA FE	
FILE	
U.S.G.S.	
LAND OFFICE	
OPERATOR	

OIL CONSERVATION DIVISION
P. O. BOX 2088
SANTA FE, NEW MEXICO 87501

Form C-103
Revised 10-1-70

5a. Indicate Type of Lease
State <input checked="" type="checkbox"/> Fee <input type="checkbox"/>
5. State Oil & Gas Lease No.
E-504-10

SUNDRY NOTICES AND REPORTS ON WELLS

(DO NOT USE THIS FORM FOR PROPOSALS TO DRILL OR TO DEEPEN OR PLUG BACK TO A DIFFERENT RESERVOIR.
USE "APPLICATION FOR PERMIT" OR FORM C-101 FOR SUCH PROPOSALS.)

1. OIL WELL <input type="checkbox"/> GAS WELL <input checked="" type="checkbox"/> OTHER-	7. Unit Agreement Name
2. Name of Operator	Allison Unit
Meridian Oil Inc.	8. Farm or Lease Name
3. Address of Operator	Allison Unit
P.O. Box 4289, Farmington, NM 87499	9. Well No.
4. Location of Well	100
UNIT LETTER <u>K</u> <u>1780'</u> FEET FROM THE <u>South</u> LINE AND <u>1540'</u> FEET FROM	10. Field and Pool, or Widacat
THE <u>West</u> LINE, SECTION <u>16</u> TOWNSHIP <u>32N</u> RANGE <u>6W</u> NMPM.	Basin Fruitland Coal
15. Elevation (Show whether DF, RT, GR, etc.)	12. County
6137' GL	San Juan

Check Appropriate Box To Indicate Nature of Notice, Report or Other Data

NOTICE OF INTENTION TO:

PERFORM REMEDIAL WORK ☐
TEMPORARILY ABANDON ☐
PULL OR ALTER CASING ☐

PLUG AND ABANDON ☐

CHANGE PLANS ☐

OTHER Revision ☒

SUBSEQUENT REPORT OF:

REMEDIAL WORK ☐
COMMENCE DRILLING OPS. ☐
CASING TEST AND CEMENT JOB ☐
OTHER ☐

ALTERING CASING ☐
PLUG AND ABANDONMENT ☐

17. Describe Proposed or Completed Operations (Clearly state all pertinent details, and give pertinent dates, including estimated date of starting any proposed work) SEE RULE 1103.

Attached is a copy of the C-102 showing the revised pool & dedication.

RECEIVED
DEC 30 1988
OIL CON. DIV.)
DIST. 3

18. I hereby certify that the information above is true and complete to the best of my knowledge and belief.

SIGNED [Signature]

TITLE Regulatory Affairs

DATE 12-27-88

APPROVED BY [Signature]

DEPUTY OIL & GAS INSPECTOR, DIST. 3

DATE JAN 04 1989

CONDITIONS OF APPROVAL, IF ANY:

RECEIVED

OIL CONSERVATION DIVISION

P. O. BOX 2088

STATE OF NEW MEXICO
ENERGY AND MINERALS DEPARTMENT

SANTA FE, NEW MEXICO 87501

Form C-102
Revised 10-1-78

All distances must be from the outer boundaries of the Section.

Operator Meridian Oil Inc.		Lease ALLISON UNIT (E-504-10)		Well No. 100
Unit Letter K	Section 16	Township 32-N	Range 6-W	County SAN JUAN
Actual Footage Location of Well: 1780 feet from the SOUTH line and 1540 feet from the WEST line				
Ground Level Elev. 6137	Producing Formation Fruitland Coal	Pool Basin	Dedicated Acreage: 320 Acres	

1. Outline the acreage dedicated to the subject well by colored pencil or hatchure marks on the plat below.
2. If more than one lease is dedicated to the well, outline each and identify the ownership thereof (both as to working interest and royalty).
3. If more than one lease of different ownership is dedicated to the well, have the interests of all owners been consolidated by communitization, unitization, force-pooling, etc?

☒ Yes ☐ No If answer is "yes," type of consolidation Unitization

If answer is "no," list the owners and tract descriptions which have actually been consolidated. (Use reverse side of this form if necessary.)

No allowable will be assigned to the well until all interests have been consolidated (by communitization, unitization, forced-pooling, or otherwise) or until a non-standard unit, eliminating such interests, has been approved by the Division.

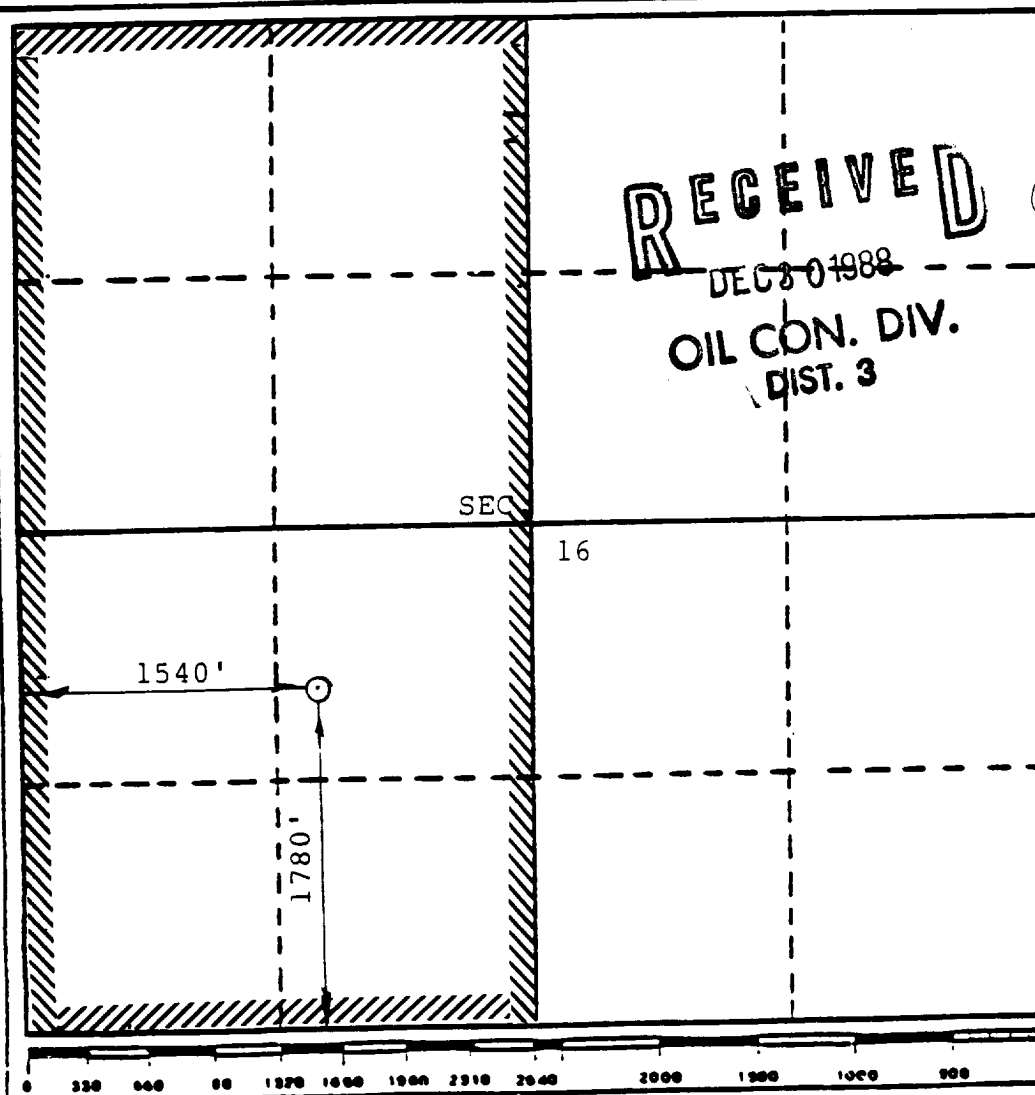

CERTIFICATION

I hereby certify that the information contained herein is true and complete to the best of my knowledge and belief.

Name
Regulatory Affairs
Position
Meridian Oil Inc.
Company

Date
12-27-88

ISAAC L. WEAVER
NEW MEXICO
REGISTERED PROFESSIONAL ENGINEER
No. 8966

MARCH 9, 1988

Date Surveyed
ISAAC L. WEAVER
Registered Professional Engineer
and/or Land Surveyor

Certificate No.
8966