

District I  
1625 N. French Dr., Hobbs, NM 88240  
District II  
811 South First, Artesia, NM 88210  
District III  
1000 Rio Brazos Road, Aztec, NM 87410  
District IV  
2040 South Pacheco, Santa Fe, NM 87505

State of New Mexico  
Energy Minerals and Natural Resources

Form C-101  
Revised March 17, 1999

Oil Conservation Division  
2040 South Pacheco  
Santa Fe, NM 87505

Submit to appropriate District Office  
State Lease - 6 Copies  
Fee Lease - 5 Copies  
AMENDED REPORT

APPLICATION FOR PERMIT TO DRILL, RE-ENTER, DEEPEN, PLUGBACK, OR ADD A ZONE

|   |  |   |
|---|--|---|
| <sup>1</sup> Operator Name and Address<br><b>Amoco Production Company</b><br>P. O. Box 3092<br>Houston, Texas 77253 |  | <sup>2</sup> OGRID Number<br>000778     |
| <sup>3</sup> Property Code<br>000986  |  | <sup>4</sup> API Number<br>30-045-29978 |
| <sup>5</sup> Property Name<br><b>Ridenour Gas Com</b>   |  | <sup>6</sup> Well No.<br>1B             |

<sup>7</sup> Surface Location

| UL or lot no. | Section | Township | Range | Lot Idn | Feet from the | North/South line | Feet from the | East/West line | County   |
|---------------|---------|----------|-------|---------|---------------|------------------|---------------|----------------|----------|
| G             | 13      | 31N      | 11W   |         | 2045          | North            | 2120          | East           | San Juan |

<sup>8</sup> Proposed Bottom Hole Location If Different From Surface

| UL or lot no.   | Section | Township | Range | Lot Idn | Feet from the                 | North/South line | Feet from the | East/West line | County |
|---|---------|----------|-------|---------|-------------------------------|------------------|---------------|----------------|--------|
| <sup>9</sup> Proposed Pool 1<br><b>Blanco Mesaverde</b> |         |          |       |         | <sup>10</sup> Proposed Pool 2 |                  |               |                |        |

|  |  |   |   |  |
|--|--|---|---|--|
| <sup>11</sup> Work Type Code<br><b>N - New Drill</b> | <sup>12</sup> Well Type Code<br><b>Gas</b>   | <sup>13</sup> Cable/Rotary<br><b>Rotary</b> | <sup>14</sup> Lease Type Code<br><b>Fee</b> | <sup>15</sup> Ground Level Elevation<br><b>5861'</b> |
| <sup>16</sup> Multiple<br><b>No</b>                  | <sup>17</sup> Proposed Depth<br><b>5037'</b> | <sup>18</sup> Formation<br><b>Mesaverde</b> | <sup>19</sup> Contractor<br><b>Aztec</b>    | <sup>20</sup> Spud Date<br><b>10/12/99</b>           |

<sup>21</sup> Proposed Casing and Cement Program

| Hole Size | Casing Size | Casing weight/foot | Setting Depth | Sacks of Cement | Estimated TOC |
|-----------|-------------|--------------------|---------------|-----------------|---------------|
| 12 1/4"   | 9 5/8"      | 32.5#              | 250'          | 146 SXS CLS B   | Surface       |
| 8 3/4"    | 7"          | 20#                | 2073'         | 254 SXS CLS B   | Surface       |
| 6 1/4"    | 4 1/2"      | 10.5#              | 5037'         | 239 SXS CLS B   | to 1973'      |
|           |             |                    |               |                 |               |
|           |             |                    |               |                 |               |

<sup>22</sup> Describe the proposed program. If this application is to DEEPEN or PLUG BACK, give the data on the present productive zone and proposed new productive zone. Describe the blowout prevention program, if any. Use additional sheets if necessary.

PLEASE SEE ATTACHED DRILLING AND COMPLETION PROGRAM.

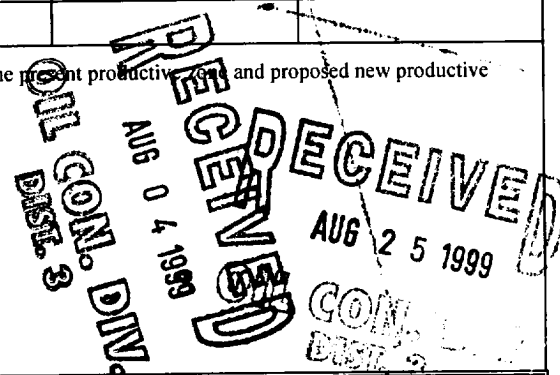

<sup>23</sup> I hereby certify that the information given above is true and complete to the best of my knowledge and belief.

Signature:

*Mary Corley*

Printed name: **Mary Corley**

Title: **Sr. Business Analyst**

Date: **8/3/99**

Phone: **281-366-4491**

OIL CONSERVATION DIVISION

8-31-99

Approved by:

*Eric Busch*

Title:

**DEPUTY OIL & GAS INSPECTOR, DIST. 3**

Approval Date:

**AUG 31 1999**

Expiration Date:

**AUG 31 2000**

Conditions of Approval:

Attached ☐

**HOLD C104 FOR NSE**

District I  
PO Box 1980, Hobbs NM 88241-1980  
District II  
PO Drawer KK, Artesia, NM 87211-0719  
District III  
1000 Rio Brazos Rd., Aztec, NM 87410  
District IV  
PO Box 2088, Santa Fe, NM 87504-2088

State of New Mexico  
Energy, Minerals & Natural Resources Department

OIL CONSERVATION DIVISION  
PO Box 2088  
Santa Fe, NM 87504-2088

Form C-102  
Revised February 21, 1994

Instructions on back  
Submit to Appropriate District Office  
State Lease - 4 Copies  
Fee Lease - 3 Copies

☐ AMENDED REPORT

WELL LOCATION AND ACREAGE DEDICATION PLAT

|   |  |  |
|---|--|--|
| <sup>1</sup> API Number<br>30-045-29978 | <sup>2</sup> Pool Code<br>72319                        | <sup>3</sup> Pool Name<br>Blanco Mesaverde |
| <sup>4</sup> Property Code<br>000986    | <sup>5</sup> Property Name<br>RIDENOUR GAS COM         | <sup>6</sup> Well Number<br># 1B           |
| <sup>7</sup> OGRID No.<br>000778        | <sup>8</sup> Operator Name<br>AMOCO PRODUCTION COMPANY | <sup>9</sup> Elevation<br>5861             |

<sup>10</sup> Surface Location

| UL or Lot No. | Section | Township | Range | Lot Idn | Feet from the | North/South line | Feet from the | East/West line | County   |
|---------------|---------|----------|-------|---------|---------------|------------------|---------------|----------------|----------|
| G             | 13      | 31 N     | 11 W  |         | 2045          | NORTH            | 2120          | EAST           | SAN JUAN |

<sup>11</sup> Bottom Hole Location If Different From Surface

| <sup>7</sup> UL or lot no.           | Section                       | Township                         | Range                   | Lot Idn | Feet from the | North/South line | Feet from the | East/West line | County |
|--------------------------------------|-------------------------------|----------------------------------|-------------------------|---------|---------------|------------------|---------------|----------------|--------|
|                                      |                               |                                  |                         |         |               |                  |               |                |        |
| <sup>12</sup> Dedicated Acres<br>320 | <sup>13</sup> Joint or Infill | <sup>14</sup> Consolidation Code | <sup>15</sup> Order No. |         |               |                  |               |                |        |

NO ALLOWABLE WILL BE ASSIGNED TO THIS COMPLETION UNTIL ALL INTERESTS HAVE BEEN CONSOLIDATED  
OR A NON-STANDARD UNIT HAS BEEN APPROVED BY THE DIVISION

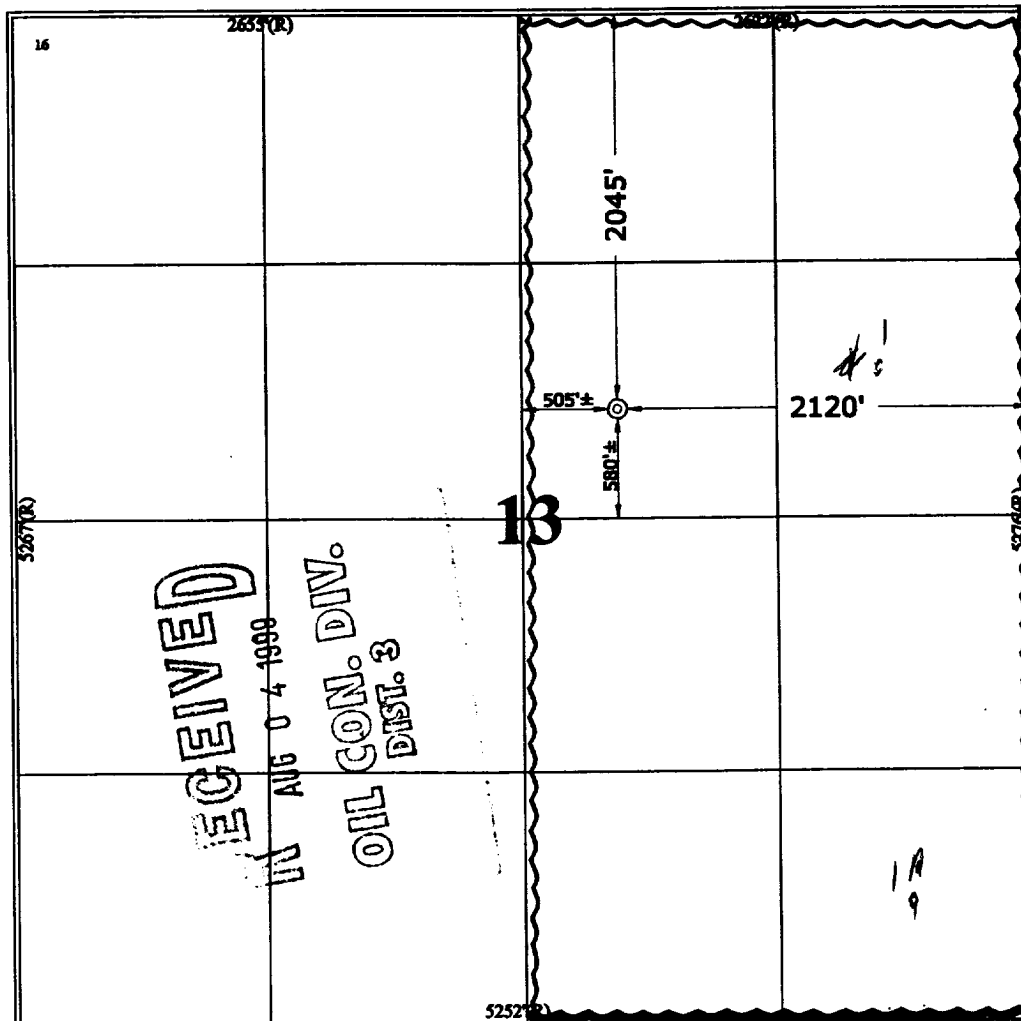
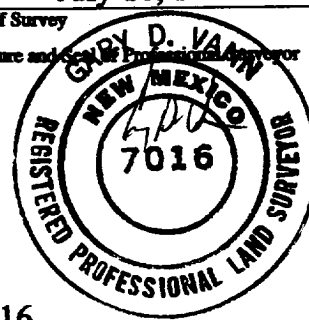
|   |  |
|---|--|
|  | <p><sup>17</sup> OPERATOR CERTIFICATION</p> <p>I hereby certify that the information contained herein is true and complete to the best of my knowledge and belief.</p> <p>Signature: <i>Mary Corley</i></p> <p>Printed Name: Mary Corley</p> <p>281-366-4491</p> <p>Title: Sr. Business Analyst</p> <p>Date:</p>   |
|   | <p><sup>18</sup> SURVEYOR CERTIFICATION</p> <p>I hereby certify that the well location shown on this plat was plotted from field notes of actual surveys made by me or under my supervision, and that the same is true and correct to the best of my belief.</p> <p>July 16, 1999</p> <p>Date of Survey</p> <p>Signature and Seal of Professional Surveyor: <i>GARY D. VAAN</i></p> <p></p> <p>7016</p> <p>Certificate Number</p> |

**AMOCO PRODUCTION COMPANY  
DRILLING AND COMPLETION PROGRAM**

**Prospect Name:** Ridenour Gas Com  
**Lease:** RIDENOUR GAS COM  
**County:** San Juan  
**State:** New Mexico  
**Date:** August 2, 1999

**Well No:** 1B  
**Surface Location:** 13-31N-11W, 2045 FNL, 2120 FEL  
**Field:** Blanco Mesaverde

|   |                 |                         |   |  |                 |                             |
|---|-----------------|-------------------------|---|--|-----------------|-----------------------------|
| <b>OBJECTIVE:</b> Drill 100' into the Mancos Shale, set 4 1/2" Liner across MV, Stimulate CH, MF, and PL interval                             |                 |                         |   |  |                 |                             |
| <b>METHOD OF DRILLING</b>   |                 |                         |   | <b>APPROXIMATE DEPTHS OF GEOLOGICAL MARKER</b> |                 |                             |
| TYPE OF TOOLS   |                 | DEPTH OF DRILLING       |   | Estimated GL: 5861                             |                 | Estimated KB: 5872          |
| Rotary/Top Drive  |                 | 0 - TD                  |   |  |                 |                             |
| <b>LOG PROGRAM</b>  |                 |                         |   | <b>MARKER</b>                                  |                 |                             |
| TYPE  |                 | DEPTH INVERAL           |   |  |                 | <b>SUBSEA</b>               |
| Cased Hole (GR-CCL-TDT)   |                 | TDT - PBTD-Top of Liner |   |  |                 | <b>MEAS. DEPTH</b>          |
|   |                 | GR-CCL - PBTD-0'        |   |  |                 |                             |
| REMARKS:<br>- Please report any flares (magnitude & duration).  |                 |                         |   | Ojo Alamo                                      |                 | 4264                        |
|   |                 |                         |   | Kirtland                                       |                 | 1608                        |
|   |                 |                         |   | Fruitland Coal                                 |                 | 1809                        |
|   |                 |                         |   | Pictured Cliffs                                |                 | 2123                        |
|   |                 |                         |   | Lewis Shale                                    |                 | 2556                        |
|   |                 |                         |   | Cliff House                                    |                 | 2648                        |
|   |                 |                         |   | Menefee Shale                                  |                 | 4145                        |
|   |                 |                         |   | Point Lookout                                  |                 | 4380                        |
|   |                 |                         |   | Mancos   |                 | 4823                        |
|   |                 |                         |   | TOTAL DEPTH                                    |                 | 4937                        |
|   |                 |                         |   |  |                 | 5037                        |
|   |                 |                         |   | # Probable completion interval * Possible Pay  |                 |                             |
| <b>SPECIAL TESTS</b>  |                 |                         |   | <b>DRILL CUTTING SAMPLES</b>                   |                 | <b>DRILLING TIME</b>        |
| TYPE  |                 |                         |   | FREQUENCY DEPTH                                |                 | FREQUENCY DEPTH             |
| None  |                 |                         |   |  |                 | Geolograph 0-TD             |
| REMARKS:  |                 |                         |   |  |                 |                             |
| <b>MUD PROGRAM:</b>   |                 |                         |   |  |                 |                             |
| Approx. Interval  |                 | Type Mud                | Weight, #/gal   | Vis, sec/qt                                    | W/L cc's/30 min | Other Specification         |
| 0 - 250   |                 | Spud                    | 8.6-9.2   |  |                 |                             |
| 250 - 2073 (1)(2)   |                 | Water/LSND              | 8.6-9.2   |  |                 |                             |
| 2073 - TD   |                 | Gas/Air/Mist            | Volume sufficient to maintain a stable and clean wellbore |  |                 |                             |
| REMARKS:  |                 |                         |   |  |                 |                             |
| (1) The hole will require sweeps to keep unloaded while fresh water drilling. Let hole conditions dictate frequency.                          |                 |                         |   |  |                 |                             |
| (2) Top set Fruitland Coal to minimize lost circulation, air volume to maintain hole stability.   |                 |                         |   |  |                 |                             |
| <b>CASING PROGRAM:</b> (Normally, tubular goods allocation letter specifies casing sizes to be used. Hole sizes will be governed by Contract) |                 |                         |   |  |                 |                             |
| Casing String   | Estimated Depth | Casing Size             | Grade   | Weight   | Hole Size       | Landing Point, Cement, Etc. |
| Surface   | 250             | 9 5/8"                  | WC40 ST&C   | 32.3#  | 12.25"          | 1                           |
| Intermediate  | 2073            | 7"                      | WC50 ST&C   | 20#  | 8.75"           | 1,2                         |
| Production (liner)  | 5037            | 4 1/2"                  | WC50 ST&C   | 10.5#  | 6.25"           | 3                           |
| REMARKS:  |                 |                         |   |  |                 |                             |
| (1) Circulate Cement to Surface   |                 |                         |   |  |                 |                             |
| (2) Set casing 50' above Fruitland Coal   |                 |                         |   |  |                 |                             |
| (3) Liner Lap should be a minimum of 200'   |                 |                         |   |  |                 |                             |
| <b>CORING PROGRAM:</b>  |                 |                         |   |  |                 |                             |
| None  |                 |                         |   |  |                 |                             |
| <b>COMPLETION PROGRAM:</b>  |                 |                         |   |  |                 |                             |
| Rigless, 2-3 Stage Limited Entry Hydraulic Frac   |                 |                         |   |  |                 |                             |
| <b>GENERAL REMARKS:</b>   |                 |                         |   |  |                 |                             |
| Notify BLM/NMOCDD 24 hours prior to Spud, BOP testing, and Casing and Cementing.  |                 |                         |   |  |                 |                             |
| Form 46 Reviewed by:  |                 |                         |   | Logging program reviewed by: N/A               |                 |                             |
| <b>PREPARED BY:</b>   |                 | <b>APPROVED:</b>        |   | <b>DATE:</b>                                   |                 |                             |
| KAS/KAT   |                 |                         |   |  |                 |                             |
| Form 46 6-99 KAT  |                 |                         |   |  |                 |                             |

## BOP Test Pressure

### Amoco Production Company BOP Pressure Testing Requirements

Well Name: Ridenour Gas Com  
County: San Juan

1B  
State: New Mexico

| Formation      | TVD  | Anticipated<br>Bottom Hole Pressure | Maximum Anticipated<br>Surface Pressure ** |
|----------------|------|-------------------------------------|--|
| Ojo Alamo      | 1608 |                                     |  |
| Kirtland       | 1809 |                                     |  |
| Fruitland Coal | 2123 |                                     |  |
| PC             | 2556 |                                     |  |
| Lewis Shale    | 2648 |                                     |  |
| Cliff House    | 4145 | 1200                                | 288.1                                      |
| Menefee Shale  | 4380 |                                     |  |
| Point Lookout  | 4823 | 4823                                | 238.94                                     |
| Mancos         | 4937 |                                     |  |

\*\* Note: Determined using the following formula:  $ABHP - (.22 \times TVD) = ASP$

Requested BOP Pressure Test Exception: 1200 psi

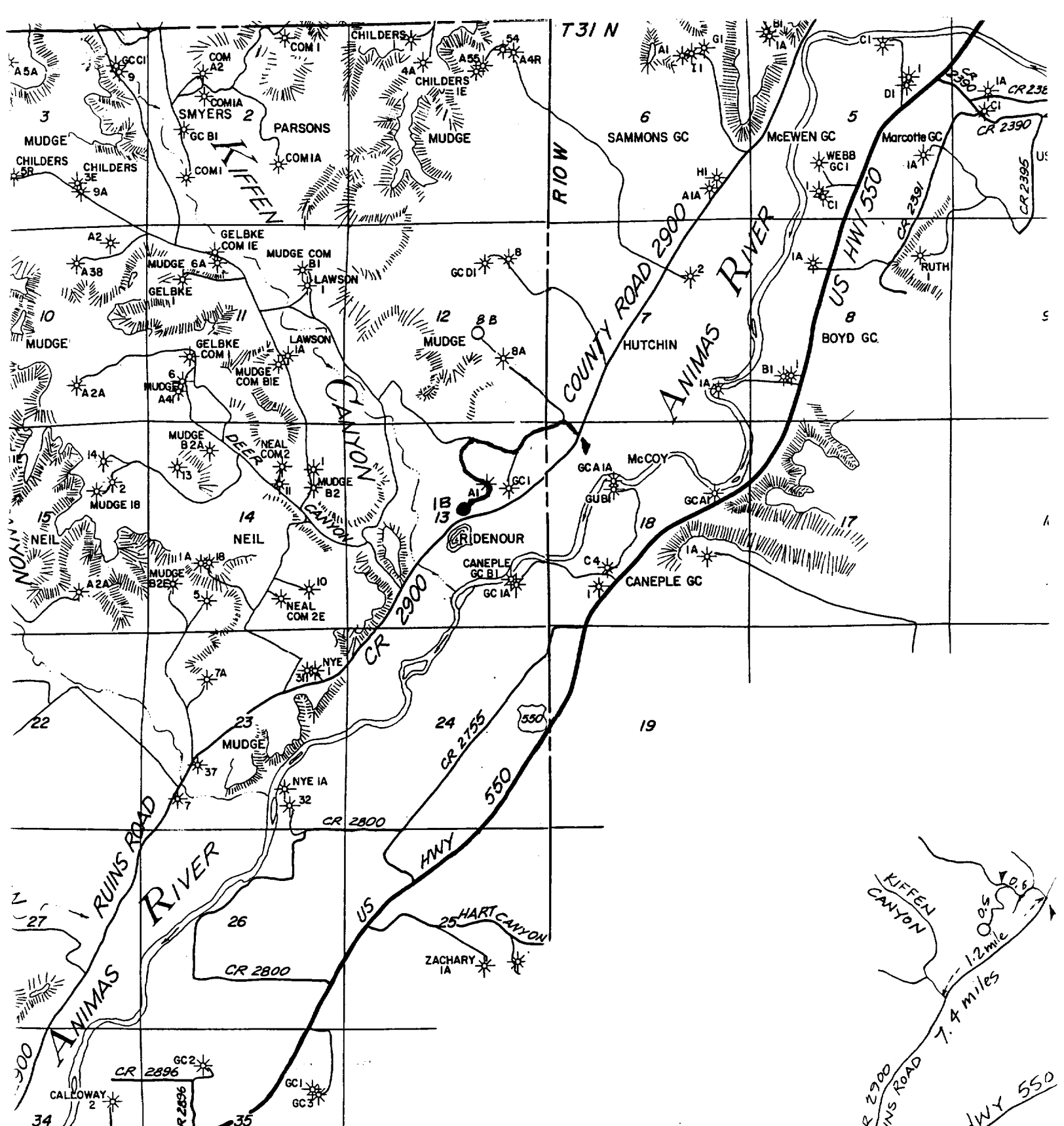

**LAT: 36°54.0'**  
**LONG: 107°56.4'**

AMOCO PRODUCTION COMPANY  
**RIDENOUR GAS COM # 1B**  
 NE¼ Sec. 13, T31N, R11W, NMPM  
 RAIL POINT:  
 MUD POINT:  
 CEMENT POINT:

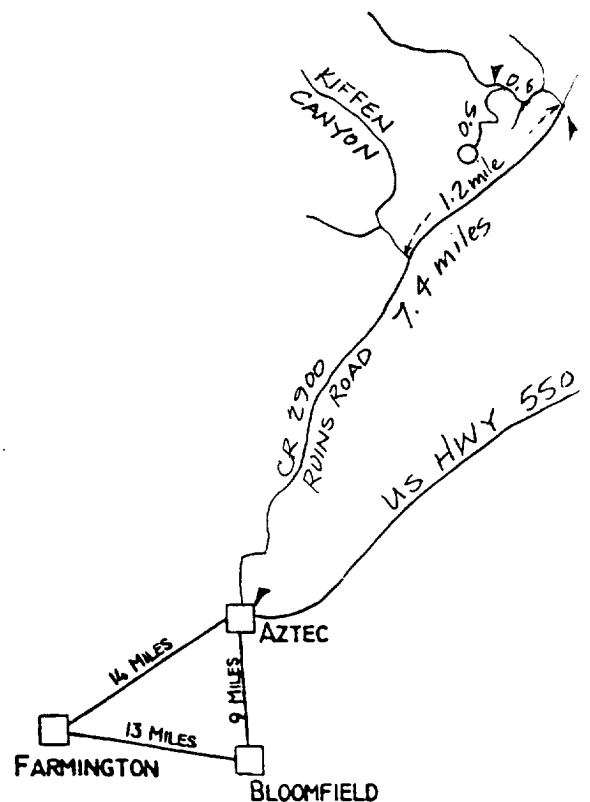

**AMOCO  
PRODUCTION COMPANY**

**RIDENOUR GAS COM # 1B**  
NE $\frac{1}{4}$  Section 13,  
T31N, R11W, N.M.P.M.

400' New FEE Road Construction

T31N, R11W, Sec. 13

SW $\frac{1}{4}$ NE $\frac{1}{4}$

**APD MAP # 1**

NE¼ Section 13,  
T31N, R11W, N.M.P.M.

T31N, R11W, Sec. 13

SW¼NE¼

APD MAP # 1

