

(SUBMIT IN TRIPLICATE)

UNITED STATES
DEPARTMENT OF THE INTERIOR
GEOLOGICAL SURVEY

Budget Bureau No. 42-R-359.2
Approval expires 12-31-55.

Indian Agency **Ute**
Tract No. **14**
Allottee **14-20-60-06**
Lease No. _____

SUNDRY NOTICES AND REPORTS ON WELLS

NOTICE OF INTENTION TO DRILL	<input checked="" type="checkbox"/>	SUBSEQUENT REPORT OF WATER SHUT-OFF	
NOTICE OF INTENTION TO CHANGE PLANS		SUBSEQUENT REPORT OF SHOOTING OR ACIDIZING	
NOTICE OF INTENTION TO TEST WATER SHUT-OFF		SUBSEQUENT REPORT OF ALTERING CASING	
NOTICE OF INTENTION TO REDRILL OR REPAIR WELL		SUBSEQUENT REPORT OF REDRILLING OR REPAIR	
NOTICE OF INTENTION TO SHOOT OR ACIDIZE		SUBSEQUENT REPORT OF ABANDONMENT	
NOTICE OF INTENTION TO PULL OR ALTER CASING		SUPPLEMENTARY WELL HISTORY	
NOTICE OF INTENTION TO ABANDON WELL			

(INDICATE ABOVE BY CHECK MARK NATURE OF REPORT, NOTICE, OR OTHER DATA)

August 18, 1956

Well No. **2** is located **1900** ft. from **SW** line and **1900** ft. from **E** line of sec. **20**
NW 1/4 Sec. 20 **14N** **19W** **107N**
 (1/4 Sec. and Sec. No.) (Twp.) (Range) (Meridian)
Unmanned **San Juan** **New Mexico**
 (Field) (County or Subdivision) (State or Territory)

The elevation of the derrick floor above sea level is _____ ft. **Will furnish later.**

DETAILS OF WORK

(State names of and expected depths to objective sands; show sizes, weights, and lengths of proposed casings; indicate mudding jobs, cementing points, and all other important proposed work)

Gulf Designation: **Southwest Barker Dome No. 2.**

It is proposed to drill a test well of the Tertiary Formation to an approximate total depth of 2000'. It is planned to set approximately 300' of 8-1/8" OD surface casing cemented to the surface. If commercial production is encountered 4-1/2" OD oil string will be used. All producing horizons will be adequately tested.



I understand that this plan of work must receive approval in writing by the Geological Survey before operations may be commenced.

Company **Gulf Oil Corporation**
 Address **c/o Lester LaFavour**
Box 2077
Denver 1, Colorado

By _____
 Title **Area Sup't. of Production**

cc: **New Mexico Oil & Gas Conservation Commission**
Ute Indian Agency

NEW MEXICO
OIL CONSERVATION COMMISSION

Form C-128

Well Location and/or Gas Proration Plat

Date August 18, 1956

Operator Gulf Oil Corporation

Lease Southwest Harbor Dam

Well No. 1 Section 20 Township 31 North Range 15 West NMPM

Located 1980 Feet From South Line, 1980 Feet From East Line,

San Juan County, New Mexico. G. L. Elevation 5715

Name of Producing Formation Tusite Pool Harbor Dam Dedicated Acreage 10

(Note: All distances must be from outer boundaries of Section).

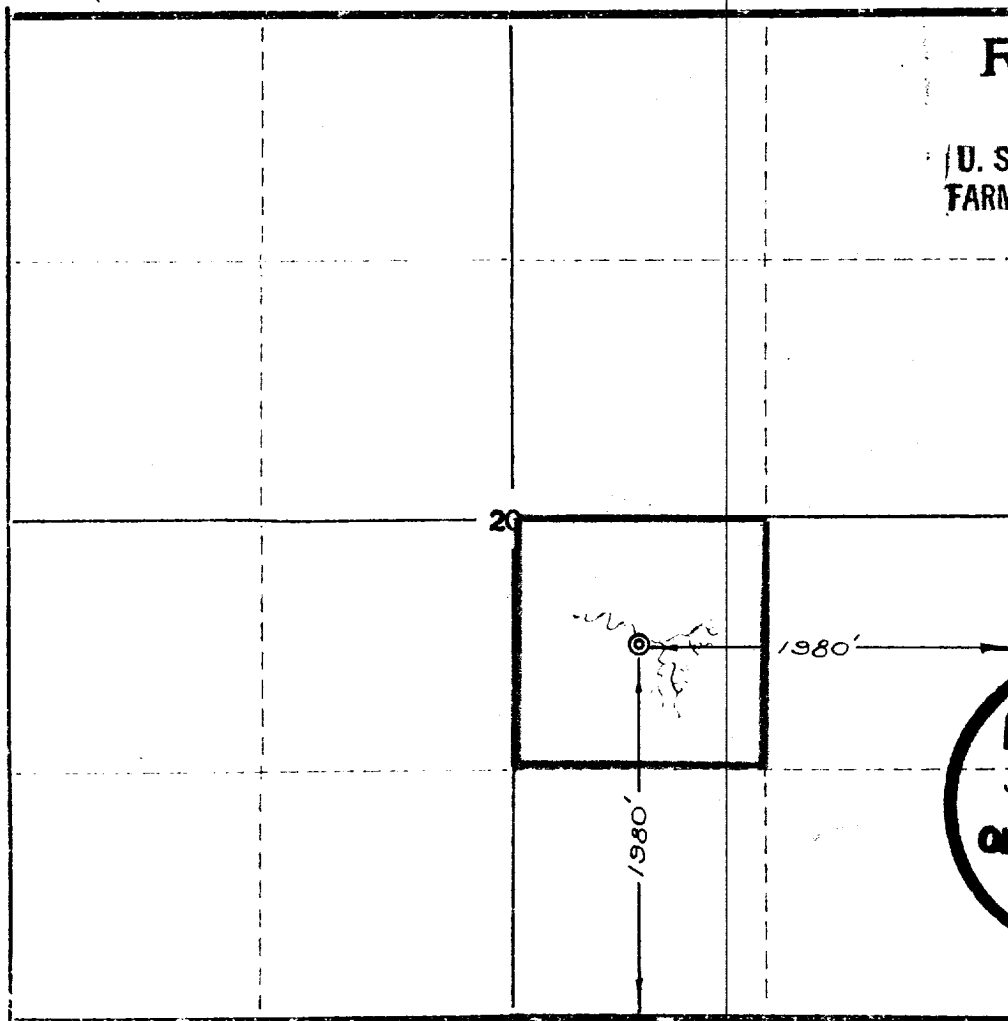

RECEIVED

AUG 20 1956

U. S. GEOLOGICAL SURVEY
FARMINGTON, NEW MEXICO

NOTE

This section of
form is to be
used for gas
wells only.



SCALE: 1" = 1000'

1. Is this Well a Dual Comp. ? Yes No X
2. If the answer to Question 1 is yes, are there any other
dually completed wells within the dedicated acreage?
Yes No X

Name Ernest V. Echohawk

Position Area Sup't. of Production

Representing Gulf Oil Corporation

Address P. O. Box 2097, Denver 1, Colorado

This is to certify that the above plat was prepared
from field notes of actual surveys made by me or
under my supervision and that the same are true and
correct to the best of my knowledge and belief.

Date Surveyed March 28, 1956

Ernest V. Echohawk

Ernest V. Echohawk

Reg. Land Surveyor, N. Mex., Reg. No. 1545