

NEW MEXICO OIL CONSERVATION COMMISSION

NOTICE OF INTENTION TO DRILL

See Rules 101 and 1104.

If changes in the proposed plan are considered advisable, a copy of this notice showing such changes will be returned to the sender. Submit this notice in triplicate. One copy will be returned following approval.

Farmington, New Mexico

January 30, 1953

Place

Date

Notice hereby is given that it is our intention to commence the drilling of a well to be known as

El Paso Natural Gas Company **Sinclair State** well No. **1** in **San Juan**
 Company or Operator Lease
 of Sec. **32**, T. **32N**, R. **11W**, N. M. P. M. **Blanco** Pool, **San Juan** County.

N

The well is **1450** feet from **2E** (S.) line and **1550** feet from
 (E.) **2E** line of the above section.

(Give location from section lines. Cross out wrong directions.)

If state land the oil and gas lease is No. **B-13318-23** Assignment No. _____

If patented land the owner is _____

Address _____

If government land the permittee is _____

Address _____

The lessee is **Brookhaven Oil Company**

Address _____

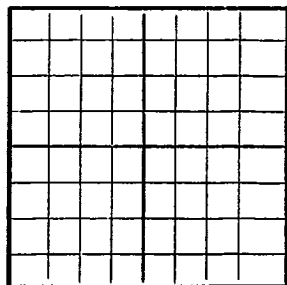

AREA 640 ACRES

LOCATE WELL CORRECTLY

We propose to drill well with drilling equipment as follows: **Rotary tools through the Mesaverde formation and using gas circulation through the pay section.**

The status of a bond for this well in conformance with Rule 101 of the General Rules and Regulations of the Commission is as follows: _____

We propose to use the following strings of casing and to land or cement them as indicated:

Size of Hole	Size of Casing	Weight Per Foot	New or Second Hand	Depth	Landed or Cemented	Sacks Cement
12-1/4	9-5/8	25.4	New	160	Cemented	125
8-3/4	7	20	New	4540	Cemented	300

If changes in the above plans become advisable we will notify you before cementing or landing casing. We estimate that the first productive oil or gas sand should occur at a depth of about **4580** feet.

Additional information:

Total depth 5395'.

Shoot the entire Mesaverde with two quarts S.M.G. per foot.

The S₁ of Section 32 is dedicated to this well.

Approved **Feb. 2**, 19 **53**

except as follows:

OIL CONSERVATION COMMISSION

By **Emery C. Arnold**
 Title **Inspector, Dist. #3**

El Paso Natural Gas Company

Company or Operator

By _____

Position **Petroleum Engineer**

Send communications regarding well to:

Name **E. J. Coal**

Address **Box 997, Farmington, New Mexico**

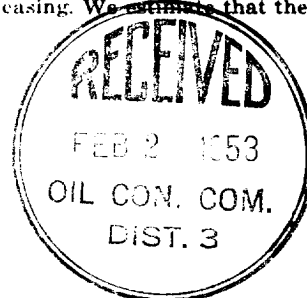

OIL CONSERVATION COMMISSION**AZTEC DISTRICT OFFICE**

No. Copies Received

DISTRIBUTION

	NO. FURNISHED	
Operator		
Santa Fe		
Proration Office		
State Land Office		
U. S. G. S.		
Transporter		
File		

COMPANY El Paso Natural Gas Co.
Well Name & No. Sinclair State #1 Lease No. B-13318-23
Location 1450 feet from the South line. 1550 feet from the East line.
Being in NW $\frac{1}{4}$ of the SE $\frac{1}{4}$
Sec. 32, T32N., R11W., N.M.P.M., San Juan County, New Mexico
Ground Elevation 6294.63

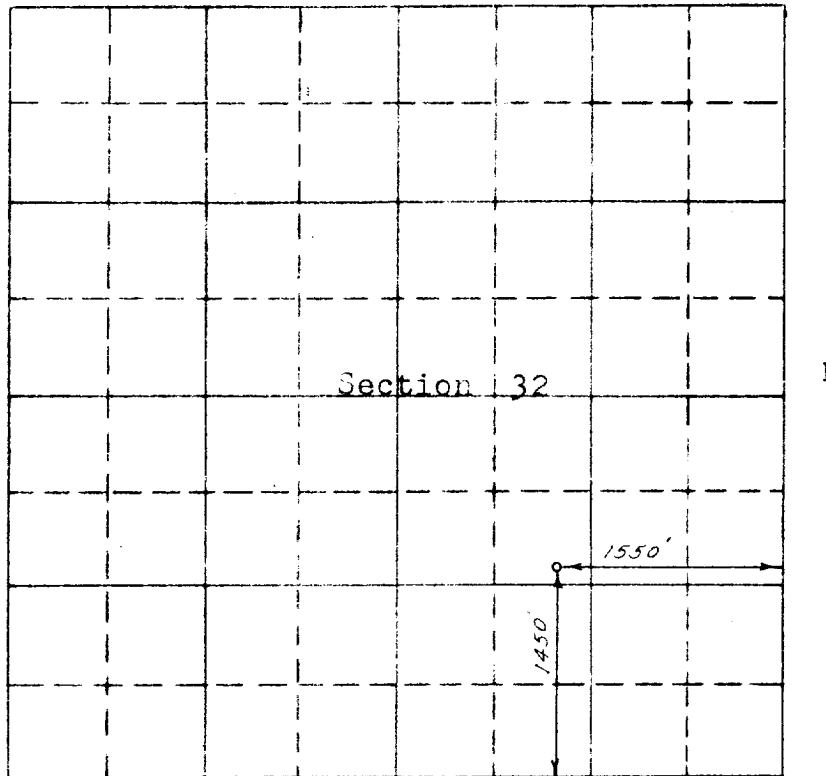

Scale -- 4 inches equals 1 mile

Surveyed _____, December 10, 19 52

This is to certify that the above plat was prepared from field notes of actual surveys made by me or under my supervision and that the same are true and correct to the best of my knowledge and belief.

C. O. Walker
Registered Professional
Engineer and Land Surveyor.

Seal:

Farmington, New Mexico



OIL CONSERVATION COMMISSION
AZTEC DISTRICT OFFICE

No. Copies Received 5

DISTRIBUTION

	NO. FURNISHED	
Operator	1	
Santa Fe	1	
Proration Office		
State Land Office	1	
U. S. G. S.	1	
Transporter		
File	1	✓