

# NEW MEXICO OIL CONSERVATION COMMISSION

## Well Location and Acreage Dedication Plat

## SECTION A.

Date September 10, 1963

Operator Skelly Oil Company Lease Navajo "P"  
 Well No. 12 Unit Letter I Section 35 Township 32 North Range 17 West NMPM  
 Located 1830 Feet From South Line, 810 Feet From East Line  
 County San Juan G. L. Elevation 5405 Dedicated Acreage 40 Acres  
 Name of Producing Formation Gallup Pool Many Rocks Gallup

1. Is the Operator the only owner\* in the dedicated acreage outlined on the plat below? Yes X No \_\_\_\_\_
2. If the answer to question One is "No," have the interests of all the owners been consolidated by communitization agreement or otherwise? Yes \_\_\_\_\_ No \_\_\_\_\_. If answer is "Yes," Type of Consolidation \_\_\_\_\_
3. If the answer to question Two is "No," list all the owners and their respective interests below:

OWNER

LAND DESCRIPTION

## SECTION B.

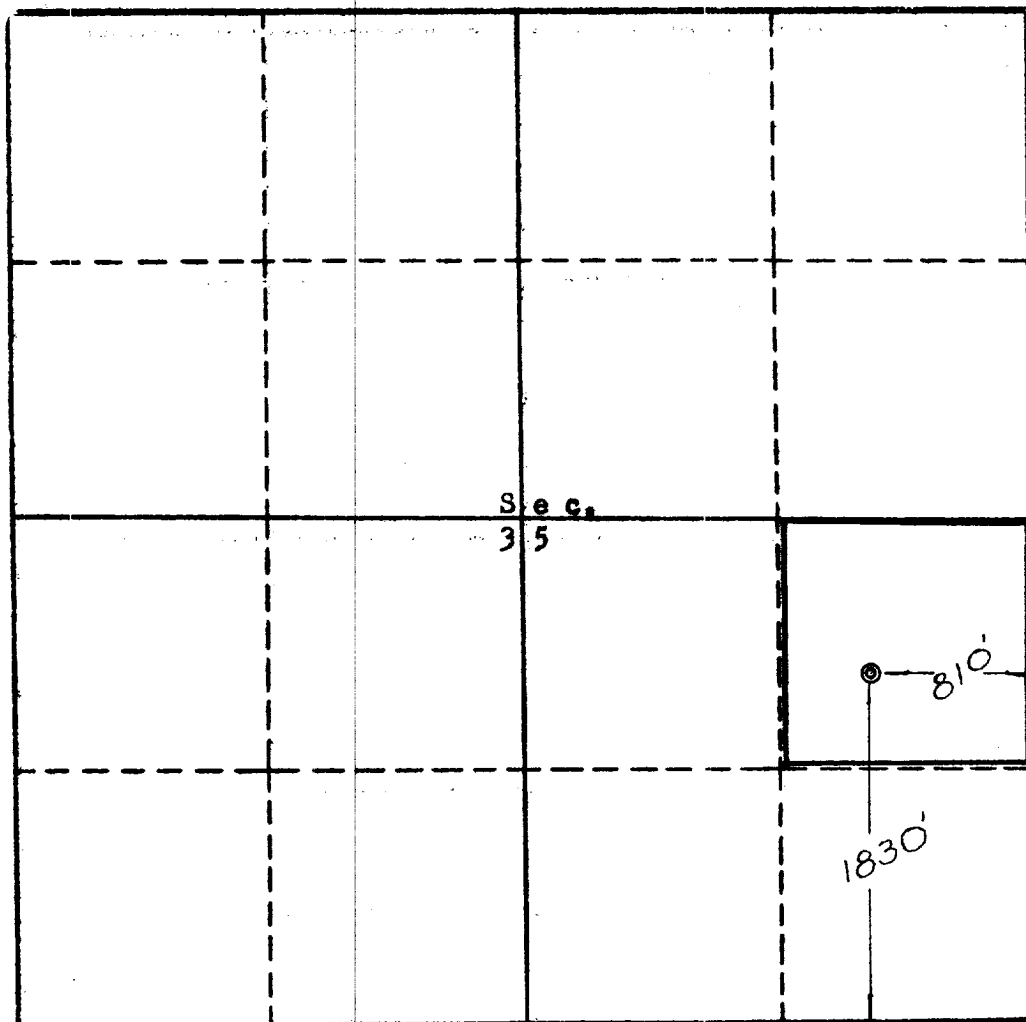

This is to certify that the information in Section A above is true and complete to the best of my knowledge and belief.

SKELLY OIL COMPANY

(OPERATOR)

*J. W. George*  
 (REPRESENTATIVE)  
 Box 730, Hobbs, New Mexico  
 (ADDRESS)

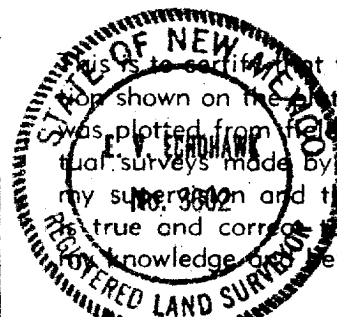
Date Surveyed Sept. 10, 1963

**Four States Engineering Co.**  
 FARMINGTON, NEW MEXICO

*Ernest H. Edwards*  
 REGISTERED ENGINEER OR  
 LAND SURVEYOR

Certificate No. 3602