

NEW MEXICO OIL CONSERVATION COMMISSION

Well Location and Acreage Dedication Plat

SECTION A.

Date May 9, 1963

Operator Skelly Oil Company Lease Navajo "P"
Well No. 2 Unit Letter K Section 35 Township 32 North Range 17 West NMPM
Located 1920 Feet From South Line, 1810 Feet From West Line
County San Juan G. L. Elevation 5730 Dedicated Acreage 40 Acres
Name of Producing Formation Gallup Pool Undesignated Gallup

1. Is the Operator the only owner* in the dedicated acreage outlined on the plat below? Yes X No
2. If the answer to question One is "No," have the interests of all the owners been consolidated by communization agreement or otherwise? Yes No If answer is "Yes," Type of Consolidation
3. If the answer to question Two is "No," list all the owners and their respective interests below:

OWNER

LAND DESCRIPTION

SECTION B.

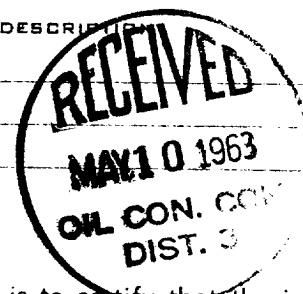
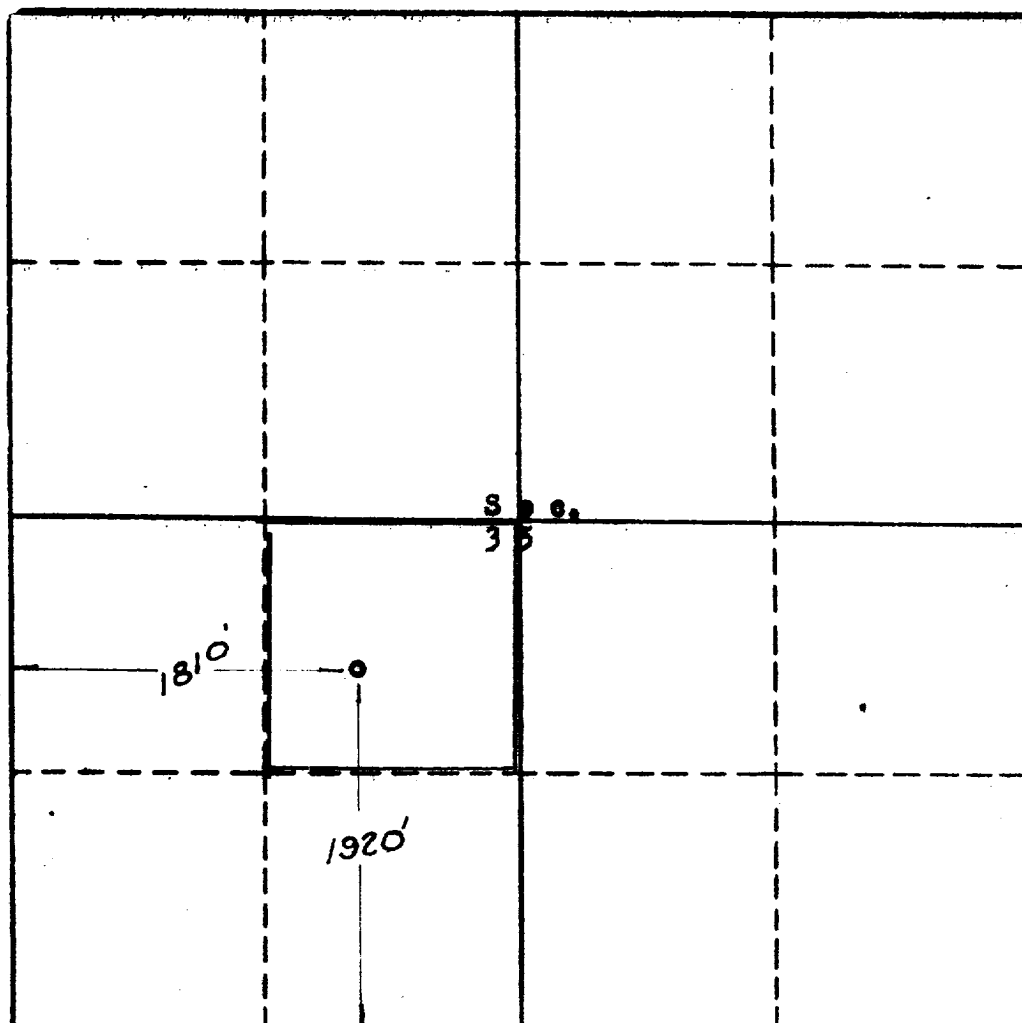

This is to certify that the information in Section A above is true and complete to the best of my knowledge and belief.

SKELLY OIL COMPANY

(OPERATOR)

J. W. George
(REPRESENTATIVE)

Box 38, Hobbs, New Mexico
(ADDRESS)

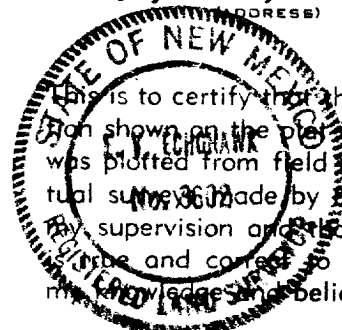

Date Surveyed May 8, 1963

Four States Engineering Co.
FARMINGTON, NEW MEXICO

Edward H. Eubank
REGISTERED ENGINEER OR
LAND SURVEYOR

Certificate No. 3602

