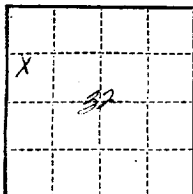

(SUBMIT IN TRIPLICATE)

Indian Agency Nava joUNITED STATES
DEPARTMENT OF THE INTERIOR
GEOLOGICAL SURVEYAllottee Nava jo
Lease No. 14-20-603-587

SUNDRY NOTICES AND REPORTS ON WELLS

NOTICE OF INTENTION TO DRILL	<input checked="" type="checkbox"/>	SUBSEQUENT REPORT OF WATER SHUT-OFF	
NOTICE OF INTENTION TO CHANGE PLANS		SUBSEQUENT REPORT OF SHOOTING OR ACIDIZING	
NOTICE OF INTENTION TO TEST WATER SHUT-OFF		SUBSEQUENT REPORT OF ALTERING CASING	
NOTICE OF INTENTION TO REDRILL OR REPAIR WELL		SUBSEQUENT REPORT OF REDRILLING OR REPAIR	
NOTICE OF INTENTION TO SHOOT OR ACIDIZE		SUBSEQUENT REPORT OF ABANDONMENT	
NOTICE OF INTENTION TO PULL OR ALTER CASING		SUPPLEMENTARY WELL HISTORY	
NOTICE OF INTENTION TO ABANDON WELL			

(INDICATE ABOVE BY CHECK MARK NATURE OF REPORT, NOTICE, OR OTHER DATA)

March 23

RECEIVED
APR 27 1959
OIL CON. COM.
DIST. 3
19 59Well No. 1-32 is located 1980 ft. from N line and 660 ft. from W line of sec. 32SW NW Sec. 32 32 N 18 W N.M.P.M.
(1/4 Sec. and Sec. No.) (Twp.) (Range) (Meridian)Wildcat
(Field)San Juan
(County or Subdivision)New Mexico
(State or Territory)The elevation of the derrick floor above sea level is 5251 ft. Survey plats attached.

DETAILS OF WORK

(State names of and expected depths to objective sands; show sizes, weights, and lengths of proposed casings; indicate mudding jobs, cementing points, and all other important proposed work)

Operator proposes to drill a well to total depth of 8000' to test the entire Pennsylvanian section for oil and/or gas. The following is a brief outline of the proposed work:

Casing program: Set approximately 275' 13 3/8" - 48# H-40 surface casing with sufficient cement to circulate. Will drill 7 7/8" hole to Molos formation at TD 8000'. If productive, will run 5 1/2" casing from surface to TD.

Coring program: Plan on coring the Tocito formation at approximately 800' and Paradox formation at approximately 7750'.

Other proposed work: Will drill hole with conventional type drilling mud and will run electric log and micro log from base of surface casing to TD.

I understand that this plan of work must receive approval in writing by the Geological Survey before operations may be commenced.

Company COMPASS EXPLORATION, INC.Address 1645 Court Place #308Denver 2, ColoradoAM 6-1939

By

Title Vice President

NEW MEXICO OIL CONSERVATION COMMISSION
Well Location and Acreage Dedication Plat

Section A.

Date March 23, 1959

Operator COMPASS EXPLORATION, Inc Lease NAVAJO
Well No. 1. Unit Letter Section 32 Township 32 N Range 18 W NMPN
Located 1980 Feet From north Line, 660 Feet From west Line
County SAN JUAN G. L. Elevation 5241 Dedicated Acreage 40 Acres
Name of Producing Formation Pavada Pool Wildcat

1. Is the Operator the only owner* in the dedicated acreage outlined on the plat below?
Yes X No .
2. If the answer to question one is "no," have the interests of all the owners been consolidated by communitization agreement or otherwise? Yes No . If answer is "yes," Type of Consolidation
3. If the answer to question two is "no," list all the owners and their respective interests below:

Owner

Land Description

Section B

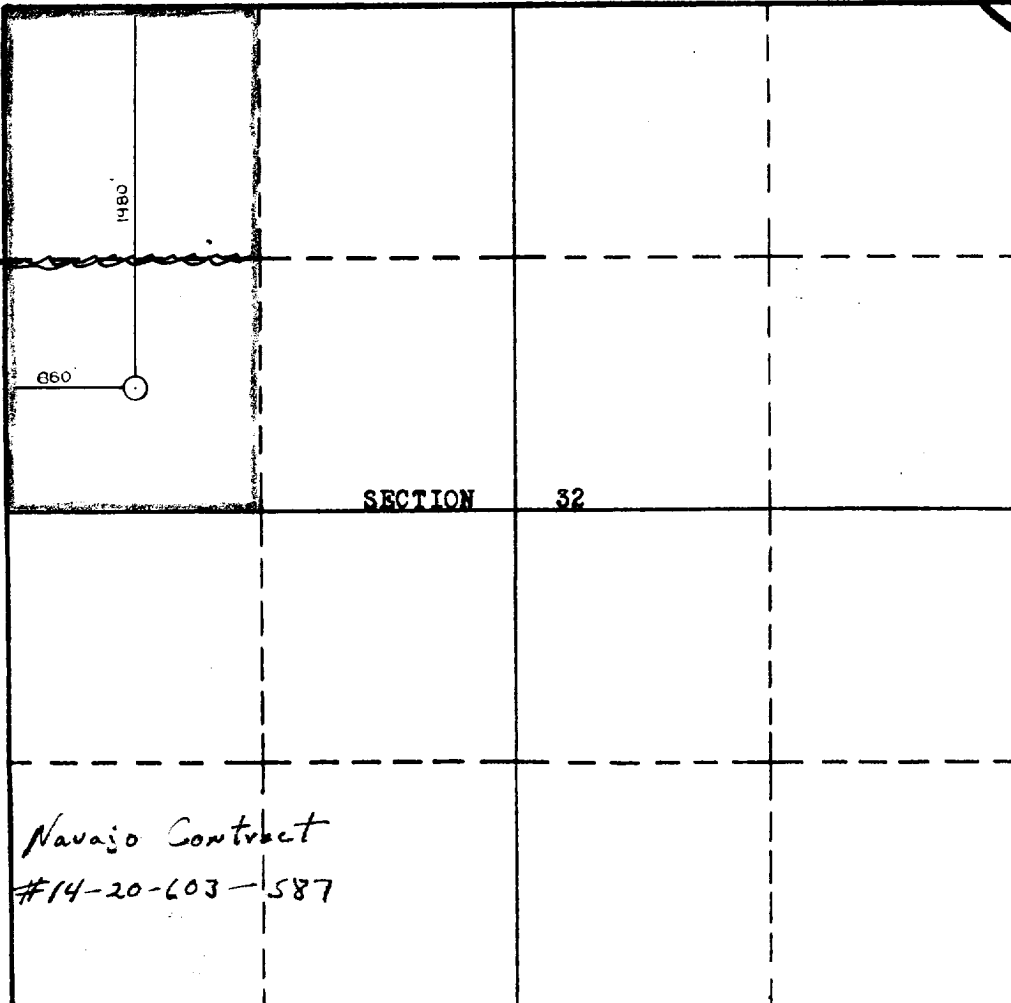

This is to certify that the information in Section A above is true and complete to the best of my knowledge and belief.

Compass Exploration, Inc
(Operator)
James E. Menon
(Representative)
Denver, Colorado
Address

This is to certify that the well location shown on the plat in Section B was plotted from field notes of actual surveys made by me or under my supervision and that the same is true and correct to the best of my knowledge and belief.

Date Surveyed March 11, 1959
Stephen H. Menon
Registered Professional
Engineer and/or Land Surveyor

Certificate No. 8097813/59

SUPERVISOR, OIL AND GAS OPERATIONS

DESIGNATION OF OPERATOR

The undersigned is, on the records of the Bureau of Land Management, holder of oil and gas lease

DISTRICT LAND OFFICE, Washington, D.C.

SERIAL NO. 1 Chicago Federal Agents Conference No. 1A-22-225-507

and hereby designates

WATER

ADDRESS:

SECRET

2026 - 2027

[REDACTED]

as his operator and local agent, with full authority to act in his behalf in complying with the terms of the lease and regulations applicable thereto and on whom the supervisor or his representative may serve written or oral instructions in securing compliance with the Oil and Gas Operating Regulations with respect to (describe acreage to which this designation is applicable):

~~SECRETED BY THE FBI, March 24, 1964, E.A.P.H.
ALL INFORMATION CONTAINED HEREIN IS UNCLASSIFIED~~

SECRET

100-443887-100



It is understood that this designation of operator does not relieve the lessee of responsibility for compliance with the terms of the lease and the Oil and Gas Operating Regulations. It is also understood that this designation of operator does not constitute an assignment of any interest in the lease.

In case of default on the part of the designated operator, the lessee will make full and prompt compliance with all regulations, lease terms, or orders of the Secretary of the Interior or his representative.

The lessee agrees promptly to notify the oil and gas supervisor of any change in the designated operator.

STORMING UNDER THE COVER

(Signature of lessee) **Willie Burdette**

THE UNIVERSITY OF CHICAGO

1000 Building, Dallas, Texas

Address

Secretary

2-20-64, 1964

(Date)