



IN REPLY REFER TO:

UNITED STATES
DEPARTMENT OF THE INTERIOR
GEOLOGICAL SURVEY
P. O. Box 965
Farmington, New Mexico

June 21, 1956

Humble Oil & Refining Company
Box 1600
Midland, Texas

Re: Navajo 14-20-603-592

Gentlemen:

Receipt is acknowledged of your "Notice of Intention to Drill" dated June 19, 1956 and "Amended Notice of Intention to Drill" dated July 2, 1956 covering your well No. 2 Humble & Continental Oil Co. Navajo Tribe of Indians "B" in NW 1/4 Sec. 29, T. 32 N., R. 20 W., N.M.P.M., San Juan County, New Mexico.

Your proposed work is hereby approved subject to compliance with the provisions of the "Oil and Gas Operating Regulations" revised May 23, 1942, a copy of which will be sent to you on request, and subject to the following conditions:

1. Drilling operations so authorized are subject to the attached sheet for general conditions of approval.
2. Furnish copies of all logs.

Very truly yours,

(Orig. Sgd.) P. T. McGRATH

P. T. McGrath
District Engineer

PTMcGrath:ac
cc - Navajo Agency



UNITED STATES
DEPARTMENT OF THE INTERIOR
GEOLOGICAL SURVEY



(SUBMIT IN TRIPLICATE)

Indian Agency Nava Jo

14-20-603-508

UNITED STATES
DEPARTMENT OF THE INTERIOR
GEOLOGICAL SURVEY

Allottee _____

Co. Lease No. 221461

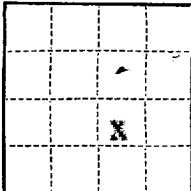

See attached plat

SUNDRY NOTICES AND REPORTS ON WELLS

NOTICE OF INTENTION TO DRILL.....	<input checked="" type="checkbox"/>	SUBSEQUENT REPORT OF WATER SHUT-OFF.....	
NOTICE OF INTENTION TO CHANGE PLANS.....		SUBSEQUENT REPORT OF SHOOTING OR ACIDIZING.....	
NOTICE OF INTENTION TO TEST WATER SHUT-OFF.....		SUBSEQUENT REPORT OF ALTERING CASING.....	
NOTICE OF INTENTION TO REDRILL OR REPAIR WELL.....		SUBSEQUENT REPORT OF REDRILLING OR REPAIR.....	
NOTICE OF INTENTION TO SHOOT OR ACIDIZE.....		SUBSEQUENT REPORT OF ABANDONMENT.....	
NOTICE OF INTENTION TO PULL OR ALTER CASING.....		SUPPLEMENTARY WELL HISTORY.....	
NOTICE OF INTENTION TO ABANDON WELL.....			

(INDICATE ABOVE BY CHECK MARK NATURE OF REPORT, NOTICE, OR OTHER DATA)

NAVAJO TRIBE OF INDIANS "B"

Midland, Texas

June 19, 1956

Well No. 2 is located 1050 ft. from N line and 1050 ft. from E line of sec. 29

1/4 3/4 Section 29
(1/4 Sec. and Sec. No.)

T-52-N
(Twp.)

R-20-W
(Range)

--
(Meridian)

Four Corners Paradox
(Field)

San Juan
(County or Subdivision)

--
(State or Territory)

The elevation of the derrick floor above sea level is 1020 ft.

DETAILS OF WORK

(State names of and expected depths to objective sands; show sizes, weights, and lengths of proposed casings; indicate mudding jobs, cementing points, and all other important proposed work)

CASING PROGRAM		
Size	Weight	Depth
15-5/8"	48	300'
9-5/8"	36	3500'
5-1/2"	14 & 15.5	6000'

CEMENTING RECORD	
Cement to surface	
Circulate 9-5/8" to 15-5/8"	
Circulate 5-1/2" to 9-5/8"	

CORING PROGRAM
Paradox 5500'-6000'

Minimum mud for samples and DST's - 300' to total depth.

I understand that this plan of work must receive approval in writing by the Geological Survey before operations may be commenced.

Company Humble Oil & Refining Company

Address Box 1800

Midland, Texas

By [Signature]

Title Division Chief Clerk

NEW MEXICO
OIL CONSERVATION COMMISSION

Form C-128

Well Location and/or Gas Proration Plat

Date 6-11-56

Operator HUMBLE OIL & REFINING CO. Lease NAVAJO TRIBAL INDIANS "B"

Well No. 2 Section 29 Township 32-N Range 20-W NMPM

Located 1650 Feet From SOUTH Line, 1650 Feet From EAST Line,

SAN JUAN County, New Mexico. G. L. Elevation _____

Name of Producing Formation PARRODOX Pool FOUR CORNERS Dedicated Acreage 160

(Note: All distances must be from outer boundaries of Section)

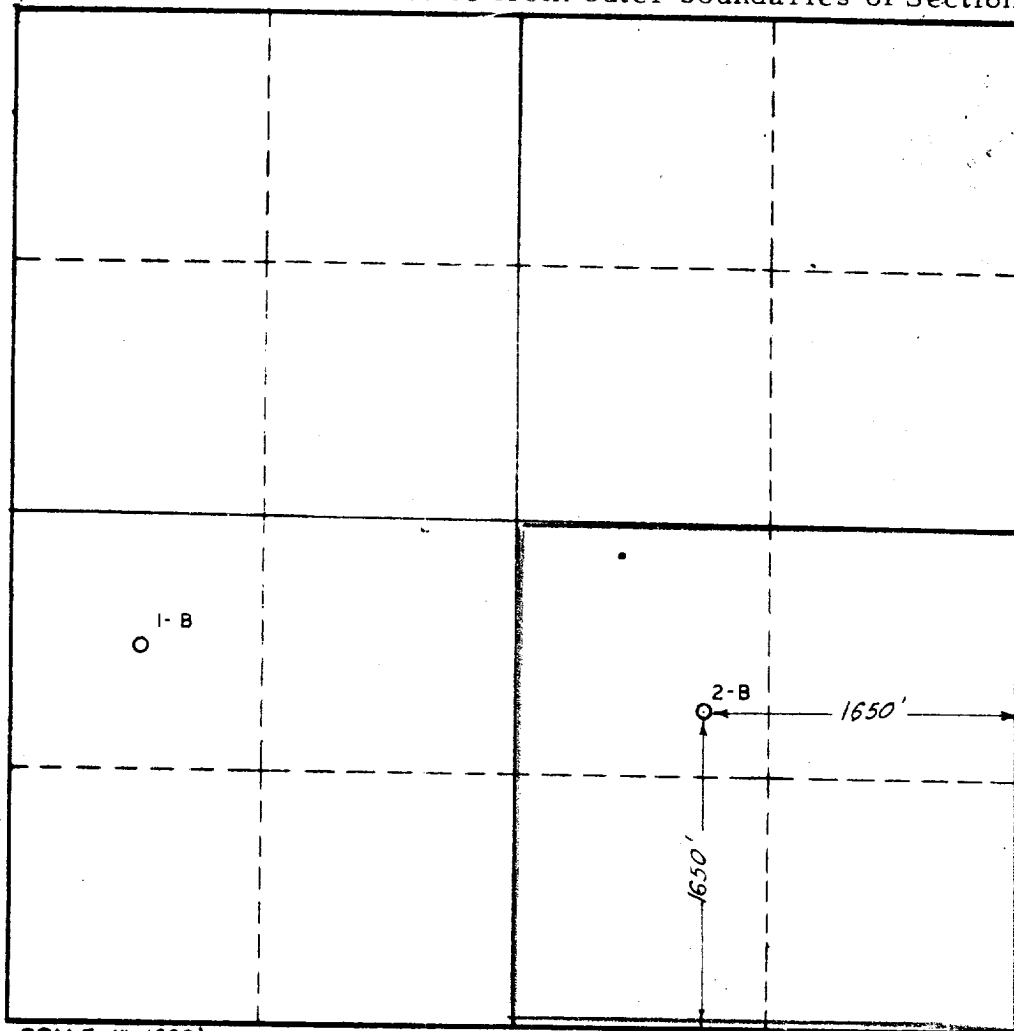

SCALE: 1"=1000'

1. Is this Well a Dual Comp. ? Yes No _____
2. If the answer to Question 1 is yes, are there any other dually completed wells within the dedicated acreage? Yes _____ No _____

This is to certify that the above plat was prepared from field notes of actual surveys made by me or under my supervision and that the same are true and correct to the best of my knowledge and belief.

Name J. P. Kuchman
Position ASSISTANT DIVISION SUPERINTENDENT
Representing HUMBLE OIL & REFINING CO.
Address BOX 1600 MIDLAND TEXAS

Date Surveyed 5-22-56
E. T. Shaha
Registered Professional Engineer and/or
Land Surveyor
LEASE NO. 221461
CONTRACT NO. 14 20 603 592
W-A 2150