

(SUBMIT IN TRIPLICATE)

Form approved.  
Budget Bureau No. 42-R359.4.

Indian Agency

**Navajo-Usu**  
**Humboldt**

Allottee

**14-80-600-3536**

Lease No.

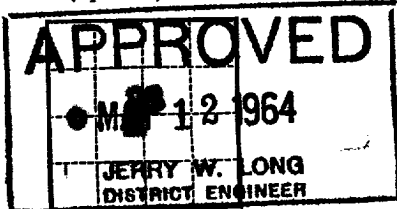

UNITED STATES  
DEPARTMENT OF THE INTERIOR  
GEOLOGICAL SURVEY

SUNDRY NOTICES AND REPORTS ON WELLS

NOTICE OF INTENTION TO DRILL	SUBSEQUENT REPORT OF WATER SHUT-OFF
NOTICE OF INTENTION TO CHANGE PLANS	SUBSEQUENT REPORT OF SHOOTING OR ACIDIZING
NOTICE OF INTENTION TO TEST WATER SHUT-OFF	SUBSEQUENT REPORT OF ALTERING CASING
NOTICE OF INTENTION TO REDRILL OR REPAIR WELL	SUBSEQUENT REPORT OF REDRILLING OR REPAIR
NOTICE OF INTENTION TO SHOOT OR ACIDIZE	SUBSEQUENT REPORT OF ABANDONMENT
NOTICE OF INTENTION TO PULL OR ALTER CASING	SUPPLEMENTARY WELL HISTORY
NOTICE OF INTENTION TO ABANDON WELL	

APR 29 1964  
U. S. GEOLOGICAL SURVEY  
DURANGO, COLO.

(INDICATE ABOVE BY CHECK MARK NATURE OF REPORT, NOTICE, OR OTHER DATA)

Well No. 1 is located 2310 ft. from N line and 820 ft. from W line of sec. 28  
Wildcat (Field) T32N-R16W (Twp.) N.M.P.M. (Range) New Mexico (State or Territory)  
The elevation 5553 ft. O.L.

DETAILS OF WORK

(State names of and expected depths to objective sands; show sizes, weights, and lengths of proposed casings; indicate mudding jobs; cementing points, and all other important proposed work)

It is intended to drill an 1800' Gallup test in the following manner: Drill 8-1/2" hole to 400' and cement 7" casing to surface. Drill 6-1/2" hole to total depth with air. If commercial production is encountered, set 4-1/2" casing and sand-oil free. Put well on production.

I understand that this plan of work must receive approval in writing by the Geological Survey before operations may be commenced.

Company Stone Drilling, Inc. & Howard L. Kennedy, Operators  
Address P. O. Box 3348  
Durango, Colorado  
By John F. Mitchell  
Title Agent

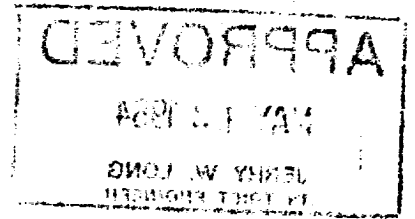

## NEW MEXICO OIL CONSERVATION COMMISSION

## Well Location and Acreage Dedication Plat

## Section A.

Date April 28, 1964

Operator Stone Drilling, Inc. & Howard L. Kennedy Lease 14-20-600-3536  
 Well No. 1 Unit Letter L Section 28 Township 32 NORTH Range 16 WEST, NMPM  
 Located 2310 Feet From the SOUTH Line, 820 Feet From the WEST Line  
 County SAN JUAN G. L. Elevation 5553.0 Dedicated Acreage 40 Acres  
 Name of Producing Formation Gallup Pool Wildcat

1. Is the Operator the only owner in the dedicated acreage outlined on the plat below?  
 Yes X No \_\_\_\_\_
2. If the answer to question one is "no", have the interests of all the owners been consolidated by communitization agreement or otherwise? Yes \_\_\_\_\_ No \_\_\_\_\_. If answer is "yes", Type of Consolidation.
3. If the answer to question two is "no", list all the owners and their respective interests below:

Owner

Land Description

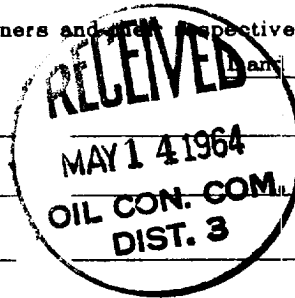

RECEIVED

APR 29 1964

U. S. GEOLOGICAL SURVEY  
DURANGO, COLO.

## Section B.

Note: All distances must be from outer boundaries of section.

This is to certify that the information in Section A above is true and complete to the best of my knowledge and belief.

Stone Drilling, Inc. &  
 Howard L. Kennedy

(Operator)

(Representative)

P. O. Box 3348

(Address)

Durango, Colorado

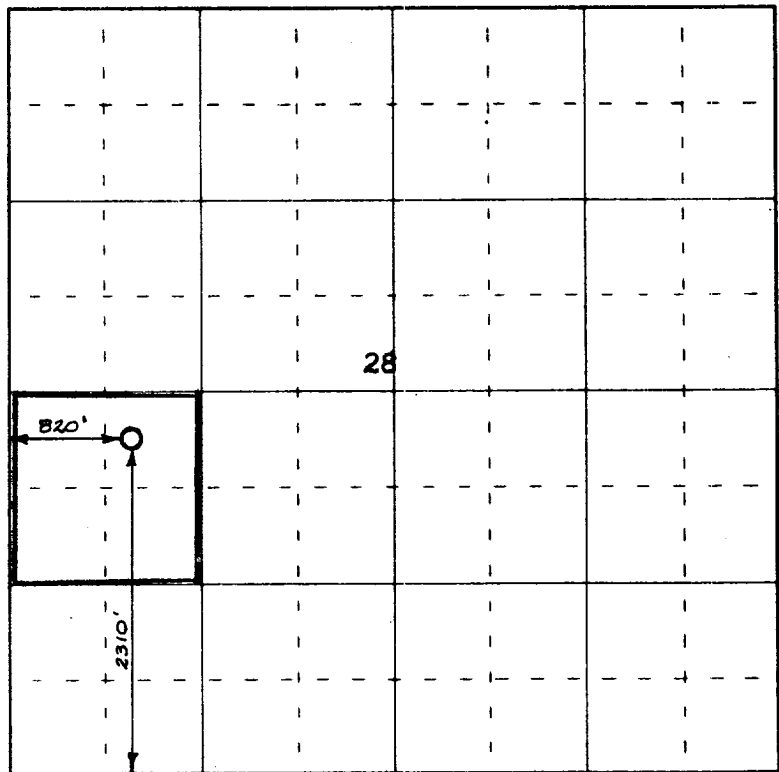

Scale 4 inches equal 1 mile



This is to certify that the above plat was prepared from field notes of actual surveys made by me or under my supervision and that the same are true and correct to the best of my knowledge and belief.

(Seal)

Date Surveyed 18 March 1964

Farmington, New Mexico

James P. Leese  
 Registered Professional Engineer and/or Land Surveyor  
 James P. Leese  
 New Mexico Reg. No. 1463