

UNITED STATES
DEPARTMENT OF THE INTERIOR
GEOLOGICAL SURVEY

APPLICATION FOR PERMIT TO DRILL, DEEPEN, OR PLUG BACK

1a. TYPE OF WORK DRILL <input checked="" type="checkbox"/> DEEPEN <input type="checkbox"/> PLUG BACK <input type="checkbox"/>		5. LEASE DESIGNATION AND SERIAL NO. 14-20-600-3539		
b. TYPE OF WELL OIL WELL <input checked="" type="checkbox"/> GAS WELL <input type="checkbox"/> OTHER <input type="checkbox"/> SINGLE ZONE <input type="checkbox"/> MULTIPLE ZONE <input type="checkbox"/>		6. IF INDIAN, ALLOTTEE OR TRIBE NAME Navajo and Ute Tribal		
2. NAME OF OPERATOR WALTER DUNCAN		7. UNIT AGREEMENT NAME		
3. ADDRESS OF OPERATOR Box 137, Durango, Colorado		8. FARM OR LEASE NAME Superior-Ute-Navajo		
4. LOCATION OF WELL (Report location clearly and in accordance with any State requirements.)* At surface 2303' S/N, 337' W/E, Sec. 25, T32N-R17W At proposed prod. zone		9. WELL NO. 1		
14. DISTANCE IN MILES AND DIRECTION FROM NEAREST TOWN OR POST OFFICE*		10. FIELD AND POOL, OR WILDCAT Wildcat		
15. DISTANCE FROM PROPOSED* LOCATION TO NEAREST PROPERTY OR LEASE LINE, FT. (Also to nearest drlg. unit line, if any)	16. NO. OF ACRES IN LEASE 1920	17. NO. OF ACRES ASSIGNED TO THIS WELL 80 40		
18. DISTANCE FROM PROPOSED LOCATION* TO NEAREST WELL, DRILLING, COMPLETED, OR APPLIED FOR, ON THIS LEASE, FT.	19. PROPOSED DEPTH 2000'	20. ROTARY OR CABLE TOOLS Rotary		
21. ELEVATIONS (Show whether DF, RT, GR, etc.) 5699' ground		22. APPROX. DATE WORK WILL START* December 18, 1964		
23. PROPOSED CASING AND CEMENTING PROGRAM				
SIZE OF HOLE 9"	SIZE OF CASING 7"	WEIGHT PER FOOT 17#	SETTING DEPTH 30'	QUANTITY OF CEMENT 20 sx.

If productive, will use 4½" casing.



IN ABOVE SPACE DESCRIBE PROPOSED PROGRAM: If proposal is to deepen or plug back, give data on present productive zone and proposed new productive zone. If proposal is to drill or deepen directionally, give pertinent data on subsurface locations and measured and true vertical depths. Give blowout preventer program, if any.

24. SIGNED *W. E. Carter* INDEX FOR: Walter Duncan DATE 12-16-64
(This space for Federal or State office use)

PERMIT NO. _____ APPROVAL DATE _____

APPROVED BY *CM* TITLE _____ DATE _____
CONDITIONS OF APPROVAL, IF ANY:

NEW MEXICO OIL CONSERVATION COMMISSION
WELL LOCATION AND ACREAGE DEDICATION PLAT
SEE INSTRUCTIONS FOR COMPLETING THIS FORM ON THE REVERSE SIDE

FORM C-128
Revised 5/1/57

Operator **Walter Duncan**

Lease **Navajo-Ute-Tribal 14-20-600-3539** Well No. **1**

Unit Letter **Section 25** Township **32 N.** Range **17 W.** County **San Juan**

Actual Footage Location of Well: **2303** feet from the **North** line and **337** feet from the **East** line

Ground Level Elev. **5699'** Producing Formation **Gallup** Pool **Wildcat** Dedicated Acreage: **40** Acres

1. Is the Operator the only owner in the dedicated acreage outlined on the plat below? YES ☒ NO ☐ ("Owner" means the person who has the right to drill into and to produce from any pool and to appropriate the production either for himself or for himself and another. 30-4-29 (NMSA 1955 Comp.)
2. If the answer to question one is "no," have the interests of all the owners been consolidated by agreement or other means? YES ☐ NO ☐ If answer is "yes," Type of Consolidation _____
3. If the answer to question two is "no," list all the owners and their respective interests below:

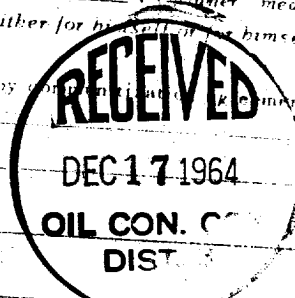

SECTION B

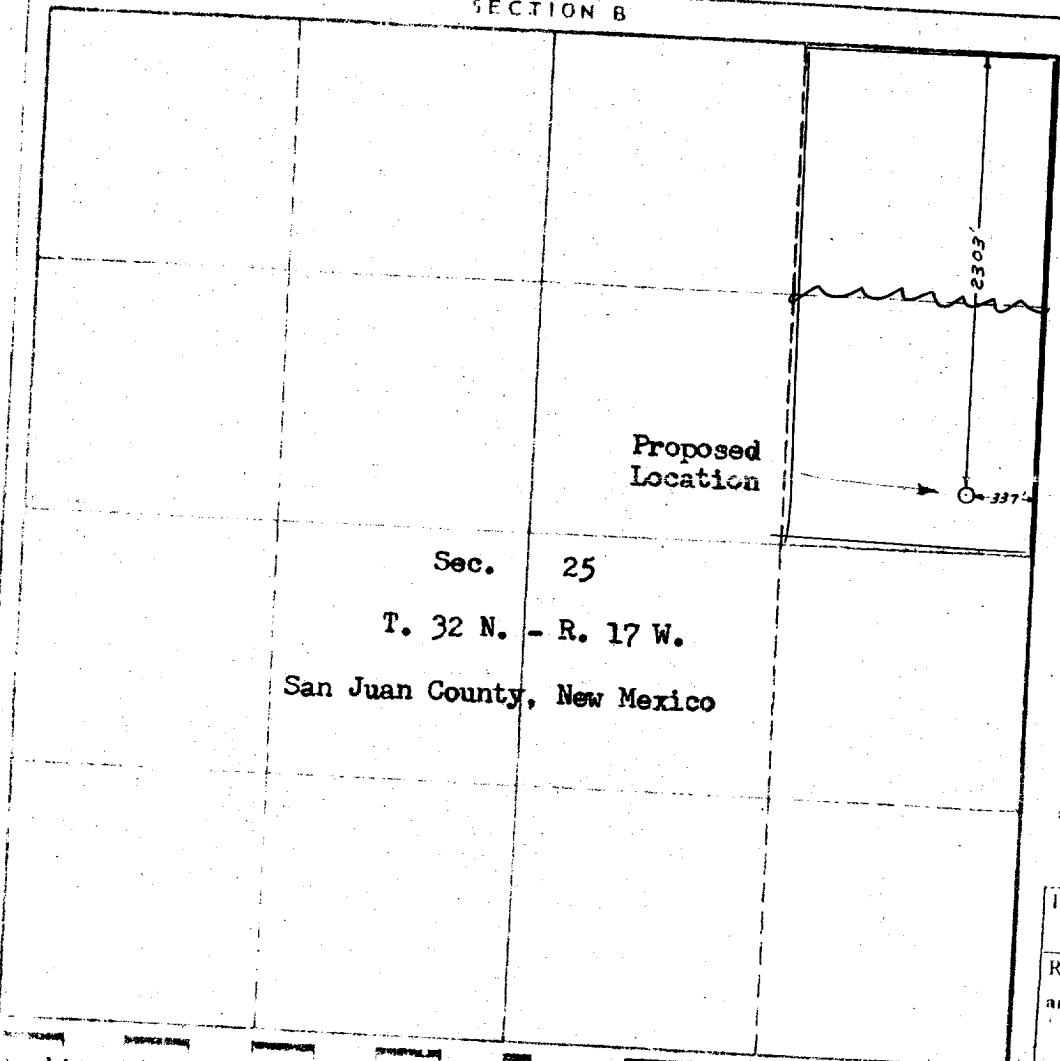

CERTIFICATION

I hereby certify that the information in SECTION A above is true and complete to the best of my knowledge and belief.

Kenneth E. Carter
Name
Position
Geologist
Company
Walter Duncan
Date
Dec. 16, 1964

I hereby certify that the well location shown on the plat in SECTION B was plotted from field notes of actual surveys made by me or under my supervision, and that the same is true and correct to the best of my knowledge and belief.

Date Surveyed
November 25, 1964
Registered Professional Engineer and/or Land Surveyor
Richard H. Hild
Certificate No.
New Mexico 3795

