

UNITED STATES
DEPARTMENT OF THE INTERIOR
GEOLOGICAL SURVEY

13 APPLICATION FOR PERMIT TO DRILL, DEEPEN, OR PLUG BACK

1a. TYPE OF WORK

DRILL ☒DEEPEN ☐PLUG BACK ☐

b. TYPE OF WELL

OIL
WELL ☒GAS
WELL ☐

OTHER

SINGLE
ZONE ☒MULTIPLE
ZONE ☐

2. NAME OF OPERATOR

THE SUPERIOR OIL COMPANY

3. ADDRESS OF OPERATOR

P. O. DRAWER 'G', CORTEZ, COLORADO

4. LOCATION OF WELL (Report location clearly and in accordance with any State requirements.)*

At surface 698' from West line & 2090' from North line Section 26.

At proposed prod. zone As above.

14. DISTANCE IN MILES AND DIRECTION FROM NEAREST TOWN OR POST OFFICE*

33 miles SE of Cortez

15. DISTANCE FROM PROPOSED*

LOCATION TO NEAREST
PROPERTY OR LEASE LINE, FT.
(Also to nearest drlg. line, if any)

590'

18. DISTANCE FROM PROPOSED LOCATION*

TO NEAREST WELL, DRILLING, COMPLETED,
OR APPLIED FOR, ON THIS LEASE, FT.First well
on lease.

16. NO. OF ACRES IN LEASE

1920 Acres

19. PROPOSED DEPTH

1800'

17. NO. OF ACRES ASSIGNED
TO THIS WELL

40 Acres

20. ROTARY OR CABLE TOOLS

Rotary

21. ELEVATIONS (Show whether DF, RT, GR, etc.)

5920' G.L.

22. APPROX. DATE WORK WILL START*

Sept. 9, 1964

23.

PROPOSED CASING AND CEMENTING PROGRAM

SIZE OF HOLE	SIZE OF CASING	WEIGHT PER FOOT	SETTING DEPTH	QUANTITY OF CEMENT
11'	8-5/8"	32	30'	To Surface
6-3/4'	4-1/2"	11.6	1800'	Through productive zones.

Propose to drill a well to the Sanastee-Gallup formation to explore for oil and gas.
Estimated T.D. - 1800'.

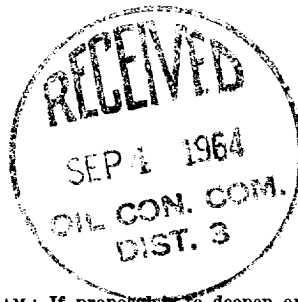

IN ABOVE SPACE DESCRIBE PROPOSED PROGRAM: If proposal is to deepen or plug back, give data on present productive zone and proposed new productive zone. If proposal is to drill or deepen directionally, give pertinent data on subsurface locations and measured and true vertical depths. Give blowout preventer program, if any.

24.

ORIGINAL SIGNED BY
J. C. GORDY

SIGNED

TITLE

Drilling Engineer

DATE

Sept. 2, 1964

(This space for Federal or State office use)

PERMIT NO.

APPROVAL DATE

APPROVED BY

TITLE

DATE

CONDITIONS OF APPROVAL, IF ANY:

*See Instructions On Reverse Side

NUMBER OF COPIES RECEIVED	
DISTRIBUTION	
SANITARY	
FILE	
U.S.G.S.	
LAND OFFICE	
TRANSPORTER	OIL
	GAS
PRODUCTION OFFICE	
OPERATOR	

NEW MEXICO OIL CONSERVATION COMMISSION
WELL LOCATION AND ACREAGE DEDICATION PLAT
 SEE INSTRUCTIONS FOR COMPLETING THIS FORM ON THE REVERSE SIDE

FORM C-128
 Revised 5/1/57

SECTION A

Operator The Superior Oil Company		Lease Navajo-Ute Mountain		Well No. #12-26	
Unit Letter ----	Section 26	Township 32N	Range 17W	County San Juan	
Actual Footage Location of Well: 698 feet from the West line and 2090 feet from the North line					
Ground Level Elev. 5920'	Producing Formation Sanastee-Gallup		Pool Undesignated		Dedicated Acreage: 40 Acres

1. Is the Operator the only owner in the dedicated acreage outlined on the plat below? YES ☒ NO ____ . ("Owner" means the person who has the right to drill into and to produce from any pool and to appropriate the production either for himself or for himself and another. (65-3-29 (e) NMSA 1935 Comp.)
2. If the answer to question one is "no," have the interests of all the owners been consolidated by communization agreement or otherwise? YES ____ NO ____ . If answer is "yes," Type of Consolidation _____
3. If the answer to question two is "no," list all the owners and their respective interests below:

Owner	Land Description

SECTION B

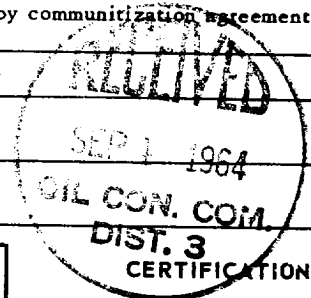
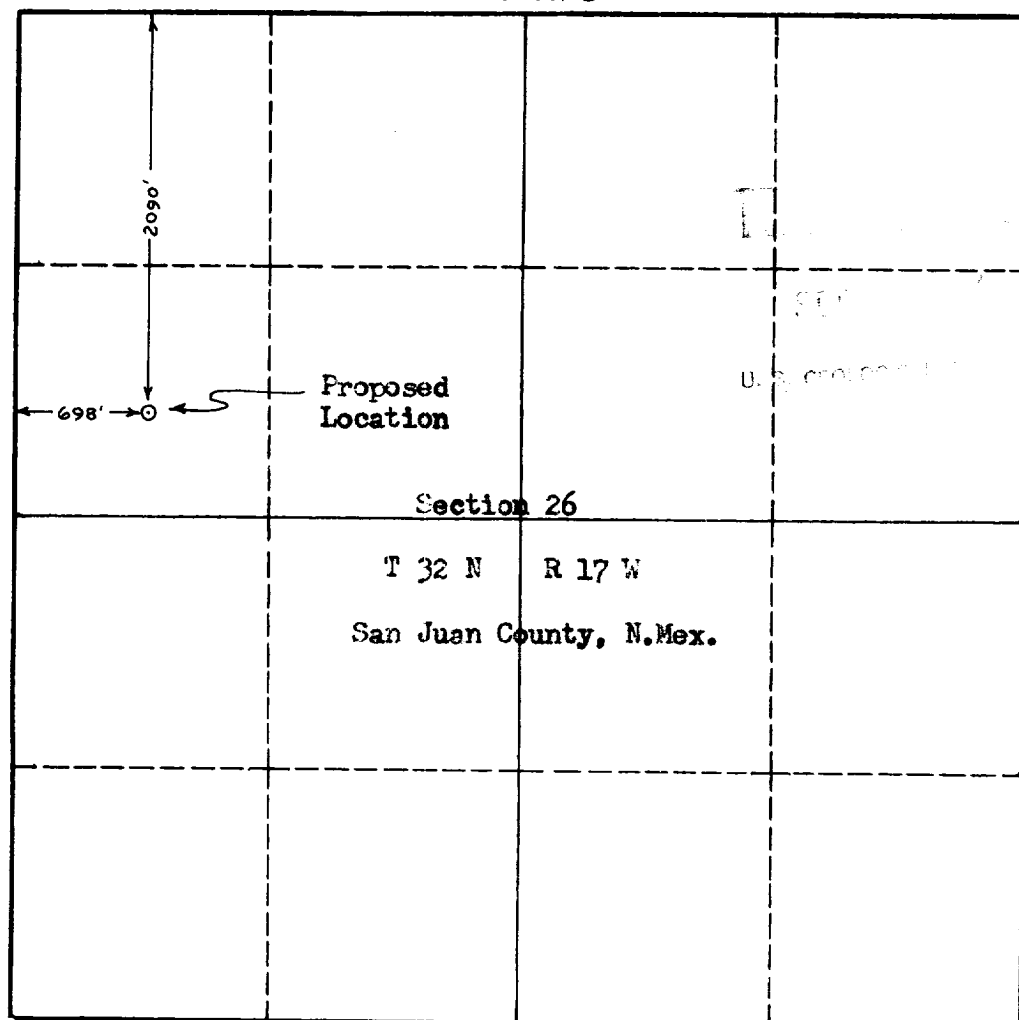

I hereby certify that the information in SECTION A above is true and complete to the best of my knowledge and belief.

Name Jerome C. Gordy
 Position **Drilling Engineer**
 Company **The Superior Oil Company**
 Date **September 2, 1964**

I hereby certify that the well location shown on the plat in SECTION B was plotted from field notes of actual surveys made by me or under my supervision, and that the same is true and correct to the best of my knowledge and belief.

Date Surveyed **June 25, 1964**
 Registered Professional Engineer and/or Land Surveyor
Frederick H. Reed
 Certificate No. **New Mexico #3795**