

(SUBMIT IN TRIPLICATE)

UNITED STATES
DEPARTMENT OF THE INTERIOR
GEOLOGICAL SURVEY

Indian Agency _____
Contract No. **1-149-Ind-7850**
Allottee _____
Lease No. _____

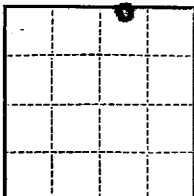

SUNDRY NOTICES AND REPORTS ON WELLS

RECEIVED

NOTICE OF INTENTION TO DRILL	<input checked="" type="checkbox"/>	SUBSEQUENT REPORT OF WATER SHUT-OFF	
NOTICE OF INTENTION TO CHANGE PLANS		SUBSEQUENT REPORT OF SHOOTING OR ACIDIZING	NOV 2 1961
NOTICE OF INTENTION TO TEST WATER SHUT-OFF		SUBSEQUENT REPORT OF ALTERING CASING	
NOTICE OF INTENTION TO REDRILL OR REPAIR WELL		SUBSEQUENT REPORT OF REDRILLING OR REPAIR	
NOTICE OF INTENTION TO SHOOT OR ACIDIZE		SUBSEQUENT REPORT OF ABANDONMENT	
NOTICE OF INTENTION TO PULL OR ALTER CASING		SUPPLEMENTARY WELL HISTORY	
NOTICE OF INTENTION TO ABANDON WELL			

Lease No. **124308**
Astec-Navajo A

(INDICATE ABOVE BY CHECK MARK NATURE OF REPORT, NOTICE, OR OTHER DATA)

October 30, 1961

Well No. **4** is located **600** ft. from **N** line and **1980** ft. from **E** line of sec. **25**

NW/4 NE/4 Sec. 25 T-32-N R-18-W NUTN
(1/4 Sec. and Sec. No.) (Twp.) (Range) (Meridian)

Undesignated San Juan New Mexico
(Field) (County or Subdivision) (State or Territory)

The elevation of the derrick floor above sea level is **2468** ft.

DETAILS OF WORK

(State names of and expected depths to objective sands; show sizes, weights, and lengths of proposed casings; indicate mudding jobs, cementing points, and all other important proposed work)

FORMATIONS EXPECTED:

Top of Gallup 1107'
Total Depth 1800'

SIZE CASING

7-5/8 24# New
4-1/2 9.5# New

CASING PROGRAM (APPROX.)

Set at Cement
105' 50 sz
1140' 100 sz



I understand that this plan of work must receive approval in writing by the Geological Survey before operations may be commenced.

Company **TEXACO Inc.**

Address **P. O. Box 3109**

Midland, Texas

By **J. J. Velten**
Title **Division Civil Engineer**

NEW MEXICO OIL CONSERVATION COMMISSION
WELL LOCATION AND ACREAGE DEDICATION PLAT

FORM C-171
 Revised 2/1/59

SEE INSTRUCTIONS FOR COMPLETING THIS FORM ON THE REVERSE SIDE

SECTION A

Operator TEXACO Inc.			Lease Aztec-Navajo "A"		Well No. 4
Unit Letter B	Section 25	Township 32N	Range 18W	County San Juan,	
Actual Footage Location of Well: 600' feet from the North line and 1980' feet from the East line					
Ground Level Elev. 5457'	Producing Formation Gallup		Pool Undesignated		Dedicated Acreage: 40 Acres

1. Is the Operator the only owner in the dedicated acreage outlined on the plat below? YES X NO ____ . ("Owner" means the person who has the right to drill into and to produce from any pool and to appropriate the production either for himself or for himself and another. (65-3-29 (e) NMSA 1935 Comp.)
2. If the answer to question one is "no," have the interests of all the owners been consolidated by communication agreement or otherwise? YES ____ NO ____ . If answer is "yes," Type of Consolidation _____
3. If the answer to question two is "no," list all the owners and their respective interests below:

Owner	Land Description

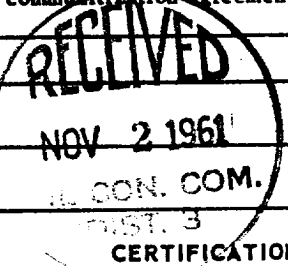

SECTION B

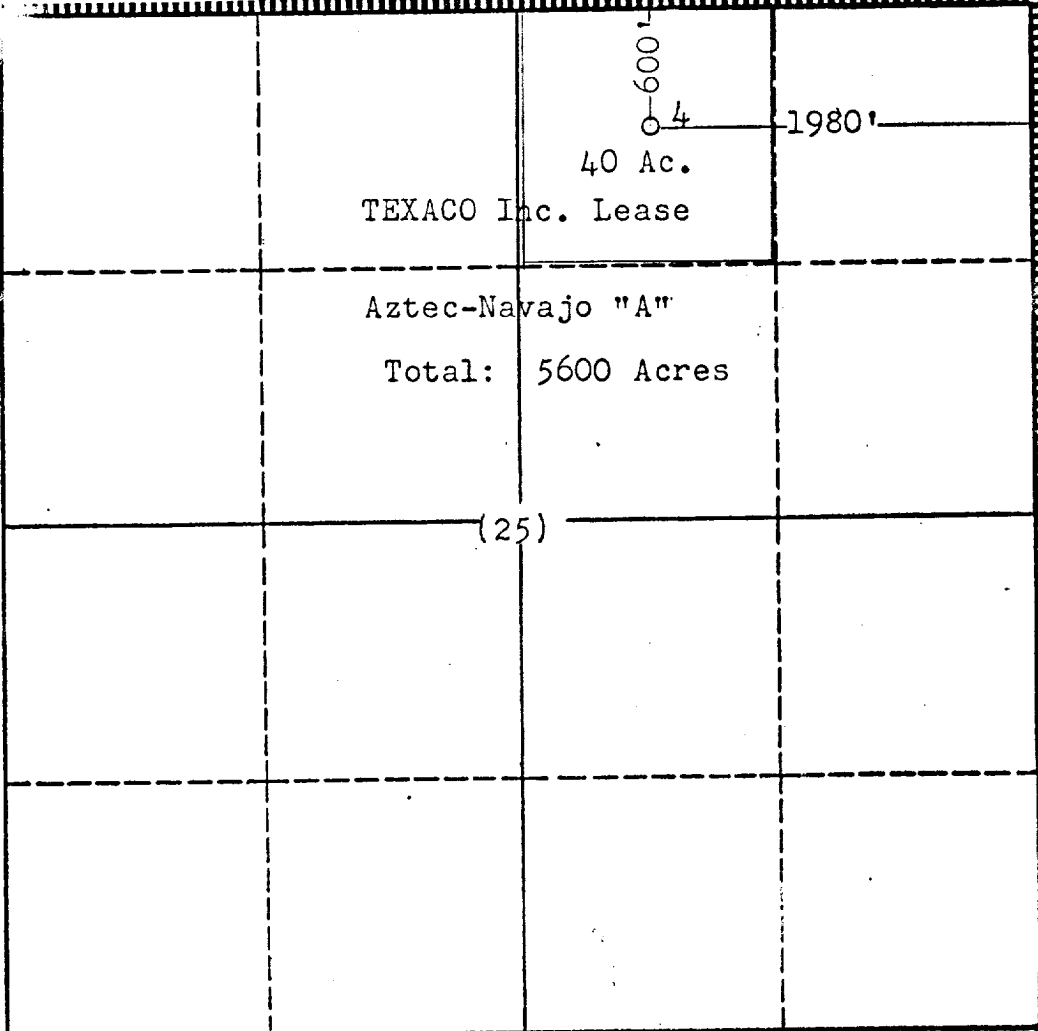

I hereby certify that the information in SECTION A above is true and complete to the best of my knowledge and belief.

Name J. J. Velten
Position Division Civil Engineer
Company TEXACO Inc.
Date 10/30/61

I hereby certify that the well location shown on the plat in SECTION B was plotted from field notes of actual surveys made by me or under my supervision, and that the same is true and correct to the best of my knowledge and belief.

Date Surveyed 10/30/61
Registered Professional Engineer and/or Land Surveyor J. J. Velten

Certificate No. **8174**

