

(SUBMIT IN TRIPLICATE)

Indian Agency .....

UNITED STATES

Contract No. **X-149-Ind-7850**

DEPARTMENT OF THE INTERIOR  
GEOLOGICAL SURVEY

Allottee .....

Lease No. ....

## SUNDRY NOTICES AND REPORTS ON WELLS

NOTICE OF INTENTION TO DRILL	<b>XXX</b>	SUBSEQUENT REPORT OF WATER SHUT-OFF	
NOTICE OF INTENTION TO CHANGE PLANS		SUBSEQUENT REPORT OF SHOOTING OR ACIDIZING	
NOTICE OF INTENTION TO TEST WATER SHUT-OFF		SUBSEQUENT REPORT OF ALTERING CASING	
NOTICE OF INTENTION TO REDRILL OR REPAIR WELL		SUBSEQUENT REPORT OF REDRILLING OR REPAIR	
NOTICE OF INTENTION TO SHOOT OR ACIDIZE		SUBSEQUENT REPORT OF ABANDONMENT	
NOTICE OF INTENTION TO PULL OR ALTER CASING		SUPPLEMENTARY WELL HISTORY	
NOTICE OF INTENTION TO ABANDON WELL			

Lease No. **124328**  
Astec-Navajo A

(INDICATE ABOVE BY CHECK MARK NATURE OF REPORT, NOTICE, OR OTHER DATA)

**November 28**, 19**61**

Well No. **5** is located **510** ft. from **N** line and **1980** ft. from **W** line of sec. **25**

**NE 1/4 NW 1/4 Sec 25 T-32-N R-18-W**

**Undesignated Gallup** **San Juan** **New Mexico**

The elevation of the derrick floor above sea level is **5435** ft.

### DETAILS OF WORK

(State names of and expected depths to objective sands; show sizes, weights, and lengths of proposed casings; indicate mudding jobs, cementing points, and all other important proposed work)

FORMATIONS EXPECTED:	SIZE CASING	CASING PROGRAM (APPROX.)
Top of Gallup 1080		Set at Cement
Total Depth 1150	7-5/8 15.26# 3-1/2 5.75#	100' 50 sz 1080' 100 sz



I understand that this plan of work must receive approval in writing by the Geological Survey before operations may be commenced.

Company **TEXACO Inc.**

Address **P. O. Box 3109**

**Midland, Texas**

By **J. J. Volten**

Title **Division Civil Engineer**

**NEW MEXICO OIL CONSERVATION COMMISSION**  
**WELL LOCATION AND ACREAGE DEDICATION PLAT**

FORM C-128  
 Revised 5/1/57

SEE INSTRUCTIONS FOR COMPLETING THIS FORM ON THE REVERSE SIDE

**SECTION A**

Operator <b>TEXACO Inc.</b>		Lease <b>Aztec-Navajo "A"</b>		Well No. <b>5</b>
Unit Letter <b>C</b>	Section <b>25</b>	Township <b>32 North</b>	Range <b>18 West</b>	County <b>San Juan</b>
Actual Footage Location of Well: <b>610'</b> feet from the <b>North</b> line and <b>1980'</b> feet from the <b>West</b> line <b>Sec. 25</b>				
Ground Level Elev. <b>5424'</b>	Producing Formation <b>Gallup</b>	Pool <b>Undesignated Gallup</b>	Dedicated Acreage: <b>40</b> Acres	

1. Is the Operator the only owner in the dedicated acreage outlined on the plat below? YES X NO \_\_\_\_ . ("Owner" means the person who has the right to drill into and to produce from any pool and to appropriate the production either for himself or for himself and another. (65-3-29 (e) NMSA 1935 Comp.)
2. If the answer to question one is "no," have the interests of all the owners been consolidated by communitization agreement or otherwise? YES \_\_\_\_ NO \_\_\_\_ . If answer is "yes," Type of Consolidation \_\_\_\_\_
3. If the answer to question two is "no," list all the owners and their respective interests below:

Owner	Land Description

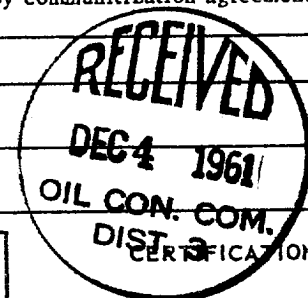

**SECTION B**

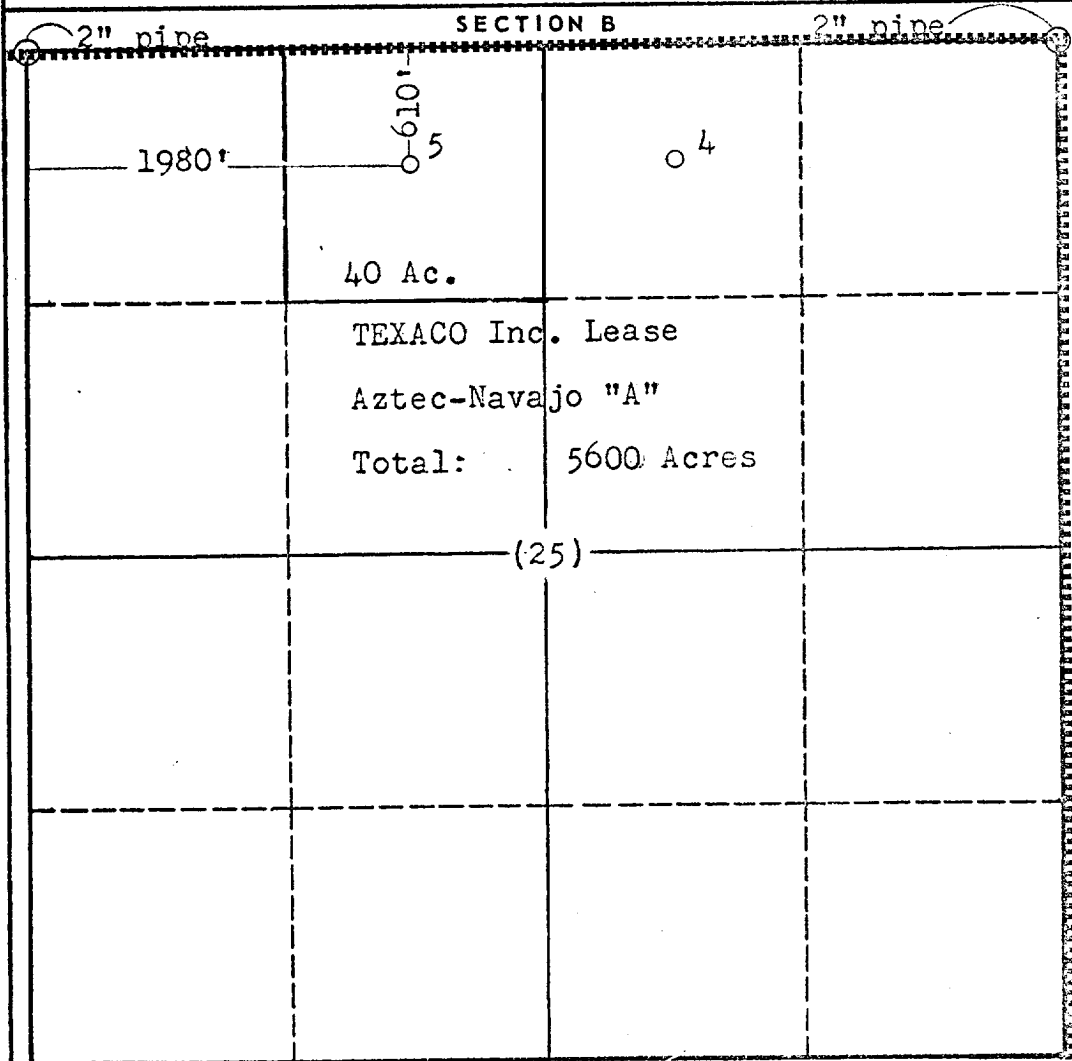

I hereby certify that the information in SECTION A above is true and complete to the best of my knowledge and belief.

Name J. J. Velten  
 Position Division Civil Engineer  
 Company TEXACO Inc.  
 Date 11/27/61

I hereby certify that the well location shown on the plat in SECTION B was plotted from field notes of actual surveys made by me or under my supervision, and that the same is true and correct to the best of my knowledge and belief.

Date Surveyed 11/25/61  
 Registered Professional Engineer and/or Land Surveyor J. J. Velten  
 Certificate No. 8174

0 330 660 990 1320 1650 1980 2310 2640 2000 1500 1000 500 0