

(SUBMIT IN TRIPLICATE)

UNITED STATES  
DEPARTMENT OF THE INTERIOR  
GEOLOGICAL SURVEY

Budget Bureau No. 42-R350.4.  
Approval expires 12-31-60.

Indian Agency Navajo  
Window Rock, Arizona  
Allottee \_\_\_\_\_  
Lease No. 14-20-603-584

SUNDRY NOTICES AND REPORTS ON WELLS

NOTICE OF INTENTION TO DRILL	<input checked="" type="checkbox"/>	SUBSEQUENT REPORT OF WATER SHUT-OFF	
NOTICE OF INTENTION TO CHANGE PLANS		SUBSEQUENT REPORT OF SHOOTING OR ACIDIZING	
NOTICE OF INTENTION TO TEST WATER SHUT-OFF		SUBSEQUENT REPORT OF ALTERING CASING	
NOTICE OF INTENTION TO REDRILL OR REPAIR WELL		SUBSEQUENT REPORT OF REDRILLING OR REPAIR	
NOTICE OF INTENTION TO SHOOT OR ACIDIZE		SUBSEQUENT REPORT OF ABANDONMENT	
NOTICE OF INTENTION TO PULL OR ALTER CASING		SUPPLEMENTARY WELL HISTORY	
NOTICE OF INTENTION TO ABANDON WELL			

(INDICATE ABOVE BY CHECK MARK NATURE OF REPORT, NOTICE, OR OTHER DATA)

NAVAJO TRIBAL "C"

February 26, 19 62

Well No. 1 is located 2310 ft. from S line and 660 ft. from W line of sec. 24

SW/4 Section 24 32-N 18-W  
(1/4 Sec. and Sec. No.) (Twp.) (Range) (Meridian)

Undesignated San Juan New Mexico  
(Field) (County or Subdivision) (State or Territory)

The elevation of the derrick floor above sea level is \_\_\_\_\_ ft. 5435 G.L.

DETAILS OF WORK

(State names of and expected depths to objective sands; show sizes, weights, and lengths of proposed casings; indicate mudlogging points, and all other important proposed work)

Estimated Total Depth 1,500'  
Objective Sand - Gallup - Estimated Top 1,329'  
Type of Rig - Rotary with Air  
Mud Program - Mud up to drill through objective sand  
Set 7" @ 60' cemented to surface  
Set 4 1/2" 11.4# J-55 casing through production zone with cement to protect producing zone.

I understand that this plan of work must receive approval in writing by the Geological Survey before operations may be commenced.

Company TEXAS PACIFIC COAL AND OIL COMPANY

Address P. O. Box 2110  
Fort Worth 1, Texas

By [Signature]  
Title Manager of Production

10/10/1981

10/10/1981

10/10/1981

10/10/1981

10/10/1981

# 10/10/1981

10/10/1981

10/10/1981

10/10/1981

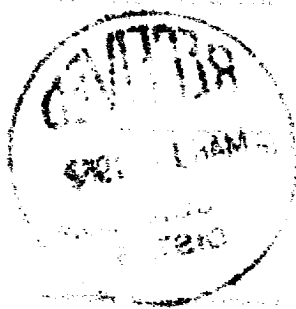

10/10/1981

10/10/1981

10/10/1981

10/10/1981

10/10/1981

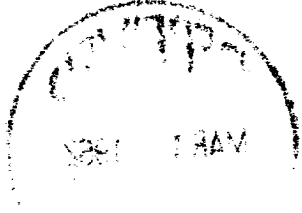

10/10/1981

10/10/1981

10/10/1981

10/10/1981

10/10/1981

10/10/1981

Well Location and Acreage Dedication Plat

Section A.

Date \_\_\_\_\_

Operator TEXAS PACIFIC COAL AND OIL COMPANY Lease NAVAJO  
 Well No. 1 Unit Letter L Section 24 Township 32 NORTH Range 18 WEST, NMPM  
 Located 2310 Feet From the SOUTH Line, 660 Feet From the WEST Line  
 County SAN JUAN G. L. Elevation 5435.0 Dedicated Acreage 40 Acres  
 Name of Producing Formation Gallup Pool Undesignated

1. Is the Operator the only owner in the dedicated acreage outlined on the plat below?  
 Yes \_\_\_\_\_ No X
2. If the answer to question one is "no", have the interests of all the owners been consolidated by communitization agreement or otherwise? Yes X No \_\_\_\_\_. If answer is "yes", Type of Consolidation.

Operating Agreement

3. If the answer to question two is "no", list all the owners and their respective interests below:

OwnerLand Description

\_\_\_\_\_  
 \_\_\_\_\_  
 \_\_\_\_\_

\_\_\_\_\_  
 \_\_\_\_\_  
 \_\_\_\_\_

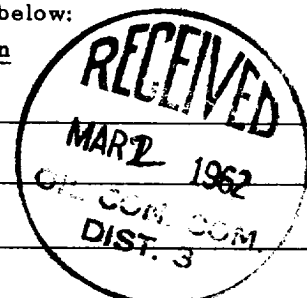

Section B.

This is to certify that the information in Section A above is true and complete to the best of my knowledge and belief.

TEXAS PACIFIC COAL AND OIL CO.

(Operator)

(Representative)

P.O. Box 5110, Fort Worth 1, Texas

(Address)

Note: All distances must be from outer boundaries of section.

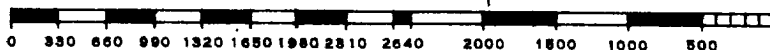
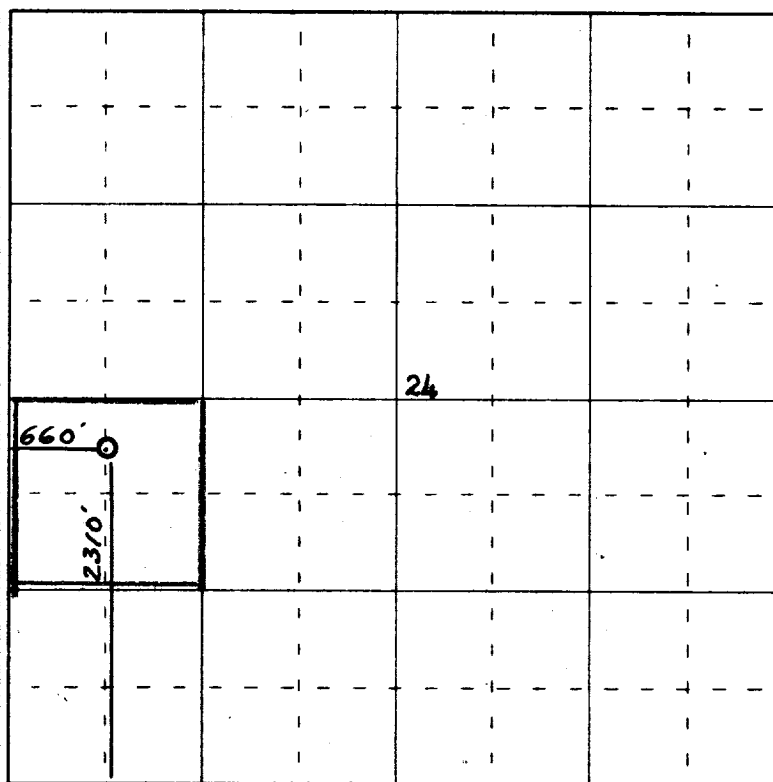

Scale 4 inches equal 1 mile

This is to certify that the above plat was prepared from field notes of actual surveys made by me or under my supervision and that the same are true and correct to the best of my knowledge and belief.

Date Surveyed 14 February 1962

James P. Leese  
 Registered Professional Engineer and/or Land Surveyor  
 James P. Leese N. Mex. Reg. No. 1463  
 San Juan Engineering Company

(Seal)  
 Farmington, New Mexico