

(SUBMIT IN TRIPLICATE)

Indian Agency Navajo

UNITED STATES  
DEPARTMENT OF THE INTERIOR  
GEOLOGICAL SURVEY

Window Rock, Arizona

Allottee Navajo

Lease No. 14-20-603-584

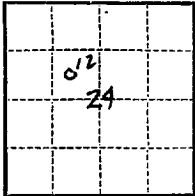

SUNDRY NOTICES AND REPORTS ON WELLS

NOTICE OF INTENTION TO DRILL	<input checked="" type="checkbox"/>	SUBSEQUENT REPORT OF WATER SHUT-OFF	
NOTICE OF INTENTION TO CHANGE PLANS		SUBSEQUENT REPORT OF SHOOTING OR ACIDIZING	
NOTICE OF INTENTION TO TEST WATER SHUT-OFF		SUBSEQUENT REPORT OF ALTERING CASING	
NOTICE OF INTENTION TO REDRILL OR REPAIR WELL		SUBSEQUENT REPORT OF REDRILLING OR REPAIR	
NOTICE OF INTENTION TO SHOOT OR ACIDIZE		SUBSEQUENT REPORT OF ABANDONMENT	
NOTICE OF INTENTION TO PULL OR ALTER CASING		SUPPLEMENTARY WELL HISTORY	
NOTICE OF INTENTION TO ABANDON WELL			

(INDICATE ABOVE BY CHECK MARK NATURE OF REPORT, NOTICE, OR OTHER DATA)

January 27, 1962

Well No. 12 Navajo is located 2015 ft. from N line and 1755 ft. from W line of sec. 24

NW 1/4 Section 24 (1/4 Sec. and Sec. No.)  
32N 18W 18W (Twp.) (Range) (Meridian)  
Undesignated San Juan County New Mexico  
(Field) (County or Subdivision) (State or Territory)

The elevation of the derrick floor above sea level is 5676 ft.

DETAILS OF WORK

(State names of and expected depths to objective sands; show sizes, weights, and lengths of proposed casings; indicate mudding jobs, cementing points, and all other important proposed work)

Set approximately 30 feet of 7" - 23# surface pipe with 7 sacks cement, pilot drill ahead 250 feet with 6-1/4" bit to see if air drilling possible. Drill with either air or drilling mud to test Tecite sandstone at about 1500 feet, drill ahead to 1550 feet, run electric log, plug and abandon or run 4-1/2" production string to be cemented with 50 sacks based on results of Tecite core or electric log analysis.

*Callup*



I understand that this plan of work must receive approval in writing by the Geological Survey before operations may be commenced.

Company Exploration Drilling Company

Address 910 Petroleum Club Building  
Denver 2, Colorado

By Ross E. Wells  
Ross E. Wells  
Title Exploration Manager



# NEW MEXICO OIL CONSERVATION COMMISSION

## Well Location and Acreage Dedication Plat

## SECTION A.

Date **January 25, 1962**

Operator **Exploration Drilling Company** Lease \_\_\_\_\_  
 Well No. **22** Unit Letter \_\_\_\_\_ Section **24** Township **32 North** Range **18 West** NMPM  
 Located **2015** Feet From **North** Line, **1755** Feet From **West** Line  
 County **San Juan** G. L. Elevation **5672** Dedicated Acreage **80** Acres  
 Name of Producing Formation **Gallego-Gravel Sand** Pool **Undesignated**

1. Is the Operator the only owner\* in the dedicated acreage outlined on the plat below? Yes \_\_\_\_\_ No **1**
2. If the answer to question One is "No," have the interests of all the owners been consolidated by communitization agreement or otherwise? Yes **1** No \_\_\_\_\_. If answer is "Yes," Type of Consolidation **Assignment of Operating Rights (1961) above San Juan State Taxes Pesticide and Murphy Corporation**
3. If the answer to question Two is "No," list all the owners and their respective interests below:

OWNER

LAND DESCRIPTION

## SECTION B.

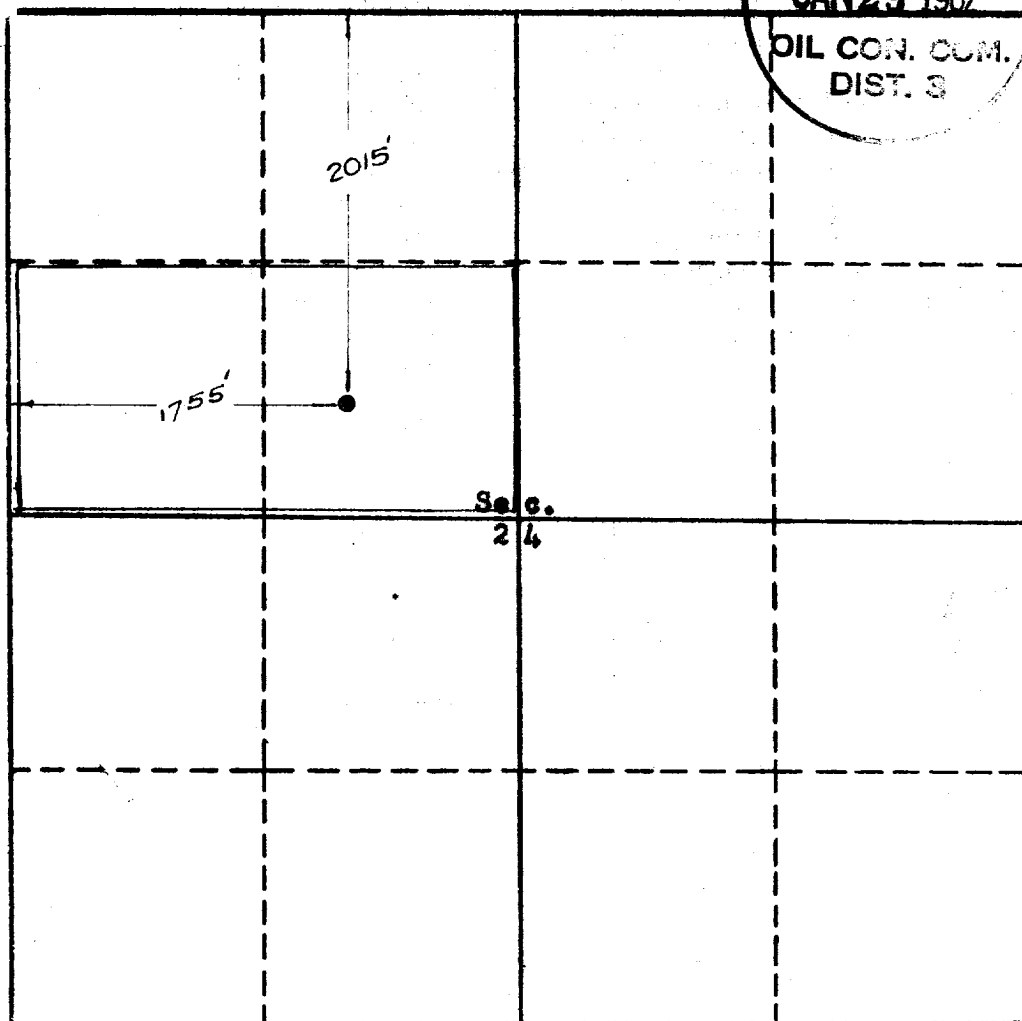

RECEIVED

JAN 29 1962

OIL CON. COM.  
DIST. 3

RECEIVED

JAN 29 1962

This is to certify that the information in Section A above is true and complete to the best of my knowledge and belief.

**Exploration Drilling Company**

(OPERATOR)

*Ross E. Wells*

**Ross E. Wells** (REPRESENTATIVE)  
**916 Petroleum Club Building**  
**Denver 2, Colorado**

(ADDRESS)

This is to certify that the well location shown on the plat in Section B was plotted from field notes of actual surveys made by me or under my supervision and that the same is true and correct to the best of my knowledge and belief.

Date Surveyed **Dec. 23, 1961**

**Four States Engineering Co.**  
 FARMINGTON, NEW MEXICO

*[Signature]*  
 REGISTERED ENGINEER OR  
 LAND SURVEYOR

Certificate No. **178**