

(SUBMIT IN TRIPLICATE)

UNITED STATES
DEPARTMENT OF THE INTERIOR
GEOLOGICAL SURVEY

Approval expires 12-31-60.
Indian Agency Navajo Tribe
Window Rock, Arizona
Allottee Navajo
Lease No. 14-20-603-584

SUNDRY NOTICES AND REPORTS ON WELLS

NOTICE OF INTENTION TO DRILL	<input checked="" type="checkbox"/>	SUBSEQUENT REPORT OF WATER SHUT-OFF
NOTICE OF INTENTION TO CHANGE PLANS		SUBSEQUENT REPORT OF SHOOTING OR ACIDIZING
NOTICE OF INTENTION TO TEST WATER SHUT-OFF		SUBSEQUENT REPORT OF ALTERING CASING
NOTICE OF INTENTION TO REDRILL OR REPAIR WELL		SUBSEQUENT REPORT OF REDRILLING OR REPAIR
NOTICE OF INTENTION TO SHOOT OR ACIDIZE		SUBSEQUENT REPORT OF ABANDONMENT
NOTICE OF INTENTION TO PULL OR ALTER CASING		SUPPLEMENTARY WELL HISTORY
NOTICE OF INTENTION TO ABANDON WELL		

(INDICATE ABOVE BY CHECK MARK NATURE OF REPORT, NOTICE, OR OTHER DATA)

Well No. 48 Navajo is located 950 ft. from N line and 330 ft. from E line of sec. 23
NE 1/4 Section 23 32N 18W NMPM
(1/4 Sec. and Sec. No.) (Twp.) (Range) (Meridian)
Undesignated San Juan County New Mexico
(Field) (County or Subdivision) (State or Territory)

The elevation of the derrick floor above sea level is 5425 ft.

DETAILS OF WORK

(State names of and expected depths to objective sands; show sizes, weights, and lengths of proposed casings; indicate mudlogging jobs, cementing points, and all other important proposed work)

Set approximately 30 feet of 7" - 23# surface casing with six sacks cement. Pilot drill ahead to 100 feet with 6-1/4" bit to see if air drilling possible. Drill with either air or drilling mud to test Tecite sandstone at about 1435 feet, drill ahead to 1500 feet and run electric log, plug and abandon or run 4-1/2" production string on results of Tecite core or electric log analysis.

If 4-1/2" production string is run, will cement with 50 sacks.

I understand that this plan of work must receive approval in writing by the Geological Survey before operations may be commenced.

Company Exploration Drilling Company

Address 910 Petroleum Club Building

Denver 2, Colorado

By Ross E. Wells

Title Exploration Manager

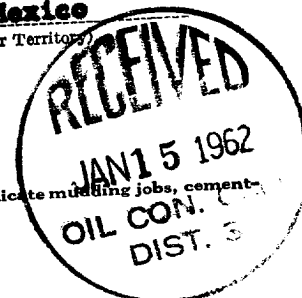

NEW MEXICO OIL CONSERVATION COMMISSION

Well Location and Acreage Dedication Plat

SECTION A.

Date December 26, 1961

Operator Exploration Drilling Company Lease _____
 Well No. #8 Unit Letter _____ Section 23 Township 32 North Range 18 West NMPM
 Located 950 Feet From North Line, 330 Feet From East Line
 County San Juan G. L. Elevation 5621 Dedicated Acreage 42.00 Acres
 Name of Producing Formation Selling-Drill-2nd Pool Undesignated

1. Is the Operator the only owner* in the dedicated acreage outlined on the plat below? Yes _____ No X
2. If the answer to question One is "No," have the interests of all the owners been consolidated by communization agreement or otherwise? Yes X No _____. If answer is "Yes," Type of Consolidation Assignment of Operating Rights (1961) above Sanction from Texas Pacific and Murphy Corporation.
3. If the answer to question Two is "No," list all the owners and their respective interests below:

OWNER

LAND DESCRIPTION

SECTION B.

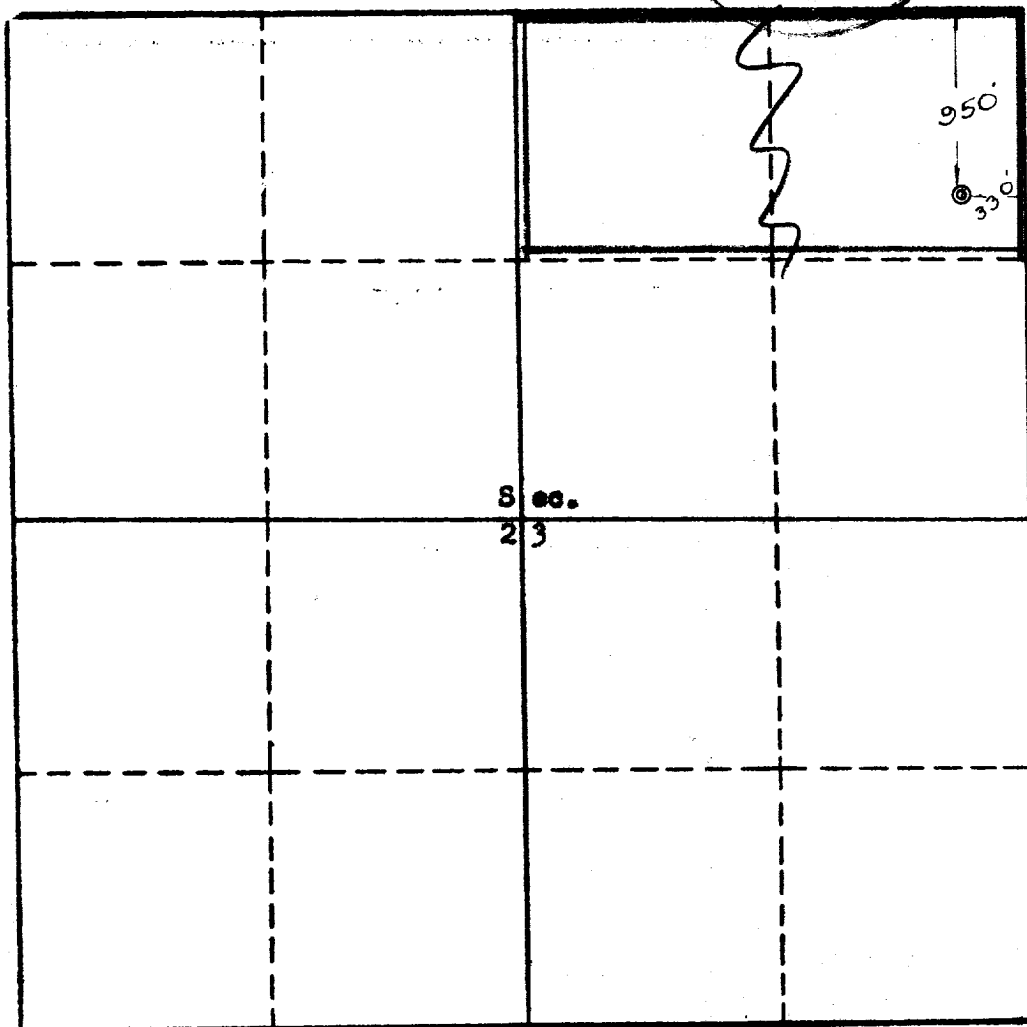

U.S. GEOLOGICAL SURVEY

This is to certify that the information in Section A above is true and complete to the best of my knowledge and belief.

Exploration Drilling Company
(OPERATOR)

Ross E. Wells
(REPRESENTATIVE)

Ross E. Wells
910 Petroleum Club Building
Denver 2, Colorado
(ADDRESS)

This is to certify that the well location shown on the plat in Section B was plotted from field notes of actual surveys made by me or under my supervision and that the same is true and correct to the best of my knowledge and belief.

Date Surveyed Dec. 26, 1961

Four States Engineering Co.
FARMINGTON, NEW MEXICO

John H. Hildebrand
REGISTERED ENGINEER
LAND SURVEYOR

Certificate No. 578