

Form 9-331b
(April 1952)

(SUBMIT IN TRIPLICATE)

Indian Agency **Havasupai Tribe**

Window Rock, Arizona

Allottee **Havasupai**

Lease No. **14-20-402-204**

UNITED STATES
DEPARTMENT OF THE INTERIOR
GEOLOGICAL SURVEY

		0

SUNDRY NOTICES AND REPORTS ON WELLS

RECEIVED

NOTICE OF INTENTION TO DRILL	SUBSEQUENT REPORT OF WATER SHUT-OFF
NOTICE OF INTENTION TO CHANGE PLANS	SUBSEQUENT REPORT OF SHOOTING OR ACIDIZING
NOTICE OF INTENTION TO TEST WATER SHUT-OFF	SUBSEQUENT REPORT OF ALTERING CASING
NOTICE OF INTENTION TO REDRILL OR REPAIR WELL	SUBSEQUENT REPORT OF REDRILLING OR REPAIR
NOTICE OF INTENTION TO SHOOT OR ACIDIZE	SUBSEQUENT REPORT OF ABANDONMENT
NOTICE OF INTENTION TO PULL OR ALTER CASING	SUPPLEMENTARY WELL HISTORY
NOTICE OF INTENTION TO ABANDON WELL	POSTAGE LOCATION CHANGE

(INDICATE ABOVE BY CHECK MARK NATURE OF REPORT, NOTICE, OR OTHER DATA)

January 24

1962

Well No. **11** **Havasupai** is located **330** ft. from **N** line and **1450** ft. from **E** line of sec. **23**

Section 23 (1/4 Sec. and Sec. No.) **33N** (Twp.) **10W** (Range) **11N** (Meridian)
Undesignated (Field) **San Juan** (County or Subdivision) **New Mexico** (State or Territory)

The elevation of the derrick floor above sea level is **5450** ft.

DETAILS OF WORK

(State names of and expected depths to objective sands; show sizes, weights, and lengths of proposed casings; indicate mudding jobs, cementing points, and all other important proposed work)

Postage location carried on Intention to Drill, approved January 12, 1962 (400' FWL and 1450' FWL), was found to be in rough topography that would cause unusual amount of bulldozing and location work. Moved to North and 10 feet East to remedy, as reported above.

I understand that this plan of work must receive approval in writing by the Geological Survey before operations may be commenced.

Company **EXPLORATION DRILLING COMPANY**

Address **912 Petroleum Club Building**

Denver 2, Colorado

By **Ross C. Wells**

Title **Exploration Mgr.**

NEW MEXICO OIL CONSERVATION COMMISSION

Well Location and Acreage Dedication Plat

SECTION A.

Date _____

Operator Exploration Drilling Company Lease _____
 Well No. _____ Unit Letter _____ Section 23 Township 32 North Range 18 West NMPM
 Located 330 Feet From North Line, 1650 Feet From East Line
 County San Juan G. L. Elevation 5420 Dedicated Acreage _____ Acres
 Name of Producing Formation _____ Pool _____

1. Is the Operator the only owner* in the dedicated acreage outlined on the plat below? Yes _____ No _____
2. If the answer to question One is "No," have the interests of all the owners been consolidated by communization agreement or otherwise? Yes _____ No _____. If answer is "Yes," Type of Consolidation _____
3. If the answer to question Two is "No," list all the owners and their respective interests below:

OWNER

LAND DESCRIPTION

RECEIVED
 JAN 31 1962

SECTION B.

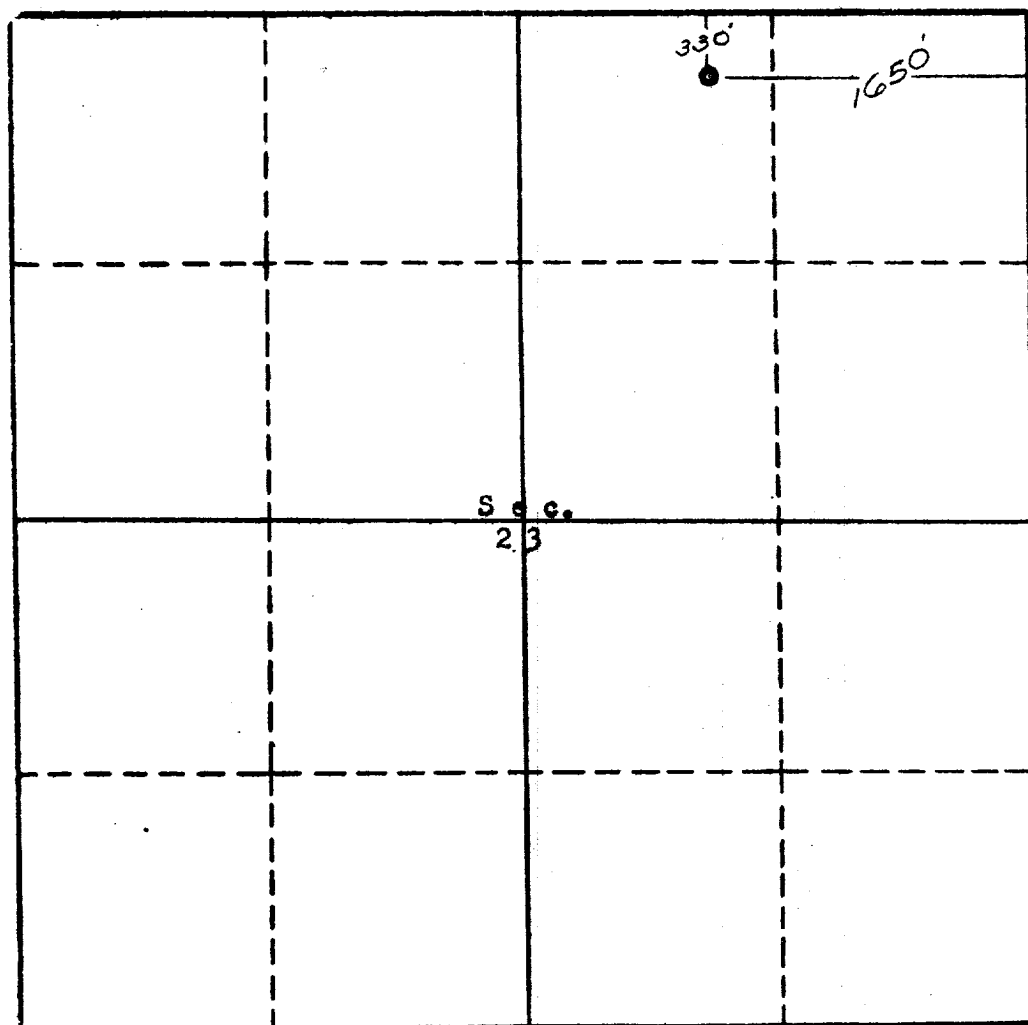

U. S. GEOLOGICAL SURVEY

This is to certify that the information in Section A above is true and complete to the best of my knowledge and belief.

(OPERATOR)

(REPRESENTATIVE)

(ADDRESS)

This is to certify that the well location shown on the plat in Section B was plotted from field notes of actual surveys made by me or under my supervision and that the same is true and correct to the best of my knowledge and belief.

Date Surveyed January 20, 1962

Four States Engineering Co.
 FARMINGTON, NEW MEXICO

[Signature]
 REGISTERED ENGINEER OF
 LAND SURVEYOR

Certificate No. 578