

NEW MEXICO OIL CONSERVATION COMMISSION

Well Location and Acreage Dedication Plat

SECTION A.

Date 9-15-61

Operator AMALGAMATED PETROLEUM COMPANY

Lease Navajo No. 14-20-603-584

Well No. 4 Navajo Unit Letter J Section 14 Township 32 NORTH Range 18 WEST NMPM

Located 1650 Feet From THE SOUTH Line, 1710 Feet From THE EAST Line

County SAN JUAN G. L. Elevation 5347 Dedicated Acreage 40 Acres

Name of Producing Formation Gallup Pool Unnamed

1. Is the Operator the only owner* in the dedicated acreage outlined on the plat below? Yes ☒ No ☐
2. If the answer to question One is "No," have the interests of all the owners been consolidated by communication agreement or otherwise? Yes ☐ No ☐ If answer is "Yes," Type of Consolidation ☐
3. If the answer to question Two is "No," list all the owners and their respective interests below:

OWNER

Amalgamated Petroleum Co.

LAND DESCRIPTION

NW-1/4 SE-1/4 Section 14

RECEIVED
SEP

SECTION B.

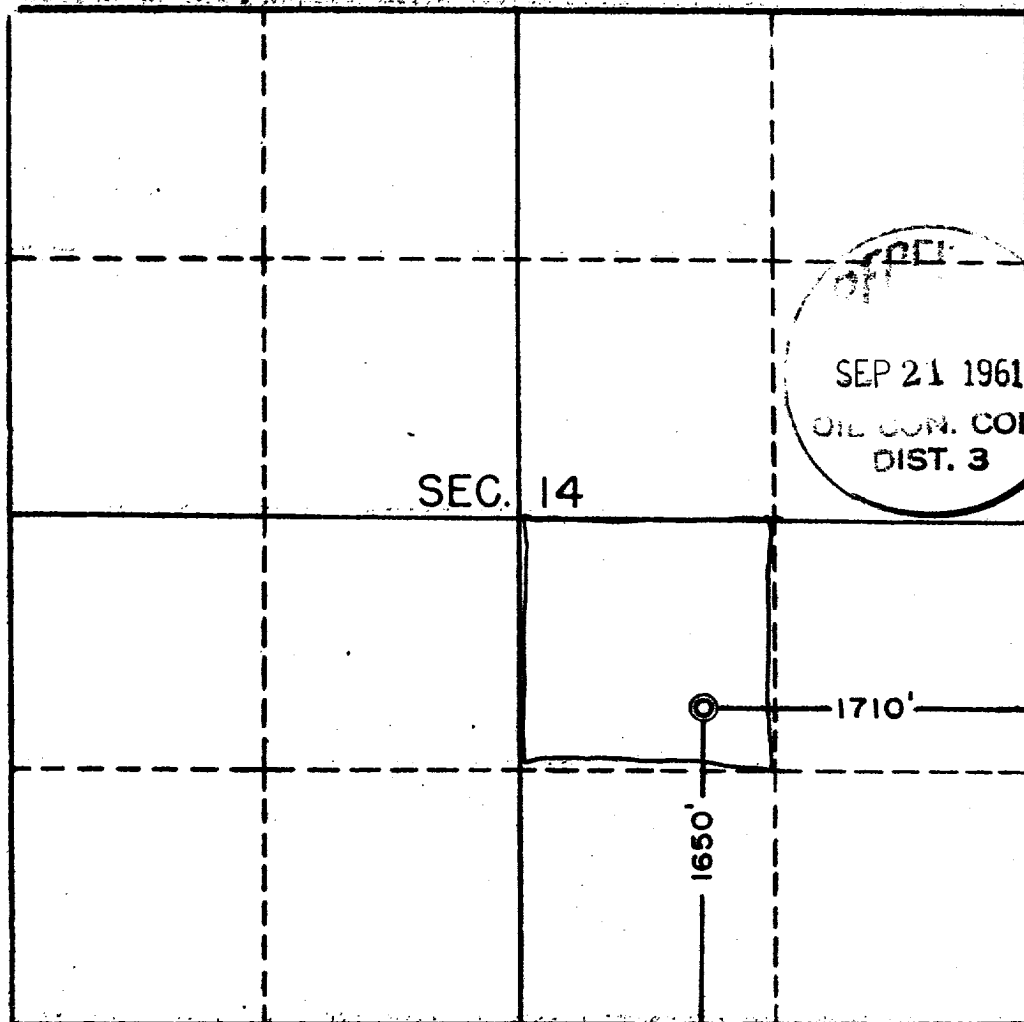

This is to certify that the information in Section A above is true and complete to the best of my knowledge and belief.

Amalgamated Petroleum Co.
(OPERATOR)

C. I. Mann
(REPRESENTATIVE)

750 West 48th Ave., Denver 16

This is to certify that the information shown on the plat in Section B was plotted from actual surveying under my supervision and is true and correct to the best of my knowledge and belief.

Date Surveyed JULY 25, 1961

Four States Engineering Co.
FARMINGTON, NEW MEXICO

C. S. Poteet
REGISTERED ENGINEER OR
LAND SURVEYOR

Certificate No. 3084 N. M.

