

Form 9-831a
(Feb. 1951)

(SUBMIT IN TRIPLICATE)

UNITED STATES
DEPARTMENT OF THE INTERIOR
GEOLOGICAL SURVEY

Land Office Santa Fe
Lease No. 078117
Unit _____

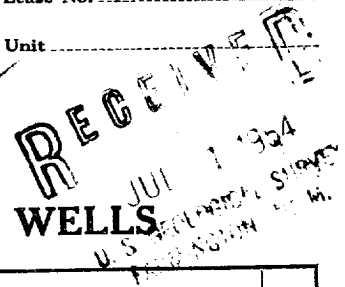

SUNDRY NOTICES AND REPORTS ON WELLS

NOTICE OF INTENTION TO DRILL	<input checked="" type="checkbox"/>	SUBSEQUENT REPORT OF WATER SHUT-OFF	
NOTICE OF INTENTION TO CHANGE PLANS		SUBSEQUENT REPORT OF SHOOTING OR ACIDIZING	
NOTICE OF INTENTION TO TEST WATER SHUT-OFF		SUBSEQUENT REPORT OF ALTERING CASING	
NOTICE OF INTENTION TO RE-DRILL OR REPAIR WELL		SUBSEQUENT REPORT OF REDRILLING OR REPAIR	
NOTICE OF INTENTION TO SHOOT OR ACIDIZE		SUBSEQUENT REPORT OF ABANDONMENT	
NOTICE OF INTENTION TO PULL OR ALTER CASING		SUPPLEMENTARY WELL HISTORY	
NOTICE OF INTENTION TO ABANDON WELL			

(INDICATE ABOVE BY CHECK MARK NATURE OF REPORT, NOTICE, OR OTHER DATA)

June 29, 1954

Well No. Horton #3 is located 1,850 ft. from N line and 1,550 ft. from E line of sec. 13

N/2 13 32 N 12W N. M. P. M.
(1/4 Sec. and Sec. No.) (Twp.) (Range) (Meridian)
Blanco San Juan New Mexico
(Field) (County or Subdivision) (State or Territory)

The elevation of the derrick floor above sea level is 6454.4 ft.

DETAILS OF WORK

(State names of and expected depths to objective sands; show sizes, weights, and lengths of proposed casings; indicate mudlogging jobs, cementing points, and all other important proposed work)

We propose to drill with rotary tools to top of Cliff House and set pipe- and drill with rotary using gas through Cliff House, Manefee and Point Lookout- if available - if not, cable tools, shoot - clean out for gas completion in Mesa verde formation.

Casing program:
200' - 10 3/4 cemented to surface
4800' - 7" or 5 1/2 cemented w/200 sxs.
5500' - 2" tubing

I understand that this plan of work must receive approval in writing by the Geological Survey before operations may be commenced.

Company Kenneth Murchison

Address Rm. 315, 1315 Pacific
Dallas, Texas

By E. F. Gesinger
Title Superintendent

Company.....Kenneth Murchison.....

Lease..... Well No.....

Sec. 13 , T. 32 N. , R. 12 W. , N.M.P.M.

Location.....1850' from the North line and 1550' from the East line.

Elevation.....6454.4 Ungraded ground.

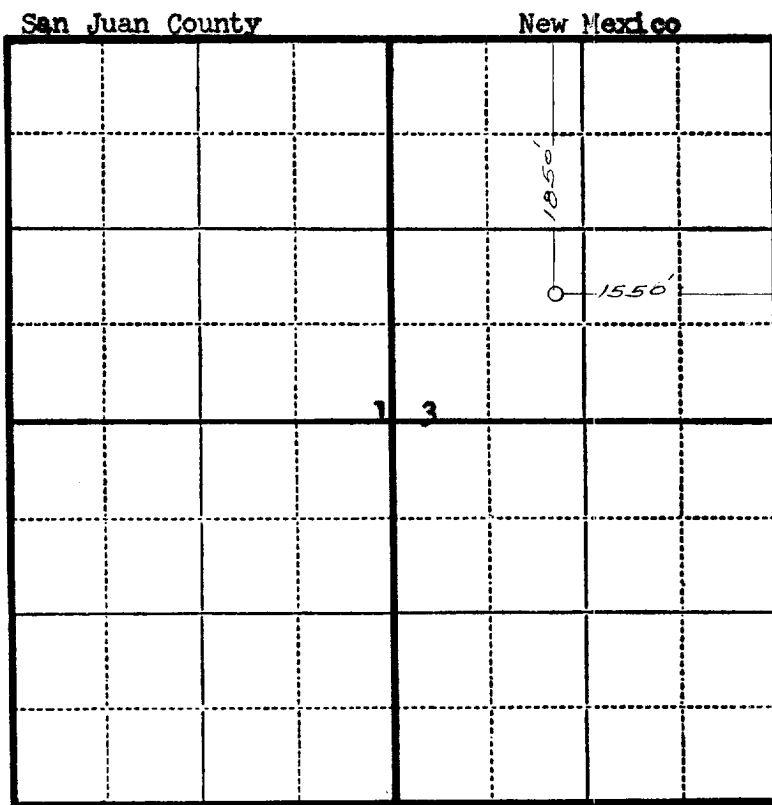

Scale—4 inches equal 1 mile.

This is to certify that the above plat was prepared from field notes of actual surveys made by me or under my supervision and that the same are true and correct to the best of my knowledge and belief.

Charles J. Finklea

Seal:

Registered Professional
Engineer and Land Surveyor.

Charles J. Finklea
N. Mex. Reg. No. 1302

Surveyed October 13 , 1952

RECEIVED
Jul. 6, 1954
OCT 23 1952
U. S. GEOLOGICAL SURVEY
SACRAMENTO, N. M.