

UNITED STATES
DEPARTMENT OF THE INTERIOR
GEOLOGICAL SURVEY

APPLICATION FOR PERMIT TO DRILL, DEEPEN, OR PLUG BACK

1a. TYPE OF WORK

DRILL ☒

DEEPEEN ☐

PLUG BACK ☐

b. TYPE OF WELL
OIL ☒
WELL

GAS WELL ☐

OTHER ☐

2. NAME OF OPERATOR

Curtis J. Little

3. ADDRESS OF OPERATOR

2929 Monte Vista NE, Albuquerque, New Mexico

4. LOCATION OF WELL (Report location clearly and in accordance with any State requirements.)*

At surface

1650' FWL 2310' FNL

At proposed prod. zone

Same

14. DISTANCE IN MILES AND DIRECTION FROM NEAREST TOWN OR POST OFFICE*

13 miles NE of Shiprock

16. NO. OF ACRES IN LEASE

1920

19. PROPOSED DEPTH

1775

15. DISTANCE FROM PROPOSED LOCATION TO NEAREST PROPERTY OR LEASE LINE, FT. (Also to nearest drilg. line, if any)

12'

18. DISTANCE FROM PROPOSED LOCATION TO NEAREST WELL, DRILLING, COMPLETE, OR APPLIED FOR, ON THIS LEASE, FT.

1300'

21. ELEVATIONS (Show whether OF RT, R, L)

5862'

PROPOSED CASING AND CEMENTING PROGRAM

SIZE OF HOLE	SIZE OF CANG	WEIGHT PER FOOT	SETTING DEPTH
10-3/4	7-5/8	24	30
6-1/4	4-1/2	9-1/2	1770

17. NO. OF ACRES ASSIGNED TO THIS WELL

40

20. ROTARY OR CABLE TOOLS

Rotary

22. APPROX. DATE WORK WILL START*

December 1, 1965

5. LEASE DESIGNATION AND SERIAL NO.

14-20-600-3539

6. IF INDIAN, ALLOTTEE OR TRIBE NAME

Navajo-Ute

7. UNIT AGREEMENT NAME

8. FARM OR LEASE NAME

Navajo-Ute Lynch

9. WELL NO.

1

10. FIELD AND POOL, OR WILDCAT

Unnamed

11. SEC., T., R., M., OR BLK. AND SURVEY OR AREA

Sec. 26, T 32 N, R 17

12. COUNTY OR PARISH

San Juan

13. STATE

New Mexico

Plan to air drill, core 1/50-60, gamma ray-induction log.
If productive at perforate sand, sand oil frac in approximate quantity of 10 bbls. oil with pound sand per gallon oil.

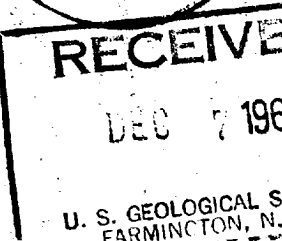

IN ABOVE SPACE DESCRIBE RECOMMENDED PROGRAM: If proposal is to deepen or plug back, give data on present productive zone and proposed new zone. If proposal is to drill or deepen directionally, give pertinent data on subsurface locations and measured and true vertical depths.

SIGNED

Curtis J. Little

TITLE

Operator

DATE

Dec.

(This space for Federal or State office use)

APPROVAL DATE

DATE

PERMIT NO.

TITLE

APPROVED BY
CONDITIONS OF APPROVAL, IF ANY:

*See Instructions On Reverse Side

**NEW MEXICO OIL CONSERVATION COMMISSION
WELL LOCATION AND ACREAGE DEDICATION PLAT**

Form C-102
Supersedes C-128
Effective 1-1-65

All distances must be from the outer boundaries of the Section.

Operator Curtis J. Little			Lease Section 26 Lynch		Well No. 1
Unit Letter F	Section 26	Township 32 North	Range 17 West	County San Juan	
Actual Footage Location of Well: 2310 feet from the North line and 1650 feet from the West line					
Ground Level Elev: 5862	Producing Formation Alfalfa		Pool Unconsolidated	Dedicated Acreage 3.1 Acres	

1. Outline the acreage dedicated to the subject well by colored pencil or hachure marks on the plat below.
2. If more than one lease is dedicated to the well, outline each and identify the ownership thereof (both as to working interest and royalty).
3. If more than one lease of different ownership is dedicated to the well, have the interests of all owners been consolidated by communitization, unitization, force-pooling, etc?

☐ Yes ☐ No If answer is "yes," type of consolidation _____

If answer is "no," list the owners and tract descriptions which have actually been consolidated. (Use reverse side of this form if necessary.) _____

No allowable will be assigned to the well until all interests have been consolidated (by communitization, unitization, forced-pooling, or otherwise) or until a non-standard unit, eliminating such interests, has been approved by the Commission.

RECEIVED

DEC 7 1965

U. S. GEOLOGICAL SURVEY

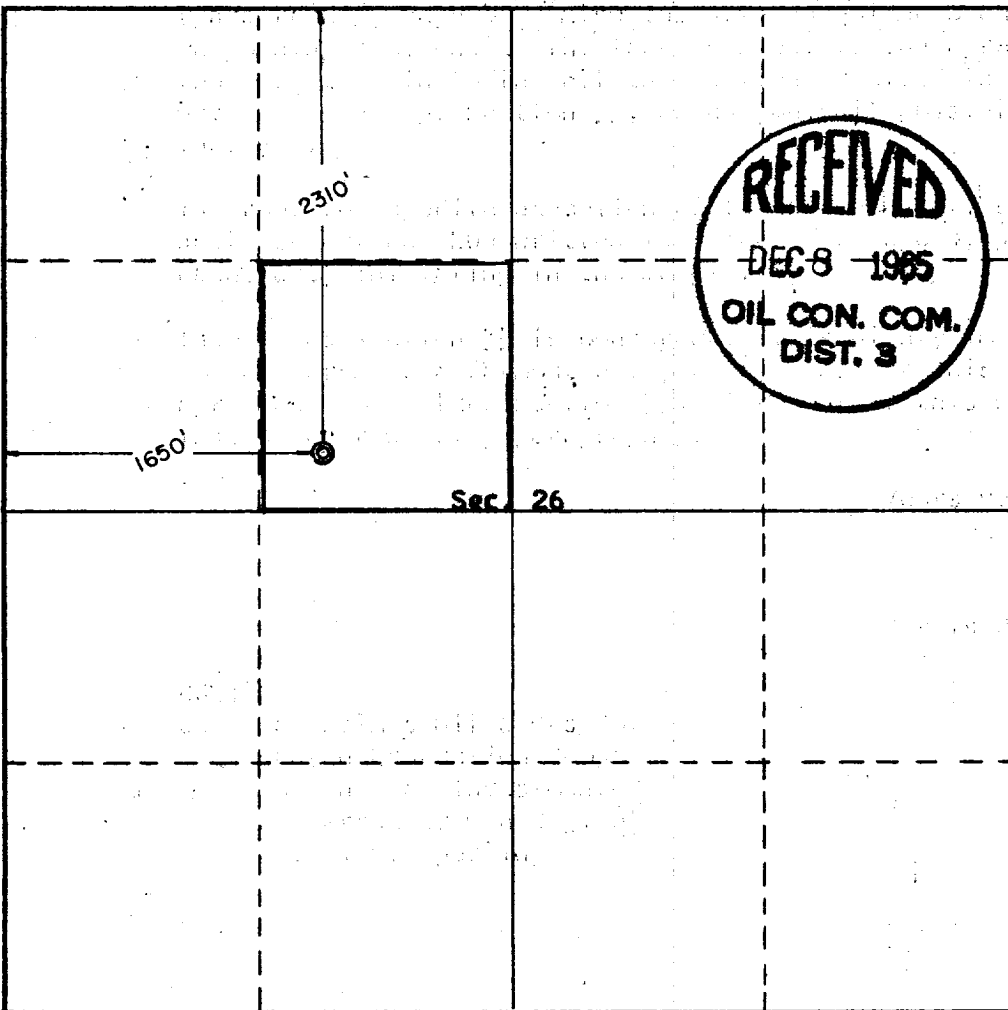

CERTIFICATION

I hereby certify that the information contained herein is true and complete to the best of my knowledge and belief.

Curtis J. Little

Operator

Position

Company

Date **December 6, 1965**

I hereby certify that the well location shown on this plat was plotted from field notes of actual surveys made by me or under my supervision, and that the same is true and correct to the best of my knowledge and belief.

Date Surveyed

September 18, 1965

Registered Professional Engineer and/or Land Surveyor

Ernest V. Echohawk
Certificate No.

3602

0 330 660 990 1320 1650 1980 2310 2640 2000 1600 1000 600 0