

UNITED STATES
DEPARTMENT OF THE INTERIOR
GEOLOGICAL SURVEY

APPLICATION FOR PERMIT TO DRILL, DEEPEN, OR PLUG BACK

1a. TYPE OF WORK DRILL <input checked="" type="checkbox"/> DEEPEN <input type="checkbox"/> PLUG BACK <input type="checkbox"/>		5. LEASE DESIGNATION AND SERIAL NO. 14-20-603-585
b. TYPE OF WELL OIL WELL <input checked="" type="checkbox"/> GAS WELL <input type="checkbox"/> OTHER <input type="checkbox"/> SINGLE ZONE <input checked="" type="checkbox"/> MULTIPLE ZONE <input type="checkbox"/>		6. IF INDIAN, ALLOTTEE OR TRIBE NAME Nava, o
2. NAME OF OPERATOR Murphy Oil Corporation		7. UNIT AGREEMENT NAME
3. ADDRESS OF OPERATOR 200 Jefferson Avenue - El Dorado, Arkansas		8. FARM OR LEASE NAME Navajo Tribal "AA"
4. LOCATION OF WELL (Report location clearly and in accordance with any State requirements.)* At surface 932' from North Line & 938' from East Line of Sec. 20-T32N-R17W At proposed prod. zone Same		9. WELL NO. 16
14. DISTANCE IN MILES AND DIRECTION FROM NEAREST TOWN OR POST OFFICE*		10. FIELD AND POOL OF PRODUCTION Many Rocks Gallup Lower Gallup
15. DISTANCE FROM PROPOSED* LOCATION TO NEAREST PROPERTY OR LEASE LINE, FT. (Also to nearest drlg. line, if any)		11. SEC., T., E., M., OR BLK. AND SURVEY OR AREA Sec. 20-T32N-R17W
16. NO. OF ACRES IN LEASE		12. COUNTY OR PARISH San Juan
17. NO. OF ACRES ASSIGNED TO THIS WELL 40		13. STATE New Mexico
18. DISTANCE FROM PROPOSED LOCATION* TO NEAREST WELL, DRILLING, COMPLETED, OR APPLIED FOR, ON THIS LEASE, FT. 1040'		20. ROTARY OR CABLE TOOLS Rotary
19. PROPOSED DEPTH 1630'		22. APPROX. DATE WORK WILL START* June 24, 1964
21. ELEVATIONS (Show whether DF, RT, GR, etc.) 5823' GR		

23. PROPOSED CASING AND CEMENTING PROGRAM

SIZE OF HOLE	SIZE OF CASING	WEIGHT PER FOOT	SETTING DEPTH	QUANTITY OF CEMENT
9"	7"	20#	30'	Cement to surface
6 1/2"	4 1/2"	9.5#	1630'	35 sacks

Plan to cut one 20' core in Lower Gallup Formation with air and/or oil, cement 4 1/2" casing with a sufficient amount of cement to cover approximately 250' above the producing zone, perforate with jet-notch gun, and fracture with 40,000# sand and 1000 bbls oil. The estimated top of the Lower Gallup is 1583'.

Plats are filed in your office.

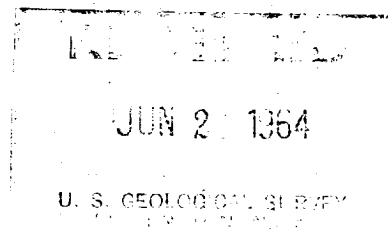

IN ABOVE SPACE DESCRIBE PROPOSED PROGRAM: If proposal is to deepen or plug back, give data on present productive zone and proposed new productive zone. If proposal is to drill or deepen directionally, give pertinent data on subsurface locations and measured and true vertical depths. Give blowout preventer program, if any.

24.

SIGNED [Signature] TITLE **Prod. Supt. - Direct Operations** DATE **6-20-64**

(This space for Federal or State office use)

PERMIT NO. _____

APPROVAL DATE _____

APPROVED BY [Signature]

TITLE _____

CONDITIONS OF APPROVAL, IF ANY:

*See Instructions On Reverse Side

NEW MEXICO OIL CONSERVATION COMMISSION

Well Location and Acreage Dedication Plat

Section A.

Date _____

Operator MURPHY OIL CORPORATION Lease NAVAJO A A
 Well No. 16 Unit Letter A Section 20 Township 32 NORTH Range 17 WEST NMPM
 Located 952 Feet From the NORTH Line, 958 Feet From the EAST Line
 County SAN JUAN G. L. Elevation 5823' Dedicated Acreage 20 Acres
 Name of Producing Formation Gallup Pool Undesignated

1. Is the Operator the only owner in the dedicated acreage outlined on the plat below?

Yes X No _____

2. If the answer to question one is "no", have the interests of all the owners been consolidated by communitization agreement or otherwise? Yes _____ No _____. If answer is "yes", Type of Consolidation _____

3. If the answer to question two is "no", list all the owners and their respective interests below:

Owner

Land Description

RECEIVED
 JUN 22 1964
 U. S. GEOLOGICAL SURVEY
 FARMINGTON, N. M.

Section B.

Note: All distances must be from outer boundaries of section.

This is to certify that the information
 in Section A above is true and complete
 to the best of my knowledge and belief.

Murphy Oil Corporation

(Operator)

Charles O. Neubley
 (Representative)

200 Jefferson Avenue

(Address)

El Dorado, Arkansas

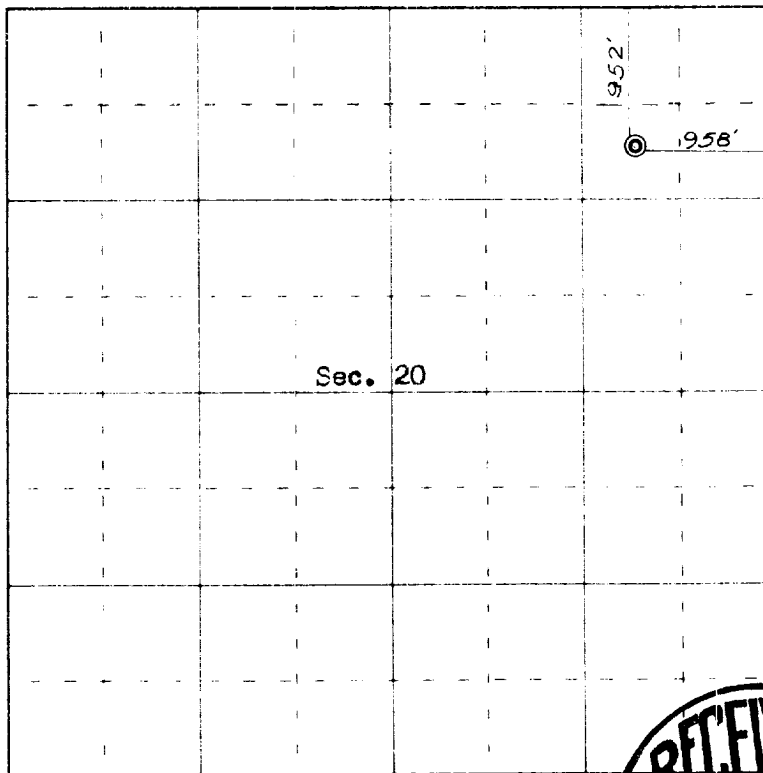

0 330 660 990 1320 1650 1980 2310 2640 2000 1500 000

Scale 4 inches equal 1 mile

RECEIVED
 JUN 23 1964
 OIL CON. COM.
 DIST. 5

This is to certify that the above plat was prepared from field notes of actual surveys made by me or under my supervision and that the same are true and correct to the best of my knowledge and belief.

Date Surveyed June 18, 1964

James P. Lease
 Registered Professional Engineer and/or Land Surveyor
 James P. Lease, N. Mex. Reg. No. 1463
 San Juan Engineering Company

