

Company SOUTHERN UNION ^{Gas} PRODUCTION COMPANY.

Lease Culpepper-Martin Well No. 3

Sec. 33. T. 32. N., R. 12. W., N.M.P.M.

Location 1650' East & 990' North from SW Cor. Sec. 33.
Being in NW $\frac{1}{4}$ SE $\frac{1}{4}$ SW $\frac{1}{4}$ section 33-T32N-R12W.
San Juan County New Mexico

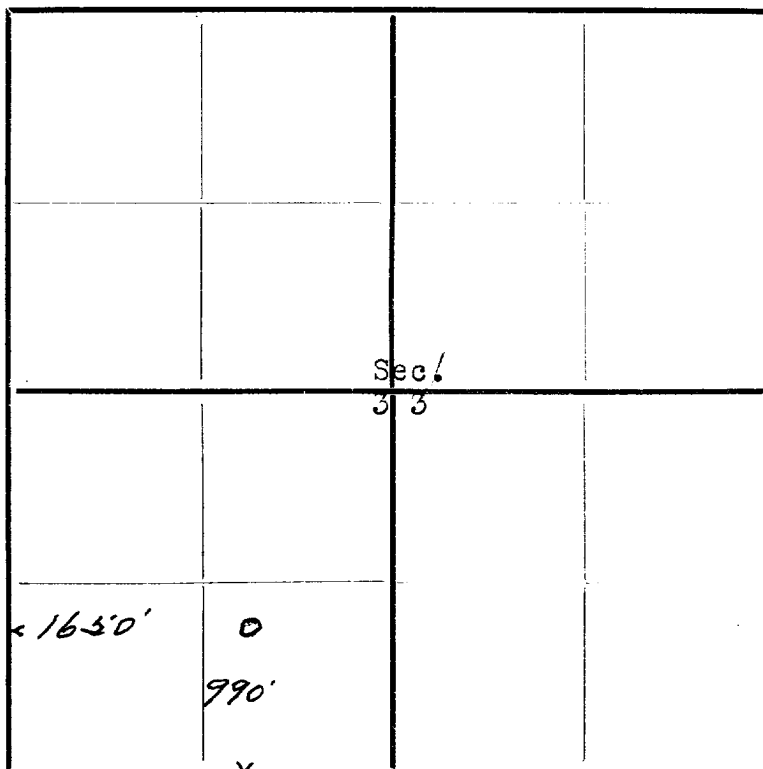

Scale—4 inches equals 1 mile.

This is to certify that the above plat was prepared from field notes of actual surveys made by me or under my supervision and that the same are true and correct to the best of my knowledge and belief.

Seal:

H. H. Miller
Registered Professional
Engineer and Land Surveyor.

Farmington, New Mexico

Surveyed April 21, 1950.