

| | |
|------------------------|---|
| NO. OF COPIES RECEIVED | 6 |
| DISTRIBUTION | |
| SANTA FE | 1 |
| FILE | 1 |
| U.S.G.S. | 2 |
| LAND OFFICE | 1 |
| OPERATOR | 1 |

NEW MEXICO OIL CONSERVATION COMMISSION

Form C-101
Revised 1-4-65 30-045-20027

| | |
|---|------------------------------|
| 5A. Indicate Type of Lease | |
| STATE <input checked="" type="checkbox"/> | FEE <input type="checkbox"/> |
| 5. State Oil & Gas Lease No. E-1198-2 | |

APPLICATION FOR PERMIT TO DRILL, DEEPEN, OR PLUG BACK

| | | | |
|---|--|--|--|
| 1a. Type of Work DRILL <input checked="" type="checkbox"/> DEEPEN <input type="checkbox"/> PLUG BACK <input type="checkbox"/> | | 7. Unit Agreement Name -- | |
| b. Type of Well OIL WELL <input type="checkbox"/> GAS WELL <input checked="" type="checkbox"/> OTHER <input type="checkbox"/> | | 8. Farm or Lease Name State Com. AK | |
| 2. Name of Operator Pubco Petroleum Corporation | | 9. Well No. 35 | |
| 3. Address of Operator P. O. Box 869, Albuquerque, New Mexico 87103 | | 10. Field and Pool, or Wildcat Basin Dakota | |
| 4. Location of Well UNIT LETTER B LOCATED 790 FEET FROM THE north LINE AND 1700 FEET FROM THE east LINE OF SEC. 36 TWP. 32N RGE. 12W NMPM | | 12. County San Juan | |
| 21. Elevations (Show whether DF, RT, etc.) 6364 GR | | 22. Approx. Date Work will start 2-25-67 | |
| 21A. Kind & Status Plug. Bond Blanket | | 21B. Drilling Contractor Circle "A" | |
| 19. Proposed Depth 7900 | | 19A. Formation Dakota | |
| 20. Rotary or C.T. Rotary | | | |

23. PROPOSED CASING AND CEMENT PROGRAM

| SIZE OF HOLE | SIZE OF CASING | WEIGHT PER FOOT | SETTING DEPTH | SACKS OF CEMENT | EST. TOP |
|--------------|----------------|-----------------|---------------|-----------------|-----------|
| 15" | 10-3/4" | 32.75 | 350 | Sufficient to | circulate |
| 9-7/8" | 7-5/8" | 26.4 | 3300 | Sufficient to | circulate |
| 6-3/4" | 4-1/2" | 10.5 | 7850 | Fill to | 3000 ft. |

Proposed to drill a Dakota well using fresh water mud thru the Pictured Cliffs and natural gas as a drilling fluid from below the 7-5/8" csg. to total depth. Will cement 10-3/4" csg. and 7-5/8" csg. to surface and will cement 4-1/2" csg. from T.D. to tie back into 7-5/8" csg. Will multi-stage frack the Dakota with water and sand.



APPROVAL VALID
FOR 30 DAYS UNLESS
DRILLING COMMENCED,

EXPIRES May 18, 1967

IN ABOVE SPACE DESCRIBE PROPOSED PROGRAM: IF PROPOSAL IS TO DEEPEN OR PLUG BACK, GIVE DATA ON PRESENT PRODUCTIVE ZONE AND PROPOSED NEW PRODUCTIVE ZONE. GIVE BLOWOUT PREVENTER PROGRAM, IF ANY.

I hereby certify that the information above is true and complete to the best of my knowledge and belief.

Signed Charles E. Kemmery Title Area Production Manager Date February 13, 1967

(This space for State Use)

APPROVED BY Clarence C. Amick TITLE Sup Dist III DATE 2-17-67

CONDITIONS OF APPROVAL, IF ANY:

**NEW MEXICO OIL CONSERVATION COMMISSION
WELL LOCATION AND ACERAGE DEDICATION PLAT**

All distances must be from the outer boundaries of the Section

| | | | | | |
|---------------------------------------|-----------------------------------|----------------------|---------------------------------------|------------------------|--|
| Operator PUBCO PETROLEUM CORP. | | Lease | | Well No. 35 | |
| Unit Letter B | Section 36 | Township 32 N | Range 12 W | County SAN JUAN | |
| Actual Footage Location of Well | | | | | |
| 790 | feet from the north | 1700 | feet from the east | | |
| Ground Level Elev. 6364 | Producing Formation DAKOTA | Basin BASIN | Dedicated Acreage EAST 1/2 320 | Acre | |

1. Outline the acreage dedicated to the subject well by colored pencil or machine marks on the plat below.
2. If more than one lease is dedicated to the well, outline each and identify the ownership thereon (both as to working interest and royalty).
3. If more than one lease of different ownership is dedicated to the well, have the interests of all owners been consolidated by commonization, unitization, forced-pooling, etc?

☒ Yes ☐ No If answer is yes, type of consolidation **Commonization**

If answer is "No," list the owners and tract descriptions which have actually consolidated. (Use reverse side of this form if necessary)

No allowable will be assigned to the well until all interests have been consolidated by commonization, unitization, forced-pooling, or otherwise, or until a non-standard unit, eliminating such interests, has been approved by the Commission.

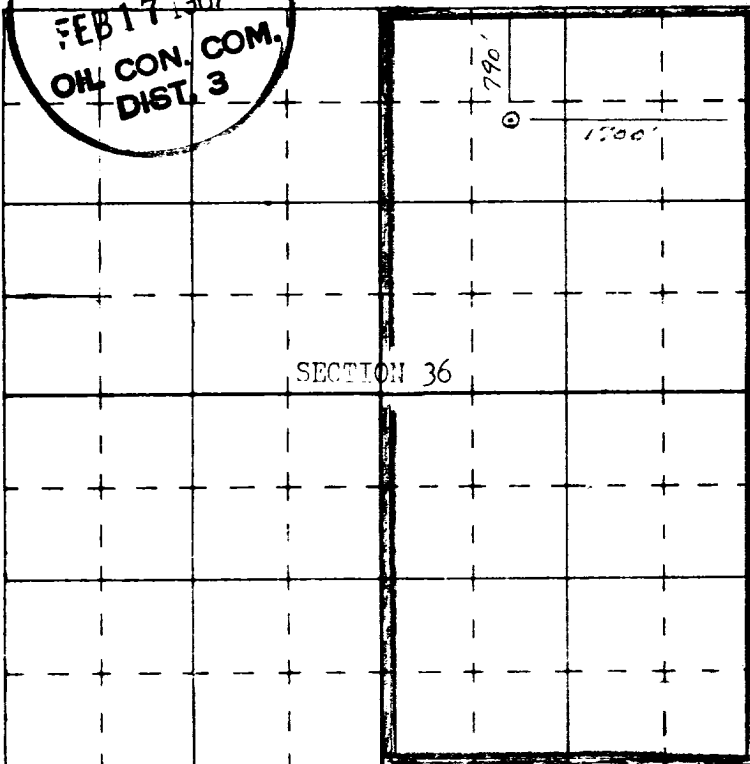

CERTIFICATION

I hereby certify that the information contained herein is true and complete to the best of my knowledge and belief.

Charles E. Ramsey, Jr.
Name **Charles E. Ramsey, Jr.**
Area Production Manager

Employer **Pubco Petroleum Corp.**
Address **869**
Box 1110, Albuquerque, N.M.

February 6, 1967

I hereby certify that the well location shown on this plat was plotted from field notes of actual surveys made by me or under my supervision, and that the same is true and correct to the best of my knowledge and belief.

February 6, 1967
Date Signed *Stephen H. Kinney*
Stephen H. Kinney
Registered Professional Engineer
Char. Land Surveyor

