

UNITED STATES
DEPARTMENT OF THE INTERIOR
GEOLOGICAL SURVEY

APPLICATION FOR PERMIT TO DRILL, DEEPEN, OR PLUG BACK

1a. TYPE OF WORK

DRILL ☒DEEPEN ☐PLUG BACK ☐

b. TYPE OF WELL

OIL
WELL ☐GAS
WELL ☒

OTHER

SINGLE
ZONE ☐MULTIPLE
ZONE ☐

2. NAME OF OPERATOR

Continental Oil Company

3. ADDRESS OF OPERATOR

152 North Durbin, Casper, Wyoming 82601

4. LOCATION OF WELL (Report location clearly and in accordance with any State regulations.)

At surface

650' FSL, 480' FEL

At proposed prod. zone

14. DISTANCE IN MILES AND DIRECTION FROM NEAREST TOWN OR POST OFFICE*

15. DISTANCE FROM PROPOSED*
LOCATION TO NEAREST
PROPERTY OR LEASE LINE, FT.
(Also to nearest drig. unit line, if any)

480' FEL

650' FSL

16. NO. OF ACRES IN LEASE

7892 - Gross

18. DISTANCE FROM PROPOSED LOCATION*
TO NEAREST WELL, DRILLING, COMPLETED,
OR APPLIED FOR, ON THIS LEASE, FT.

19. PROPOSED DEPTH

6150'

21. ELEVATIONS (Show whether DF, RT, GR, etc.)

5003.0' Ground

23.

PROPOSED CASING AND CEMENTING PROGRAM

SIZE OF HOLE	SIZE OF CASING	WEIGHT PER FOOT	SETTING DEPTH	QUANTITY OF CEMENT
12 1/4"	8 5/8"	24#	300'	150 sacks
7 7/8"	5 1/2"	14# & 15.5#	6150'	140 sacks

We propose to drill this well to an estimated total depth of 6150' to test the Desert Creek formation for commercial oil production.

A 12 1/4" hole will be drilled to approximately 300'. An estimated 300' of 8 5/8" casing will be set and cemented to surface with 150 sacks of cement.

A 7 7/8" hole will be drilled to approximately 6150'. Two DST's are planned, one each in the Johnson Creek and the Desert Creek formations. No cores will be cut. If productive, 5 1/2" OD 14# and 15.5# casing will be run to total depth and cemented with 140 sacks of cement.

The well will be logged prior to setting the 5 1/2" casing. It will then be perforated, stimulated, if necessary, and production equipment run.

IN ABOVE SPACE DESCRIBE PROPOSED PROGRAM: If proposal is to deepen or plug back, give data on present productive zone and proposed new productive zone. If proposal is to drill or deepen directionally, give pertinent data on subsurface locations and measured and true vertical depths. Give blowout preventer program, if any.

24.

Original Signed By

SIGNED

J. A. UBBEN

TITLE Administrative Supervisor

DATE 11-9-71

(This space for Federal or State office use)

PERMIT NO.

APPROVAL DATE

APPROVED BY

TITLE

CONDITIONS OF APPROVAL, IF ANY:

USGS-Durango(6) Duncan File(2)

*See Instructions On Reverse Side

30-045-20959

5. LEASE DESIGNATION AND SERIAL NO.

NOO-C-14-20-4137

6. IF INDIAN, ALLOTTEE OR TRIBE NAME

Navajo

7. UNIT AGREEMENT NAME

8. FARM OR LEASE NAME

Navajo Tribal 13

9. WELL NO.

1

10. FIELD AND POOL, OR WILDCAT

Undesignated - Wildcat

11. SEC., T., R., M., OR BLK.
AND SURVEY OR AREA

Sec. 13, T32N, R20W

12. COUNTY OR PARISH

San Juan

New Mexico

17. NO. OF ACRES ASSIGNED
TO THIS WELL

40

20. ROTARY OR CABLE TOOLS

Rotary

22. APPROX. DATE WORK WILL START*

11-15-71

NOV 15 1971

**NEW MEXICO OIL CONSERVATION COMMISSION
WELL LOCATION AND ACERAGE DEDICATION PLAT**

All distances must be from the outer boundaries of the Section

Operator CONTINENTAL OIL COMPANY		Navajo Tribal Monument		Well No. 13	
Unit Letter P	Section 13	Township 32 NORTH	Range 20 WEST	County SAN JUAN	
Actual Footage Location of Well: 650 feet from the SOUTH line and 480 feet from the EAST line					
Ground Level Elev 5003.0	Producing Formation	Pool	Dedicated Acreage 40		Acres

1. Outline the acreage dedicated to the subject well by colored pencil or hatchure marks on the plat below.
2. If more than one lease is dedicated to the well, outline each and identify the ownership interest (both as to working interest and royalty).
3. If more than one lease of different ownership is dedicated to the well, have the interests of all owners been consolidated by communization, unitization, force-pooling, etc?

() Yes () No If answer is "yes," type of consolidation _____

If answer is "no," list the owners and tract descriptions which have actually consolidated (on reverse side of this form if necessary.) _____

No allowable will be assigned to the well until all interests have been consolidated (by communization, unitization, forced-pooling, or otherwise) or until a non standard unit, eliminating such interests, has been approved by the Commission.



CERTIFICATION

I hereby certify that the information contained herein is true and complete to the best of my knowledge and belief.

Name _____

Position _____

Company _____

Date _____

I hereby certify that the well location shown on this plat was plotted from field notes of actual surveys made by me or under my supervision, and that the same is true and correct to the best of my knowledge and belief.

29 October, 1971

Date Surveyed _____

James P. Leese

Registered Professional Engineer
and/or Land Surveyor

JAMES P. LEESE

1463

Certificate No. _____

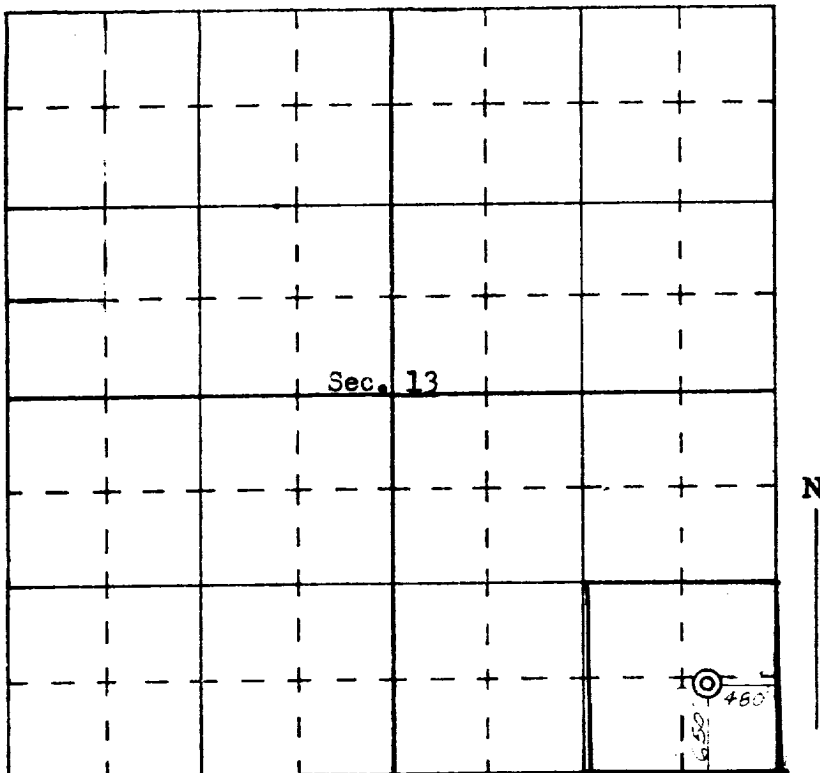

SCALE—4 INCHES EQUALS 1 MILE

SAN JUAN ENGINEERING COMPANY, FARMINGTON, N. M.