

BENSON-MONTIN-GREER DRILLING CORP.

DEVELOPMENT PLAN FOR SURFACE USE

BENSON-MONTIN-GREER DRILLING CORP.

LA PLATA MANCOS UNIT #7 (K-30)
NE $\frac{1}{4}$ SW $\frac{1}{4}$ SEC. 30, T 32N, R 13W NMPM
SAN JAUN COUNTY, NEW MEXICO
FEDERAL LEASE NM 4282

1. Existing Roads:

As shown on attached plat entitled "Existing and Proposed Roads and Pipeline Right-of-Way."

2. Planned Access Roads:

From New Mexico State Highway #17 approximately 17 miles north of Farmington, take existing road (west) to Barker Dome. Enter Ute Mountain Tribal Reservation, across cattleguard turn right (north) approximately $\frac{1}{4}$ mile after crossing cattleguard, then north approximately $\frac{1}{2}$ mile to the existing well location, then right approximately $\frac{3}{4}$ mile to location as shown on attached plat entitled "Existing and Proposed Roads and Pipeline Right-of-Way."

3. Location of Wells:

As shown on attached plat entitled "Existing and Proposed Roads and Pipeline Right-of-Way."

4. Laternal Roads to Well Locations:

As shown on attached plat entitled "Existing and Proposed Roads and Pipeline Right-of-Way."

5. Location of Tank Batteries and Flow Lines:

As shown on attached plat entitled "Location and Equipment Layout."

6. Location and Type of Water Supply:

Existing Water Well located on main Barker Dome Road in SW $\frac{1}{4}$ SEC. 31

7. Method of Handling Waste Disposal:

Waste will be buried in burn pit or reserve pit as applicable.



BENSON-MONTIN-GREER DRILLING CORP.

8. Location of Camps:

None

9. Location of Airstrips:

None

10. Location/Layout to Include Position of Rig, Mud Tanks, Reserve Pit, Burn Pit, Pipe Racks, Ect.:

As shown on attached plat entitled "Location and Equipment Layout, La Plata Mancos Unit #7 (K-30)

11. Plans for Restoration of the Surface:

All excavations will be filled and surface leveled, Surface will then be reseeded.

12. Other Information

This location on Federal lease under jurisdiction of Bureau of Land Management. Benson-Montin-Greer representatives, Mr. M.L. Seelinger, United States Geological Survey Engineer, and Mr. Jon Weddle, Bureau of Land Management Natural Resource Specialist, visited area and viewed locations and access roads to locations on May 24, 1974. Verbal approval was granted Benson-Montin-Greer representatives to commence surface dirt work on location and that portion of road on Bureau of Land Management land.

Additional access road located on Ute Mountain Indian Reservation. On May 27, 1974, an aerial survey of this segment of road was made by Benson-Montin-Greer representatives and Mr. Hal Rogers, Realty Officer, Ute Mountain Tribal Indian Reservation. Verbal approval was granted Benson-Montin-Greer representatives to commence surface dirt work on this segment of access road.



BENSON-MONTIN-GREER DRLG. CORP.
EXISTING & PROPOSED ROADS &
PIPELINE RIGHT-OF-WAYS
LA PLATA MANCOS UNIT 7 (K-30)

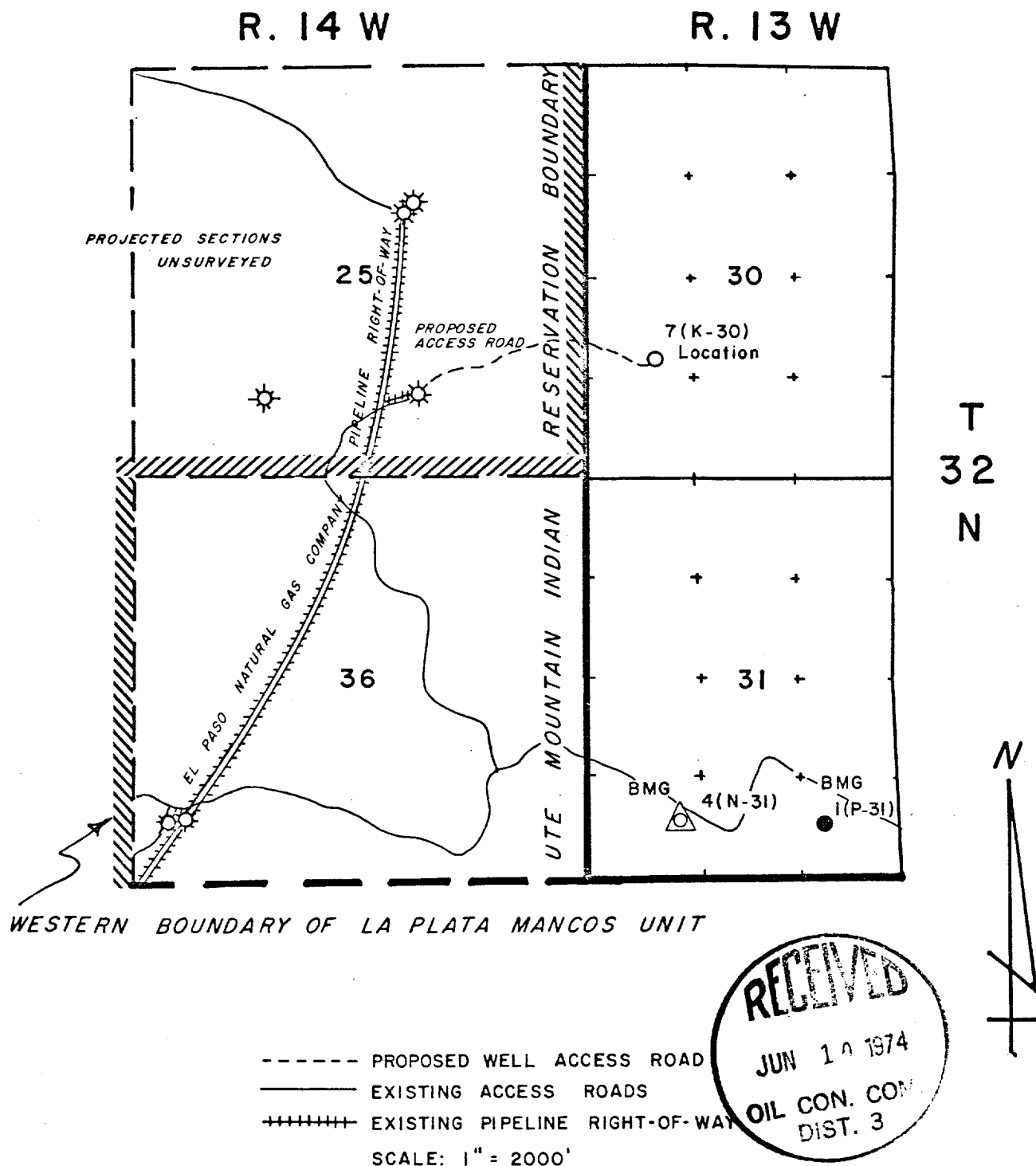

----- PROPOSED WELL ACCESS ROAD
 ————— EXISTING ACCESS ROADS
 ++++++ EXISTING PIPELINE RIGHT-OF-WAY
 SCALE: 1" = 2000'

**BENSON-MONTIN-GREER DRUG CORP.
LA PLATA MANCOS UNIT No. 7 (K-30)**

LOCATION & EQUIPMENT LAYOUT

