

UNITED STATES  
DEPARTMENT OF THE INTERIOR  
GEOLOGICAL SURVEY

## APPLICATION FOR PERMIT TO DRILL, DEEPEN, OR PLUG BACK

1a. TYPE OF WORK  
DRILL ☒ DEEPEN ☐ PLUG BACK ☐

b. TYPE OF WELL  
OIL WELL ☐ GAS WELL ☒ OTHER ☐ SINGLE ZONE ☒ MULTIPLE ZONE ☐

2. NAME OF OPERATOR  
Aztec Oil & Gas Company

3. ADDRESS OF OPERATOR  
P. O. Drawer 570, Farmington, New Mexico

4. LOCATION OF WELL (Report location clearly and in accordance with any State requirements.)\*  
At surface  
1500' FSL & 850' FEL  
At proposed prod. zone

14. DISTANCE IN MILES AND DIRECTION FROM NEAREST TOWN OR POST OFFICE\*

15. DISTANCE FROM PROPOSED\*  
LOCATION TO NEAREST  
PROPERTY OR LEASE LINE, FT.  
(Also to nearest drlg. unit line, if any)

16. NO. OF ACRES IN LEASE

17. NO. OF ACRES ASSIGNED  
TO THIS WELL  
E / 320

18. DISTANCE FROM PROPOSED LOCATION\*  
TO NEAREST WELL, DRILLING, COMPLETED,  
OR APPLIED FOR, ON THIS LEASE, FT.

19. PROPOSED DEPTH  
5190'

20. ROTARY OR CABLE TOOLS  
Rotary

21. ELEVATIONS (Show whether DF, RT, GR, etc.)  
6095' GR

22. APPROX. DATE WORK WILL START\*

23.

5. LEASE DESIGNATION AND SERIAL NO.  
SF-078146

6. IF INDIAN, ALLOTTEE OR TRIBE NAME

7. UNIT AGREEMENT NAME

8. FARM OR LEASE NAME  
Culpepper Martin

9. WELL NO.  
#7-A

10. FIELD AND POOL, OR WILDCAT  
Blanco Mesa Verde

11. SEC., T., R., M., OR BLK.  
AND SURVEY OR AREA  
Section 28, T32N, R12W

12. COUNTY OR PARISH  
San Juan

13. STATE  
New Mexico

## PROPOSED CASING AND CEMENTING PROGRAM

SIZE OF HOLE	SIZE OF CASING	WEIGHT PER FOOT	SETTING DEPTH	QUANTITY OF CEMENT
13-3/4"	9-5/8"	36#	200'	190 sxs
8-3/4"	7"	23#	2808'	165 sxs
6-1/4"	4-1/2"	10.50#	2658'-5190'	245 sxs
	2-3/8"	4.7#	5195'	

Surface formation is Nacimiento.  
Top of Ojo Alamo sand is at 1290'.  
Top of Pictured Cliffs sand is at 2508'.  
A fresh water mud system will be used for drilling to intermediate casing point.  
An air system will be used for drilling to total depth.  
It is anticipated that IES and Density logs will be run at total depth.  
No abnormal pressures or poisonous gases are anticipated in this well.  
It is expected that this well will be drilled before June, 1977. This depends  
on time required for approvals, rig availability and the weather.  
We will follow the surface restoration plan set out by the appropriate surface  
agency and the U.S.G.S.

GAS IS DEDICATED

IN ABOVE SPACE DESCRIBE PROPOSED PROGRAM: If proposal is to deepen or plug back, give data on present productive zone and proposed new productive zone. If proposal is to drill or deepen directionally, give pertinent data on subsurface locations and measured and true vertical depths. Give blowout preventer program, if any.

SIGNED: [Signature] TITLE: District Production Manager DATE: January 12, 1977  
(This space for Federal or State office use)

PERMIT NO. \_\_\_\_\_

APPROVED BY: [Signature]  
CONDITIONS OF APPROVAL, IF ANY: \_\_\_\_\_

TITLE \_\_\_\_\_

APPROVAL DATE \_\_\_\_\_

RECEIVED

JAN 14 1977  
DATEU. S. GEOLOGICAL SURVEY  
WASHINGTON, D. C.

\*See Instructions On Reverse Side

**NEW MEXICO OIL CONSERVATION COMMISSION  
WELL LOCATION AND ACREAGE DEDICATION PLAT**

Form C-102  
Supersedes C-128  
Effective 1-1-65

All distances must be from the outer boundaries of the Section.

Operator <b>Aztec Oil &amp; Gas Company</b>			Lease <b>Culpepper-Martin</b>		Well No. <b>7A</b>
Unit Letter <b>I</b>	Section <b>28</b>	Township <b>32N</b>	Range <b>12W</b>	County <b>San Juan</b>	
Actual Footage Location of Well: <b>1500</b> feet from the <b>South</b> line and <b>850</b> feet from the <b>East</b> line					
Ground Level Elev. <b>6095</b>	Producing Formation <b>Mesa Verde</b>	Pool <b>Blanco</b>		Dedicated Acreage; <b>320</b> Acres	

1. Outline the acreage dedicated to the subject well by colored pencil or hachure marks on the plat below.
2. If more than one lease is dedicated to the well, outline each and identify the ownership thereof (both as to working interest and royalty).
3. If more than one lease of different ownership is dedicated to the well, have the interests of all owners been consolidated by communitization, unitization, force-pooling, etc?

☐ Yes   ☐ No   If answer is "yes," type of consolidation \_\_\_\_\_

If answer is "no," list the owners and tract descriptions which have actually been consolidated. (Use reverse side of this form if necessary.) \_\_\_\_\_

No allowable will be assigned to the well until all interests have been consolidated (by communitization, unitization, forced-pooling, or otherwise) or until a non-standard unit, eliminating such interests, has been approved by the Commission.

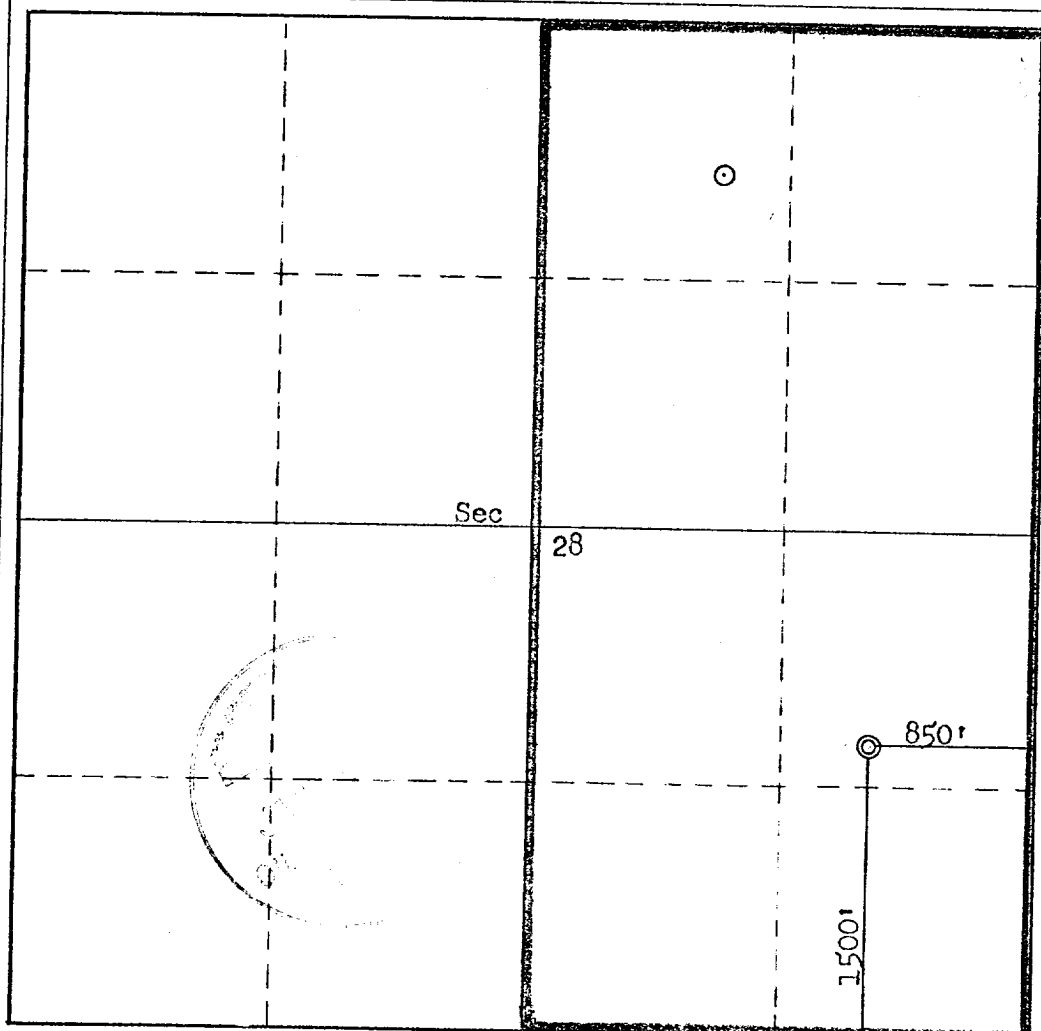

**CERTIFICATION**

*I hereby certify that the information contained herein is true and complete to the best of my knowledge and belief.*

Name *Van Kegan*  
 Position **District Production Manager**  
 Company **Aztec Oil & Gas Company**  
 Date **January 12, 1977**

*I hereby certify that the well location shown on this plat was plotted from field notes of actual surveys made by me or under my supervision, and that the same is true and correct to the best of my knowledge and belief.*

Date Surveyed **December 21, 1976**  
 Registered Professional Engineer and/or Land Surveyor  
*Fred B. Kerr Jr.*  
**Fred B. Kerr Jr.**  
 Certificate No. **3950**