

NO. OF COPIES RECEIVED	5
DISTRIBUTION	
SANTA FE	1
FILE	1
U.S.G.S.	2
LAND OFFICE	
OPERATOR	1

# NEW MEXICO OIL CONSERVATION COMMISSION

30-045-22328  
Form C-101  
Revised 1-1-65

5A. Indicate Type of Lease	
STATE <input type="checkbox"/>	FEE <input checked="" type="checkbox"/>
5. State Oil & Gas Lease No.	

## APPLICATION FOR PERMIT TO DRILL, DEEPEN, OR PLUG BACK

1a. Type of Work		7. Unit Agreement Name	
b. Type of Well DRILL <input checked="" type="checkbox"/> DEEPEN <input type="checkbox"/> PLUG BACK <input type="checkbox"/> OIL WELL <input type="checkbox"/> GAS WELL <input checked="" type="checkbox"/> OTHER <input type="checkbox"/> SINGLE ZONE <input checked="" type="checkbox"/> MULTIPLE ZONE <input type="checkbox"/>		8. Farm or Lease Name Culpepper Martin	
2. Name of Operator Aztec Oil & Gas Company		9. Well No. #6-A	
3. Address of Operator P. O. Drawer 570, Farmington, New Mexico		10. Field and Pool, or Wildcat Blanco Mesa Verde	
4. Location of Well UNIT LETTER I LOCATED 1740 FEET FROM THE South LINE AND 990 FEET FROM THE East LINE OF SEC. 33 TWP. 32N RGE. 12W NMPM		12. County San Juan	
21. Elevations (Show whether DF, RT, etc.) 6043' GR		19. Proposed Depth 5111'	19A. Formation Mesa Verde
21A. Kind & Status Plug. Bond		20. Rotary or C.T. Rotary	22. Approx. Date Work will start

## PROPOSED CASING AND CEMENT PROGRAM

SIZE OF HOLE	SIZE OF CASING	WEIGHT PER FOOT	SETTING DEPTH	SACKS OF CEMENT	EST. TOP
13-3/4"	9-5/8"	36#	200'	190 sxs	Surface
8-3/4"	7"	23#	2769'	170 sxs	Cover Ojo Alamo
6-1/4"	4-1/2"	10.50#	2619' - 5111'	245 sxs	To liner top
	2-3/8"	4.7#	5111'		

Surface formation is Nacimiento.  
Top of Ojo Alamo sand is at 1285'.  
Top of Pictured Cliffs sand is at 2469'

A fresh water mud system will be used for drilling to intermediate casing point.  
An air system will be used for drilling to total depth.  
It is anticipated that IES and Density logs will be run at total depth.  
No abnormal pressures or poisonous gases are anticipated in this well  
It is expected that this well will be drilled before June, 1977. This depends on time required for approvals, rig availability and the weather.

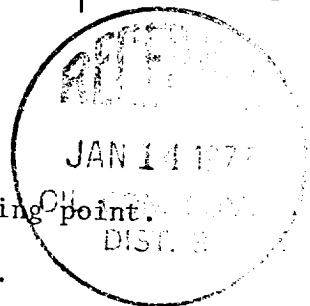

APPROVED FOR OIL CONSERVATION COMMISSION  
EXPIRES 4-14-77

IN ABOVE SPACE DESCRIBE PROPOSED PROGRAM: IF PROPOSAL IS TO DEEPEN OR PLUG BACK, GIVE DATA ON PRESENT PRODUCTIVE ZONE AND PROPOSED NEW PRODUCTIVE ZONE, GIVE BLOWOUT PREVENTER PROGRAM, IF ANY.

I hereby certify that the information above is true and complete to the best of my knowledge and belief.

Signed [Signature] Title District Production Manager Date January 11, 1977

(This space for State Use)

PETROLEUM RESOURCES DIST. NO. 3

APPROVED BY [Signature] TITLE \_\_\_\_\_ DATE \_\_\_\_\_

CONDITIONS OF APPROVAL, IF ANY:

**NEW MEXICO OIL CONSERVATION COMMISSION  
WELL LOCATION AND ACREAGE DEDICATION PLAT**

Form C-102  
Supersedes C-128  
Effective 1-1-65

All distances must be from the outer boundaries of the Section.

Operator <b>Aztec Oil &amp; Gas Company</b>			Lease <b>Culpepper-Martin</b>		Well No. <b>6A</b>
Unit Letter <b>I</b>	Section <b>33</b>	Township <b>32N</b>	Range <b>12W</b>	County <b>San Juan</b>	
Actual Footage Location of Well: <b>1740</b> feet from the <b>South</b> line and <b>990</b> feet from the <b>East</b> line					
Ground Level Elev. <b>6043</b>	Producing Formation <b>Mesa Verde</b>		Pool <b>Blanco</b>	Dedicated Acreage: <b>320</b> Acres	

1. Outline the acreage dedicated to the subject well by colored pencil or hachure marks on the plat below.
2. If more than one lease is dedicated to the well, outline each and identify the ownership thereof (both as to working interest and royalty).
3. If more than one lease of different ownership is dedicated to the well, have the interests of all owners been consolidated by communitization, unitization, force-pooling, etc?

☐ Yes   ☐ No   If answer is "yes," type of consolidation \_\_\_\_\_

If answer is "no," list the owners and tract descriptions which have actually been consolidated. (Use reverse side of this form if necessary.) \_\_\_\_\_

No allowable will be assigned to the well until all interests have been consolidated (by communitization, unitization, forced-pooling, or otherwise) or until a non-standard unit, eliminating such interests, has been approved by the Commission.

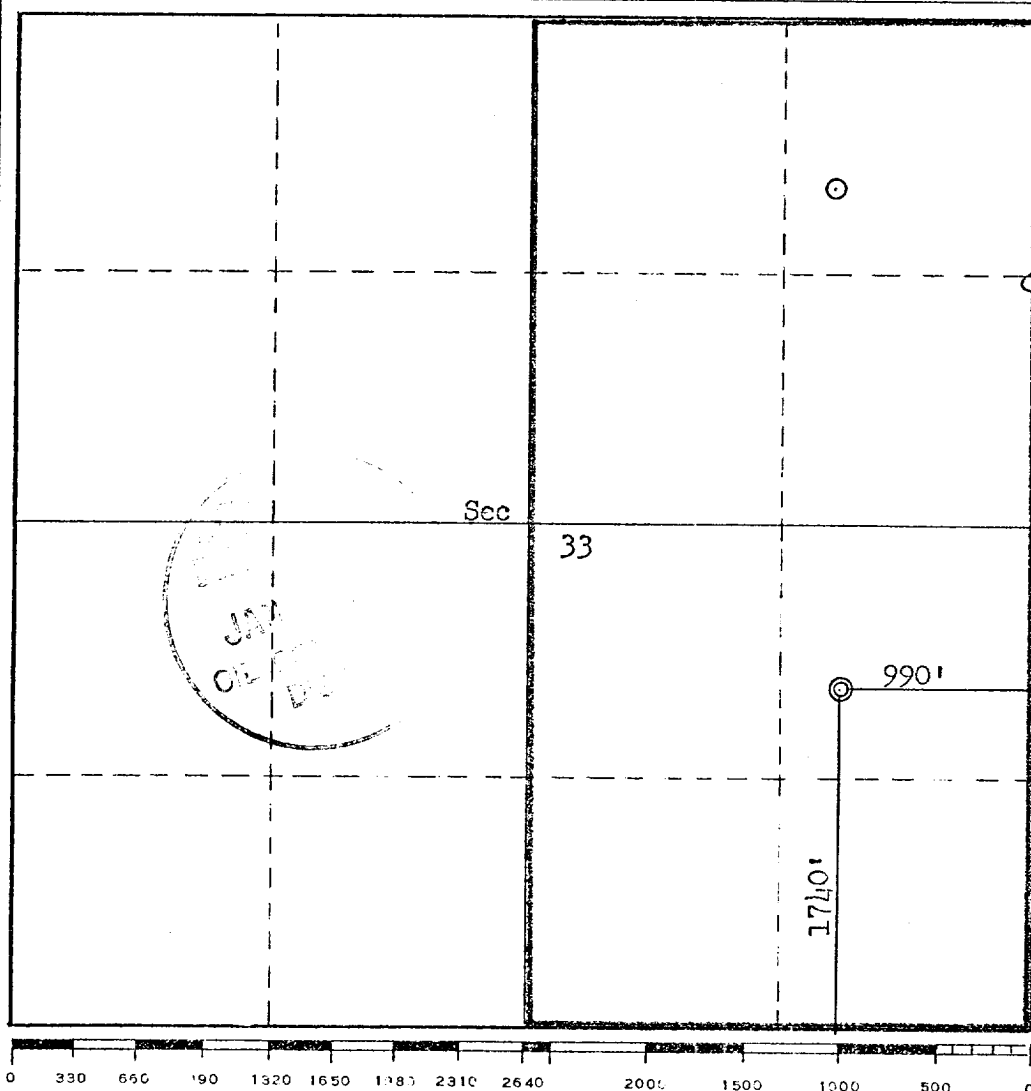

**CERTIFICATION**

*I hereby certify that the information contained herein is true and complete to the best of my knowledge and belief.*

Name \_\_\_\_\_

Position \_\_\_\_\_

**District Production Manager**

Company \_\_\_\_\_

**Aztec Oil & Gas Company**

Date \_\_\_\_\_

**January 11, 1977**

*I hereby certify that the well location shown on this plat was plotted from field notes of actual surveys made by me or under my supervision, and that the same is true and correct to the best of my knowledge and belief.*

Date Surveyed \_\_\_\_\_

**December 21, 1976**

Registered Professional Engineer and/or Land Surveyor

**Fred B. Kerr Jr.**

Certificate No. \_\_\_\_\_

**3950**