

NEW MEXICO OIL CONSERVATION COMMISSION
WELL LOCATION AND ACREAGE DEDICATION PLAT

Form C-102
Supersedes C-128
Effective 1-1-65

All distances must be from the outer boundaries of the Section.

2772

Operator EL PASO NATURAL GAS COMPANY		Lease UTE MTN. TRIBAL I-22-IND-2622 BARKER CREEK DOME GAS STORAGE PROJECT		Well No. WI-24
Unit Letter G	Section 15	Township 32-N	Range 14-W	County SAN JUAN
Actual Footage Location of Well: <div style="display: flex; justify-content: space-between;"> 2015 feet from the NORTH line and 2459 feet from the EAST line </div>				
Ground Level Elev. 6936	Producing Formation DAKOTA	Pool N/A	Dedicated Acreage: N/A <input checked="" type="checkbox"/> Acres	

1. Outline the acreage dedicated to the subject well by colored pencil or hachure marks on the plat below.
2. If more than one lease is dedicated to the well, outline each and identify the ownership thereof (both as to working interest and royalty).
3. If more than one lease of different ownership is dedicated to the well, have the interests of all owners been consolidated by communization, unitization, force-pooling, etc?

☐ Yes ☐ No If answer is "yes," type of consolidation _____

If answer is "no," list the owners and tract descriptions which have actually been consolidated. (Use reverse side of this form if necessary.) _____

No allowable will be assigned to the well until all interests have been consolidated (by communization, unitization, forced-pooling, or otherwise) or until a non-standard unit, eliminating such interests, has been approved by the Commission.

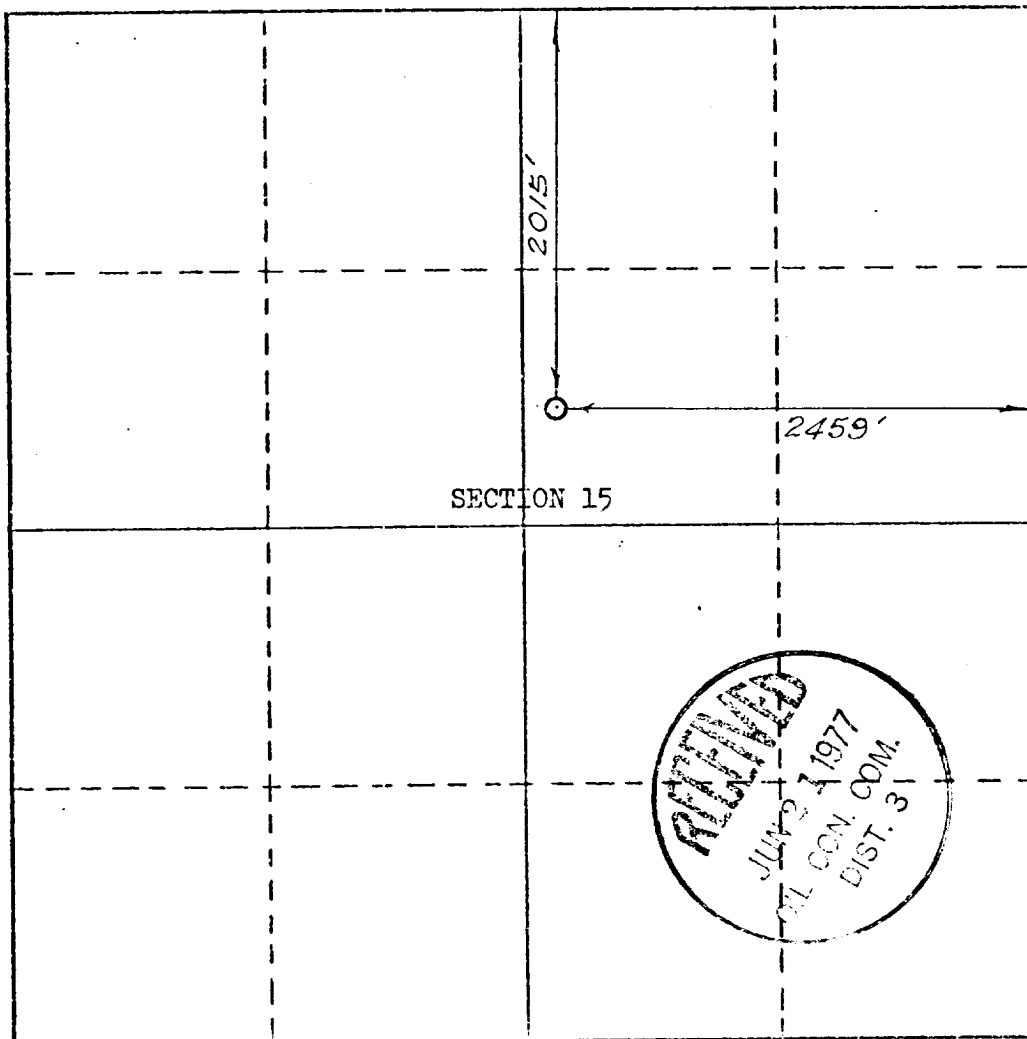

CERTIFICATION

I hereby certify that the information contained herein is true and complete to the best of my knowledge and belief.

ORIGINAL SIGNED BY

LARRY A. AIMES

Name
Sr. Drilling Engineer

Position
El Paso Natural Gas

Company
June 10, 1977

Date

I hereby certify that the well location shown on this plat was plotted from field notes of actual surveys made by me or under my supervision, and that the same is true and correct to the best of my knowledge and belief.

Date Surveyed
APRIL 22, 1977

Registered Professional Engineer and/or Land Surveyor

[Signature]

Certificate No. **1760**

