

Multi-Point Surface Use Plan  
Fields #3A

1. Existing Road - Please refer to Map No. 1 which shows the existing roads. New roads which will be required have been marked on this map. All existing and new roads will be properly maintained during the duration of this project.
2. Planned Access Roads - Please refer to Map No. 1. The grade of the access roads will be consistent with that of the local terrain. The road surface will not exceed twenty feet (20') in width. Upon completion of the project, the access road will be adequately drained to control soil erosion. Drainage facilities may include ditches, water bars, culverts or any other measure deemed necessary by trained Company personnel to insure proper drainage. Gates and/or cattleguards will be installed if necessary.
3. Location of Existing Wells - Please refer to Map No. 2
4. Location of Tank Batteries, Production Facilities, and Production Gathering and Service Lines - Please refer to Maps No. 1 and No. 2. Map No. 2 shows the existing gas gathering lines. Map No. 1 shows the existing roads and new proposed access roads. All known production facilities are shown on these two maps.
5. Location and Type of Water Supply - Water for the proposed project will be obtained from a water hole located at Kiffin Canyon Water Hole.
6. Source of Construction Materials - No additional materials will be required to build either the access road or the proposed location.

7. Methods of Handling Waste Materials - All garbage and trash materials will be put into a burn pit shown on the attached Location Plat No. 1. When clean-up operations are begun on the proposed project, the burn pit with its refuse will be buried to a depth of at least three feet (3'). A latrine, the location of which is also shown on Plat No. 1 will be provided for human waste. If large amounts of liquids are left in the reserve pit after completion of the project, the pit will be fenced until the liquids have had adequate time to dry. The location clean-up will not take place until such time as the reserve pit can be properly covered over to prevent run-off from carrying any of these materials into the watershed. No earthen pit will be located on natural drainages; all earthen pits will be so constructed as to prevent leakage from occurring.
8. Ancillary Facilities - No camps or airstrips will be associated with this project.
9. Wellsite Layout - Please refer to the attached Plat No. 1.
10. Plans for Restoration of the Surface - After completion of the proposed project, the location will be cleaned and leveled. The location will be left in such a condition that will enable reseeding operations to be carried out. Seed Mixture #2 will be used. The reseeding operation will be performed during the time period set forth by the regulatory body. The location production equipment will be painted brown (Federal Standard #595-30318)
11. Other Information - The terrain is sandstone ledges and high hills with pinon and cedar trees growing. Deer graze the proposed project site.

12. Operator's Representative - W. D. Dawson, Post Office Box 990,  
Farmington, New Mexico 87401

13. Certification - I hereby certify that I, or persons under my direct supervision, have inspected the proposed drillsite and access route; that I am familiar with the conditions which presently exist; that the statements made in this plan are, to the best of my knowledge, true and correct; and, that the work associated with the operations proposed herein will be performed by El Paso Natural Gas Company and its contractors and sub-contractors in conformity with this plan and the terms and conditions under which it is approved.

December 8, 1977



---

D. R. Read  
Division Drilling Engineer

DRR:pb

December 9, 1977

Operations Plan  
Fields #3A

I. Location: 1190'S, 1065'E, Section 29, T-32-N, R-11-W, San Juan County, NM

Field: Blanco Mesa Verde

Elevation: 6311'GL

II. Geology:

A. Formation Tops:	Surface	San Jose	Lewis	3050'
	Ojo Alamo	1060'	Mesa Verde	4460'
	Kirtland	1100'	Menefee	4740'
	Fruitland	2460'	Point Lookout	5160'
	Pic.Cliffs	2880'	Total Depth	5610'

B. Logging Program: GR-Ind. and GR-Density at Total Depth.

C. Coring Program: none

D. Natural Gauges: 4450', 4730', 5150' and at Total Depth.  
Also gauge any noticeable increase in gas. Record all gauges in daily drilling report and on morning report.

III. Drilling:

A. Mud Program: mud from surface to 3250'. Gas from intermediate casing to Total Depth.

IV. Materials:

A. Casing Program:	<u>Hole Size</u>	<u>Depth</u>	<u>Casing Size</u>	<u>Wt.&amp;Grade</u>
	13 3/4"	200'	9 5/8"	32.3# H-40
	8 3/4"	3250'	7"	20.0# K-55
	6 1/4"	3100-5610'	4 1/2"	10.5# K-55

B. Float Equipment: 9 5/8" surface casing - Larkin guide shoe (fig. 102)

7" intermediate casing - Dowell guide shoe (fig. 50101) and Dowell self-fill insert float valve (fig. 53003), 5 B&W stabilizers (Prod. No. 637085) every other joint above shoe. Run float two joints above shoe.

4 1/2" liner - 4 1/2" liner hanger with neoprene packoff. Larkin geyser shoe (fig. 222) and Larkin flapper type float collar (fig. 404 M&F).

C. Tubing: 5610' of 2 3/8", 4.7#, J-55 8rd EUE tubing with a common pump seating nipple above perforated pup joint with bull plugged full joint for mud anchor on bottom.

D. Wellhead Equipment: 10" 900 x 9 5/8" casing head. 10" 900 x 6" 900 xmas tree.

V. Cementing:

9 5/8" surface casing - use 190 sks. of Class "B" cement with 1/4# gel-flake per sack and 3% calcium chloride (224 cu.ft. of slurry, 100% excess to circulate to surface). WOC 12 hours. Test casing to 600#/30 minutes.

7" intermediate casing - use 235 sks. of 65/35 Class "B" Poz with 6% gel and 2% calcium chloride (8.3 gallons of water per sack) followed by 100 sks. of Class "B" with 2% calcium chloride (499 cu.ft. of slurry, 50% excess to cover Ojo Alamo). Run temperature survey at 8 hours. WOC 12 hours. Test casing to 1200#/30 minutes.

4 1/2" liner - precede cement with 20 barrels of gel water (2 sks. gel) Cement with 250sks. of Class "B" cement with 4% gel, 1/4 cu.ft. of fine gilsonite per sack and 0.6% Halad-9 (440 cu.ft. of slurry, 70% excess to circulate liner). WOC 18 hours.

El Paso Natural Gas Company

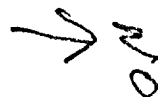

# Diagram of Installation for Mega Verde Well

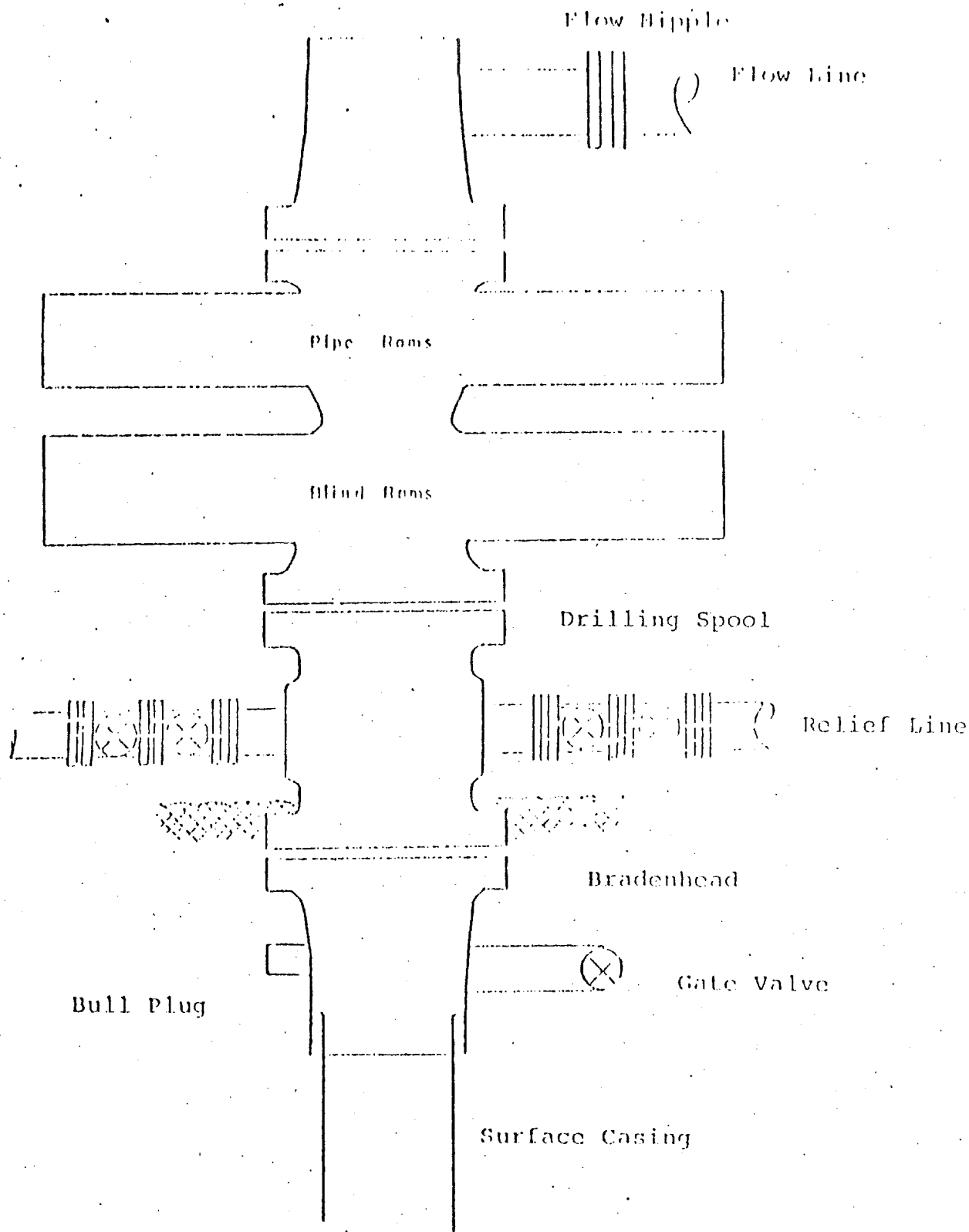

Series 900 Double Gate BOP, rated  
at 3000 psi Working Pressure  
When gas drilling operations begin a Shaffer type 50  
or equivalent rotating head is installed on top of the  
flow nipple and the flow line is converted into a blowie line

# EL PASO NATURAL GAS COMPANY

Field #3A

SW 19-12-11

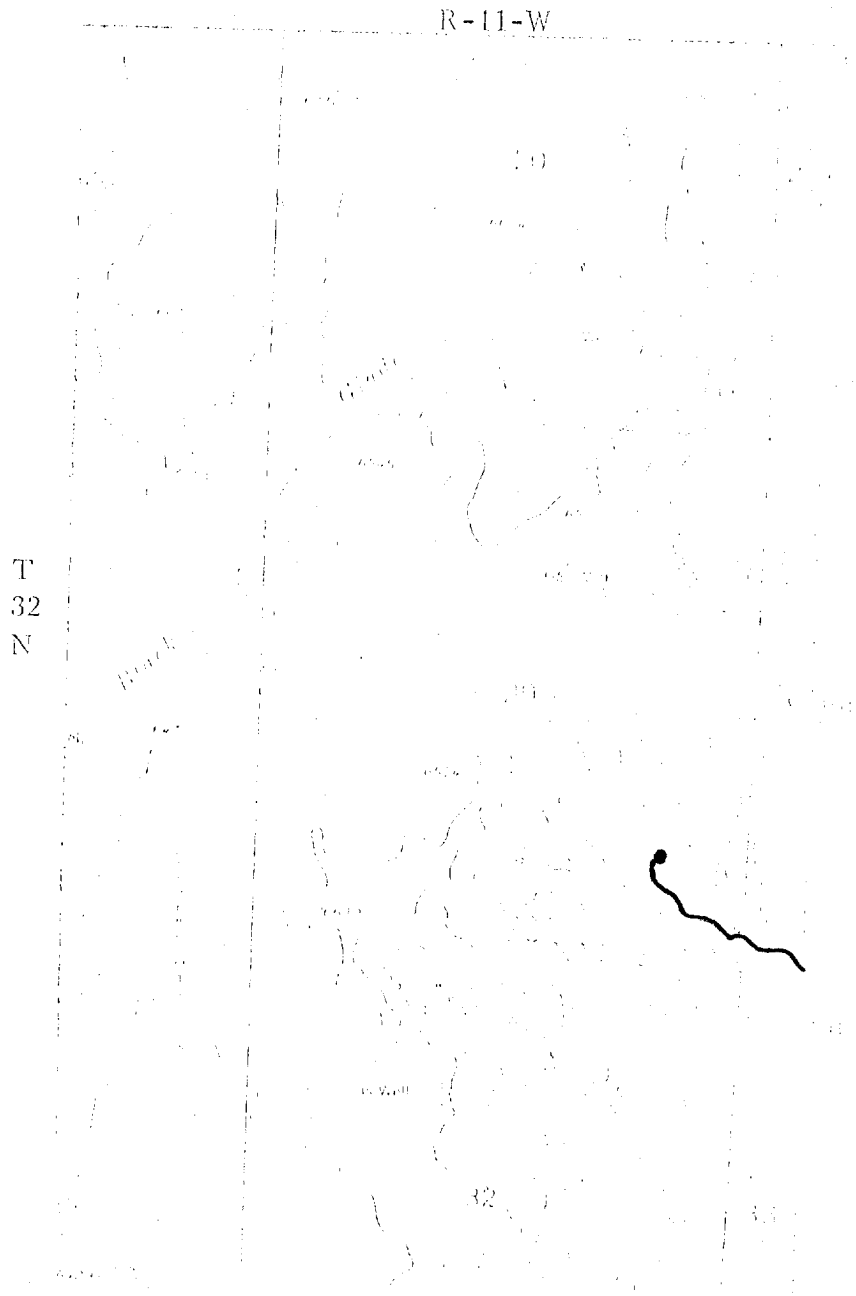

MAP #1

Legend

Section 32	---
Section 33	---
Section 34	---
Section 35	---
Section 36	---
Section 37	---
Section 38	---
Section 39	---
Section 40	---
Section 41	---
Section 42	---
Section 43	---
Section 44	---
Section 45	---
Section 46	---
Section 47	---
Section 48	---
Section 49	---
Section 50	---
Section 51	---
Section 52	---
Section 53	---
Section 54	---
Section 55	---
Section 56	---
Section 57	---
Section 58	---
Section 59	---
Section 60	---
Section 61	---
Section 62	---
Section 63	---
Section 64	---
Section 65	---
Section 66	---
Section 67	---
Section 68	---
Section 69	---
Section 70	---
Section 71	---
Section 72	---
Section 73	---
Section 74	---
Section 75	---
Section 76	---
Section 77	---
Section 78	---
Section 79	---
Section 80	---
Section 81	---
Section 82	---
Section 83	---
Section 84	---
Section 85	---
Section 86	---
Section 87	---
Section 88	---
Section 89	---
Section 90	---
Section 91	---
Section 92	---
Section 93	---
Section 94	---
Section 95	---
Section 96	---
Section 97	---
Section 98	---
Section 99	---
Section 100	---



# EL PASO NATURAL GAS COMPANY

Field's #3A

SE 29-32-11

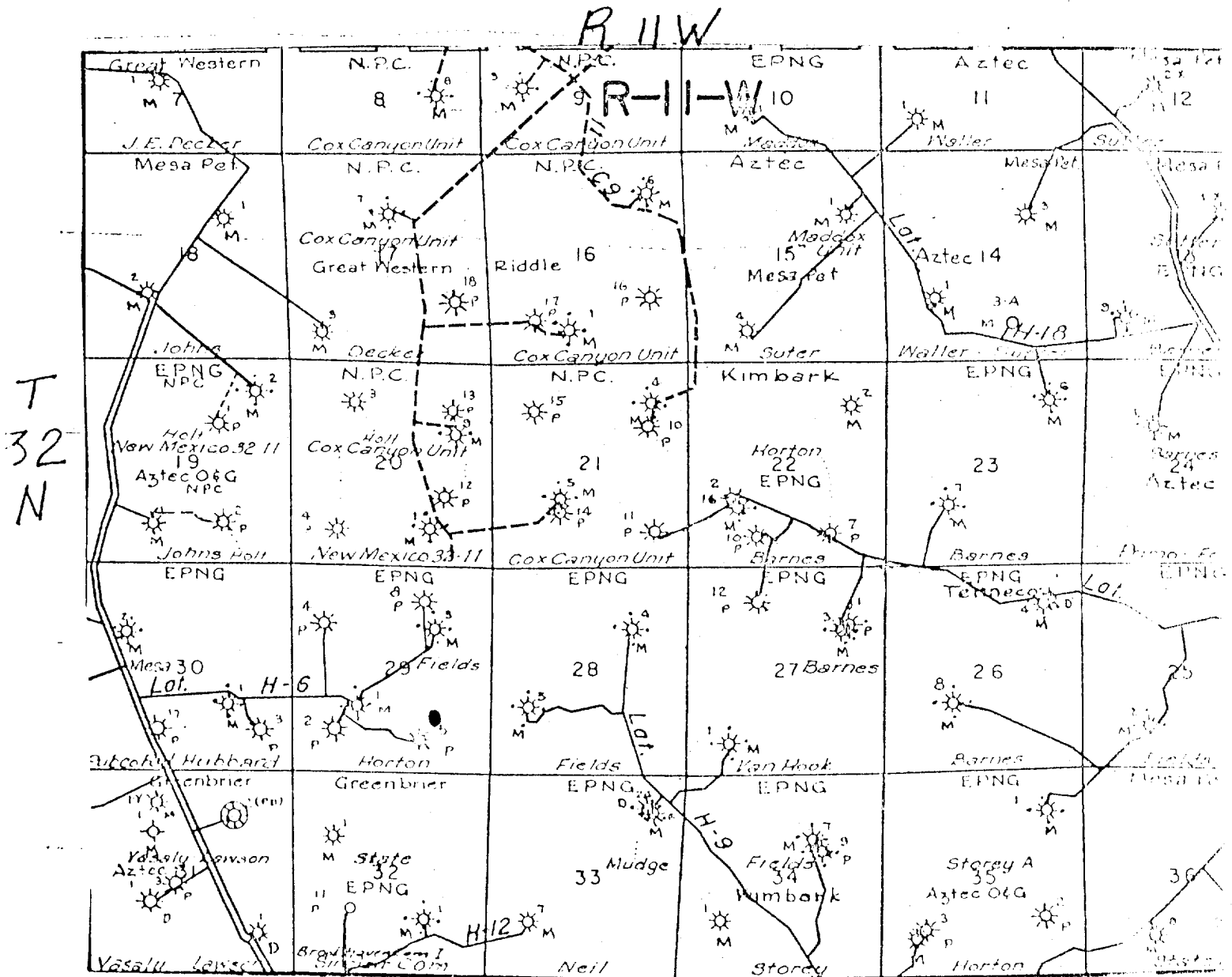

MAP #2

Proposed Location