

06
District I
P. J. *Barney S. Frost*
DEPUTY OIL & GAS INSPECTOR

District III
1000 Rio Brazos Rd, Aztec, NM 87401
SEP 08 1999

State of New Mexico
Energy, Minerals and Natural Resources Department

OIL CONSERVATION DIVISION

2040 South Pacheco Street
Santa Fe, New Mexico 87505

SUBMIT 1 COPY TO
APPROPRIATE
DISTRICT OFFICE
AND 1 COPY TO
SANTA FE OFFICE

PIT REMEDIATION AND CLOSURE REPORT

RECEIVED
JUL 30 1999
OIL CON. DIV.
DIST. 3

Approved

Operator: PNM Gas Services (Burlington) **Telephone:** 324-3764

Address: 603 W. Elm Street Farmington, NM 87401

Facility or Well Name: Hubbard #3A

Location: Unit E Sec 15 T 32N R 12W County San Juan

Pit Type: Separator ☐ Dehydrator ☒ Other _____

Land Type: BLM ☐ State ☐ Fee ☒ Other _____

Pit Location: Pit dimensions: length 20 ' width 20 ' depth 3 '

(Attach diagram) Reference: wellhead ☒ other _____

Footage from reference: 75 '

Direction from reference: 30 Degrees ☒ East North ☐
of ☐ West South ☒

Depth to Ground Water:

(Vertical distance from contaminants to
seasonal high water elevation of ground
water)

| | | |
|-----------------------|-------------|----------|
| Less than 50 feet | (20 points) | |
| 50 feet to 99 feet | (10 points) | |
| Greater than 100 feet | (0 points) | <u>0</u> |

Wellhead Protection Area:

(Less than 200 feet from a private
domestic water source, or; less than 1,000
feet from all other water sources)

| | | |
|-----|-------------|----------|
| Yes | (20 points) | |
| No | (0 points) | <u>0</u> |

Distance to Surface Water:

(Horizontal distance to perennial lakes,
ponds, rivers, streams, creeks, irrigation
canals and ditches)

| | | |
|-------------------------|-------------|----------|
| Less than 200 feet | (20 points) | |
| 200 feet to 1,000 feet | (10 points) | |
| Greater than 1,000 feet | (0 points) | <u>0</u> |

RANKING SCORE (TOTAL POINTS): 0

Hubbard #3A

Date Remediation Started: 04/29/1999

Date Completed: 04/29/1999

Remediation Method:

Excavation ☒

Approx. Cubic Yard 462

(Check all appropriate sections)

Landfarmed ☒

Amount Landfarmed (cubic yds) 402

Other 60 cu. yds. overburden

Remediation Location:

Onsite ☒Offsite ☐

(i.e., landfarmed onsite, name and location of offsite facility)

Backfill Material Location:

General Description of Remedial Action:

Excavated contaminated soil to a pit size of 24' X 26' X 20' and landfarmed soil onsite within a bermed area at a depth of 6" to 12". Soil was aerated by disking/plowing until soil met regulatory levels.

Ground Water Encountered:

No ☒Yes ☐

Depth

Final Pit Closure Sampling:

Sample Location

3 pt. composite - bottom.

(if multiple samples, attach sample result and diagram of sample locations and depths.)

Sample depth

20'

Sample date

04/29/1999

Sample time

11:50:00 AM

Sample Results

Benzene (ppm) < 0.025

Total BTEX (ppm) 1.138

Field headspace (ppm)

TPH (ppm)

130.00

Method

8015B

Vertical Extent (ft)

Risk Analysis form attached Yes ☐ No ☒

Ground Water Sample:

Yes ☐No ☒

(If yes, see attached Groundwater Site Summary Report)

I HEREBY CERTIFY THAT THE INFORMATION ABOVE IS TRUE AND COMPLETE TO THE BEST OF MY KNOWLEDGE AND MY BELIEF

DATE July 27, 1999

SIGNATURE

PRINTED NAME Maureen Gannon
AND TITLE Project Manager

Hubbard # 3A
Burlington
Sec. 15, 32N, 12W, E

4/29/99



Site diagram:

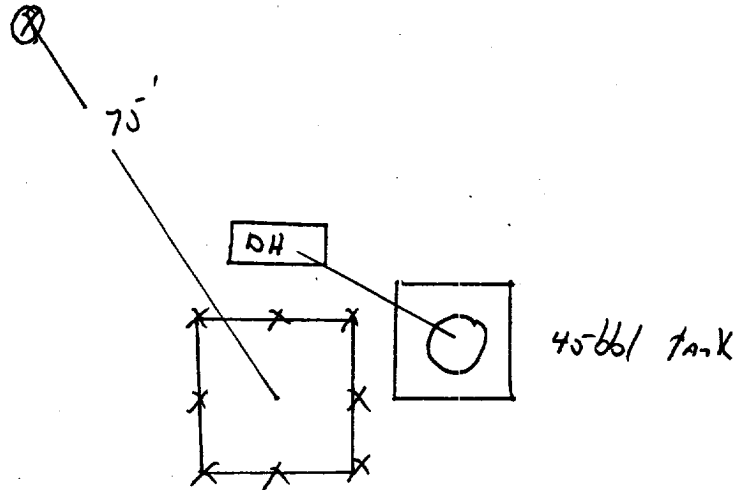

End of excavation:

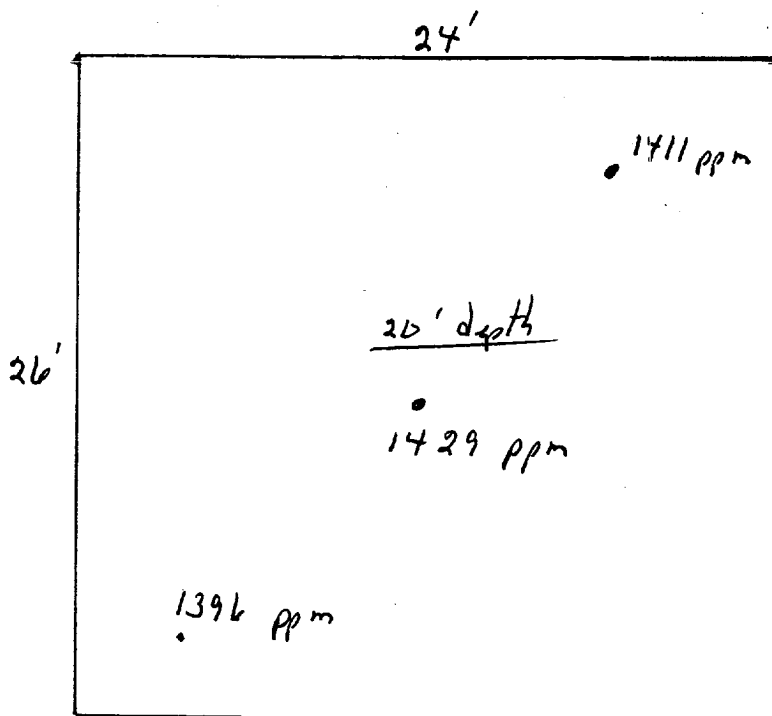

OFF: (505) 325-5667



LAB: (505) 325-1556

On Site Technologies, LTD.

Date: 14-May-99

CLIENT: PNM - Public Service Company of NM

Project: Hubbard #3A

Lab Order: 9904073

CASE NARRATIVE

Samples were analyzed using the methods outlined in the following references:

Test Methods for Evaluating Solid Waste, Physical/Chemical Methods, SW846, 3rd Edition

All method blanks, laboratory spikes, and/or matrix spikes met quality assurance objectives.

LC

OFF: (505) 325-5667



LAB: (505) 325-1556

ANALYTICAL REPORT

Date: 14-May-99

| | | | |
|--------------------|------------------------------------|----------------------------|---------------------------|
| Client: | PNM - Public Service Company of NM | Client Sample Info: | Hubbard #3A |
| Work Order: | 9904073 | Client Sample ID: | 9904291150; Bottom @ 20ft |
| Lab ID: | 9904073-01A | Matrix: | SOIL |
| Project: | Hubbard #3A | Collection Date: | 4/29/99 11:50:00 AM |
| | | COC Record: | 7583 |

| Parameter | Result | PQL | Qual | Units | DF | Date Analyzed |
|-------------------------------------|--------|----------------|------|-------------|----|---------------|
| DIESEL RANGE ORGANICS | | SW8015B | | Analyst: DC | | |
| T/R Hydrocarbons: C10-C28 | 130 | 25 | | mg/Kg | 1 | 5/12/99 |
| AROMATIC VOLATILES BY GC/PID | | SW8021B | | Analyst: DC | | |
| Benzene | ND | 25 | | µg/Kg | 25 | 5/11/99 |
| Toluene | ND | 50 | | µg/Kg | 25 | 5/11/99 |
| Ethylbenzene | 38 | 25 | | µg/Kg | 25 | 5/11/99 |
| m,p-Xylene | 780 | 50 | | µg/Kg | 25 | 5/11/99 |
| o-Xylene | 320 | 25 | | µg/Kg | 25 | 5/11/99 |

1138
1.138 ppm

| | | |
|--------------------|---|---|
| Qualifiers: | PQL - Practical Quantitation Limit | S - Spike Recovery outside accepted recovery limits |
| | ND - Not Detected at Practical Quantitation Limit | R - RPD outside accepted recovery limits |
| | J - Analyte detected below Practical Quantitation Limit | E - Value above quantitation range |
| | B - Analyte detected in the associated Method Blank | Surr: - Surrogate |

P.O. BOX 2606 • FARMINGTON, NM 87499

- TECHNOLOGY BLENDING INDUSTRY WITH THE ENVIRONMENT -

OFF: (505) 325-5667



LAB: (505) 325-1556

ANALYTICAL REPORT

Date: 14-May-99

| | | | |
|--------------------|------------------------------------|----------------------------|--------------------------|
| Client: | PNM - Public Service Company of NM | Client Sample Info: | Hubbard #3A |
| Work Order: | 9904073 | Client Sample ID: | 9904291155; Walls @ 15ft |
| Lab ID: | 9904073-02A | Matrix: | SOIL |
| Project: | Hubbard #3A | Collection Date: | 4/29/99 11:55:00 AM |
| | | COC Record: | 7583 |

| Parameter | Result | PQL | Qual | Units | DF | Date Analyzed |
|------------------------------|--------|----------------|------|-------|----|---------------|
| DIESEL RANGE ORGANICS | | SW8015B | | | | Analyst: DC |
| T/R Hydrocarbons: C10-C28 | ND | 25 | | mg/Kg | 1 | 5/5/99 |

Qualifiers:

PQL - Practical Quantitation Limit

S - Spike Recovery outside accepted recovery limits

ND - Not Detected at Practical Quantitation Limit

R - RPD outside accepted recovery limits

J - Analyte detected below Practical Quantitation Limit

E - Value above quantitation range

B - Analyte detected in the associated Method Blank

Surr: - Surrogate

1 of 1

P.O. BOX 2606 • FARMINGTON, NM 87499

TECHNOLOGIES, LTD. REPORTING IN ACCORDANCE WITH THE ENVIRONMENT

Hubbard 3A
Sec. 15 T-32N R-12W 4LE
Burlington

LAND FARM DRAWING

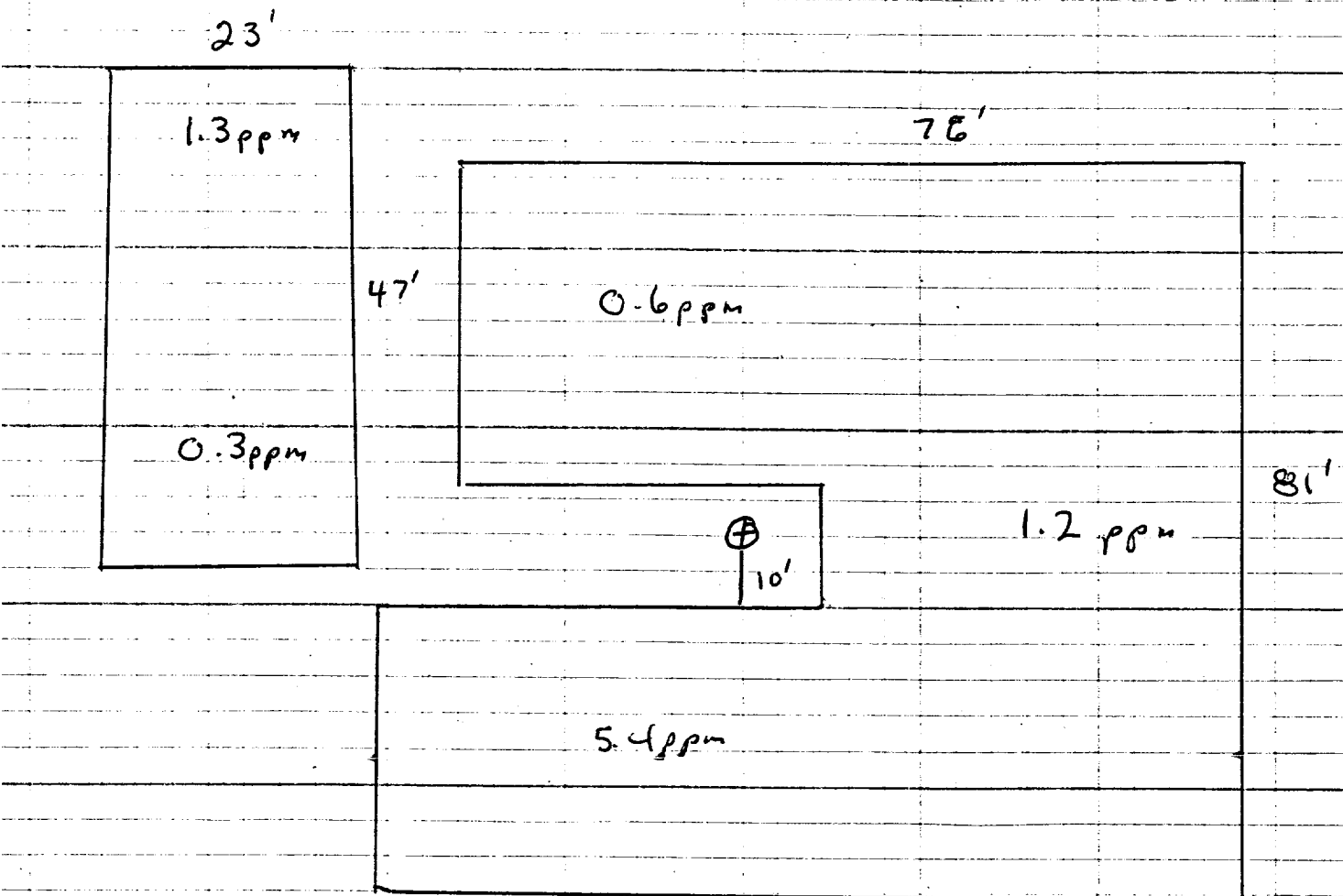

2" to 12" Depth
Headspace 12.3 ppm
Sample ~~9906099200~~
9906091200

Not to Scale

OFF: (505) 325-5667



LAB: (505) 325-1556

On Site Technologies, LTD.

Date: 21-Jun-99

CLIENT: PNM - Public Service Company of NM

Project: PNM Landfarms

Lab Order: 9906041

CASE NARRATIVE

Samples were analyzed using the methods outlined in the following references:

Test Methods for Evaluating Solid Waste, Physical/Chemical Methods, SW846, 3rd Edition

All method blanks, laboratory spikes, and/or matrix spikes met quality assurance objectives.

RB

OFF: (505) 325-5667



LAB: (505) 325-1556

ANALYTICAL REPORT

Date: 21-Jun-99

| | | | |
|--------------------|------------------------------------|----------------------------|-----------------------|
| Client: | PNM - Public Service Company of NM | Client Sample Info: | Hubbard #3A LF |
| Work Order: | 9906041 | Client Sample ID: | 9906091200; 5pt. Comp |
| Lab ID: | 9906041-03A | Matrix: | SOIL |
| Project: | PNM Landfarms | Collection Date: | 6/9/99 12:00:00 PM |
| | | COC Record: | 7717 |

| Parameter | Result | PQL | Qual | Units | DF | Date Analyzed |
|------------------------------|--------|----------------|------|-------|----|--------------------|
| DIESEL RANGE ORGANICS | | SW8015B | | | | Analyst: DC |
| T/R Hydrocarbons: C10-C28 | ND | 25 | | mg/Kg | 1 | 6/16/99 |

Qualifiers:

PQL - Practical Quantitation Limit

S - Spike Recovery outside accepted recovery limits

ND - Not Detected at Practical Quantitation Limit

R - RPD outside accepted recovery limits

J - Analyte detected below Practical Quantitation Limit

E - Value above quantitation range

B - Analyte detected in the associated Method Blank

Surr: - Surrogate

1 of 1

P.O. BOX 2606 • FARMINGTON, NM 87499

TECHNOLOGIES, LTD. • SERVING THE ENVIRONMENT