

NO. OF COPIES RECEIVED	6
DISTRIBUTION	
SANTA FE	1
FILE	2
U.S.G.S.	2
LAND OFFICE	
OPERATOR	2

# NEW MEXICO OIL CONSERVATION COMMISSION

30-046-22848  
Form C-101  
Revised 1-1-65

APPROVAL VALID  
FOR 90 DAYS UNLESS  
APPLICANT COMMENCED

5A. Indicate Type of Lease	STATE <input type="checkbox"/>	FEE <input checked="" type="checkbox"/>
5. State Oil & Gas Lease No.		

EXPIRES 3-16-78

## APPLICATION FOR PERMIT TO DRILL, DEEPEN, OR PLUG BACK

1a. Type of Work		7. Unit Agreement Name	
b. Type of Well OIL WELL <input type="checkbox"/> GAS WELL <input checked="" type="checkbox"/> OTHER <input type="checkbox"/>		8. Farm or Lease Name Culpepper Martin	
2. Name of Operator Aztec Oil & Gas Company		9. Well No. #9A	
3. Address of Operator P. O. Drawer 570, Farmington, New Mexico		10. Field and Pool, or Willent Blanco Mesa Verde	
4. Location of Well UNIT LETTER A LOCATED 1130 FEET FROM THE North LINE		12. County San Juan	
AND 1180 FEET FROM THE East LINE OF SEC. 30 TWP. 32N RGE. 12W NMPM			
19. Proposed Depth 4917'		19A. Formation Mesa Verde	
20. Rotary or C.T. Rotary			
21. Elevations (Show whether DP, RT, etc.) 5858' GR		22. Approx. Date Work will start January 15, 1978	

23.

### PROPOSED CASING AND CEMENT PROGRAM

SIZE OF HOLE	SIZE OF CASING	WEIGHT PER FOOT	SETTING DEPTH	SACKS OF CEMENT	EST. TOP
12-1/4"	9-5/8"	36#	200'	130 cu. ft.	Circ to surface
8-3/4"	7"	20#	2470'	340 cu. ft.	Cover Ojo Alamo
6-1/4"	4-1/2"	10.50#	2320'-4917'	452 cu. ft.	Other top
	2-3/8"	4.7#	4850'		

Surface formation is Nacimiento.

Top of Ojo Alamo sand is at 962'.

Top of Pictured Cliffs sand is at 2170'.

A fresh water mud system will be used for drilling to intermediate casing point.

An air system will be used for drilling from intermediate casing point to TD. It is anticipated that Gamma Ray Induction and Gamma Ray Density logs be run at total depth.

No abnormal pressures or poisonous gases are anticipated in this well.

It is expected that this well be drilled before April 1, 1978. This depends on time required for approvals, rig availability and the weather.

Gas is dedicated.

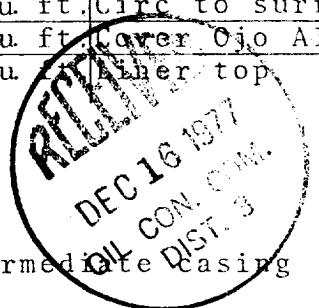

IN ABOVE SPACE DESCRIBE PROPOSED PROGRAM: IF PROPOSAL IS TO DEEPEN OR PLUG BACK, GIVE DATA ON PRESENT PRODUCTIVE ZONE AND PROPOSED NEW PRODUCTIVE ZONE. GIVE BLOWOUT PREVENTER PROGRAM, IF ANY.

I hereby certify that the information above is true and complete to the best of my knowledge and belief.

Signed [Signature] Title Dist. Production Manager Date December 15, 1977

(This space for State Use)

APPROVED BY [Signature] TITLE SUPERVISOR DIST. DATE DEC 16 1977

CONDITIONS OF APPROVAL, IF ANY:

NEW MEXICO OIL CONSERVATION COMMISSION  
WELL LOCATION AND ACREAGE DEDICATION PLAT

Form C-102  
Supersedes C-128  
Effective 1-1-65

All distances must be from the outer boundaries of the Section.

Operator <b>Aztec Oil &amp; Gas Company</b>			Lease <b>Culpepper-Martin</b>		Well No. <b>9A</b>
Unit Letter <b>A</b>	Section <b>30</b>	Township <b>32N</b>	Range <b>12W</b>	County <b>San Juan</b>	
Actual Footage Location of Well: <b>1130</b> feet from the <b>North</b> line and <b>1180</b> feet from the <b>East</b> line					
Ground Level Elev. <b>5858</b>	Producing Formation <b>Mesa Verde</b>	Pool <b>Blanco</b> ✓	Dedicated Acreage: <b>317.60</b> Acres		

1. Outline the acreage dedicated to the subject well by colored pencil or hachure marks on the plat below.
2. If more than one lease is dedicated to the well, outline each and identify the ownership thereof (both as to working interest and royalty).
3. If more than one lease of different ownership is dedicated to the well, have the interests of all owners been consolidated by communitization, unitization, force-pooling, etc?

☐ Yes ☐ No If answer is "yes," type of consolidation \_\_\_\_\_

If answer is "no," list the owners and tract descriptions which have actually been consolidated. (Use reverse side of this form if necessary.) \_\_\_\_\_

No allowable will be assigned to the well until all interests have been consolidated (by communitization, unitization, forced-pooling, or otherwise) or until a non-standard unit, eliminating such interests, has been approved by the Commission.

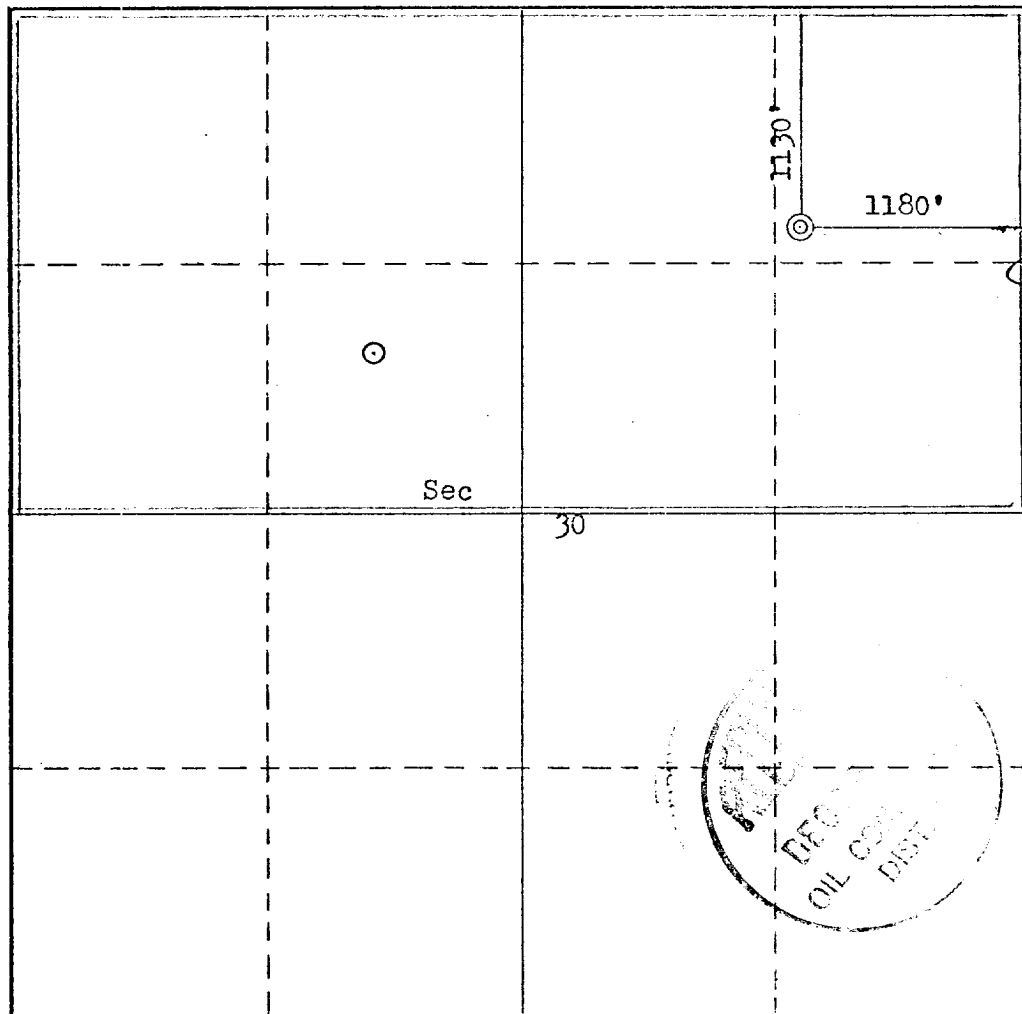

CERTIFICATION

I hereby certify that the information contained herein is true and complete to the best of my knowledge and belief.

Name: *Stan Ryan*  
 Position: **Dist. Production Manager**  
 Company: **Aztec Oil & Gas Company**

Date: **December 15, 1977**

I hereby certify that the well location shown on this plat was plotted from field notes of actual surveys made by me or under my supervision, and that the same is true and correct to the best of my knowledge and belief.

Date Surveyed: **October 28, 1977**

Registered Professional Engineer and/or Land Surveyor

*Fred B. Kerr*  
**Fred B. Kerr**

Certificate No.

**3950**

