

NO. OF COPIES RECEIVED	6
DISTRIBUTION	
SANTA FE	1
FILE	1
U.S.G.S.	2
LAND OFFICE	1
OPERATOR	1

NEW MEXICO OIL CONSERVATION COMMISSION

30-043-22243
Form C-101
Revised 1-1-65

003-E-4700-2
005-E-453-7

5A. Indicate Type of Lease STATE <input checked="" type="checkbox"/> FEE <input type="checkbox"/>
5. State Oil & Gas Lease No. 001-E-5152-1, 002-E-3157-3

APPLICATION FOR PERMIT TO DRILL, DEEPEN, OR PLUG BACK

1a. Type of Work b. Type of Well OIL WELL <input type="checkbox"/> GAS WELL <input checked="" type="checkbox"/> OTHER <input type="checkbox"/>		DRILL <input checked="" type="checkbox"/> DEEPEN <input type="checkbox"/> PLUG BACK <input type="checkbox"/>		7. Unit Agreement Name	
2. Name of Operator Mesa Petroleum Co.		8. Farm or Lease Name STATE COM F		9. V. No. 1 A	
3. Address of Operator P.O. Box 2009, Amarillo, Texas 79105		10. Field and Pool, or Wildcat Blanco Mesa Verde		11. Field and Pool, or Wildcat Blanco P.C. - Ext.	
4. Location of Well UNIT LETTER P LOCATED 790' FEET FROM THE South LINE AND 790' FEET FROM THE East LINE OF SEC. 36 TWP. 32N RGE. 12W NMPM		19. Proposed Depth 5550		20. Rotary or C.T. Rotary	
21. Elevations (Show whether DF, RT, etc.) 6381 G.L.		21A. Kind & Status Plug. Bond State Wide		22. Approx. Date Work will start March 1, 1978	
21B. Drilling Contractor Young Drilling		20A. Formation Pictured Cliffs Mesa Verde			

23.

PROPOSED CASING AND CEMENT PROGRAM

SIZE OF HOLE	SIZE OF CASING	WEIGHT PER FOOT	SETTING DEPTH	SACKS OF CEMENT	EST. TOP
17 1/4"	10 3/4"	40.50	200	350	Surface
8 1/2"	7"	23.0	3200	225	1500
6 1/4"	4 1/2" (liner)	10.5	5550	260	3000

Drill 17 1/4" hole to 200' and cement casing as above. Install and test blowout preventer prior to drilling out from under surface.

Drill 8 1/2" hole to 3200' using native mud with following properties: wt. 8.9, vis. 32, w.l. 15±. Open hole logs, IES and FDC-CNL with gamma ray and caliper will be run over the Pictured Cliffs Section to determine if it is commercial. The 7" casing will be run and cemented as above.

A 6 1/4" hole will be gas drilled from under intermediate to t.d. If open hole logs show commercial gas, a 4 1/2" liner will be run and cemented as above. If non-commercial, the well will be plugged according to state instructions.

Gas under this lease is dedicated to a contract.

IN ABOVE SPACE DESCRIBE PROPOSED PROGRAM; IF PROPOSAL IS TO DEEPEN OR PLUG BACK, GIVE DATA ON PRESENT PRODUCTIVE ZONE AND PROPOSED NEW PRODUCTIVE ZONE. GIVE BLOWOUT PREVENTER PROGRAM, IF ANY.

I hereby certify that the information above is true and complete to the best of my knowledge and belief.

Signed John Alexander Title Agent Date 2-23-78
(This space for State Use)

APPROVED BY AR Kendrick TITLE SUPERVISOR DATE FEB 22 1978
CONDITIONS OF APPROVAL, IF ANY:

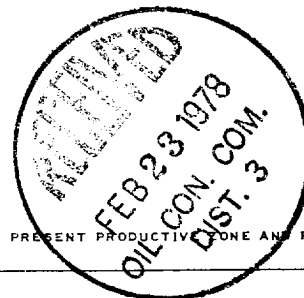

NEW MEXICO OIL CONSERVATION COMMISSION
WELL LOCATION AND ACREAGE DEDICATION PLAT

Form C-102
Supersedes C-128
Effective 1-1-65

All distances must be from the outer boundaries of the Section.

Operator Mesa Petroleum Company		Lease State Com F		Well No. 1 A	
Unit Letter P	Section 36	Township 32N	Range 12W	County San Juan	
Actual Footage Location of Well: 790 feet from the South line and 790 feet from the East line					
Ground Level Elev. 6381	Producing Formation Mesa Verde Pictured Cliff		Pool Blanco Mesa Verde		Dedicated Acreage: 320 Acres
Blanco Pictured Cliff-Ext. PC 160, MV 160					

1. Outline the acreage dedicated to the subject well by colored pencil or hachure marks on the plat below.
2. If more than one lease is dedicated to the well, outline each and identify the ownership thereof (both as to working interest and royalty).
3. If more than one lease of different ownership is dedicated to the well, have the interests of all owners been consolidated by communitization, unitization, force-pooling, etc?

☒ Yes ☐ No If answer is "yes," type of consolidation Communitization

If answer is "no," list the owners and tract descriptions which have actually been consolidated. (Use reverse side of this form if necessary.)

No allowable will be assigned to the well until all interests have been consolidated (by communitization, unitization, forced-pooling, or otherwise) or until a non-standard unit, eliminating such interests, has been approved by the Commission.

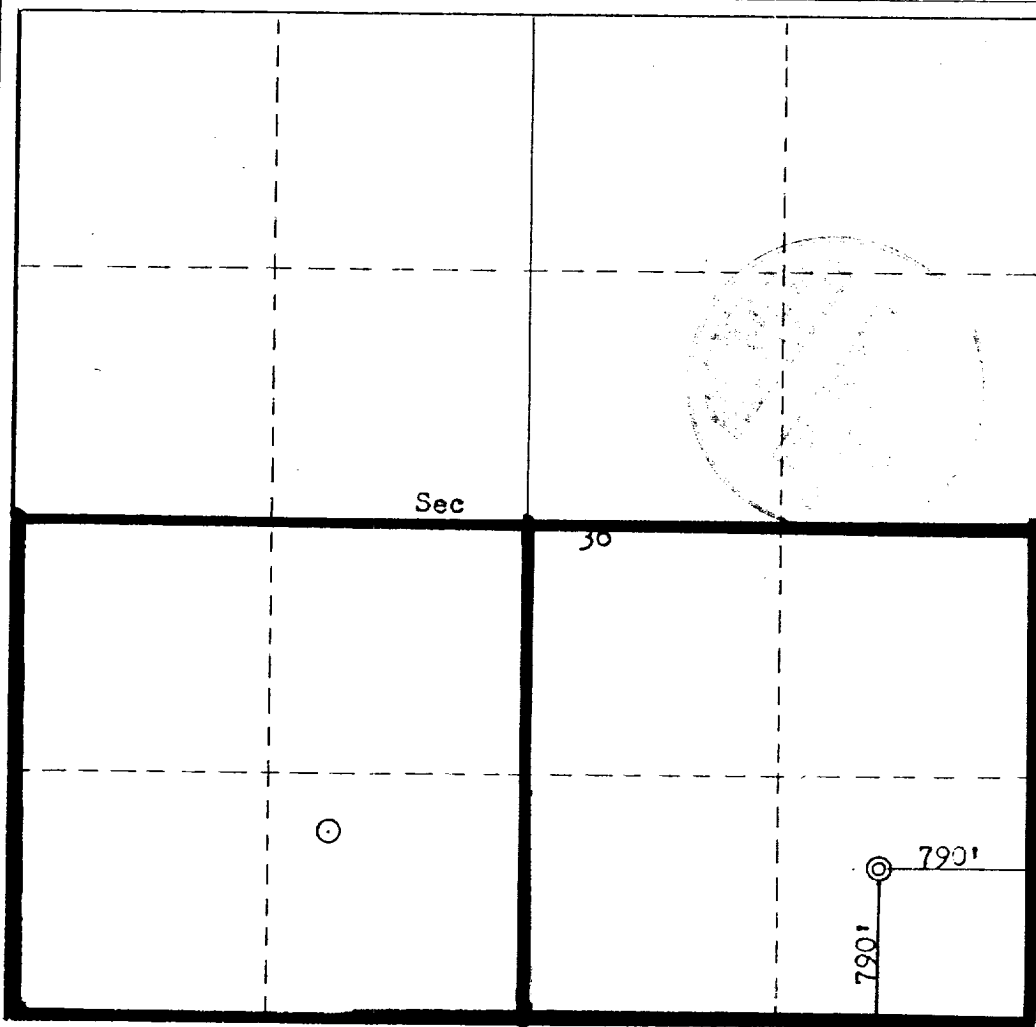

CERTIFICATION

I hereby certify that the information contained herein is true and complete to the best of my knowledge and belief.

John Alexander

Name

Agent

Position

Mesa Petroleum

Company

2-23-78

Date

John Alexander

I hereby certify that the well location shown on this plat was plotted from field notes of actual surveys made by me or under my supervision, and that the same is true and correct to the best of my knowledge and belief.

Date Surveyed

February 6, 1978

Registered Professional Engineer and/or Land Surveyor

Fred B. Kerr Jr.

Certificate No.

3950

