

NO. OF COPIES RECEIVED	
DIS.	
SANTA FE	
FILE	
U.S.G.S.	
LAND OFFICE	
OPERATOR	

NEW MEXICO OIL CONSERVATION COMMISSION

Form C-101
Revised 1-1-65

5A. Indicate Type of Lease	
STATE <input checked="" type="checkbox"/>	FEE <input type="checkbox"/>
5. State Oil & Gas Lease No.	
R - 11318 -27	

APPLICATION FOR PERMIT TO DRILL, DEEPEN, OR PLUG BACK

1a. Type of Work		7. Unit Agreement Name	
b. Type of Well DRILL <input checked="" type="checkbox"/> DEEPEN <input type="checkbox"/> PLUG BACK <input type="checkbox"/> OIL WELL <input type="checkbox"/> GAS WELL <input checked="" type="checkbox"/> OTHER <input type="checkbox"/> SINGLE ZONE <input checked="" type="checkbox"/> MULTIPLE ZONE <input type="checkbox"/>		8. Farm or Lease Name Sinclair Com.	
2. Name of Operator El Paso Natural Gas Company		9. Well No. 1A	
3. Address of Operator P.O. Box 990 Farmington, NM		10. Field and Pool, or Wildcat Blanco Mesa Verde	
4. Location of Well UNIT LETTER M LOCATED 830 FEET FROM THE south LINE AND 990 FEET FROM THE west LINE OF SEC. 32 TWP. 32N RGE. 11W NMPM		12. County San Juan	
19. Proposed Depth 5885		19A. Formation Mesa Verde	20. Rotary or C.T. Rotary
21. Elevations (Show whether DF, RT, etc.) 6503 GR.	21A. Kind & Status Plug. Bond Statewide	21B. Drilling Contractor	22. Approx. Date Work will start

23.

PROPOSED CASING AND CEMENT PROGRAM

SIZE OF HOLE	SIZE OF CASING	WEIGHT PER FOOT	SETTING DEPTH	SACKS OF CEMENT	EST. TOP
13 3/4	9 5/8	32.3	200	190	circulate
8 3/4	7	20	3600	345	top of Ojo Ala
6 1/4	4 1/2 liner	10.5	3450 - 5885	305	3450

Selectively perforate and sand water fracture the Mesa Verde formation.

A 3000 psi WP and 6000 psi test double gate preventor equipped with blind and pipe rams will be used for blow out prevention on this well.

This gas is dedicated.

The S / 2 of Sec. 32 is dedicated to this well.

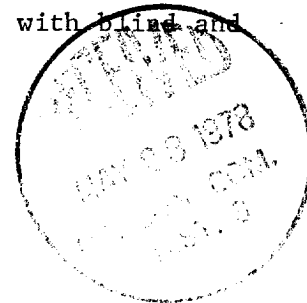

EXPIRES 8-21-78

IN ABOVE SPACE DESCRIBE PROPOSED PROGRAM: IF PROPOSAL IS TO DEEPEN OR PLUG BACK, GIVE DATA ON PRESENT PRODUCTIVE ZONE AND PROPOSED NEW PRODUCTIVE ZONE. GIVE BLOWOUT PREVENTER PROGRAM, IF ANY.

I hereby certify that the information above is true and complete to the best of my knowledge and belief.

Signed D. G. Duise Title Drilling Clerk Date 5-18-78

(This space for State Use)

APPROVED BY MR Kendrick TITLE MANAGER DATE MAY 18 1978

CONDITIONS OF APPROVAL, IF ANY:

**NEW MEXICO OIL CONSERVATION COMMISSION
WELL LOCATION AND ACREAGE DEDICATION PLAT**

Form C-102
Supersedes C-128
Effective 1-1-65

All distances must be from the outer boundaries of the Section.

Operator EL PASO NATURAL GAS COMPANY			Lease Sinclair Com (B-11318-27)		Well No. 1A
Unit Letter M	Section 32	Township 32N	Range 11W	County San Juan	
Actual Footage Location of Well: 880 feet from the South line and 990 feet from the West line					
Ground Level Elev. 6503	Producing Formation Mesa Verde		Pool Blanco Mesa Verde	Dedicated Acreage: 320.00 Acres	

1. Outline the acreage dedicated to the subject well by colored pencil or hachure marks on the plat below.
2. If more than one lease is dedicated to the well, outline each and identify the ownership thereof (both as to working interest and royalty).
3. If more than one lease of different ownership is dedicated to the well, have the interests of all owners been consolidated by communitization, unitization, force-pooling, etc?

☒ Yes ☐ No If answer is "yes," type of consolidation Communitization

If answer is "no," list the owners and tract descriptions which have actually been consolidated. (Use reverse side of this form if necessary.) _____

No allowable will be assigned to the well until all interests have been consolidated (by communitization, unitization, forced-pooling, or otherwise) or until a non-standard unit, eliminating such interests, has been approved by the Commission.

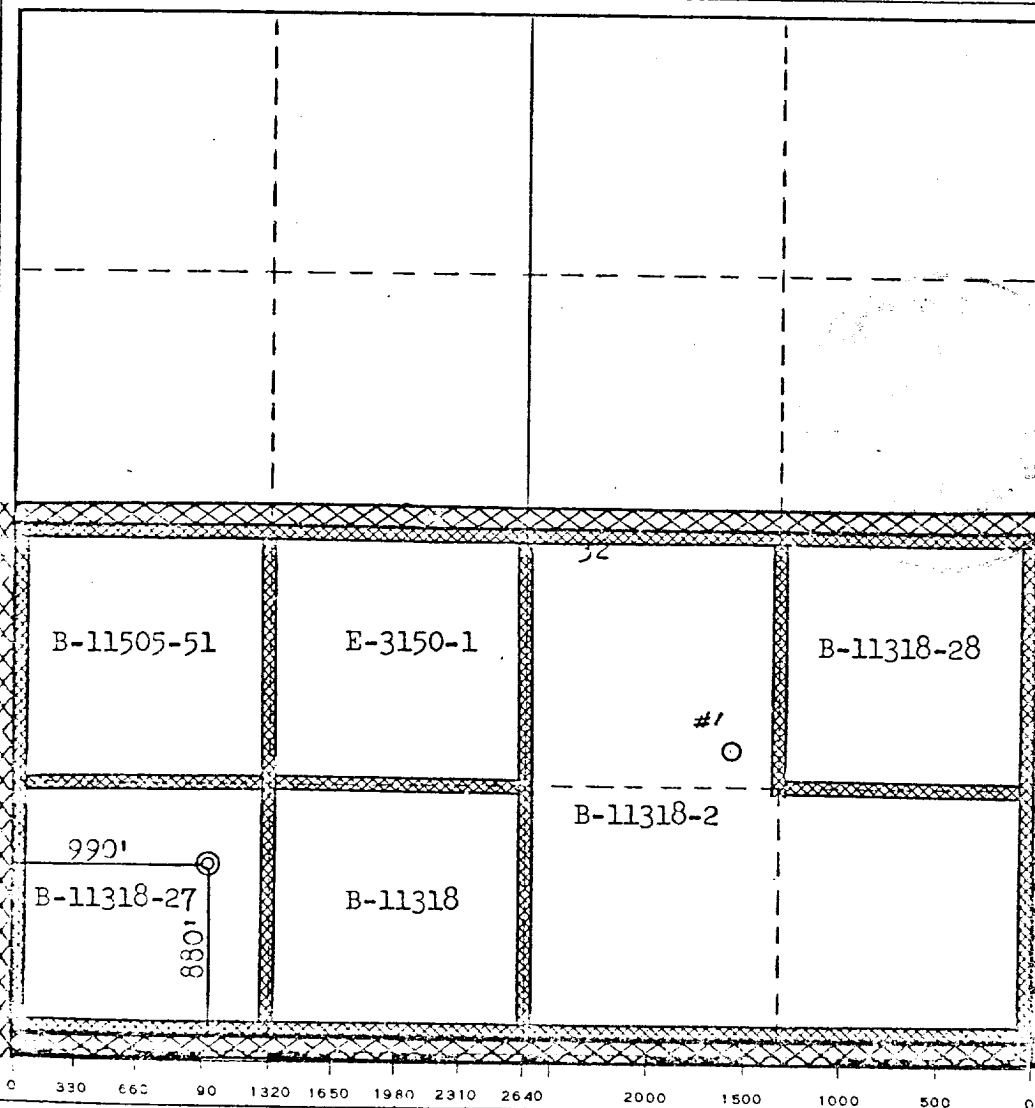

CERTIFICATION

I hereby certify that the information contained herein is true and complete to the best of my knowledge and belief.

D. G. Lucas

Name
Drilling Clerk
Position
El Paso Natural Gas Co.
Company
5-18-78
Date

I hereby certify that the well location shown on this plat was plotted from field notes of actual surveys made by me or under my supervision, and that the same is true and correct to the best of my knowledge and belief.

Date Surveyed
April 20, 1978
Registered Professional Engineer and/or Land Surveyor
Fred B. Kerr, Jr.
Certificate No. **3950**