

NO. OF COPIES RECEIVED	6
DISTRIBUTION	
SANTA FE	1
FILE	2
U.S.G.S.	2
LAND OFFICE	2
OPERATOR	2

NEW MEXICO OIL CONSERVATION COMMISSION

3-045-23132
Form C-101
Revised 1-1-65

5A. Indicate Type of Lease	
STATE <input type="checkbox"/>	FEE <input checked="" type="checkbox"/>
5. State Oil & Gas Lease No.	

APPLICATION FOR PERMIT TO DRILL, DEEPEN, OR PLUG BACK

1a. Type of Work		7. Unit Agreement Name	
b. Type of Well DRILL <input checked="" type="checkbox"/> DEEPEN <input type="checkbox"/> PLUG BACK <input type="checkbox"/> OIL WELL <input type="checkbox"/> GAS WELL <input checked="" type="checkbox"/> OTHER <input type="checkbox"/> SINGLE ZONE <input checked="" type="checkbox"/> MULTIPLE ZONE <input type="checkbox"/>		8. Farm or Lease Name Decker	
2. Name of Operator Southland Royalty Company		9. Well No. 4A	
3. Address of Operator P. O. Drawer 570, Farmington, New Mexico 87401		10. Field and Pool, or Wildcat Blanco Mesaverde	
4. Location of Well UNIT LETTER 0 LOCATED 800 FEET FROM THE South LINE AND 1630 FEET FROM THE East LINE OF SEC. 10 TWP. 32N RGE. 12W NMPM		12. County San Juan	
19. Proposed Depth 4824'		19A. Formation Mesaverde	
20. Rotary or C.T. Rotary		21. Elevations (Show whether DF, RT, etc.) 5862' GR	
21A. Kind & Status Plug. Bond		21B. Drilling Contractor	
22. Approx. Date Work will start 1-15-79			

PROPOSED CASING AND CEMENT PROGRAM

SIZE OF HOLE	SIZE OF CASING	WEIGHT PER FOOT	SETTING DEPTH	SACKS OF CEMENT	EST. TOP
12-1/4"	9-5/8"	36#	200'	125 cu. ft.	Circ. to surface
8-3/4"	7"	20#	2234'	295 cu. ft.	Cover Ojo Alamo
6-1/4"	4-1/2"	10.5#	2084'-4824'	478 cu. ft.	Liner top
	2-3/8"	4.7#	5170'		

Surface formation is Nacimiento.
Top of Ojo Alamo sand is at 924'.
Top of Pictured sand is at 1984'.

Fresh water mud will be used to drill from surface to intermediate casing point.
An air system will be used to drill from intermediate casing point to total depth.
It is anticipated that a Gamma Ray Induction and a Gamma Ray Density log will be run at total depth.

No abnormal pressures or poisonous gases are anticipated in this well.

It is expected that this well will be drilled before April 30, 1978. This depends on time required for approvals, rig availability and the weather.
Gas is dedicated.

EXPIRES 3-14-79

IN ABOVE SPACE DESCRIBE PROPOSED PROGRAM: IF PROPOSAL IS TO DEEPEN OR PLUG BACK, GIVE DATA ON PRESENT PRODUCTIVE ZONE AND PROPOSED NEW PRODUCTIVE ZONE. GIVE BLOWOUT PREVENTER PROGRAM, IF ANY.

I hereby certify that the information above is true and complete to the best of my knowledge and belief.

Signed [Signature] Title District Production Manager Date December 4, 1978

(This space for State Use)

APPROVED BY [Signature] DEPUTY OIL & GAS INSPECTOR, DIST. #3 DATE DEC 14 1978

CONDITIONS OF APPROVAL, IF ANY:

NWU 3-181

NEW MEXICO OIL CONSERVATION COMMISSION
WELL LOCATION AND ACREAGE DEDICATION PLAT

Form C-192
Supersedes C-128
Effective 1-1-65

All distances must be from the outer boundaries of the Section.

Operator SOUTHLAND ROYALTY COMPANY			Lease DECKER		Well No. 1A
Unit Letter 0	Section 10	Township 32N	Range 12W	County San Juan	
Actual Footage Location of Well: 800 feet from the South line and 1630 feet from the East line					
Ground Level Elev: 6093	Producing Formation Mesa Verde		Pool Blanco	Dedicated Acreage: 326.68 Acres	

1. Outline the acreage dedicated to the subject well by colored pencil or hachure marks on the plat below.
2. If more than one lease is dedicated to the well, outline each and identify the ownership thereof (both as to working interest and royalty).
3. If more than one lease of different ownership is dedicated to the well, have the interests of all owners been consolidated by communitization, unitization, force-pooling, etc?

☐ Yes ☐ No If answer is "yes," type of consolidation _____

If answer is "no," list the owners and tract descriptions which have actually been consolidated. (Use reverse side of this form if necessary.) _____

No allowable will be assigned to the well until all interests have been consolidated (by communitization, unitization, forced-pooling, or otherwise) or until a non-standard unit, eliminating such interests, has been approved by the Commission.

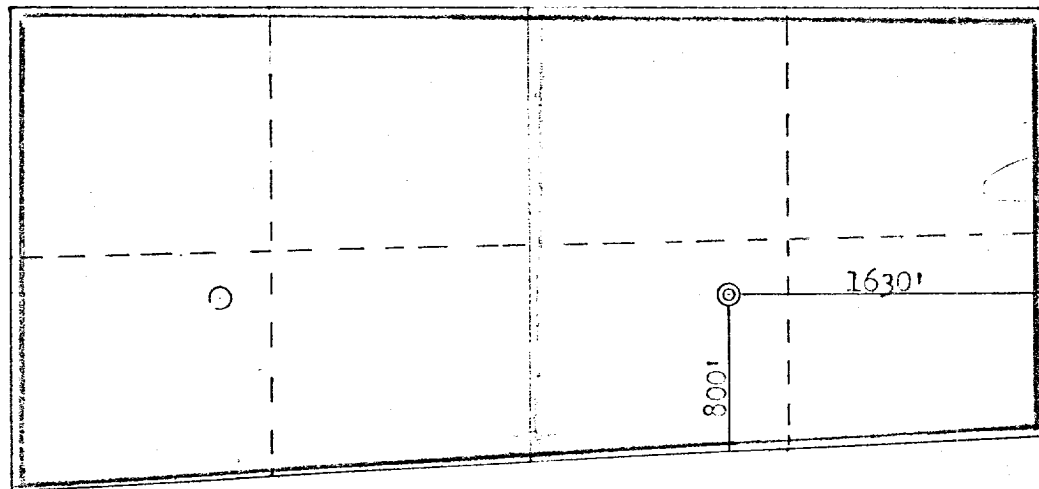

SCALE: 1"=1000'

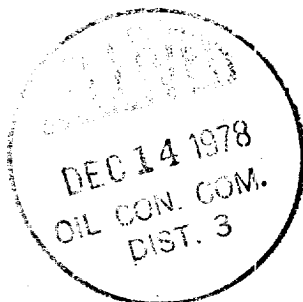

CERTIFICATION

I hereby certify that the information contained herein is true and complete to the best of my knowledge and belief.

Name [Signature]
Position
District Production Manager
Company
Southland Royalty Company
Date
December 4, 1978

I hereby certify that the well location shown on this plat was plotted from field notes of actual surveys made by me or under my supervision, and that the same is true and correct to the best of my knowledge and belief.

Date Surveyed
November 10, 1978
Registered Professional Engineer
and Land Surveyor
[Signature]
Fred B. Kerr Jr.
Certificate No.
3950



Southland Royalty Company

December 4, 1978

Oil Conservation Division
1000 Rio Brazos Road
Aztec, New Mexico 87410

Attention: Mr. Al Kendrick

Dear Sir:

All drilling and completion rigs will be equipped with 6" or larger double gate hydraulic blowout preventers and a hydraulic operated closing unit with steel lines.

The preventer is 3000# working pressure and 6000# test.

All crews will be thoroughly trained in the operation of this preventer. The preventer will be tested frequently enough to insure safe operation.

Yours truly,

L. O. Van Ryan
District Production Manager

LOVR/dg