

NO. OF COPIES RECEIVED	5
DISTRIBUTION	
SANTA FE	
FILE	1
U.S.G.S.	2
LAND OFFICE	
OPERATOR	1

NEW MEXICO OIL CONSERVATION COMMISSION

30-045-20414
Form C-101
Revised 1-1-65

EXPIRES 6-10-79

APPLICATION FOR PERMIT TO DRILL, DEEPEN, OR PLUG BACK

1a. Type of Work		7. Unit Agreement Name	
b. Type of Well OIL WELL <input type="checkbox"/> GAS WELL <input checked="" type="checkbox"/> OTHER <input type="checkbox"/>		8. Farm or Lease Name Ripley	
2. Name of Operator Consolidated Oil & Gas, Inc.		9. Well No. 2-A	
3. Address of Operator 1860 Lincoln Street, Suite 1300, Denver, Colorado 80295		10. Field and Pool, or Willacut Blanco Mesaverde	
4. Location of Well UNIT LETTER "P" LOCATED 790 FEET FROM THE East LINE AND 790 FEET FROM THE South LINE OF SEC. 26 T4N 32N RGE. 13W NMPM		17. County San Juan	
21. Elevations (Show whether DF, RL, etc.) GL 5860'		19a. Formation Mesaverde	20. Rotary or C.T. Rotary
21A. Casing & Plugback Program Blanket/Inforce	21B. Drilling Contractor LLL Drilling Company	22. Approx. Date Work will start April 22, 1979	

PROPOSED CASING AND CEMENT PROGRAM

SIZE OF HOLE	SIZE OF CASING	WEIGHT PER FOOT	SETTING DEPTH	SACKS OF CEMENT	EST. TOP
12-1/4"	8-5/8"	24.0#	250'	200 sx	Surface
7-7/8"	4-1/2"	10.5#	4800'	300 sx	2000'

1. Drill 12-1/4" hole to \pm 250'. Set 8-5/8" casing. Circulate cement to surface.
2. WOC 12 hours.
3. Install blowout preventer. Pressure test surface casing & BOP's to 1000 psig.
4. Drill 7-7/8" hole to \pm 4800' with fresh water gel mud. Log.
5. Run 4-1/2" casing and cement same with approximately 300 sx.
5. Selectively perforate and stimulate the Mesaverde formation per applicable rules and regulations.

The E/2 of Section 26 is dedicated to this well and the acreage is committed to a gas sales contract.

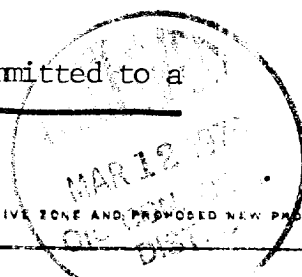

IN ABOVE SPACE DESCRIBE PROPOSED PROGRAM; IF PROPOSAL IS TO DEEPEN OR PLUG BACK, GIVE DATA ON PRESENT PRODUCTIVE ZONE AND PROPOSED NEW PRODUCTIVE ZONE, GIVE BLOWOUT PREVENTER PROGRAM, IF ANY.

I hereby certify that the information above is true and complete to the best of my knowledge and belief.

Signed CM. R. L. L.

Title Sr. Production Engineer

Date 3-9-79

(This space for State Use)

APPROVED BY Frank S. Chung

TITLE DEPUTY OIL & GAS INSPECTOR, DIST. #3

DATE MAR 12 1979

CONDITIONS OF APPROVAL, IF ANY:

**NEW MEXICO OIL CONSERVATION COMMISSION
WELL LOCATION AND ACREAGE DEDICATION PLAT**

Form C-102
Supersedes C-128
Effective 1-1-65

All distances must be from the outer boundaries of the Section.

Operator CONSOLIDATED OIL AND GAS, INC.			Lease RIPLEY		Well No. 2 A
Unit Letter P	Section 26	Township 32 NORTH	Range 13 WEST	County SAN JUAN	
Actual Footage Location of Well: <div style="display: flex; justify-content: space-between; align-items: center;"> 790 feet from the SOUTH line and 790 feet from the EAST line </div>					
Ground Level Elev. 5860	Producing Formation Mesaverde		Pool Blanco Mesaverde		Dedicated Acreage: 160 Acres

1. Outline the acreage dedicated to the subject well by colored pencil or hachure marks on the plat below.
2. If more than one lease is dedicated to the well, outline each and identify the ownership thereof (both as to working interest and royalty).
3. If more than one lease of different ownership is dedicated to the well, have the interests of all owners been consolidated by communitization, unitization, force-pooling, etc?

☒ Yes ☐ No If answer is "yes," type of consolidation Communitization

If answer is "no," list the owners and tract descriptions which have actually been consolidated. (Use reverse side of this form if necessary.) _____

No allowable will be assigned to the well until all interests have been consolidated (by communitization, unitization, forced-pooling, or otherwise) or until a non-standard unit, eliminating such interests, has been approved by the Commission.

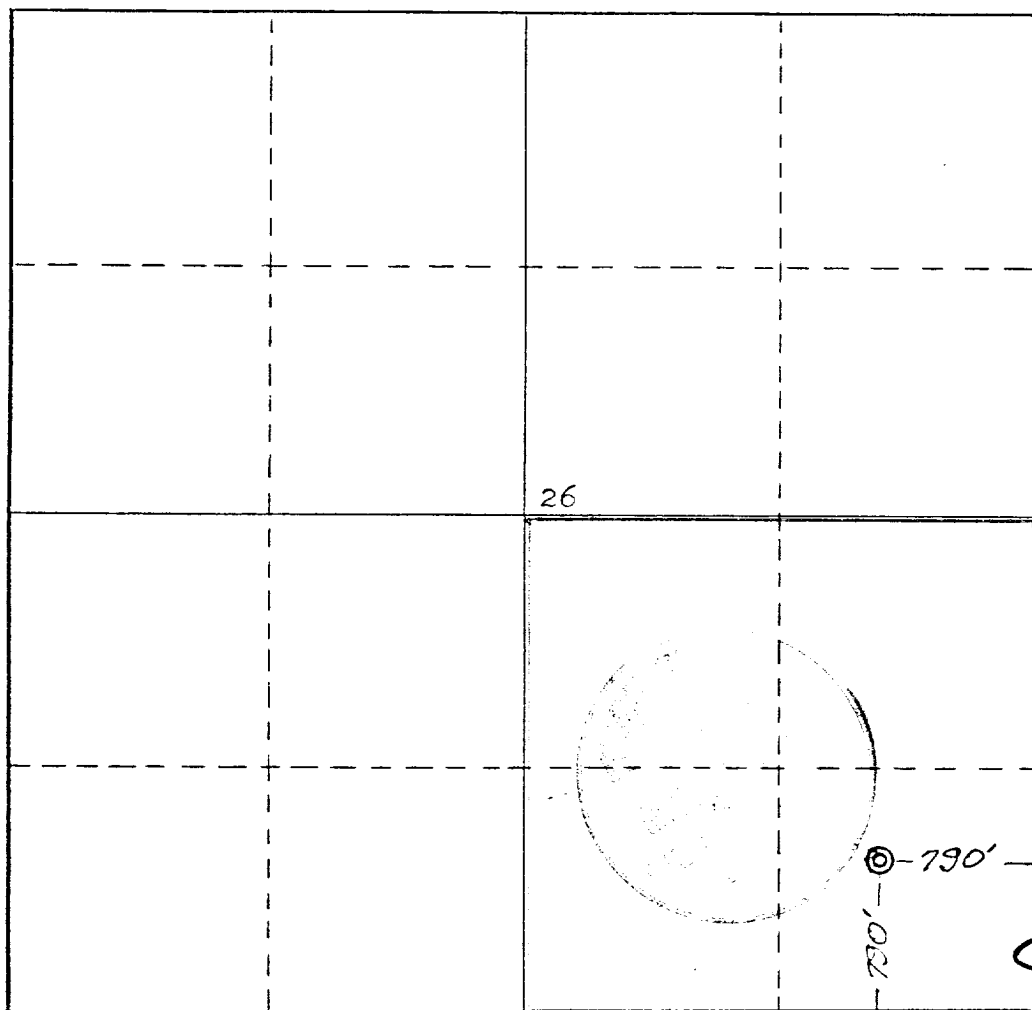

CERTIFICATION

I hereby certify that the information contained herein is true and complete to the best of my knowledge and belief.

C. M. Parham

Name

C. M. Parham

Position

Sr. Production Engineer

Company

Consolidated Oil & Gas, Inc.

Date

3-9-79

I hereby certify that the well location shown on this plat was plotted from field notes of actual surveys made by me or under my supervision, and that the same is true and correct to the best of my knowledge and belief.

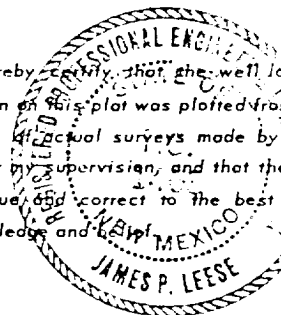

Date Surveyed

20 January 1979

Registered Professional Engineer

and Land Surveyor

James P. Leese
James P. Leese

Certificate No.

12463