

District I
P.O. Box 1980 Santa Fe, NM

District II
P.O. Drawer 1000 Santa Fe, NM 87505

District III
1000 Rio Brazos Rd, Aztec, NM 87410

State of New Mexico
Energy, Minerals and Natural Resources Department

OIL CONSERVATION DIVISION

2040 South Pacheco Street
Santa Fe, New Mexico 87505

SUBMIT 1 COPY TO
APPROPRIATE
DISTRICT OFFICE
AND 1 COPY TO
SANTA FE OFFICE

SEP 03 1999

PIT REMEDIATION AND CLOSURE REPORT

RECEIVED
JUL 30 1999
OIL CON. DIV.
DIST. 3

Operator: PNM Gas Services (Burlington) Telephone: 324-3764

Address: 603 W. Elm Street Farmington, NM 87401

Facility or Well Name: Ripley #2A

Location: Unit P Sec 26 T 32 N R 13 W County San Juan

Pit Type: Separator ☐ Dehydrator ☒ Other

Land Type: BLM ☐ State ☐ Fee ☒ Other

Pit Location: Pit dimensions: length 18' width 18' depth 3'

(Attach diagram) Reference: wellhead ☒ other

Footage from reference: 72'

Direction from reference: 53 Degrees ☐ East North ☒
of ☒ West South ☐

| | | | |
|------------------------|-----------------------|-------------|---|
| Depth to Ground Water: | Less than 50 feet | (20 points) | 0 |
| | 50 feet to 99 feet | (10 points) | |
| | Greater than 100 feet | (0 points) | |

(Vertical distance from contaminants to
seasonal high water elevation of ground
water)

| | | | |
|---------------------------|-----|-------------|---|
| Wellhead Protection Area: | Yes | (20 points) | 0 |
| | No | (0 points) | |

(Less than 200 feet from a private
domestic water source, or, less than 1,000
feet from all other water sources)

| | | | |
|----------------------------|-------------------------|-------------|---|
| Distance to Surface Water: | Less than 200 feet | (20 points) | 0 |
| | 200 feet to 1,000 feet | (10 points) | |
| | Greater than 1,000 feet | (0 points) | |

(Horizontal distance to perennial lakes,
ponds, rivers, streams, creeks, irrigation
canals and ditches)

RANKING SCORE (TOTAL POINTS): 0

Ripley #2A

Date Remediation Started: 04/12/1999

Date Completed: 04/12/1999

Remediation Method:

Excavation ☒

Approx. Cubic Yard 225

(Check all appropriate sections)

Landfarmed ☒

Amount Landfarmed (cubic yds) 225

Other _____

Remediation Location:

Onsite ☒

Offsite _____

(i.e., landfarmed onsite, name and location of offsite facility)

Backfill Material Location: _____

General Description of Remedial Action:

Excavated contaminated soil to a pit size of 27' X 25' X 9' and landfarmed soil onsite within a bermed area at a depth of 6" to 12". Soil was aerated by disking/plowing until soil met regulatory levels.

Ground Water Encountered:

No ☒Yes ☐

Depth _____

Final Pit Closure Sampling:

Sample Location

5 pt. composite - bottom.

(if multiple samples, attach sample result and diagram of sample locations and depths.)

Sample depth

9'

Sample date

04/12/1999

Sample time

9:30:00 AM

Sample Results

Benzene (ppm) < 0.100

Total BTEX (ppm) 13.700

Field headspace (ppm) _____

TPH (ppm)

75.00

Method

8015B

Vertical Extent (ft) _____

Risk Analysis form attached Yes ☐No ☒

Ground Water Sample:

Yes ☐No ☒

(If yes, see attached Groundwater Site Summary Report)

I HEREBY CERTIFY THAT THE INFORMATION ABOVE IS TRUE AND COMPLETE TO THE BEST OF MY KNOWLEDGE AND MY BELIEF

DATE July 27, 1999

SIGNATURE



PRINTED NAME Maureen Gannon
AND TITLE Project Manager

Ripley #2A
Burlington

(P) - 26-32N-13W
4-12-99

N

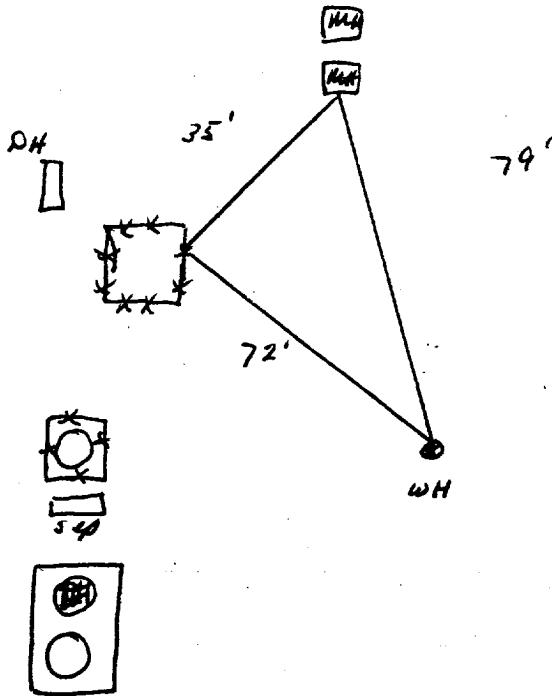

Excavation Sampling

27'(N+S) X 25'(E+W) X 9'(D)

PID Readings

5' - 2432 ppm
7' - 2444 ppm
9' - 1399 ppm

North wall head space
at 9' - 0 ppm

East wall head space
at 9' - 124 ppm

West wall head space
at 9' - 106 ppm

5 point bottom
composite head space
at 9' - 2444 ppm

South wall head space
at 9' - 0 ppm

not to scale

OFF: (505) 325-5667



LAB: (505) 325-1556

On Site Technologies, LTD.

Date: 22-Apr-99

CLIENT: PNM - Public Service Company of NM

Project: PNM Pit Remediation

Lab Order: 9904008

CASE NARRATIVE

Samples were analyzed using the methods outlined in the following references:

Test Methods for Evaluating Solid Waste, Physical/Chemical Methods, SW846, 3rd Edition

All method blanks, laboratory spikes, and/or matrix spikes met quality assurance objectives.

OFF: (505) 325-5667



LAB: (505) 325-1556

ANALYTICAL REPORT

Date: 22-Apr-99

| | | | |
|--------------------|------------------------------------|----------------------------|-------------------------------|
| Client: | PNM - Public Service Company of NM | Client Sample Info: | Ripley #2A |
| Work Order: | 9904008 | Client Sample ID: | 9904120930; 5pt. Bottom Comp. |
| Lab ID: | 9904008-01A | Matrix: | SOIL |
| Project: | PNM Pit Remediation | Collection Date: | 4/12/99 9:30:00 AM |
| | | COC Record: | 5786 |

| Parameter | Result | PQL | Qual | Units | DF | Date Analyzed |
|-------------------------------------|----------------|-----|------|-------|-----|---------------|
| DIESEL RANGE ORGANICS | | | | | | |
| | SW8015 | | | | | Analyst: HR |
| T/R Hydrocarbons: C10-C28 | 75 | 25 | | mg/Kg | 1 | 4/15/99 |
| AROMATIC VOLATILES BY GC/PID | | | | | | |
| | SW8021B | | | | | Analyst: HR |
| Benzene | ND | 100 | | µg/Kg | 100 | 4/15/99 |
| Toluene | 2100 | 200 | | µg/Kg | 100 | 4/15/99 |
| Ethylbenzene | 1100 | 100 | | µg/Kg | 100 | 4/15/99 |
| m,p-Xylene | 8600 | 200 | | µg/Kg | 100 | 4/15/99 |
| o-Xylene | 1900 | 100 | | µg/Kg | 100 | 4/15/99 |

13700
13.7 ppm

| | | |
|--------------------|---------------------------------------------------------|-----------------------------------------------------|
| Qualifiers: | PQL - Practical Quantitation Limit | S - Spike Recovery outside accepted recovery limits |
| | ND - Not Detected at Practical Quantitation Limit | R - RPD outside accepted recovery limits |
| | J - Analyte detected below Practical Quantitation Limit | E - Value above quantitation range |
| | B - Analyte detected in the associated Method Blank | Surr: - Surrogate |

1 of 1

P.O. BOX 2606 • FARMINGTON, NM 87499

- TECHNICAL SUPPORT FOR INDUSTRY WITH THE ENVIRONMENT -

OFF: (505) 325-5667



LAB: (505) 325-1556

ANALYTICAL REPORT

Date: 23-Apr-99

| | | | |
|--------------------|------------------------------------|----------------------------|--------------------------|
| Client: | PNM - Public Service Company of NM | Client Sample Info: | Ripley #2A |
| Work Order: | 9904008 | Client Sample ID: | 9904120935; 4 Wall Comp. |
| Lab ID: | 9904008-02A | Matrix: | SOIL |
| Project: | PNM Pit Remediation | Collection Date: | 4/12/99 9:35:00 AM |
| | | COC Record: | 5786 |

| Parameter | Result | PQL | Qual | Units | DF | Date Analyzed |
|------------------------------|--------|---------------|------|-------|----|---------------|
| DIESEL RANGE ORGANICS | | SW8015 | | | | Analyst: DC |
| T/R Hydrocarbons: C10-C28 | ND | 25 | | mg/Kg | 1 | 4/13/99 |

Qualifiers:

PQL - Practical Quantitation Limit

S - Spike Recovery outside accepted recovery limits

ND - Not Detected at Practical Quantitation Limit

R - RPD outside accepted recovery limits

J - Analyte detected below Practical Quantitation Limit

E - Value above quantitation range

B - Analyte detected in the associated Method Blank

Surr: - Surrogate

1 of 1

Ripley 2A
Sec-26 T-32N R-13W
Burlington

LAND FARM DRAWING
ON LOCATION App. 225 cu.yds

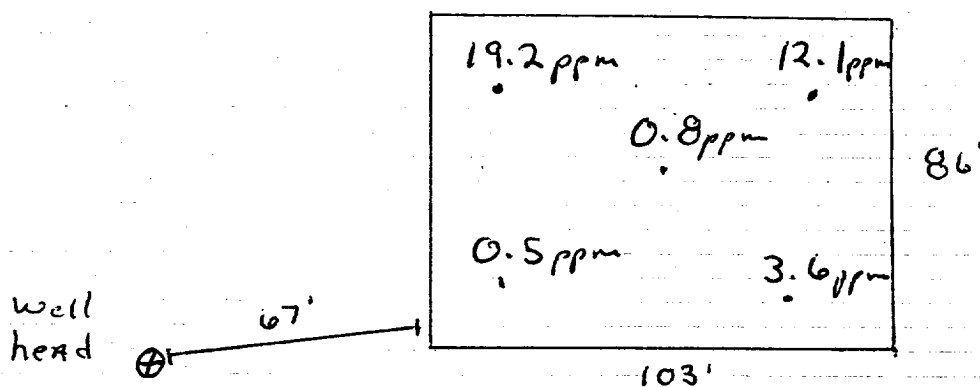

2" to 12" Depth
Headspace Reading 25.1
Sample # 9905111055

Not to Scale

OFF: (505) 325-5667



LAB: (505) 325-1556

On Site Technologies, LTD.

Date: 18-May-99

CLIENT: PNM - Public Service Company of NM
Project: PNM Pit Remediation - Landfarms
Lab Order: 9905046

CASE NARRATIVE

Samples were analyzed using the methods outlined in the following references:

Test Methods for Evaluating Solid Waste, Physical/Chemical Methods, SW846, 3rd Edition

All method blanks, laboratory spikes, and/or matrix spikes met quality assurance objectives.

OFF: (505) 325-5667



LAB: (505) 325-1556

ANALYTICAL REPORT

Date: 18-May-99

| | | | |
|--------------------|------------------------------------|----------------------------|----------------------------|
| Client: | PNM - Public Service Company of NM | Client Sample Info: | Ripley 2A Landfarm |
| Work Order: | 9905046 | Client Sample ID: | 9905111055; 5pt. Composite |
| Lab ID: | 9905046-01A | Matrix: | SOIL |
| Project: | PNM Pit Remediation - Landfarms | Collection Date: | 5/11/99 10:55:00 AM |
| | | COC Record: | 7615 |

| Parameter | Result | PQL | Qual | Units | DF | Date Analyzed |
|------------------------------|--------|----------------|------|-------|----|---------------|
| DIESEL RANGE ORGANICS | | SW8015B | | | | Analyst: DC |
| T/R Hydrocarbons: C10-C28 | 39 | 25 | | mg/Kg | 1 | 5/17/99 |

Qualifiers:

PQL - Practical Quantitation Limit

ND - Not Detected at Practical Quantitation Limit

J - Analyte detected below Practical Quantitation Limit

B - Analyte detected in the associated Method Blank

S - Spike Recovery outside accepted recovery limits

R - RPD outside accepted recovery limits

E - Value above quantitation range

Surr: - Surrogate

P.O. BOX 2606 • FARMINGTON, NM 87499

- TECHNOLOGY BLENDING INDUSTRY WITH THE ENVIRONMENT -

1 of 1