

UNITED STATES
DEPARTMENT OF THE INTERIOR
GEOLOGICAL SURVEY

30-045-23475

APPLICATION FOR PERMIT TO DRILL, DEEPEN, OR PLUG BACK

1a. TYPE OF WORK

DRILL ☒DEEPEN ☐PLUG BACK ☐

b. TYPE OF WELL

OIL
WELL ☐GAS
WELL ☒OTHER ☐SINGLE
ZONE ☒MULTIPLE
ZONE ☐

2. NAME OF OPERATOR

Benson-Montin-Greer Drilling Corp.

3. ADDRESS OF OPERATOR

221 Petroleum Center Building, Farmington, NM 87401

4. LOCATION OF WELL (Report location clearly and in accordance with any State requirements.)*
At surface

F 790' FWL and 1850' FNL

At proposed prod. zone
same

14. DISTANCE IN MILES AND DIRECTION FROM NEAREST TOWN OR POST OFFICE*

Approximately 15 miles north of Farmington, NM

15. DISTANCE FROM PROPOSED*

LOCATION TO NEAREST
PROPERTY OR LEASE LINE, FT.
(Also to nearest drlg. unit line, if any)

790'

16. NO. OF ACRES IN LEASE

487.88

18. DISTANCE FROM PROPOSED LOCATION*
TO NEAREST WELL, DRILLING, COMPLETED,
OR APPLIED FOR, ON THIS LEASE, FT.

NA

19. PROPOSED DEPTH

3100'

17. NO. OF ACRES ASSIGNED
TO THIS WELL

240.01

20. ROTARY OR CABLE TOOLS

Rotary

21. ELEVATIONS (Show whether DF, RT, GR, etc.)

6381' GL

22. APPROX. DATE WORK WILL START*

as soon as possible

23.

PROPOSED CASING AND CEMENTING PROGRAM

SIZE OF HOLE	SIZE OF CASING	WEIGHT PER FOOT	SETTING DEPTH	QUANTITY OF CEMENT
15"	9 5/8"	32.30#	90'	150 sacks
8 3/4"	7"	23#	1100'	100 sacks
6 1/4"	4 1/2"	10.50#	3100'	100 sacks

- Operator will test and maintain proper drilling equipment during all operations.
- Well will be drilled to TD, logs run and if warranted, production casing will be run and well will be completed.
- For blow-out preventer program, see Exhibit III attached.

gas not dedicated

IN ABOVE SPACE DESCRIBE PROPOSED PROGRAM: If proposal is to deepen or plug back, give data on present productive zone and proposed new productive zone. If proposal is to drill or deepen directionally, give pertinent data on subsurface locations and measured and true vertical depths. Give blowout preventer program, if any.

24.

SIGNED

TITLE

Vice-President

DATE

April 10, 1979

(This space for Federal or State office use)

PERMIT NO.

APPROVAL DATE

APPROVED BY

TITLE

DATE

CONDITIONS OF APPROVAL, IF ANY:

ok Frank

*See Instructions On Reverse Side

N/M/OCC

NEW MEXICO OIL CONSERVATION COMMISSION
WELL LOCATION AND ACREAGE DEDICATION PLAT

Form O-101
Supersedes O-128
Effective 1-1-67

All distances must be from the outer boundaries of the Section.

Owner BENSON-MONTIN-GREER DRILLING CORP.			Lease La Plata		Well No. #4 (F-31)
Unit Letter F	Section 31	Township 32 NORTH	Range 13 WEST	County SAN JUAN	
Actual Footage Location of Well: 1850 feet from the NORTH line and 790 feet from the WEST line					
Ground Level Elev. 6381	Producing Formation Dakota		Pool: <i>Ute Blaine</i> Undesignated Dakota <i>ext</i>		Dedicated Acreage: 240.01 Acres

1. Outline the acreage dedicated to the subject well by colored pencil or hatchure marks on the plat below.
2. If more than one lease is dedicated to the well, outline each and identify the ownership thereof (both as to working interest and royalty). **One lease**
3. If more than one lease of different ownership is dedicated to the well, have the interests of all owners been consolidated by communitization, unitization, force-pooling, etc?

☐ Yes ☐ No If answer is "yes," type of consolidation _____

If answer is "no," list the owners and tract descriptions which have actually been consolidated. (Use reverse side of this form if necessary.) _____

No allowable will be assigned to the well until all interests have been consolidated (by communitization, unitization, forced-pooling, or otherwise) or until a non-standard unit, eliminating such interests, has been approved by the Commission.

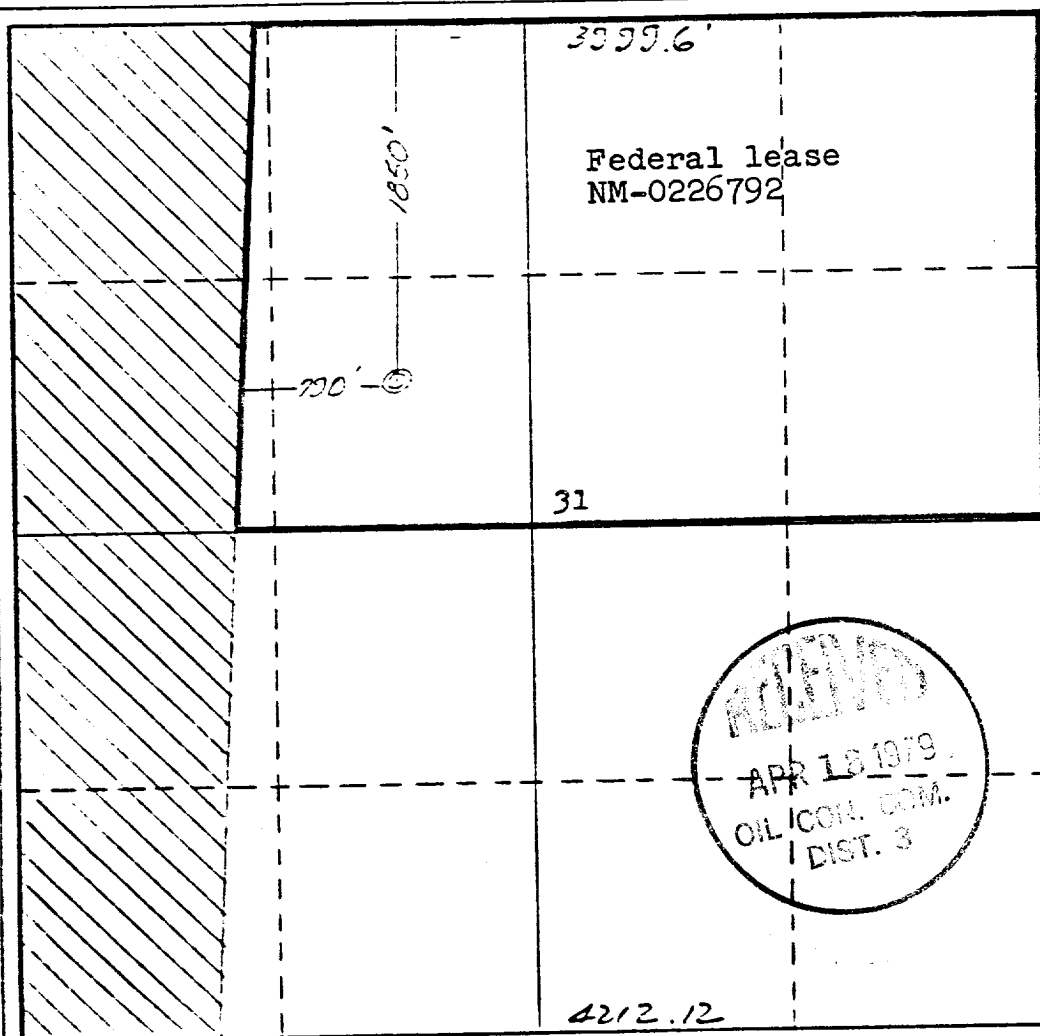

CERTIFICATION

I hereby certify that the information contained herein is true and complete to the best of my knowledge and belief.

Name *Virgil L. Stoabs*
Position **Vice-President**
Company **Benson-Montin-Greer Drilling Corp.**

Date **April 10, 1979**

I hereby certify that the location shown on this plat was plotted in the field notes of actual surveys made by me or under my supervision, and that the same is true and correct to the best of my knowledge and belief.

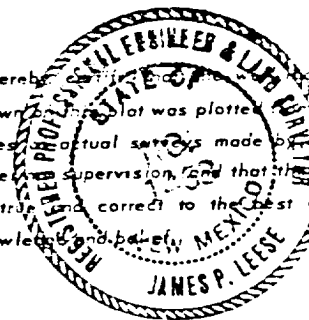

Date Surveyed **11 November 1978**

Registered Professional Engineer and Surveyor

James P. Lease
James P. Lease

Certificate No. **1463**

0 330 660 990 1320 1650 1980 2310 2640 2970 3300 3630 3960 4290 4620 4950 5280 5610 5940 6270 6600

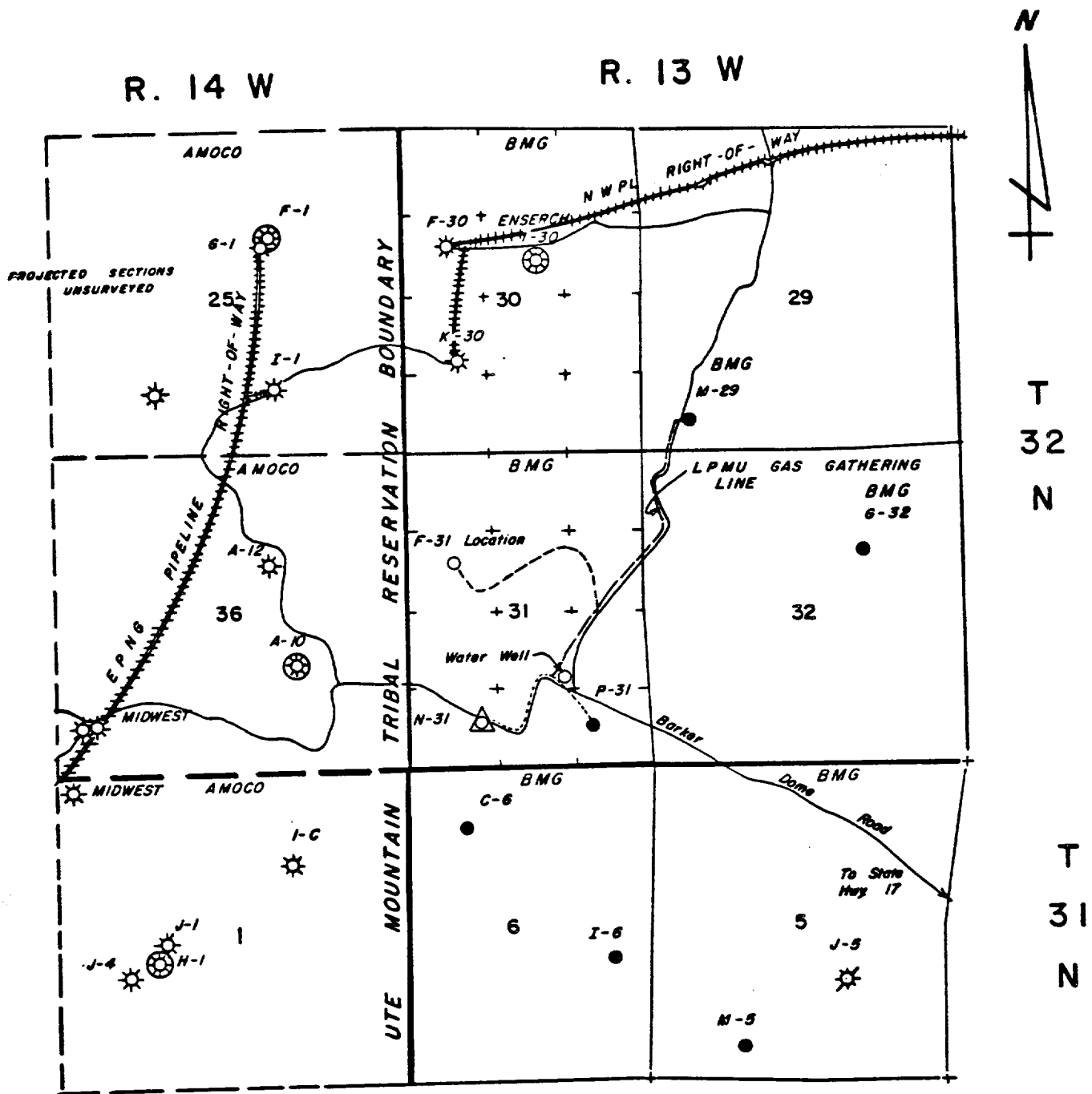

- LEGEND -

- Proposed Well Access Road
- Gas Gathering Line Under Construction
- ☼ Paradox (Penn.) Well

Original: 4/79 on

BENSON - MONTIN - GREER DRILLING CORP.
USGS NTL-6 MAP

La Plata Mancos Unit No. 4 (F-31)
Lot 7, Sec. 31 - 32N-13W
San Juan Co., N. Mex.

NTL-6 ENVIRONMENTAL PROTECTION STATEMENT

Operator: Benson-Montin-Greer Drilling Corp.
Well No. and Lease: La Plata #4 (F-31)
Location: NW $\frac{1}{4}$ Section 31, T-32N, R-13W
County and State: San Juan County, New Mexico
Date: April 10, 1979

TO: District Engineer, U. S. Geological Survey,
Bureau of Land Management and/or U. S. Forest Service

I. General

The following information is provided in order that the environmental impact of proposed operations on subject leasehold may be evaluated. Oil and gas operations by this operator will be totally systemized between management and operations personnel to ameliorate and minimize any adverse effect on the environment. Operator plans to conduct operations in such a fashion that will:

- (A) Result in diligent development and efficient resource recovery.
- (B) Afford adequate safeguard for the environment.
- (C) Result in proper rehabilitation of disturbed land.
- (D) Assure protection of public health and safety.
- (E) Conform with best available oil field practice.

II. Drilling Operations

A. Preliminary Environmental Review

Request for permission to stake well location and submission of topo map has been done previously.

B. Application for Permit to Drill, Deepen, or Plug Back

- (1) Form 9-331C (Application for Permit to Drill, Deepen, or Plug Back) is attached.
- (2) Multi-Point Surface Use and Operations Plan is attached.
- (3) If private surface is involved, Rehabilitation Agreement is attached (see Exhibit I-A).
- (4) Form 9-331C
 1. Location - see 9-331C
 2. Elevation gl - see 9-331C
 3. Geologic name of surface formation - see 9-331C
 4. Type drilling tools - see 9-331C
 5. Proposed TD - see 9-331C
 6. Estimated tops of important geologic markers - see Exhibit I
 7. Estimated depth anticipated water, oil, gas, or other mineral bearing form - see Exhibit II
 8. Proposed casing program (size, grade, wgt., N or U) - see 9-331C
 9. Proposed setting depth each string (amt., type cmt. and additives) - see 9-331C
 10. Operator's planned minimum specs for pressure control equipment, schematic, sizes and pressure ratings (API series), testing procedures and frequency - see Exhibit III
 11. Type and characteristics of circulating medium (quantities and types of mud and weighting material to be maintained) - see Exhibit IV
 12. Testing, logging, and coring program w/provision for flexibility - see Exhibit V
 13. Any anticipated abnormal pressures, temperatures, or hazardous gases (H_2S), and mitigating plans if necessary - see Exhibit VI
 14. Anticipated starting date and duration of operation - see Exhibit VII
 15. Extraneous facets of proposed operation - see Exhibit VIII

- (5) Provide copy of approved Application for Permit to Drill at wellsite - see dog house wall

Benson-Montin-Greer Drilling Corp.
La Plata #4 (F-31)
NW $\frac{1}{4}$ Section 31, T-32N, R-13W
San Juan County, New Mexico

EXHIBIT I
(TO ACCOMPANY FORM 9-331C)

(4-6) Estimated tops of important geologic markers:

Mesa Verde	<u>surface</u>
Mancos	<u>995'</u>
Niobrara	<u>2000'</u>
Greenhorn	<u>2725'</u>
Graneros	<u>2780'</u>
Dakota	<u>2840'</u>
Morrison	<u>3070'</u>

Benson-Montin-Greer Drilling Corp.
La Plata #4 (F-31)
NW $\frac{1}{4}$ Section 31, T-32N, R-13W
San Juan County, New Mexico

EXHIBIT II
(TO ACCOMPANY FORM 9-331C)

(4-7) Estimated depths anticipated water, oil, gas or other mineral bearing formations:

Mesa Verde (possible gas)	<u>Surface</u>
Niobrara (oil and gas)	<u>2000'</u>
Dakota (oil and gas)	<u>2840'</u>

Benson-Montin-Greer Drilling Corp.
La Plata #4 (F-31)
NW $\frac{1}{4}$ Section 31, T-32N, R-13W
San Juan County, New Mexico

EXHIBIT III

SCHEMATIC DRAWING OF BLOW-OUT PREVENTER STACK

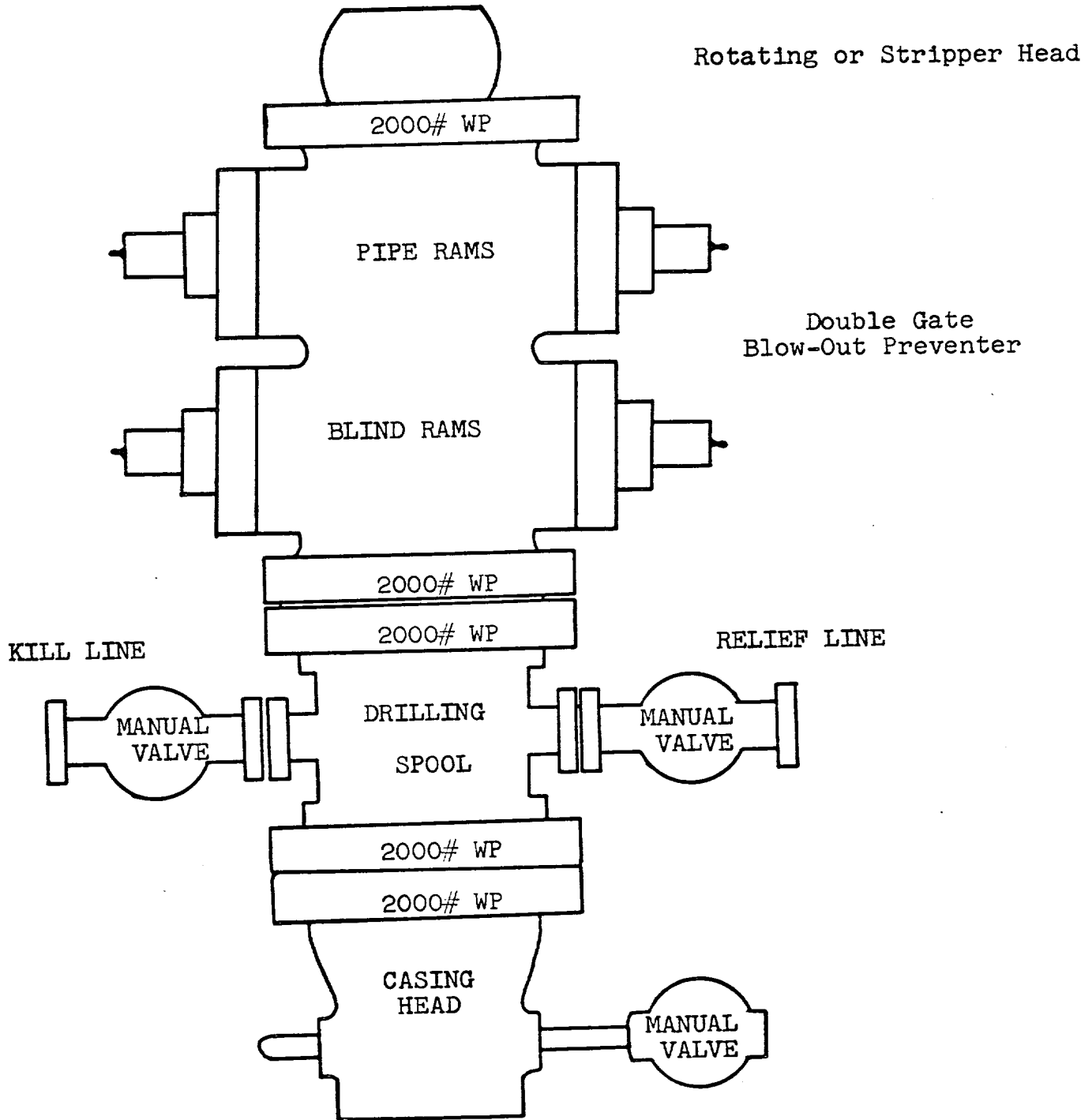

EXHIBIT III
(TO ACCOMPANY FORM 9-331C)

(4-10) Planned pressure control, planned testing, frequency and procedures:

Testing procedure of pressure control equipment and frequency will be conducted in accordance with approved API procedures and/or best oil field practice in area concerned.

- (a) Visual inspection will be made of its equipment before installation.
- (b) After installation, equipment will be tested at manufacturer's rated, equipment pressure, or at least as high as obtainable with wellsite equipment.
- (c) Pressure control equipment will be operationally tested each trip for bit, but not more than once per day.

EXHIBIT IV
(TO ACCOMPANY FORM 9-331C)

(4-11) Planned types and characteristics of circulating medium:

<u>Depth</u>	<u>Mud Weight</u>	<u>Viscosity</u>
0 - 100'	8.5 - 9.0	30 - 40
Spud with fresh water gel slurry. Adjust viscosity as needed to keep hole clean and remove cuttings.		
100-1100'	8.8 - 9.5	32 - 50 40 - 50 if decide to log or test

Continue with fresh water gel. Water loss adjusted to minimize fluid loss into shales. Hole will be circulated and cleaned before running surface and/or intermediate casing strings. Shale shaker will be used to remove cuttings except as selectively shut down to prevent loss of LCM. Desilter will be used if necessary. A gas buster will be installed if considered necessary.

1100'-TD Operator proposes to drill this footage with compressed air as circulating medium. Air volume will be adequate to keep hole clean and remove cuttings. In event water is encountered, air mist circulating medium will be used.

Benson-Montin-Greer Drilling Corp.
La Plata #4 (F-31)
NW $\frac{1}{4}$ Section 31, T-32N, R-13W
San Juan County, New Mexico

EXHIBIT V
(TO ACCOMPANY FORM 9-331C)

(4-12) Planned testing, logging, and coring program (with provision for flexibility):

DST's planned: None

Cores planned: None

Logs planned: Suitable Resistivity, Reciprocal Conductivity, and SP log in fluid filled hole; Gamma-ray Induction if hole dry.

Suitable porosity log if tools available, GR Comp. Den. and/or Comp. Neut with caliper.

All logs in API units.

If circumstances arise, will consider a selected DST and/or core if additional reservoir information desired.

EXHIBIT VI
(TO ACCOMPANY FORM 9-331C)

(4-13) Anticipated abnormal pressures, temperatures, or hazardous gases (H₂S):

- (a) Anticipated abnormal pressures: None
- (b) Anticipated abnormal temperatures: None
- (c) Anticipated hazardous gases (H₂S): None

If any of the foregoing are unexpectedly encountered, suitable steps will be taken to mitigate.

Benson-Montin-Greer Drilling Corp.
La Plata #4 (F-31)
NW $\frac{1}{4}$ Section 31, T-32N, R-13W
San Juan County, New Mexico

EXHIBIT VII
(TO ACCOMPANY FORM 9-331C)

(4-14) Anticipated starting date and duration of operation:

- (a) Anticipated starting date: April 15, 1979.
- (b) Duration of operation: 15 days
- (c) Depending on weather and rig availability, will either complete well with the drilling rig on the hole or in the logistical alternative, subsequently use a completion rig. Unless operational problems are encountered, expect to perf, frac, run tubing and clean up well in approximately 45 additional days.

Benson-Montin-Greer Drilling Corp.
La Plata #4 (F-31)
NW $\frac{1}{4}$ Section 31, T-32N, R-13W
San Juan County, New Mexico

EXHIBIT VIII
(TO ACCOMPANY FORM 9-331C)

(4-15) Extraneous facets of proposed operation:

(a) None.

NTL-6 ENVIRONMENTAL PROTECTION STATEMENT

Operator: Benson-Montin-Greer Drilling Corp.
Well No. and Lease: La Plata #4 (F-31)
Location: NW $\frac{1}{4}$ Section 31, T-32N, R-13W
County and State: San Juan County, New Mexico
Date: April 10, 1979

III. Multi-Point Surface Use and Operations Plan

Plan submitted is in sufficient detail to permit complete appraisal of environmental effects associated with proposed project. Submitted in triplicate to USGS District Engineer along with form 9-331C.

A-1. Existing Roads (see Exhibit A)

- (a) Topo or county road map.
- (b) Proposed route shown including distances to highway or county road.
- (c) Proposed access roads labeled.
- (d) Wildcat - all existing roads with 3-mile radius.
Development well - all existing roads within 1-mile radius.
- (e) Improvement and/or maintenance of existing roads will be only as necessary and normally consist of minor blade work.

A-2. Planned Access Roads (see Exhibit A)

- (a) Identify permanent and temporary access roads.
 - 1. Planned data on newly constructed access roads (see Exhibit A-1).
 - a. Width
 - b. Maximum grade
 - c. Turnouts
 - d. Drainage design

- e. Location and size of culverts
- f. Surfacing material
- g. CL staked or flagged
- h. Where existing fence to be cut
- i. Gates or cattleguard to be used
- j. Any existing gates to be replaced
- k. Any existing cattleguards to be replaced

A-3. Location of Existing Wells (see Exhibit B)

- (a) Wildcat - all wells within 2-mile radius
(include water wells - use topo)
- (b) Development well - all wells within 1-mile radius
(include water wells - use topo)

A-4. Location of Existing and/or Proposed Facilities - tank batteries, production facilities, and production, gathering and service lines (see Exhibit C)

- (a) Existing facilities within 1-mile radius of location owned or controlled by operator to be shown on a plat or map.
- (b) There are no existing facilities owned within 1-mile radius located on F-31 drill-site pad.
- (c) Protective measures to functionally minimize or ameliorate hazards to livestock, waterfowl and other wildlife will be accomplished by fencing permanent or temporary pits as considered necessary.
- (d) New facilities will be located on drill-site pad of new well.
- (e) All production facilities will be located on the drill-site in optimum positions with due organizational regard to traffic mobility and ROW sale line options and flexibility.
- (f) All disturbed areas not needed for operation and maintenance will be reseeded, as required by surface jurisdictional and management agencies or fee land owner.
- (g) Future prospects for additional development of this leasehold have been functionally considered in this plan.

A-5. Location and Type of Water Supply (see Exhibit D)

- (a) Location of water for drilling purposes and method and route of transportation are stated in above mentioned Exhibit.

A-6. Source of Construction Materials (see Exhibit E)

- (a) Location of proposed source of sand, gravel, stone, soil, or construction materials and transportation route are described in above mentioned Exhibit.

A-7. Method of Handling Waste Disposal (see Exhibit F)

- (a) A brief written narrative description of method and location for safe containment and disposal of each type of waste material which results from drilling of proposed well and eventual disposal of drilling fluids and any produced oil or water recovered during testing operations are described in above mentioned Exhibit.

A-8. Ancillary Facilities (see Exhibit G)

- (a) Plans and maps for camps, airstrips, location and land area required, and methods and standards of construction are detailed in above mentioned Exhibit. Center lines of camps and airstrips shall be staked on the ground.

A-9. Well-site Layout (see Exhibit H)

- (a) A proposed plat of well-site layout showing cuts and fills and relation to topography is provided, including cross sections. The proposed location of mud tanks, pits (reserve, burn and trash), pipe racks, access roads, turn-around areas, living facilities, soil material stockpiles (if necessary), and orientation of rig are indicated. Plans to line pit are noted.

A-10. Plans for Restoration of Surface (see Exhibit I)

- (a) Proposed program for surface restoration upon completion of operation is outlined in above mentioned Exhibit. Waste disposal is outlined in Exhibit F. Proposed timetable for commencement and completion of rehabilitation operations is also provided.

A-11. Other Information (see Exhibit J)

- (a) General description of topography.
- (b) Soil characteristics.
- (c) Formation lithologies.
- (d) Geologic features.
- (e) Flora.
- (f) Fauna.
- (g) Surface use activities.

- (h) Surface ownership at well location.
- (i) Surface ownership lands crossed by newly constructed or upgraded roads.
- (j) Any other information considered to be useful by operator to USGS and BLM and/or Forest Service.
- (k) Proximity to steep hillsides.
- (l) Proximity to steep gullies.
- (m) Proximity to water wells (see Exhibit B).
- (n) Proximity to ponds.
- (o) Proximity to streams.
- (p) Proximity to other facilities.
- (q) Proximity to occupied dwellings.
- (r) Proximity to archeological sites.
- (s) Proximity to historical sites.
- (t) Proximity to cultural sites.
- (u) Information concerning cuts and fills of roads (see Exhibit A-1).
- (v) Information concerning cuts and fills of location (see Exhibit H).
- (w) Construction practices necessary to accommodate potential geologic hazards.

A-12. Operator's Representative (see Exhibit K)

- (a) Name, address and phone number of operator's field representative(s).

A-13. Certification (see Exhibit L)

- (a) Signed by field representative.

IV. Environmental Analysis Requirements

- A. If preliminary inspection is not made prior to staking, an on-site inspection will normally be required by representatives of District Engineer (USGS), operator, and Federal Surface Management Agency.

V. Approval of Subsequent Operations

- A. Must be done on 9-331A or 9-331C and approval obtained before work started.
- B. Operator must submit for approval suitable plan prior to any new construction or alteration of any existing facilities, including roads, dams and production facilities.

VI. Agreement for Rehabilitation of Privately-Owned Surface (see Exhibit K, if applicable)

- A. Form 9-331C shall contain information landowner's rehabilitation requirements.
- B. Written agreement or letter must be furnished.

- C. If landowner's requirements are impossible or impractical, a letter describing situation will be acceptable.
- D. If no arrangements made, USGS will request appropriate Federal agency to recommend surface restoration requirements.

VII. Well Abandonment (see Exhibit L, if applicable)

- A. No well abandonment operations will be commenced without prior approval of the District Engineer.
- B. Upon completion of abandonment or rehabilitation operations, District Engineer to be notified by Sundry Notice.

VIII. Water Well Conversion (see Exhibit M, if applicable)

- A. Well that encounters usable fresh water will not be approved if Federal Surface Management Agency wants to acquire well.
- B. If Federal Surface Management Agency elects to acquire well, it will reimburse operator for cost of any recoverable casing or well-head equipment which it requests to be left in or on the hole.
- C. Operator completes cleanup.

R 13 W

Benson-Montin-Greer Drilling Corp.
La Plata #4 (F-31)
NW $\frac{1}{4}$ Section 31, T-32N, R-13W
San Juan County, New Mexico

EXHIBIT A
(a & b)

T
31
N

T
30
N

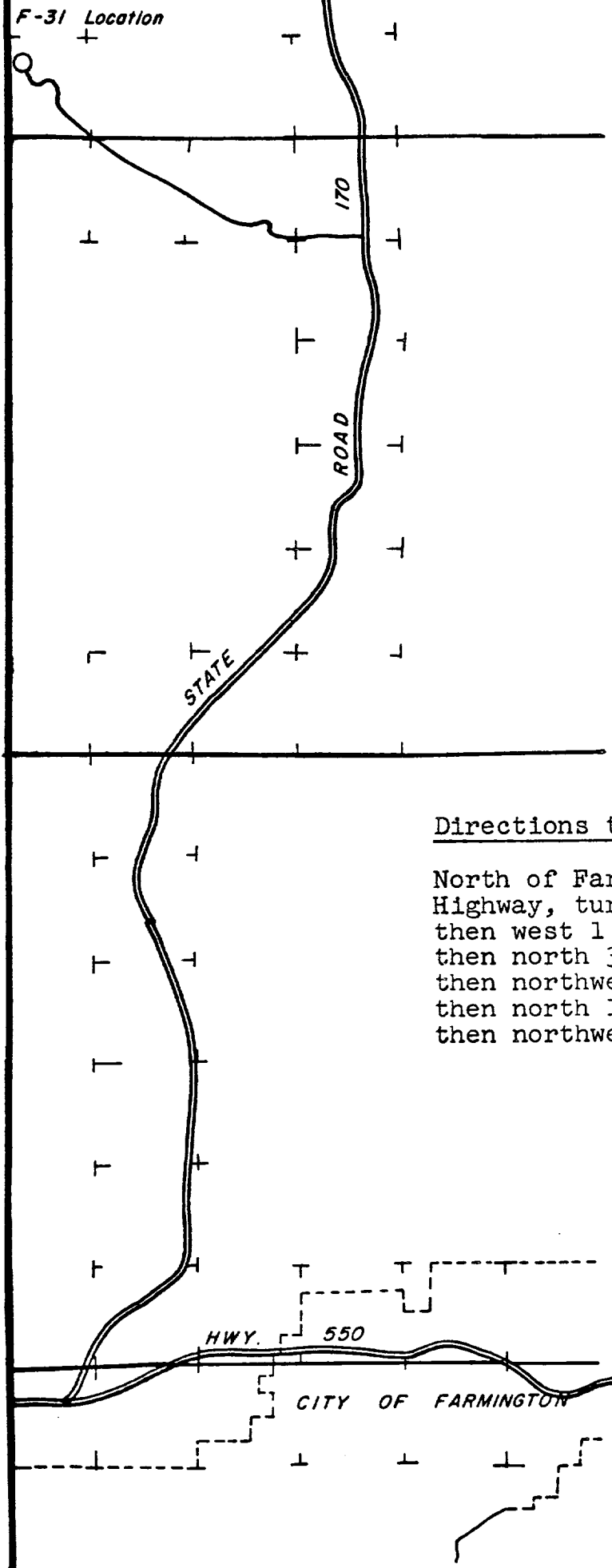

Directions to well:

North of Farmington 15 miles on La Plata Highway, turn left on Barker Dome Road, then west 1 mile on gravel road, turn right then north 300 yards - turn left thru cattleguard then northwest 2.3 miles - turn right then north 1/4 mile - turn left then northwest to location.

EXHIBIT A-1
TO ACCOMPANY EXHIBIT A (a & b)

(III-A-2-1) Planned data on newly constructed access roads:

(a) Width	<u>20'</u>
(b) Maximum grade	<u>8%</u>
(c) Turnouts	<u>None</u>
(d) Drainage design	<u>Natural</u>
(e) Location and size of culverts	<u>None</u>
(f) Surfacing material	<u>None</u>
(g) CL staked or flagged	<u>Yes</u>
(h) Where existing fence to be cut	<u>None</u>
(i) Gates or cattleguard to be used	<u>None</u>
(j) Any existing gates to be replaced	<u>None</u>
(k) Any existing cattleguards to be replaced	<u>None</u>

Benson-Montin-Greer Drilling Corp.
La Plata #4 (F-31)
NW $\frac{1}{4}$ Section 31, T-32N, R-13W
San Juan County, New Mexico

EXHIBIT A
(c & d)

R. 14 W

R. 13 W

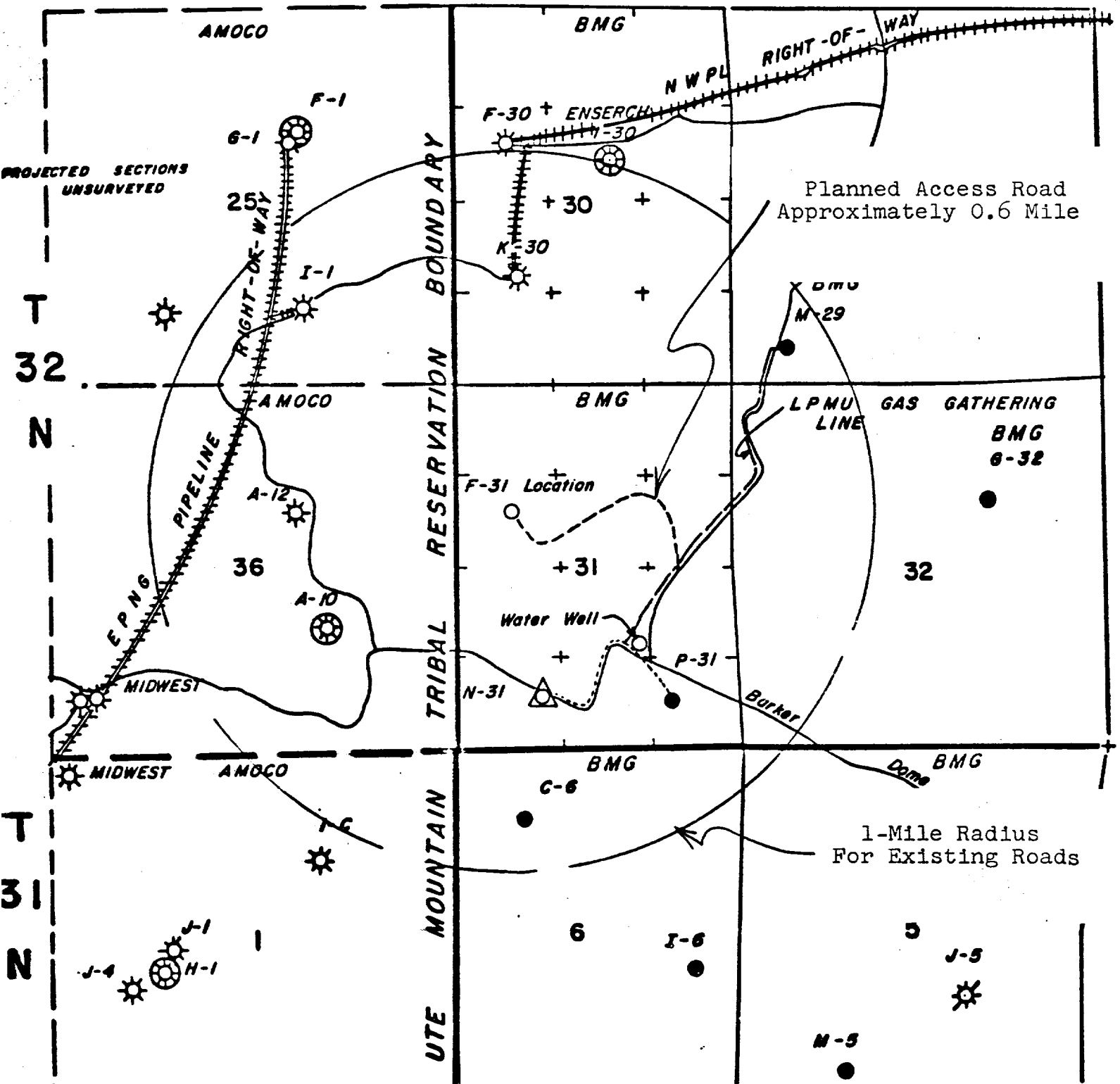

Benson-Montin-Greer Drilling Corp.
La Plata #4 (F-31)
NW $\frac{1}{4}$ Section 31, T-32N, R-13W
San Juan County, New Mexico

EXHIBIT B

R. 14 W

R. 13 W

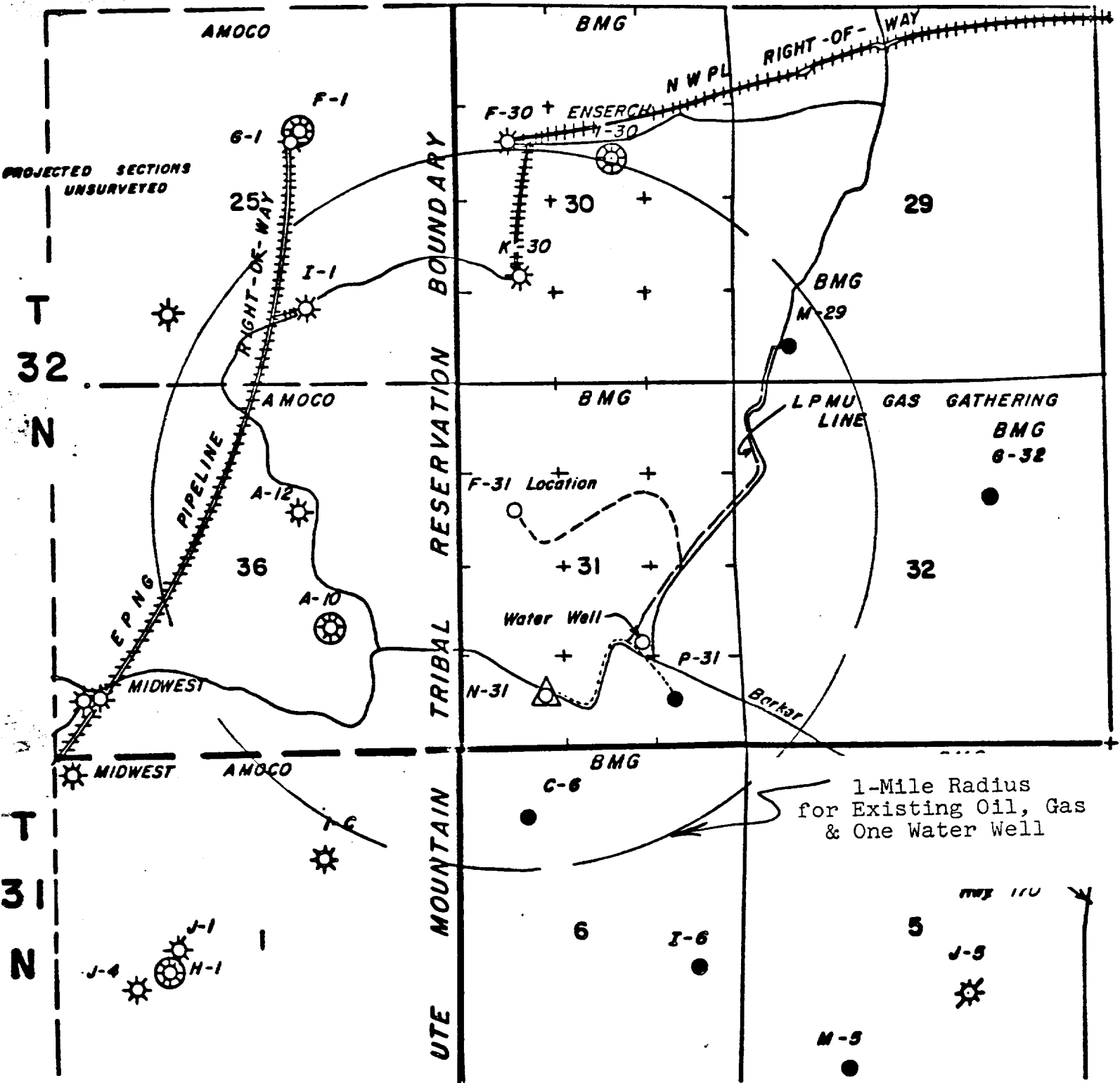
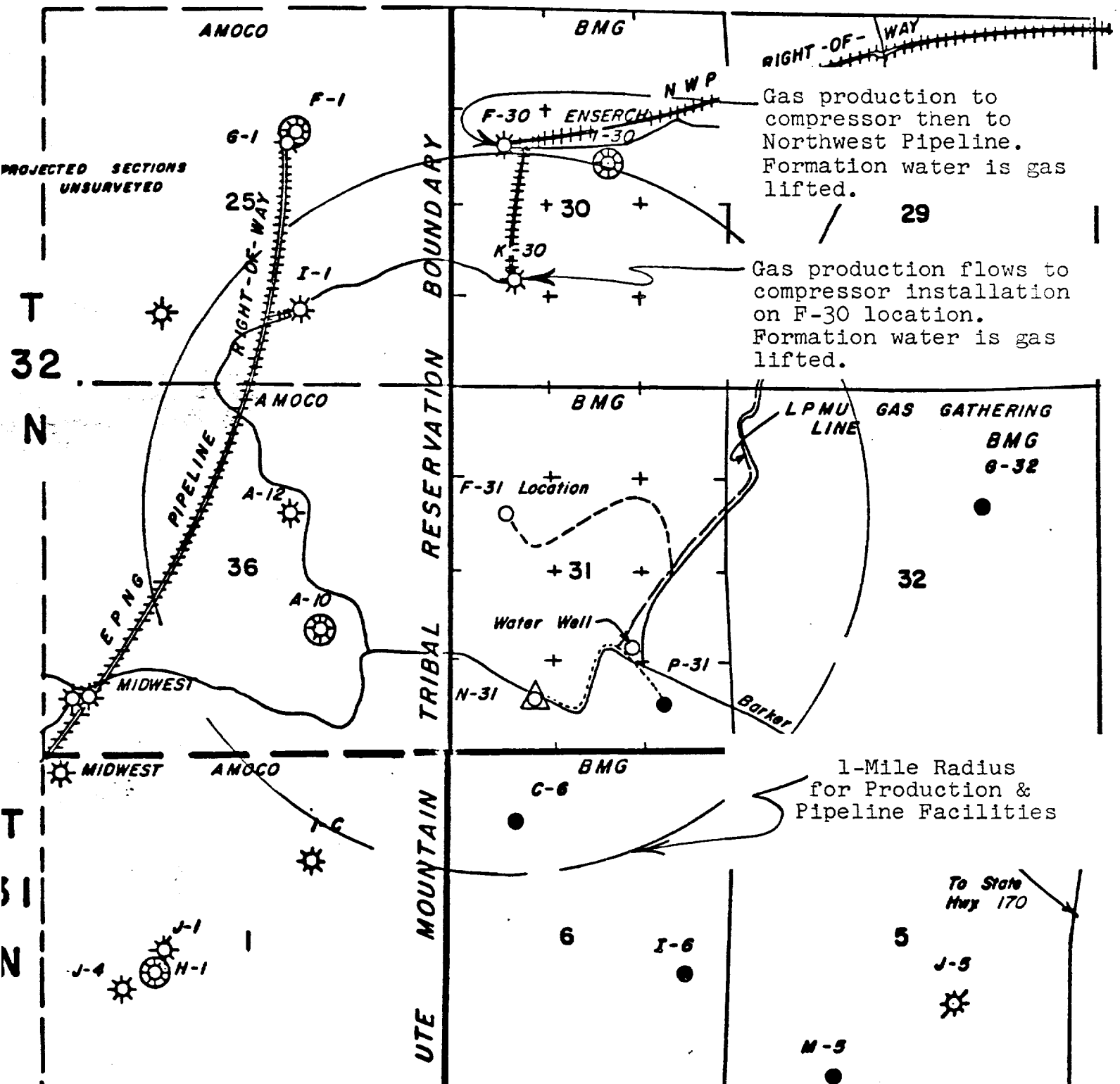

EXHIBIT C

R. 14 W

R. 13 W



- (a) Existing facilities within one-mile radius of location owned or controlled by operator include gas gathering line to K-30 location located SW $\frac{1}{4}$ Sec 30, T-32N, R-13W; also a gas lift source gas pipeline to K-30 location extending from F-30 location located in NW $\frac{1}{4}$ Sec 30, T-32N, R-13W where compressor is located to gas lift formation water and compressed gas for delivery to Northwest Pipeline transmission line.

EXHIBIT D

(III-A-5) Location, route and method of transportation, and type of water supply:

- (a) Location: Drilling and frac water will be hauled from irrigation ditch or La Plata River at La Plata, depending on time of year and road conditions.
- (b) Route of transportation: Direct from La Plata, along Barker Dome road, thence north to drill site.
- (c) Method of transportation: Water trucks.
- (d) Type of water supply: Fresh water.

EXHIBIT E

(III-A-6) Source of construction materials:

- (a) Sand: None
- (b) Gravel: None
- (c) Stone: None
- (d) Soil: None
- (e) Lumber will be purchased from suppliers in the Farmington/Aztec area and will use transportation route as shown on Exhibit A (a & b).
- (f) Planned transportation route will be on suitable public or private roads, normally from Farmington, New Mexico. Road and weather conditions at time of operations may have some effect on actual route.

EXHIBIT F

(III-A-7) Method of handling waste material:

- (a) Drill cuttings will be buried in reserve pit.
- (b) Drilling fluids will be collected in reserve pit, allowed to evaporate and dry, and buried when dry.
- (c) Small amounts of produced fluids will be collected in reserve pit, allowed to evaporate, and buried when dry.
- (d) Any sewage will be covered and buried when portable toilet removed.
- (e) Any garbage, cans, and general trash will be burned in burn pit and covered when reserve pit covered. Other general debris and waste material, such as junk iron, wire line, cans, and bags will either be burned or buried in reserve pit.
- (f) Drilling crews, under the supervision of contractor or operator, will control and dispose of waste material during drilling operations.
- (g) Roustabout or completion crews will dispose of trash after well is completed or abandoned. After drying of reserve pit, a general cleanup and covering of the pit along with leveling of location or drillsite will take place.

EXHIBIT G

(III-A-8) Ancillary facilities:

- (a) Camps planned: None (may have small house trailer on location for tool pusher).
- (b) Airstrips planned: None.
- (c) Area and land required for above: None.

EXHIBIT H

(III-A-9) Planned wellsite layout:

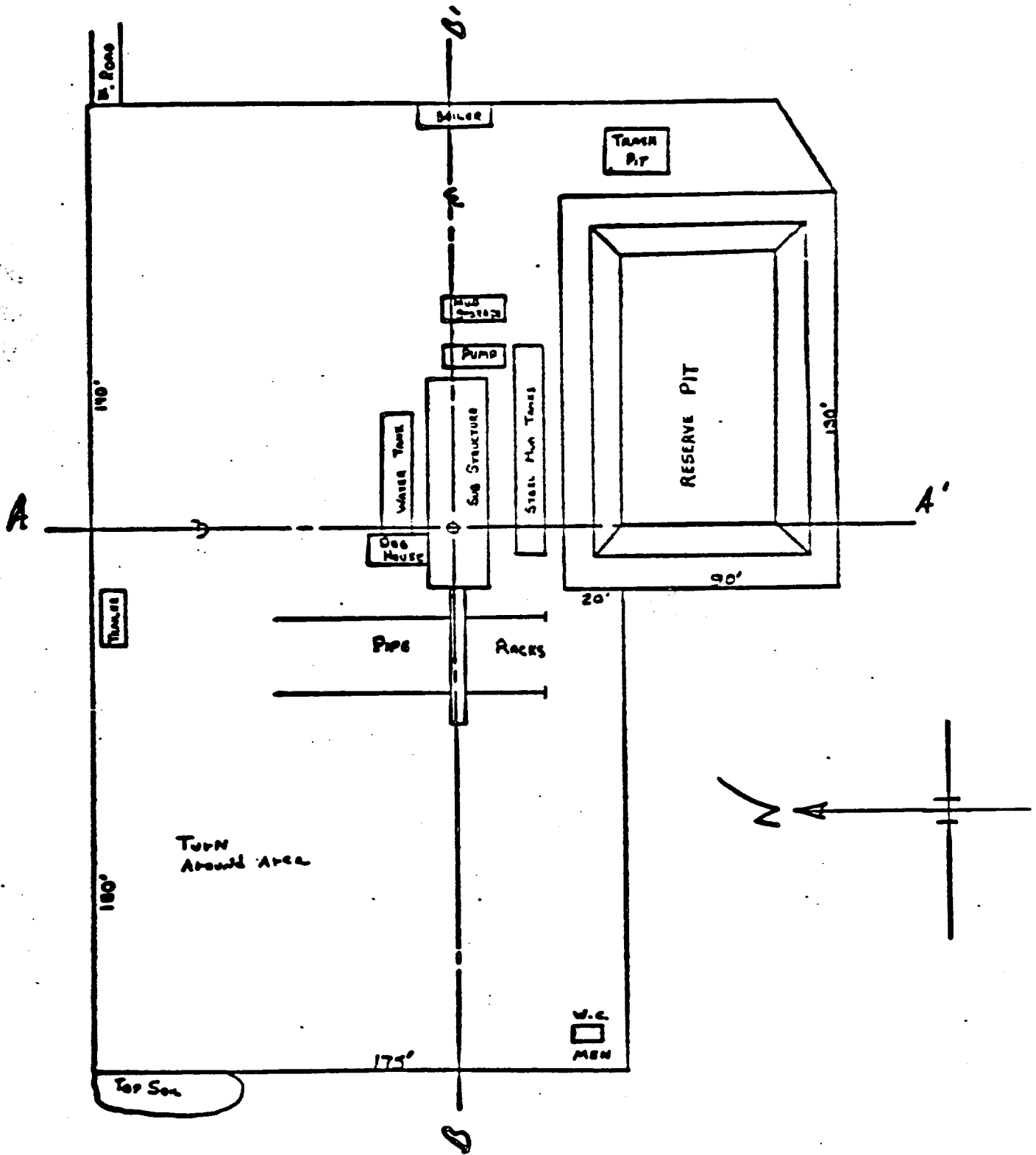

Reserve pit will be unlined.

EXHIBIT H

(III-A-9) Planned wellsite layout:

A

B

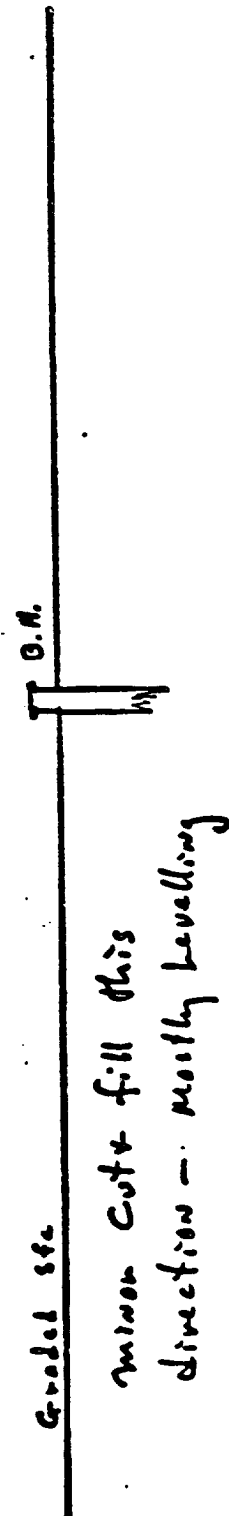
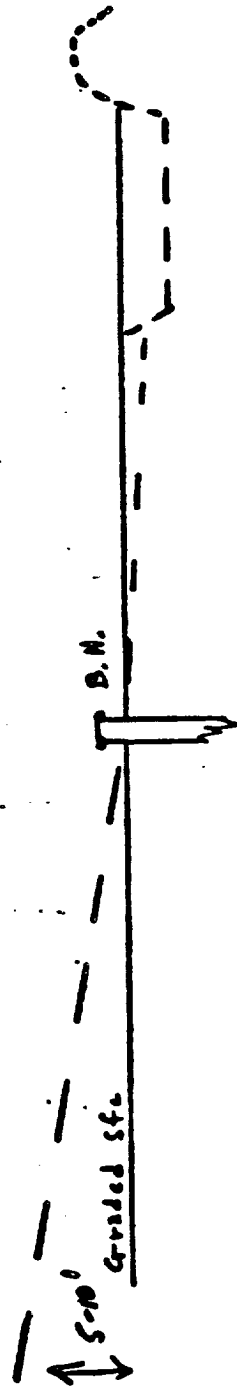
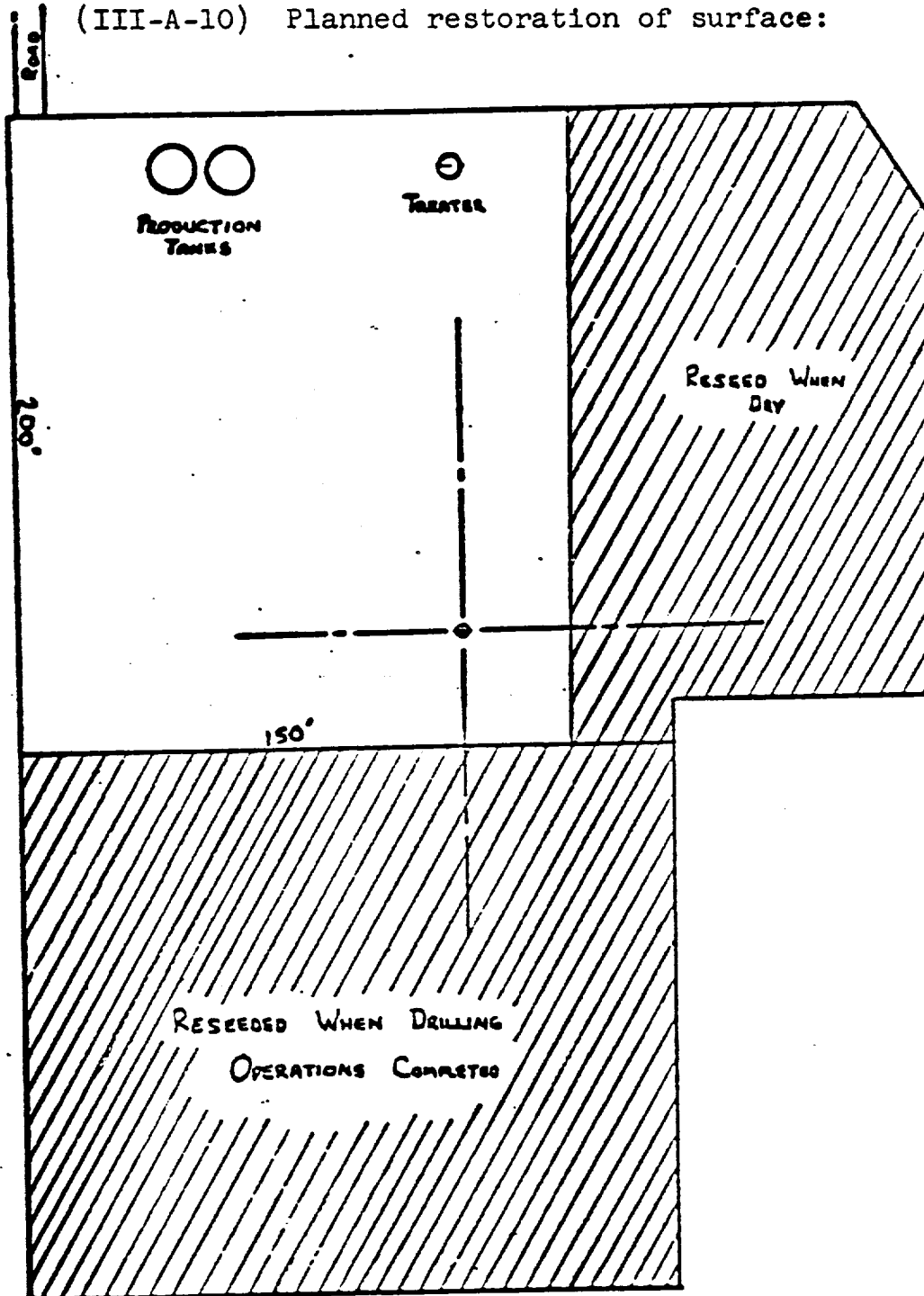

EXHIBIT I

(III-A-10) Planned restoration of surface:



- (a) Waste disposal outlined in Exhibit F.
- (b) Rehabilitation commencement of wellsite surface will take place when well is completed and reserve pit is dry. Work will be completed 2 $\frac{1}{2}$ days after commencement.
- (c) Reseeding will take place within one week of completion of foregoing.

EXHIBIT J

(III-A-11) Other information:

- (a) Area is flat to gently rolling with occasional mesa-valley topography developed. Area drained by ephemeral arroyos and washes.
- (b) Soil characteristics: sandy and clayey loam, where bare rock and shale exposed, no soil profile is developed.
- (c) Surface formation lithologies are sandstone, siltstone, and shale.
- (d) No unusual geologic features are present. Surface geomorphic features are described in (a).
- (e) Flora: Normal dry land grasses are present, shrubs such as sagebrush, Mormon tea, and occasional yucca are present. Trees such as pinon and juniper dot the landscape.
- (f) Fauna: Rabbit, coyotes, and occasional deer are known. Domestic cattle, horses, and sheep occasionally graze the area. Small dry land mammals, rodents and reptiles are present. It is doubtful that the peregrine falcon and the black-footed ferret exist in the area. A normal suite of birds, such as the pinon jay, raven, and an occasional hawk have been seen.
- (g) There is no surface use activity except sporadic grazing.
- (h) Surface ownership at well location: Federal.
- (i) Surface ownership lands crossed by newly constructed or upgraded roads: Federal.
- (j) No steep hillsides nearby; adjacent to north.
- (k) No steep gullies; adjacent to south.
- (l) Proximity to water wells: see Exhibit B.
- (m) No ponds nearby.
- (n) No streams nearby.
- (o) No other facilities nearby.
- (p) No occupied dwellings nearby.

EXHIBIT J
(continued)

- (q) No archaeological sites in area.
- (r) No historical sites in area.
- (s) No cultural sites in area.
- (t) Information concerning cuts and fills of roads,
see Exhibit A-1.
- (u) Information concerning cuts and fills of location,
see Exhibit H.
- (v) Construction practices necessary to accommodate
potential geologic hazards: none.

EXHIBIT K

(III-A-12) Operator's representatives:

- (a) Virgil L. Stoabs
221 Petroleum Center Building
Farmington, NM 87401

Office: (505) 325-8874
Residence: (505) 325-9772
- (b) Albert R. Greer
221 Petroleum Center Building
Farmington, NM 87401

Office: (505) 325-8874
Residence: (505) 325-2674
- (c) John Pool
706 Lovers Lane
Aztec, NM 87410

Residence: (505) 334-6616
- (d) M. P. York
725 W. Animas
Farmington, NM 87401

Residence: (505) 325-9714
- (e) E. A. Templeman
520 Park Avenue
Aztec, NM 87410

Residence: (505) 334-9197

EXHIBIT L

(III-A-13) Certification:

I hereby certify that I, or persons under by direct supervision, have inspected the proposed drillsite and access route; that I am familiar with the conditions which presently exist; that the statements made in this plan are, to the best of my knowledge, true and correct; and, that the work associated with the operations proposed herein will be performed by Benson-Montin-Greer Drilling Corp. and its contractors and subcontractors in conformity with this plan and the terms and conditions under which it is approved.

April 10, 1979

Date

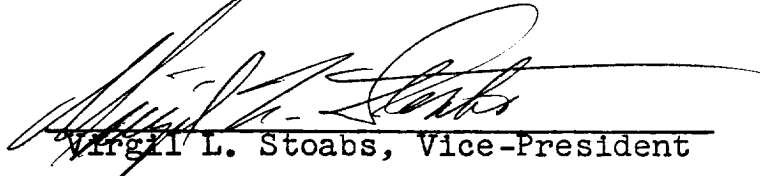
Virgil L. Stoabs, Vice-President