

NO. OF COPIES RECEIVED	5
DISTRIBUTION	
SANTA FE	1
FILE	
U.S.G.S.	2
LAND OFFICE	
OPERATOR	1

NEW MEXICO OIL CONSERVATION COMMISSION

32-045-23636
Form C-101
Revised 1-1-55

5A. Indicate Type of Lease
STATE <input type="checkbox"/> FEE <input checked="" type="checkbox"/>
5. State Oil & Gas Lease No.

APPLICATION FOR PERMIT TO DRILL, DEEPEN, OR PLUG BACK

1a. Type of Work	DRILL <input checked="" type="checkbox"/> DEEPEN <input type="checkbox"/> PLUG BACK <input type="checkbox"/>
b. Type of Well	OIL WELL <input type="checkbox"/> GAS WELL <input checked="" type="checkbox"/> OTHER <input type="checkbox"/> SINGLE ZONE <input type="checkbox"/> MULTIPLE ZONE <input checked="" type="checkbox"/>
2. Name of Operator	Consolidated Oil & Gas, Inc.
3. Address of Operator	1860 Lincoln Street, Suite 1300, Denver, Colorado 80295
4. Location of Well	UNIT LETTER "N" LOCATED 820 FEET FROM THE South LINE AND 2220 FEET FROM THE West LINE OF SEC. 34 TWP. 32N RGF. 13W NADPM
11. Proposed Depth	6920'
19A. Formation	Dakota
20. Rotary or C.T.	Rotary
21. Elevations (Show whether DP, RT, etc.)	5829 GR
21A. Kind & Status Plug, Bond	Blanket/Inforce
21B. Drilling Contractor	NA
22. Approx. Date Work will start	July 1, 1979

7. Unit Agreement Name
8. Farm or Lease Name
Robinson Bros.
9. Well No.
1-M
10. Field and Pool, or, if distinct, Mesaverde/Dakota
12. County
San Juan

PROPOSED CASING AND CEMENT PROGRAM					
SIZE OF HOLE	SIZE OF CASING	WEIGHT PER FOOT	SETTING DEPTH	SACKS OF CEMENT	EST. TOP
12-1/4"	8-5/8"	24.0#	250'	200	Circ to surf.
7-7/8"	5-1/2"	15.5#	6920'	500	3000'

1. Drill 12-1/4" hole to \pm 250'. Set 8-5/8" casing, circulate cement to surface.
2. WOC 12 hours.
3. NU BOP's. Pressure test surface casing and BOP's to 1000#.
4. Drill 7-7/8" hole to \pm 6920' w/fresh water gel mud. Log.
5. Run 5-1/2" casing and cement same in two stages w/approximately 500 sx.
6. Selectively perforate and stimulate the Mesaverde and Dakota formations and complete as required by applicable rules and regulations.

The S/2 of Section 34 is dedicated to this well and the acreage is committed to a gas sales contract.

9-23-79

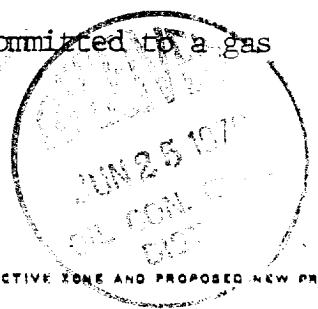

IN ABOVE SPACE DESCRIBE PROPOSED PROGRAM IF PROPOSAL IS TO DEEPEN OR PLUG BACK, GIVE DATA ON PRESENT PRODUCTIVE ZONE AND PROPOSED NEW PRODUCTIVE ZONE. GIVE SLOWOUT PREVENTER PROGRAM, IF ANY.

I hereby certify that the information above is true and complete to the best of my knowledge and belief.

Signed M. J. Rohan Title Senior Production Engineer Date June 13, 1979

APPROVED BY Frank S. Chang TITLE DEPUTY OIL & GAS INSPECTOR, DIST. #3 DATE JUN 25 1979

CONDITIONS OF APPROVAL, IF ANY:
Subject to approval of non-standard location in Blaine Mesaverde and Basin Dakota pools

NEW MEXICO OIL CONSERVATION COMMISSION
WELL LOCATION AND ACREAGE DEDICATION PLAT

Form C-102
Supersedes C-128
Effective 1-1-65

All distances must be from the outer boundaries of the Section.

Operator CONSOLIDATED OIL AND GAS, INC.		Lease ROBINSON BROS.		Well No. 1-M
Unit Letter N	Section 34	Township 32 NORTH	Range 13 WEST	County SAN JUAN
Actual Footage Location of Well: 820 feet from the SOUTH line and 2220 feet from the WEST line				
Ground Level Elev. 5829	Producing Formation Mesaverde	Pool Blanco Mesaverde	Dedicated Acreage: 320.00 Acres	

1. Outline the acreage dedicated to the subject well by colored pencil or hachure marks on the plat below.
2. If more than one lease is dedicated to the well, outline each and identify the ownership thereof (both as to working interest and royalty).
3. If more than one lease of different ownership is dedicated to the well, have the interests of all owners been consolidated by communitization, unitization, force-pooling, etc?

☒ Yes ☐ No If answer is "yes," type of consolidation Communitization

If answer is "no," list the owners and tract descriptions which have actually been consolidated. (Use reverse side of this form if necessary.) _____

No allowable will be assigned to the well until all interests have been consolidated (by communitization, unitization, forced-pooling, or otherwise) or until a non-standard unit, eliminating such interests, has been approved by the Commission.

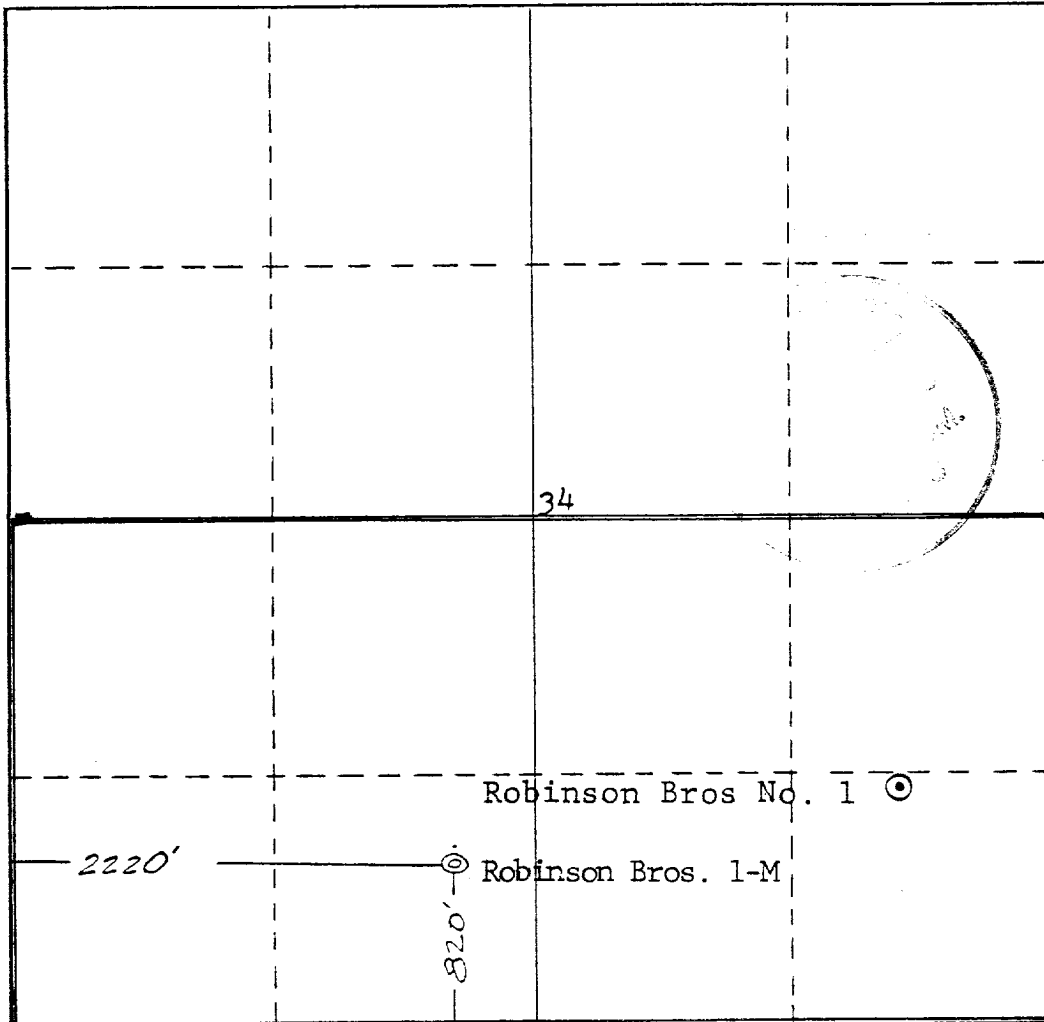

CERTIFICATION

I hereby certify that the information contained herein is true and complete to the best of my knowledge and belief.

C. M. Parham

Name
C. M. Parham

Position
Senior Production Engineer

Company
Consolidated Oil & Gas, Inc.

Date
6-21-79

I hereby certify that the well location shown on this plat was plotted from field notes of actual survey made by me or under my supervision and that the same is true and correct to the best of my knowledge and belief.

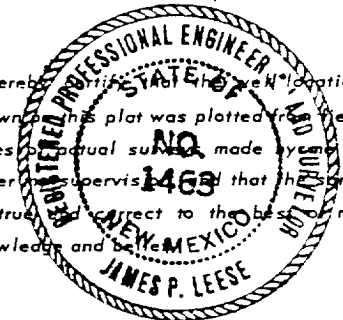

Date Surveyed
16 June 1979

Registered Professional Engineer
and/or Land Surveyor

James P. Leese
James P. Leese

Certificate No.
1463

NEW MEXICO OIL CONSERVATION COMMISSION
WELL LOCATION AND ACREAGE DEDICATION PLAT

Form C-102
Supersedes C-128
Effective 1-1-65

All distances must be from the outer boundaries of the Section.

Operator CONSOLIDATED OIL AND GAS, INC.		Lease ROBINSON BROS.		Well No. 1-M
Unit Letter N	Section 34	Township 32 NORTH	Range 13 WEST	County SAN JUAN
Actual Footage Location of Well: 820 feet from the SOUTH line and 2220 feet from the WEST line				
Ground Level Elev. 5829	Producing Formation Dakota	Pool Basin Dakota	Dedicated Acreage: 320.00 Acres	

1. Outline the acreage dedicated to the subject well by colored pencil or hachure marks on the plat below.
2. If more than one lease is dedicated to the well, outline each and identify the ownership thereof (both as to working interest and royalty).
3. If more than one lease of different ownership is dedicated to the well, have the interests of all owners been consolidated by communitization, unitization, force-pooling, etc?

☒ Yes ☐ No If answer is "yes," type of consolidation Communitization

If answer is "no," list the owners and tract descriptions which have actually been consolidated. (Use reverse side of this form if necessary.) _____

No allowable will be assigned to the well until all interests have been consolidated (by communitization, unitization, forced-pooling, or otherwise) or until a non-standard unit, eliminating such interests, has been approved by the Commission.

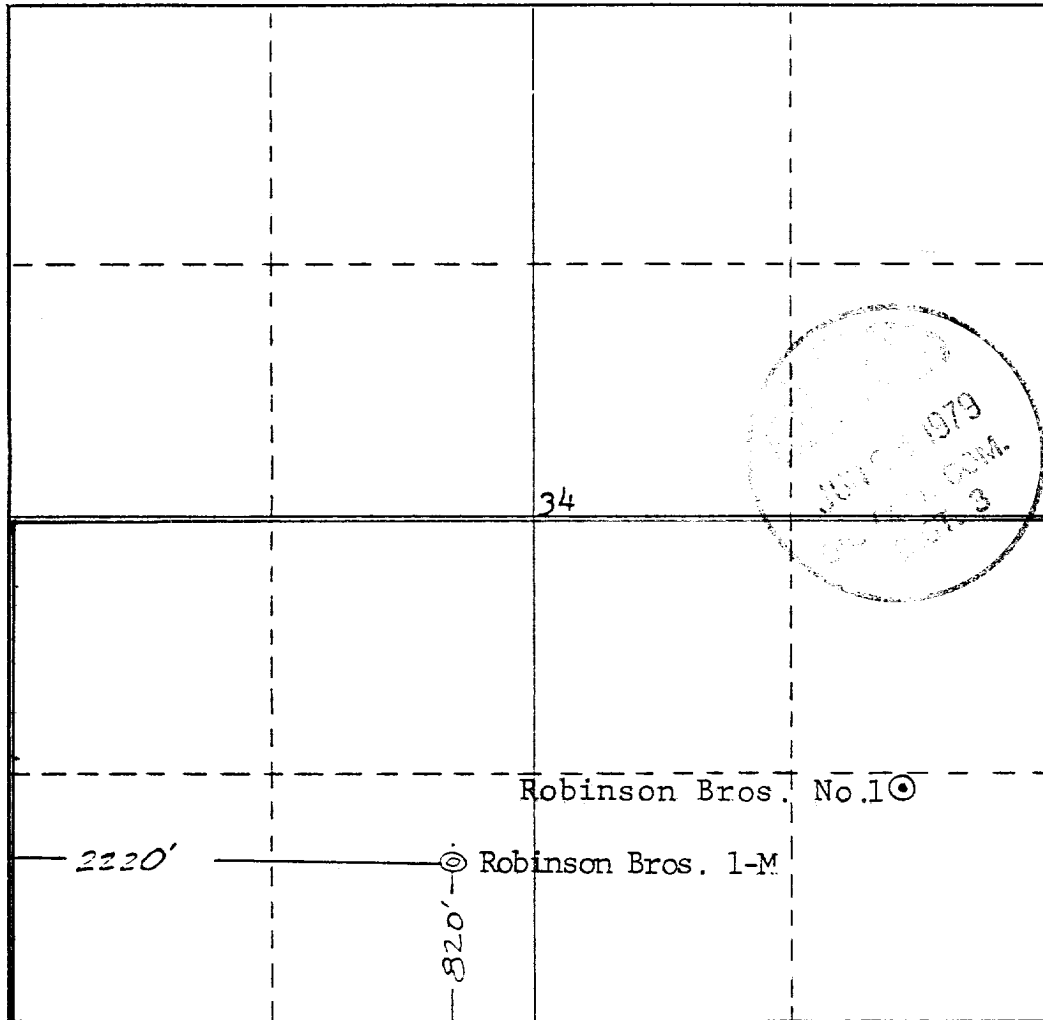

CERTIFICATION

I hereby certify that the information contained herein is true and complete to the best of my knowledge and belief.

C. M. Parham
Name
C. M. Parham
Position
Senior Production Engineer
Company
Consolidated Oil & Gas, Inc.
Date
6-21-79

I hereby certify that the well location shown on this plat was plotted from field notes and actual survey made by me or under my supervision and that the same is true and correct to the best of my knowledge and belief.

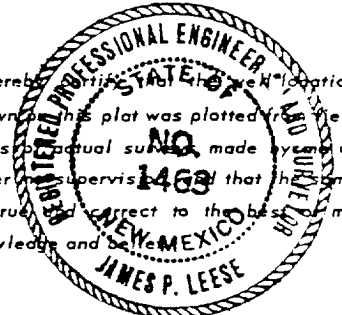

Date Surveyed
16 June 1979
Registered Professional Engineer
and Land Surveyor
James P. Leese
James P. Leese

Certificate No. **1463**

