

Submit to Appropriate
District Office
State Lease - 6 copies
Fee Lease - 5 copies

State of New Mexico
Energy, Minerals and Natural Resources Department

Form C-101
Revised 1-1-89

OIL CONSERVATION DIVISION

P.O. Box 2088
Santa Fe, New Mexico 87504-2088

DISTRICT I
P.O. Box 1980, Hobbs, NM 88240

DISTRICT II
P.O. Drawer DD, Artesia, NM 88210

DISTRICT III
1000 Rio Brazos Rd., Aztec, NM 87410

API NO. (assigned by OCD on New Wells)

30-045-23636

5. Indicate Type of Lease

STATE ☐

FEE ☒

6. State Oil & Gas Lease No.

APPLICATION FOR PERMIT TO DRILL, DEEPEN, OR PLUG BACK

1a. Type of Work:

DRILL ☐

RE-ENTER ☐

DEEPEN ☐

PLUG BACK ☒

b. Type of Well:

OIL

WELL ☐

GAS

WELL ☒

OTHER ☐

SINGLE

ZONE ☒

MULTIPLE

ZONE ☐

7. Lease Name or Unit Agreement Name

Robinson Brothers

2. Name of Operator

Hallwood Petroleum, Inc.

8. Well No.

1-M

3. Address of Operator

P. O. Box 378111, Denver, Colorado 80237

9. Pool name or Wildcat

Basin Fruitland Coal

4. Well Location

Unit Letter N : 820 Feet From The South Line and 2220 Feet From The West Line

Section 34

Township 32N

Range 13W

NMPM

San Juan

County

10. Proposed Depth

2100'

11. Formation

Fruitland Coal

12. Rotary or C.T.

N/A

13. Elevations (Show whether DF, RT, GR, etc.)

5829' GR, 5842' KB

14. Kind & Status Plug. Bond

Blanket B1595231

15. Drilling Contractor

N/A

Already drilled

16. Approx. Date Work will start

2/1/94

17. PROPOSED CASING AND CEMENT PROGRAM

SIZE OF HOLE	SIZE OF CASING	WEIGHT PER FOOT	SETTING DEPTH	SACKS OF CEMENT	EST. TOP
12 1/4	8 5/8"	24#	257	250	0
7 7/8	5 1/2"	15.50#	6963	1250*	0

*3 Stage cement job, circulated out 20 bbls. cement on top (last) stage.

Hallwood Petroleum, Inc. is the new operator for the subject well. Hallwood proposes to abandon the Dakota and Mesa Verde formations per the attached procedure and plug back and recomple to the Basal Fruitland Coal formation at 2040-2070'.

RECEIVED

JAN 25 1994

OIL CON. DIV.
DIST. 3

IN ABOVE SPACE DESCRIBE PROPOSED PROGRAM: IF PROPOSAL IS TO DEEPEN OR PLUG BACK, GIVE DATA ON PRESENT PRODUCTIVE ZONE AND PROPOSED NEW PRODUCTIVE ZONE. GIVE BLOWOUT PREVENTER PROGRAM, IF ANY.

I hereby certify that the information above is true and complete to the best of my knowledge and belief.

SIGNATURE

Kevin O'Connell

TITLE Drilling & Production Manager DATE 1/18/94

TYPE OR PRINT NAME

Kevin O'Connell

(303) TELEPHONE NO. 850-7373

(This space for State Use)

APPROVED BY

Ernie Bush

TITLE DEPUTY OIL & GAS INSPECTOR, DIST. 3 DATE JAN 26 1994

CONDITIONS OF APPROVAL, IF ANY:

Hold C-10 for PTH of Robinson 34#2 well*

ROBINSON BROTHERS #1-M (FC)
FRUITLAND COAL RECOMPLETION

WELL DATA:

ELEVATIONS: 5,842' KB
5,829' GL
13' Difference

TOTAL DEPTH: 6,980'

SPUD DATE: 6/11/80

CASING: 8-5/8" surface at 257', cemented with 250 sacks.

5-1/2" production at 6,963', cemented with 1,250 sacks cement to surface.

OPEN PERFS: Dakota: 6,714-6,830'
6,893-6,915'
Mesaverde: 4,536-4,757'

API#: 30-045-23636

PROCEDURE:

1. MIRUSU, set anchors if necessary.
2. Kill well, ND tree & NU BOP's.
3. Strap out of hole with tubing.

NOTE: Reports are sketchy right now as to what is in the well. We will hopefully obtain more information on the downhole equipment and packer after purchase transaction is completed. Completion records show 1-1/2" tubing to 6,699' with a packer at 4,840' (for Dakota) and 1-1/4" tubing at 4,585'.

4. Run in hole with tubing and circulate plug mud.
5. After tubing/packer are removed run in hole with 2-3/8" tubing and spot a 100' plug inside casing above Dakota perfs from 6,700-6,600'.
6. POH to 4,500' and spot a second 100' cement plug above the Mesaverde perfs.
7. POOH with tubing, RU wireline and set a CIBP at 2,500', cap with 35' of cement.
8. RIH and circulate hole over to fresh water or 2% KCL water.
9. Perforate the Basal Fruitland Coal a 2,040-2,070' with 8 SPF, 4-inch casing guns with 90° phasing.
10. Frac the Basal Fruitland Coal with approximately the following:
 - a. Spearhead 2,000 gallons 7-1/2% HCL acid.
 - b. 78,000 gallons 30# borate gelled system.
 - c. 18,000# 40/70 Brady sand.
 - d. 240,000# 12/20 Brady sand ramped up to 8 ppg.
11. After fracing well, and 4 hour shut-in, flow well until it dies, check for fill, clean out as needed.
12. Rod well up and pump test for several days.

Hallwood Energy Companies

Well History Record

CURRENT AS-15
WELLBORE

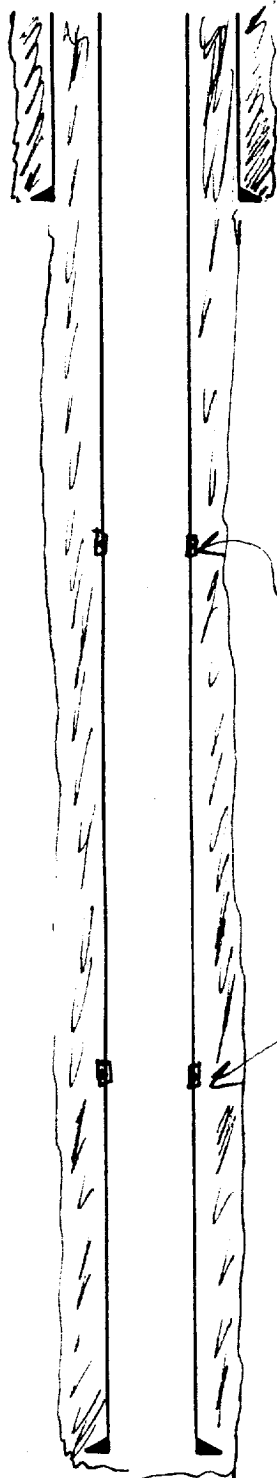

Surface

85/8 " 24 #
Gr J-55 @ 257'
Cmt.wl 250 Sxs.
TOC @ SURFACE *
Hole Size 12 1/4" "
Max Mud Wt. 8.6 #
*CIRC. 12 BOLS CEMENT

DV TOOL 2323'

DV TOOL 4933'

Production

5 1/2 " 15.50 #
Gr K-55 @ 6963'
Cmt.wl 1250 ** Sxs.
TOC @ SURFACE
Hole Size 7 7/8 "
Max Mud Wt. 9.0 #

WELL: ROBINSON BROTHERS #1-M

LOCATION: UNIT N, 820' FSL X 2220' FWL
Sec. 34 - T32N - R13W, SAN JUAN CO, NM

SPUD DATE: 6-11-80

COMPL. DATE: 10-23-80

T.D.: 6980' PBTD: 6932'

FIELD: BLANCO MESA VERDE

ZONES: DAKOTA / MESA VERDE

PERFS: 4536 - 4757', 18 holes (MV)
6714 - 6915', 27 holes (DAKOTA)
6714 - 6830' + 6893 - 6915'

STIMULATION: FOAM FRACED

~~***~~ LONG STRING CEMENTED WITH
3 STAGE JOB:

STAGE 1: 450 SX 50/50 POZ

STAGE 2: 500 SX 50/50 POZ

STAGE 3: 350 SX 65/35 POZ

+ 400 SX 50/50 POZ

TOTAL 1700 SACKS

TOPS: PICTURED CLIFFS 2070'

CLIFF HOUSE 3710'

DAKOTA 6684'

KEO 1/17/94

Submit to Appropriate
District Office
State Lease - 4 copies
Fee Lease - 3 copies

State of New Mexico
Energy, Minerals and Natural Resources Department

Form C-102
Revised 1-1-89

OIL CONSERVATION DIVISION

DISTRICT I
P.O. Box 1980, Hobbs, NM 88240

P.O. Box 2088
Santa Fe, New Mexico 87504-2088

DISTRICT II
P.O. Drawer DD, Artesia, NM 88210

DISTRICT III
1000 Rio Brazos Rd., Aztec, NM 87410

WELL LOCATION AND ACREAGE DEDICATION PLAT

All Distances must be from the outer boundaries of the section

Operator Hallwood Petroleum, Inc.			Lease Robinson Brothers		Well No. 1-M
Unit Letter N	Section 34	Township 32N	Range 13W	County NMMP	San Juan
Actual Footage Location of Well: 820 feet from the South line and 2220 feet from the West line					
Ground level Elev. 5829'	Producing Formation Fruitland Coal	Pool Basin Fruitland Coal	Dedicated Acreage: (±) 5/320 Acres		
<p>1. Outline the acreage dedicated to the subject well by colored pencil or hatchure marks on the plat below.</p> <p>2. If more than one lease is dedicated to the well, outline each and identify the ownership thereof (both as to working interest and royalty).</p> <p>3. If more than one lease of different ownership is dedicated to the well, have the interest of all owners been consolidated by communitization, unitization, force-pooling, etc.? <input type="checkbox"/> Yes <input type="checkbox"/> No If answer is "yes" type of consolidation _____ If answer is "no" list the owners and tract descriptions which have actually been consolidated. (Use reverse side of this form if necessary.) _____ No allowable will be assigned to the well until all interests have been consolidated (by communitization, unitization, forced-pooling, or otherwise) or until a non-standard unit, eliminating such interest, has been approved by the Division.</p>					

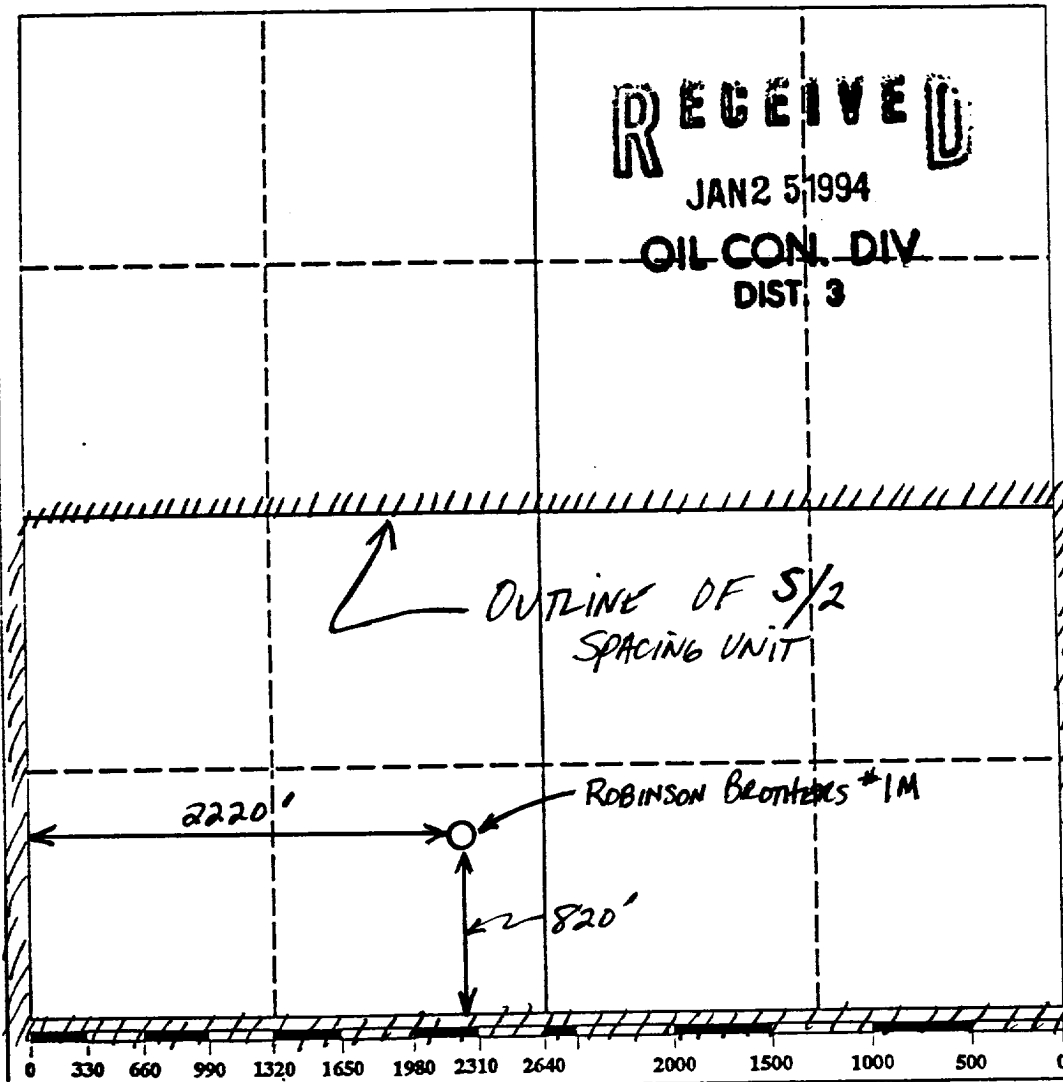

OPERATOR CERTIFICATION

I hereby certify that the information contained herein is true and complete to the best of my knowledge and belief.

Signature
Kevin E. O'Connell
Printed Name
Kevin E. O'Connell
Position
Drlg. & Prod. Manager
Company
Hallwood Petroleum, Inc.
Date
January 17, 1994

SURVEYOR CERTIFICATION

I hereby certify that the well location shown on this plat was plotted from field notes of actual surveys made by me or under my supervision, and that the same is true and correct to the best of my knowledge and belief.

Date Surveyed
Signature & Seal of Professional Surveyor
Certificate No.