

NO. OF COPIES RECEIVED	5
DISTRIBUTION	
SANTA FE	1
FILE	
U.S.G.S.	2
LAND OFFICE	
OPERATOR	1

NEW MEXICO OIL CONSERVATION COMMISSION

30-045-23944
Form C-101
Revised 1-1-65

5A. Indicate Type of Lease	
STATE <input type="checkbox"/>	FEE <input checked="" type="checkbox"/>
5. State Oil & Gas Lease No.	

APPLICATION FOR PERMIT TO DRILL, DEEPEN, OR PLUG BACK

1a. Type of Work		7. Unit Agreement Name	
b. Type of Well OIL WELL <input type="checkbox"/> GAS WELL <input checked="" type="checkbox"/> OTHER <input type="checkbox"/>		Federal Gas Com Unit	
2. Name of Operator		8. Farm or Lease Name	
Energy Reserves Group, Inc		Federal Gas Com Unit	
3. Address of Operator		9. Well No.	
Box 3280, Casper, Wyoming 82602		1-A	
4. Location of Well		10. Field and Pool, or Wildcat	
UNIT LETTER F LOCATED 1600' FEET FROM THE North LINE		Blanco Mesaverde	
AND 1690' FEET FROM THE West LINE OF SEC. 20 TWP. 32N RGE. 12W NMPM		12. County	
		San Juan	
19. Proposed Depth		19A. Formation	
5000'		Mesa Verde	
20. Rotary or C.T.		Rotary	
21. Elevations (Show whether DF, RT, etc.)		21B. Drilling Contractor	
5914 GR		Coleman Drilling	
21A. Kind & Status Plug. Bond		22. Approx. Date Work will start	
Blanket-3881464		Oct. - Nov. 1979	

PROPOSED CASING AND CEMENT PROGRAM

SIZE OF HOLE	SIZE OF CASING	WEIGHT PER FOOT	SETTING DEPTH	SACKS OF CEMENT	EST. TOP
12 1/2"	8-5/8"	24#	250'±	Cmt to surface	Surface
7-7/8"	4 1/2"	9.5#	5000±	250sx	4000'

Energy Reserves Group, Inc. proposes to drill the above referenced well with rotary tools from the surface to T.D. proposed zone of completion is the Mesa Verde formation @4650'. No coring or DST's are planned.

Copies of all logs run will be furnished upon completion of the well.

Formation Tops:

Ojo Alamo 1200'
Fruitland 1350'
Picture Cliffs 2150'
Lewis 2300'
Cliff House 3800'
Menefee 4100'
Pt. Lookout 4650'
T.D. 5000'

Gas Dedicated - El Paso Natural Gas Company

FOR 10
121

1-30-80

IN ABOVE SPACE DESCRIBE PROPOSED PROGRAM: IF PROPOSAL IS TO DEEPEN OR PLUG BACK, GIVE DATA ON PRESENT PRODUCTIVE ZONE AND PROPOSED NEW PRODUCTIVE ZONE. GIVE BLOWOUT PREVENTER PROGRAM, IF ANY.

I hereby certify that the information above is true and complete to the best of my knowledge and belief.

Signed William J. Hines Title Field Services Administrator Date 10-29-79

(This space for State Use)

APPROVED BY Frank S. Chang TITLE DATE 1 1979

CONDITIONS OF APPROVAL, IF ANY:

OIL CONSERVATION DIVISION

P. O. BOX 2088

Form C-102
Revised 10-1-78

STATE OF NEW MEXICO

ENERGY AND MINERALS DEPARTMENT

SANTA FE, NEW MEXICO 87501

All distances must be from the outer boundaries of the Section.

Operator • ENERGY RESERVES GROUP			Lease FEDERAL GAS COM 1		Well No. 1-A
Unit Letter F	Section 20	Township 32N	Range 12W	County San Juan	
Actual Footage Location of Well: 1600 feet from the North line and 1690 feet from the West line					
Ground Level Elev. 5914	Producing Formation Dakota Mesaverde		Pool Basin Dakota Blanco	Dedicated Acreage: 320 (160) Acres	

1. Outline the acreage dedicated to the subject well by colored pencil or hachure marks on the plat below.
2. If more than one lease is dedicated to the well, outline each and identify the ownership thereof (both as to working interest and royalty).
3. If more than one lease of different ownership is dedicated to the well, have the interests of all owners been consolidated by communitization, unitization, force-pooling, etc?

☐ Yes ☐ No If answer is "yes," type of consolidation _____

If answer is "no," list the owners and tract descriptions which have actually been consolidated. (Use reverse side of this form if necessary.) _____

No allowable will be assigned to the well until all interests have been consolidated (by communitization, unitization, forced-pooling, or otherwise) or until a non-standard unit, eliminating such interests, has been approved by the Commission.

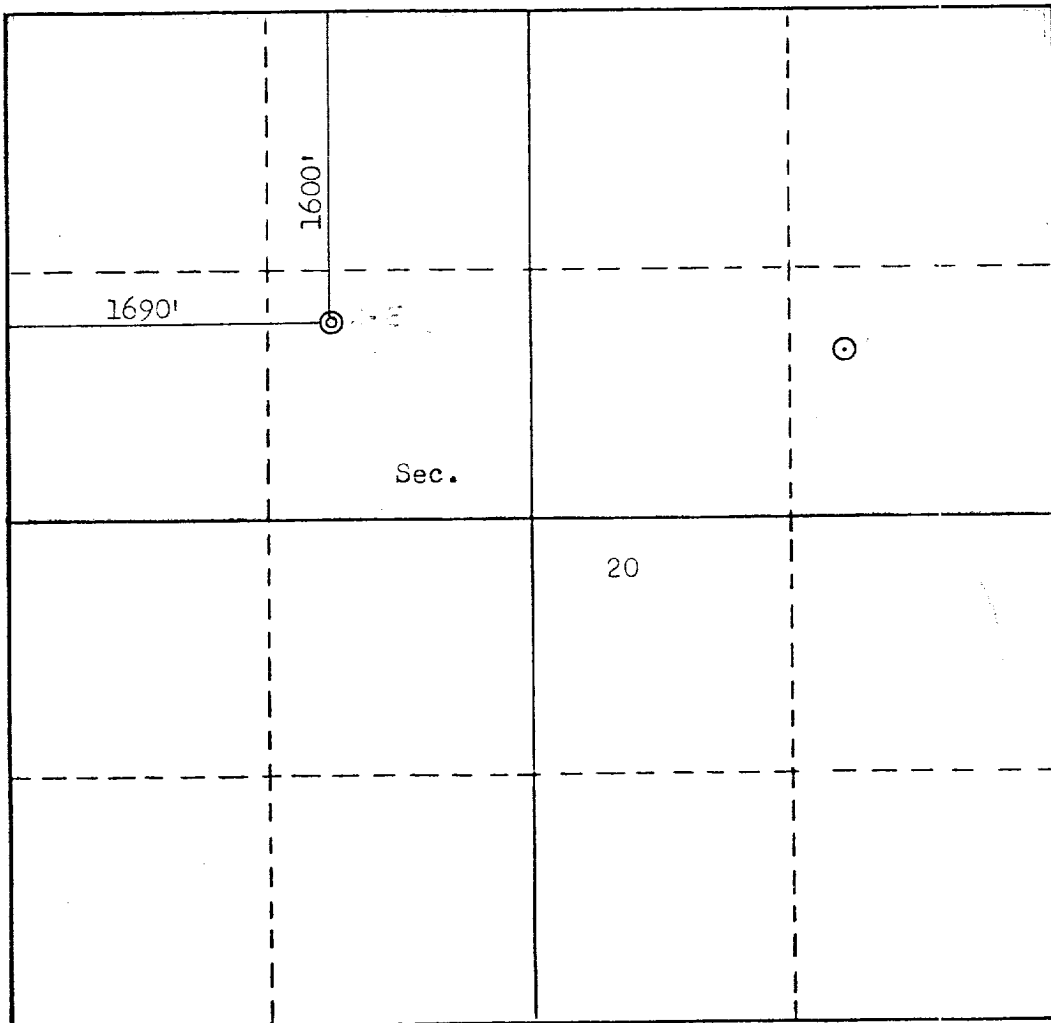

CERTIFICATION

I hereby certify that the information contained herein is true and complete to the best of my knowledge and belief.

Name
William J. Kerr
Position
Field Services Administ.
Company
Energy Reserves Group, Inc.
Date
10-29-79

I hereby certify that the well location shown on this plat was plotted from field notes of actual surveys made by me or under my supervision, and that the same is true and correct to the best of my knowledge and belief.

Date Surveyed
October 10, 1979
Registered Professional Engineer
and/or Land Surveyor
Fred B. Kerr Jr.
Certificate No.
3950