

NO. OF COPIES RECEIVED	
DISTRIEUTION	
SANTA FE	
FILE	
U.S.G.S.	
LAND OFFICE	
OPERATOR	

# NEW MEXICO OIL CONSERVATION COMMISSION

Form C-101  
Revised 1-1-65

5A. Indicate Type of Lease  
STATE ☐ FEE ☒  
5. State Oil & Gas Lease No.

## APPLICATION FOR PERMIT TO DRILL, DEEPEN, OR PLUG BACK

1a. Type of Work b. Type of Well OIL WELL <input type="checkbox"/> GAS WELL <input checked="" type="checkbox"/> OTHER <input type="checkbox"/> DRILL <input checked="" type="checkbox"/> DEEPEN <input type="checkbox"/> PLUG BACK <input type="checkbox"/> SINGLE ZONE <input checked="" type="checkbox"/> MULTIPLE ZONE <input type="checkbox"/>		7. Unit Agreement Name
2. Name of Operator Southland Royalty Company		8. Farm or Lease Name Culpepper Martin
3. Address of Operator P. O. Drawer 570, Farmington, NM 87401		9. Well No. #19
4. Location of Well UNIT LETTER A LOCATED 975 FEET FROM THE North LINE AND 790 FEET FROM THE East LINE OF SEC. 29 TWP. 32N RGE. 12W NMPM		10. Field and Pool, or Wildcat Blanco Pictured Cliffs
		12. County San Juan
		19. Proposed Depth 2550'
		19A. Formation Pict. Cliffs
		20. Rotary or C.T. Rotary
21. Elevations (Show whether DE, RT, etc.) 5955' GR	21A. Kind & Status Plug. Bond	21B. Drilling Contractor
		22. Approx. Date Work will start September 15, 1980

### PROPOSED CASING AND CEMENT PROGRAM

SIZE OF HOLE	SIZE OF CASING	WEIGHT PER FOOT	SETTING DEPTH	SACKS OF CEMENT	EST. TOP
12 1/4"	8 5/8"	24#	140'	100 sx	Surface
6 3/4"	2 7/8"	6.5#	2550'	285 sx	Ojo Alamo
				sufficient to	circulate

Surface formation is Nacimiento.  
Top of Ojo Alamo sand is at 1207'.  
Top of Pictured Cliffs sand is at 2324'.  
Fresh water mud will be used to drill from surface to total depth.  
It is anticipated that an IES and a GR-Density log will be run at total depth.  
No abnormal pressures or poisonous gases are anticipated in this well.  
It is expected that this well will be drilled before March 15, 1981. This depends on time required for approvals, rig availability and the weather.  
Gas is dedicated.

APPROVAL VALID  
FOR 90 DAYS UNLESS  
DRILLING COMMENCED,

EXPIRES 12-13-80



IN ABOVE SPACE DESCRIBE PROPOSED PROGRAM; IF PROPOSAL IS TO DEEPEN OR PLUG BACK, GIVE DATA ON PRESENT PRODUCTIVE ZONE, AND PROPOSED NEW PRODUCTIVE ZONE. GIVE BLOWOUT PREVENTER PROGRAM, IF ANY.

I hereby certify that the information above is true and complete to the best of my knowledge and belief.

Signed P. E. Fields Title District Engineer Date 8-15-80

(This space for State Use)

APPROVED BY Frank J. Chazy TITLE SUPERVISOR DISTRICT #1 DATE AUG 15 1980

CONDITIONS OF APPROVAL, IF ANY:

note cement charge

## OIL CONSERVATION DIVISION

STATE OF NEW MEXICO  
ENERGY AND MINERALS DEPARTMENTP. O. BOX 2088  
SANTA FE, NEW MEXICO 87501Form C-107  
Revised 10-1-78

All distances must be from the outer boundaries of the Section.

Operator <b>SOUTHLAND ROYALTY COMPANY</b>			Lease <b>CULPEPPER-MARTIN</b>		Well No. <b>19</b>
Unit Letter <b>A</b>	Section <b>29</b>	Township <b>32N</b>	Range <b>12W</b>	County <b>San Juan</b>	
Actual Footage Location of Well: <b>975</b> feet from the <b>North</b> line and <b>790</b> feet from the <b>East</b> line					
Ground Level Elev. <b>5955</b>	Producing Formation <b>Pictured Cliffs</b>	Pool <b>Blanco WC</b>		Dedicated Acreage: <b>L60</b> Acres	

1. Outline the acreage dedicated to the subject well by colored pencil or hachure marks on the plat below.
2. If more than one lease is dedicated to the well, outline each and identify the ownership thereof (both as to working interest and royalty).
3. If more than one lease of different ownership is dedicated to the well, have the interests of all owners been consolidated by communitization, unitization, force-pooling, etc?

☐ Yes ☐ No If answer is "yes," type of consolidation \_\_\_\_\_

If answer is "no," list the owners and tract descriptions which have actually been consolidated. (Use reverse side of this form if necessary.) \_\_\_\_\_

No allowable will be assigned to the well until all interests have been consolidated (by communitization, unitization, forced-pooling, or otherwise) or until a non-standard unit, eliminating such interests, has been approved by the Commission.

## CERTIFICATION

I hereby certify that the information contained herein is true and complete to the best of my knowledge and belief.

*R.E. Fielder*

Name

Robert E. Fielder

Position

District Engineer

Company

Southland Royalty Company

Date

August 15, 1980

I hereby certify that the well location shown on this plat was plotted from field notes of actual surveys made by me or under my supervision, and that the same is true and correct to the best of my knowledge and belief.

Date Surveyed

May 21, 1980

Registered Professional Engineer and/or Land Surveyor

Fred B. Kerr, Jr.

Certification

3950

DRILLING SCHEDULE - CULPEPPER MARTIN #19

Location: 975' FNL & 790' FEL, Section 29, T32N, R12W  
San Juan County, NM

Field: Blanco Pictured Cliffs

Elevation: 5955' GR  
5967' KB

Geology:

Formation Tops:	Ojo Alamo	1207'
	Fruitland	1797'
	Pictured Cliffs	2324'
	Total Depth	2550'

Logging Program: IES and GR-Density at Total Depth.

Coring Program : None

Natural Gauges : None

Drilling

Contractor:

Tool Pusher:

SRC Representative:

SRC Answering Service: 325-1841

Dispatch Number: 325-7391

Mud Program: Fresh water mud from surface to Total Depth.

Materials

Casing Program:	Hole Size	Depth	Casing Size	Wt. & Grade	
	12 1/4"	140'	8 5/8"	24#	K-55
	6 3/4"	2550'	2 7/8"	6.5#	K-55

Float Equipment

8-5/8" Surface Casing: Pathfinder cement guide shoe (#1003-1-010).

2-7/8" Production Casing: Sawtooth collar guide shoe. Howco 2 7/8" latch down baffle (PR 60). Two 3 1/16" rubber balls and one 2 7/8" Omega latching plug (PR 59). Use 3 1/4" plug container head. Six B & W stabilizers on bottom 6 joints.

Wellhead Equipment: 8 5/8" X 2 7/8", EUE, screwed head.

Page #2

Cementing

8-5/8" Surface Casing: 118 cu. ft. ( 100 sx) Class "B" with 1/4# gel  
flake per sack and 3%  $\text{CaCl}_2$ . (100% excess.)

2-7/8" Production Casing: 407 cu. ft. ( 235 sx) of 50/50 Class "B" Poz  
with 6% gel mixed with 7.2 gals water per sack  
to weigh 12.85 ppg. Tail in with (50 sx) Class  
"B" with 2%  $\text{CaCl}_2$ . If lost circulation occurs,  
add 1/4 cu. ft. of fine gilsonite per sack.  
(50% excess to cover Ojo Alamo). Displace cemen  
with 50 gallons of 7 1/2% acetic acid. Run  
temperature survey after 12 hours.

---

L. O. Van Ryan  
District Production Manager

REF \_\_\_\_\_  
Date \_\_\_\_\_



**Southland Royalty Company**

August 15, 1980

Oil Conservation Division  
Mr. Frank Chavez  
1000 Rio Brazos Road  
Aztec, NM 87410

RE: Blowout Preventer Plan

Dear Mr. Chavez:

All drilling and completion rigs will be equipped with 6" or larger double gate hydraulic blowout preventers and a hydraulic operated closing unit with steel lines.

The preventer is 3000# working pressure and 6000# test pressure. All crews will be thoroughly trained in the operation of this preventer. The preventer will be tested frequently enough to ensure proper operation.

Sincerely,

SOUTHLAND ROYALTY COMPANY

Robert E. Fielder  
District Engineer

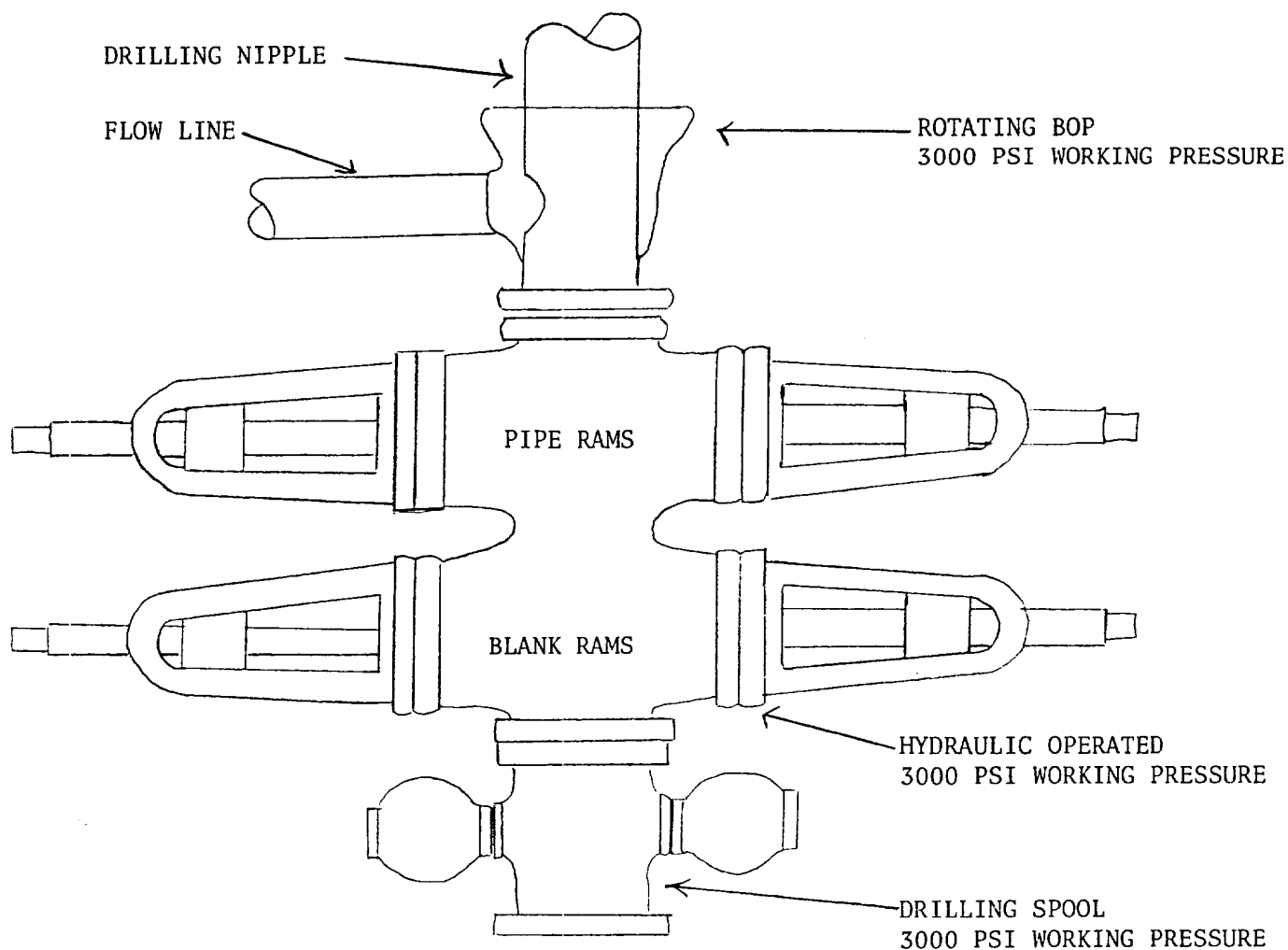



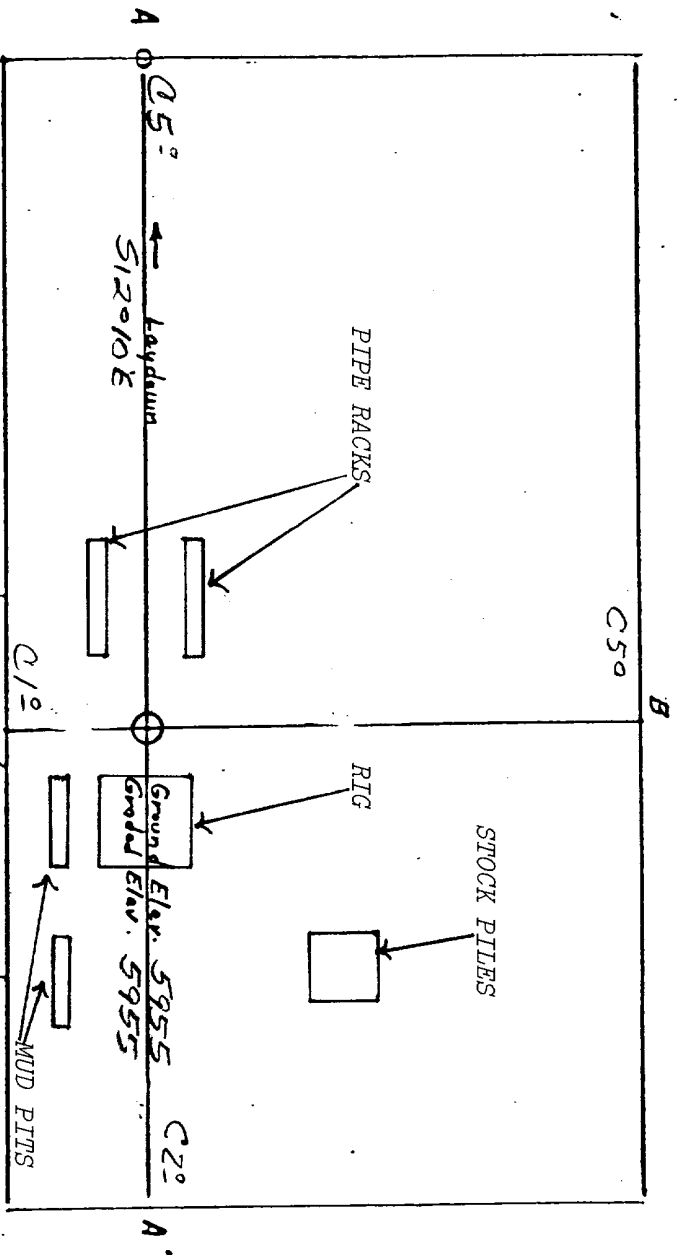

PREVENTERS AND SPOOLS ARE TO HAVE  
THROUGH BORE OF 6" - 3000 PSI OR LARGER

Southland Royalty Company  
Culpepper Martin #19  
975' FNL & 790' FEL  
Section 29, T32N, R12W  
San Juan County, NM

SOUTHLAND ROYALTY COMPANY #19 CULPEPPER-MARTIN  
975 PNL 7901 FEL Sec. 29-T32N-R12W  
SANT JUAN COUNTY, NEW MEXICO



Vert. $1'' = 40'$	A - A' &	Horiz: $1'' = 100'$
5960		
5950		
5940		

	B-B'	E
5960		
5950		
5940		

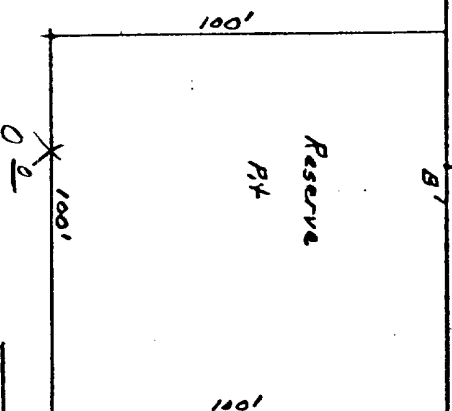
[illegible][illegible]

KERR LAND SURVEYING  
Date: 5/21/80

