

CONSERVATION DIVISION

P. O. BOX 2088

SANTA FE, NEW MEXICO 87501

Form C-107
Revised 10-1-

All distances must be from the outer boundaries of the Section.

Operator UNION TEXAS PETROLEUM COMPANY			Lease CULPEPPER-MARTIN		Well No. 1A
Section Letter G	Section 31	Township 32N	Range 12W	County San Juan	
Actual Footage Location of Well					
1850 feet from the North line and		1850 feet from the East line			
Ground Level Elev. 5842	Producing Formation Mesaverde, Dakota		Pool Blanco Mesaverde, Basin Dakota		Dedicated Acreage 320 Acres

1. Outline the acreage dedicated to the subject well by colored pencil or hatchure marks on the plat below.
2. If more than one lease is dedicated to the well, outline each and identify the ownership thereof (both as to working interest and royalty).
3. If more than one lease of different ownership is dedicated to the well, have the interests of all owners been consolidated by communitization, unitization, force-pooling, etc?

☐ Yes ☐ No If answer is "yes," type of consolidation _____

If answer is "no," list the owners and tract descriptions which have actually been consolidated. (Use reverse side of this form if necessary.) _____

No allowable will be assigned to the well until all interests have been consolidated (by communitization, unitization, forced-pooling, or otherwise) or until a non-standard unit, eliminating such interests, has been approved by the Commission.

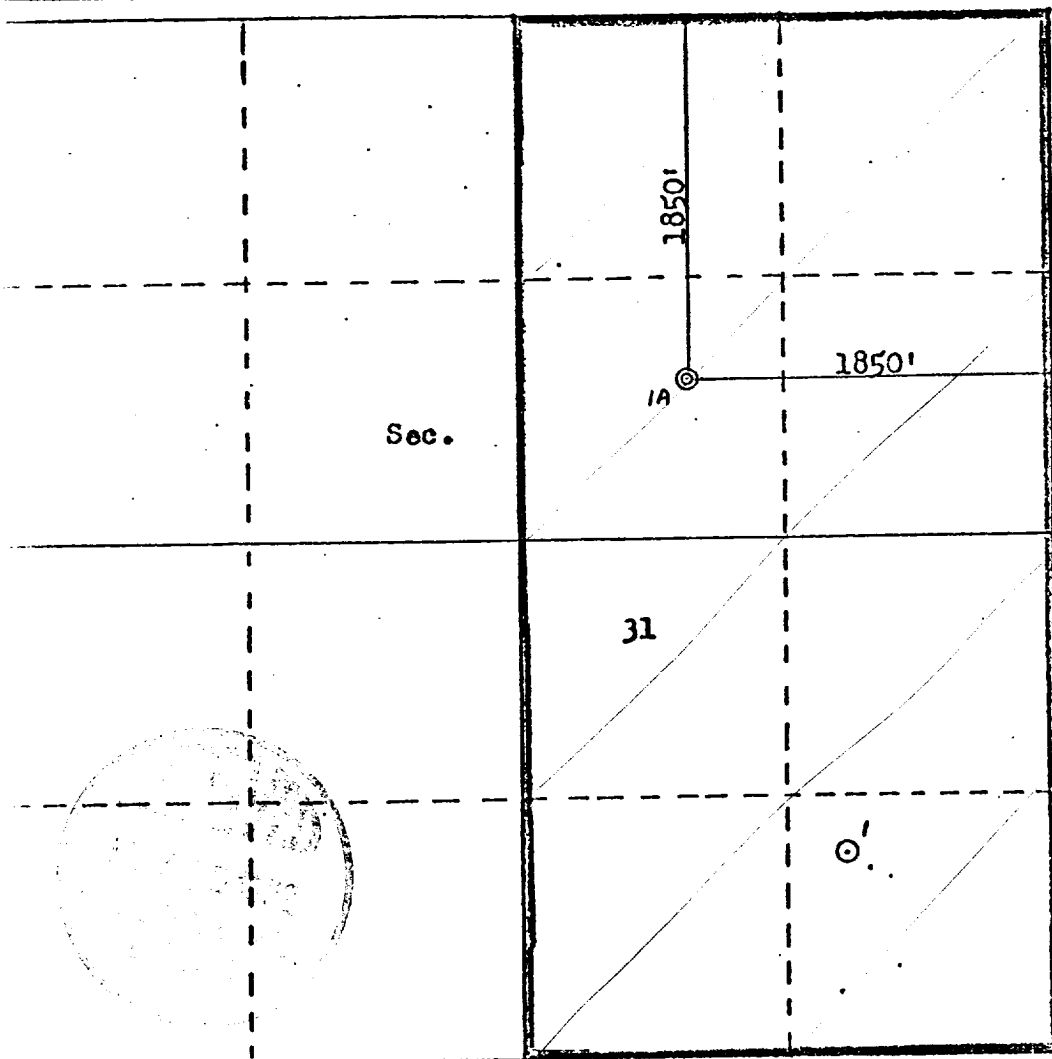

Scale: 1"=1000'

CERTIFICATION

I hereby certify that the information contained herein is true and complete to the best of my knowledge and belief.

Name Thomas C. Balla
Position District Petroleum Engineer
Company Union Texas Petroleum Corp.
Date July 6, 1981

I hereby certify that the well location shown on this plat was plotted from field notes of actual surveys made by me or under my supervision, and that the same is true and correct to the best of my knowledge and belief.

Date Survey June 16, 1981
Registered Professional Engineer and Land Surveyor
Fred E. Kere, Jr.
Certificate No. 3950