

District I  
P.O. Box 1980, Hobbs, NM

District II  
P.O. Drawer DD, Artesia, NM 88221

District III  
1000 Rio Brazos Rd, Aztec, NM 87410

State of New Mexico  
Energy, Minerals and Natural Resources Department

OIL CONSERVATION DIVISION

2040 South Pacheco Street  
Santa Fe, New Mexico 87505

SUBMIT 1 COPY TO  
APPROPRIATE  
DISTRICT OFFICE  
AND 1 COPY TO  
SANTA FE OFFICE

**PIT REMEDIATION AND CLOSURE REPORT**

RECEIVED  
NOV - 1 1999  
OIL CON. DIV.  
DEPT. 3

Operator: PNM Gas Services ( Burlington ) Telephone: 324-3764

Address: 603 W. Elm Street Farmington, NM 87401

Facility or Well Name: Culpepper Martin #1E

Location: Unit P Sec 31 T 32 N R 12 W County San Juan

Pit Type: Separator ☐ Dehydrator ☒ Other                     

Land Type: BLM ☐ State ☐ Fee ☒ Other                     

Pit Location: Pit dimensions: length 15 ' width 15 ' depth 3 '

(Attach diagram) Reference: wellhead ☒ other                     

Footage from reference: 65 '

Direction from reference: 45 Degrees ☒ East North ☒

of ☐ West South ☐

<b>Depth to Ground Water:</b>  (Vertical distance from contaminants to seasonal high water elevation of ground water)	Less than 50 feet	(20 points)	<u>0</u>
	50 feet to 99 feet	(10 points)	
	Greater than 100 feet	( 0 points)	

<b>Wellhead Protection Area:</b>  (Less than 200 feet from a private domestic water source, or, less than 1,000 feet from all other water sources)	Yes	(20 points)	<u>0</u>
	No	( 0 points)	

<b>Distance to Surface Water:</b>  (Horizontal distance to perennial lakes, ponds, rivers, streams, creeks, irrigation canals and ditches)	Less than 200 feet	(20 points)	<u>20</u>
	200 feet to 1,000 feet	(10 points)	
	Greater than 1,000 feet	( 0 points)	

**RANKING SCORE (TOTAL POINTS) :** 20

Culpepper Martin #1E

Date Remediation Started: 05/17/1999

Date Completed: 05/18/1999

Remediation Method: Excavation ☒

Approx. Cubic Yard 791

(Check all appropriate sections)

Landfarmed ☒

Amount Landfarmed (cubic yds) 791

Other

Remediation Location:

Onsite

☒

Offsite

(i.e., landfarmed onsite, name and location of offsite facility)

Backfill Material Location:

General Description of Remedial Action:

Excavated contaminated soil to a pit size of 30.5' X 50' X 14' and landfarmed soil onsite within a bermed area at a depth of 6" to 12". Soil was aerated by disking/plowing until soil met regulatory levels.

Ground Water Encountered:

No



Yes



Depth

Final Pit Closure Sampling:

Sample Location

Five point composite - bottom.

(if multiple samples, attach sample result and diagram of sample locations and depths.)

Sample depth

14'

Sample date

05/18/1999

Sample time

7:50:00 AM

Sample Results

Benzene (ppm)

0.036

Total BTEX (ppm)

2.344

Field headspace (ppm)

TPH (ppm)

< 25.00

Method

8015B

Vertical Extent (ft)

Risk Analysis form attached Yes



No



Ground Water Sample:

Yes



No



(If yes, see attached Groundwater Site Summary Report)

I HEREBY CERTIFY THAT THE INFORMATION ABOVE IS TRUE AND COMPLETE TO THE BEST OF MY KNOWLEDGE AND MY BELIEF

DATE October 28, 1999

SIGNATURE

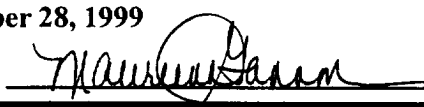

PRINTED NAME Maureen Gannon  
AND TITLE Project Manager

Culpepper Martin #1E

(P) 31-320-12W

Burlington

5-17-99 @ 0420

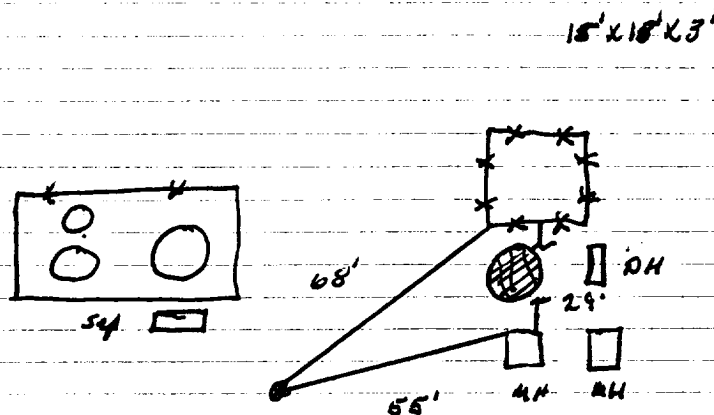

Excavation Sampling

PID readings

5' - 2999 ppm

10' - 2837 ppm

14' - 2169 ppm

30.5'(NYS) x 50'(ETH) x 14'(D)

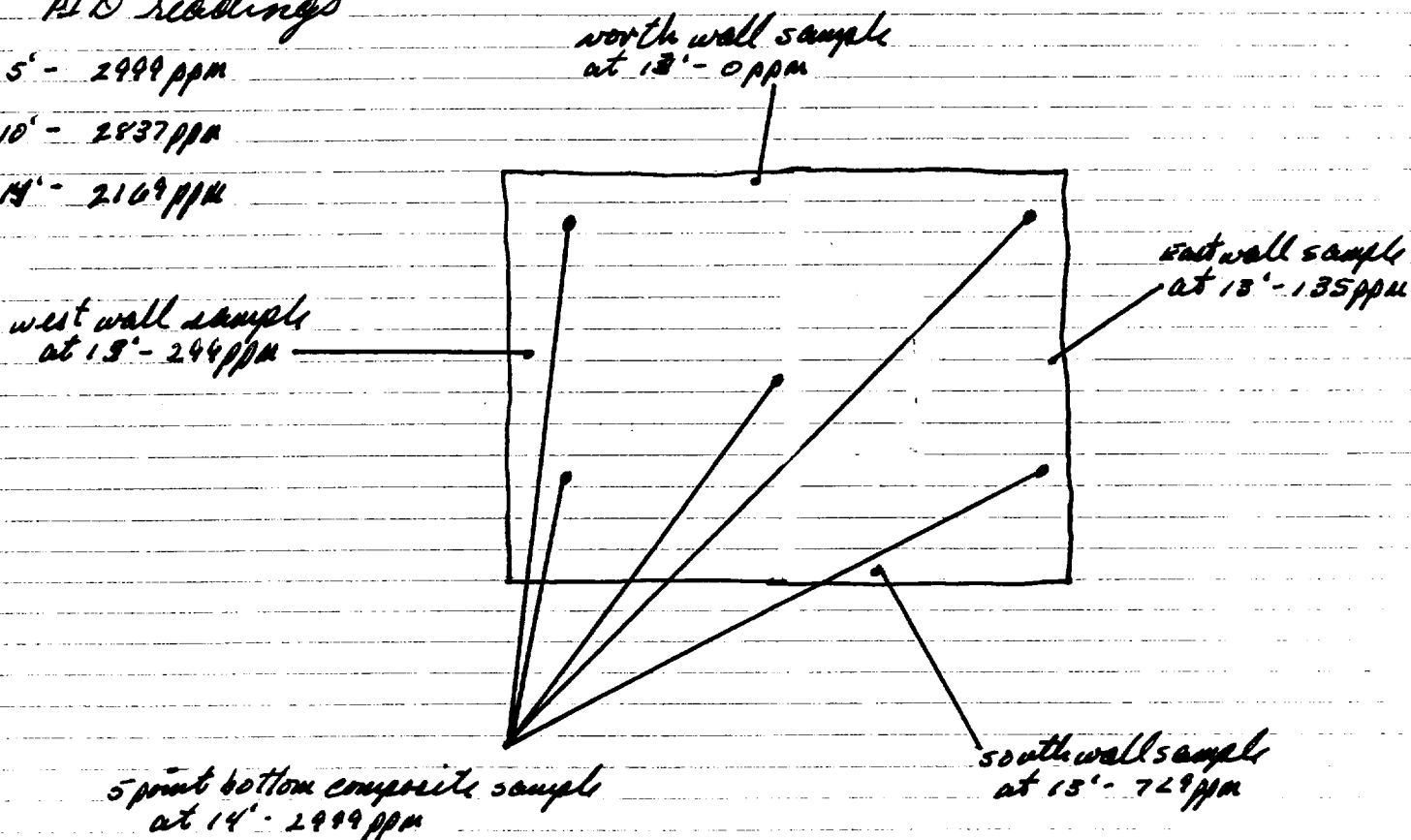

Field Headspace: 130 ppm (walls-composite).

not to scale

OFF: (505) 325-5667



LAB: (505) 325-1556

**On Site Technologies, LTD.**

**Date:** 26-May-99

---

**CLIENT:** PNM - Public Service Company of NM

**Project:** Culpepper Martin #1E & #4M

**Lab Order:** 9905064

## **CASE NARRATIVE**

---

Samples were analyzed using the methods outlined in the following references:

Test Methods for Evaluating Solid Waste, Physical/Chemical Methods, SW846, 3rd Edition

All method blanks, laboratory spikes, and/or matrix spikes met quality assurance objectives.

OFF: (505) 325-5667



LAB: (505) 325-1556

Ray

# ANALYTICAL REPORT

Date: 26-May-99

<b>Client:</b>	PNM - Public Service Company of NM	<b>Client Sample Info:</b>	Culpepper Martin #1E
<b>Work Order:</b>	9905064	<b>Client Sample ID:</b>	9905180750; 5pt. Bottom Comp
<b>Lab ID:</b>	9905064-01A	<b>Matrix:</b>	SOIL
<b>Project:</b>	Culpepper Martin #1E & #4M	<b>Collection Date:</b>	5/18/99 7:50:00 AM
		<b>COC Record:</b>	7625

Parameter	Result	PQL	Qual	Units	DF	Date Analyzed
<b>DIESEL RANGE ORGANICS</b>		<b>SW8015B</b>				Analyst: DC
T/R Hydrocarbons: C10-C28	ND	25		mg/Kg	1	5/21/99
<b>AROMATIC VOLATILES BY GC/PID</b>		<b>SW8021B</b>				Analyst: DM
Benzene	36	25		µg/Kg	25	5/21/99
Toluene	480	50		µg/Kg	25	5/21/99
Ethylbenzene	98	25		µg/Kg	25	5/21/99
m,p-Xylene	1400	50		µg/Kg	25	5/21/99
o-Xylene	330	25		µg/Kg	25	5/21/99

2344  
2.344 ppm

<b>Qualifiers:</b>	PQL - Practical Quantitation Limit	S - Spike Recovery outside accepted recovery limits
	ND - Not Detected at Practical Quantitation Limit	R - RPD outside accepted recovery limits
	J - Analyte detected below Practical Quantitation Limit	E - Value above quantitation range
	B - Analyte detected in the associated Method Blank	Surr: - Surrogate

P.O. BOX 2606 • FARMINGTON, NM 87499

- TECHNOLOGY BLENDING INDUSTRY WITH THE ENVIRONMENT -

OFF: (505) 325-5667



LAB: (505) 325-1556

## ANALYTICAL REPORT

Date: 26-May-99

<b>Client:</b>	PNM - Public Service Company of NM	<b>Client Sample Info:</b>	Culpepper Martin #1E
<b>Work Order:</b>	9905064	<b>Client Sample ID:</b>	9905180800; 4pt. Wall Comp
<b>Lab ID:</b>	9905064-02A	<b>Matrix:</b>	SOIL
<b>Project:</b>	Culpepper Martin #1E & #4M	<b>Collection Date:</b>	5/18/99 8:00:00 AM
		<b>COC Record:</b>	7625

Parameter	Result	PQL	Qual	Units	DF	Date Analyzed
<b>DIESEL RANGE ORGANICS</b>		<b>SW8015B</b>				Analyst: DC
T/R Hydrocarbons: C10-C28	ND	25		mg/Kg	1	5/21/99

**Qualifiers:**

PQL - Practical Quantitation Limit

S - Spike Recovery outside accepted recovery limits

ND - Not Detected at Practical Quantitation Limit

R - RPD outside accepted recovery limits

J - Analyte detected below Practical Quantitation Limit

E - Value above quantitation range

B - Analyte detected in the associated Method Blank

Surr: - Surrogate

P.O. BOX 2606 • FARMINGTON, NM 87499

1 of 1

- TECHNOLOGY BLENDING INDUSTRY WITH THE ENVIRONMENT -

Culpepper Martin 1E  
Sec-31 T-32N R-12W  
Burlington

# Landfarm Drawing #1

App 300 cu yds

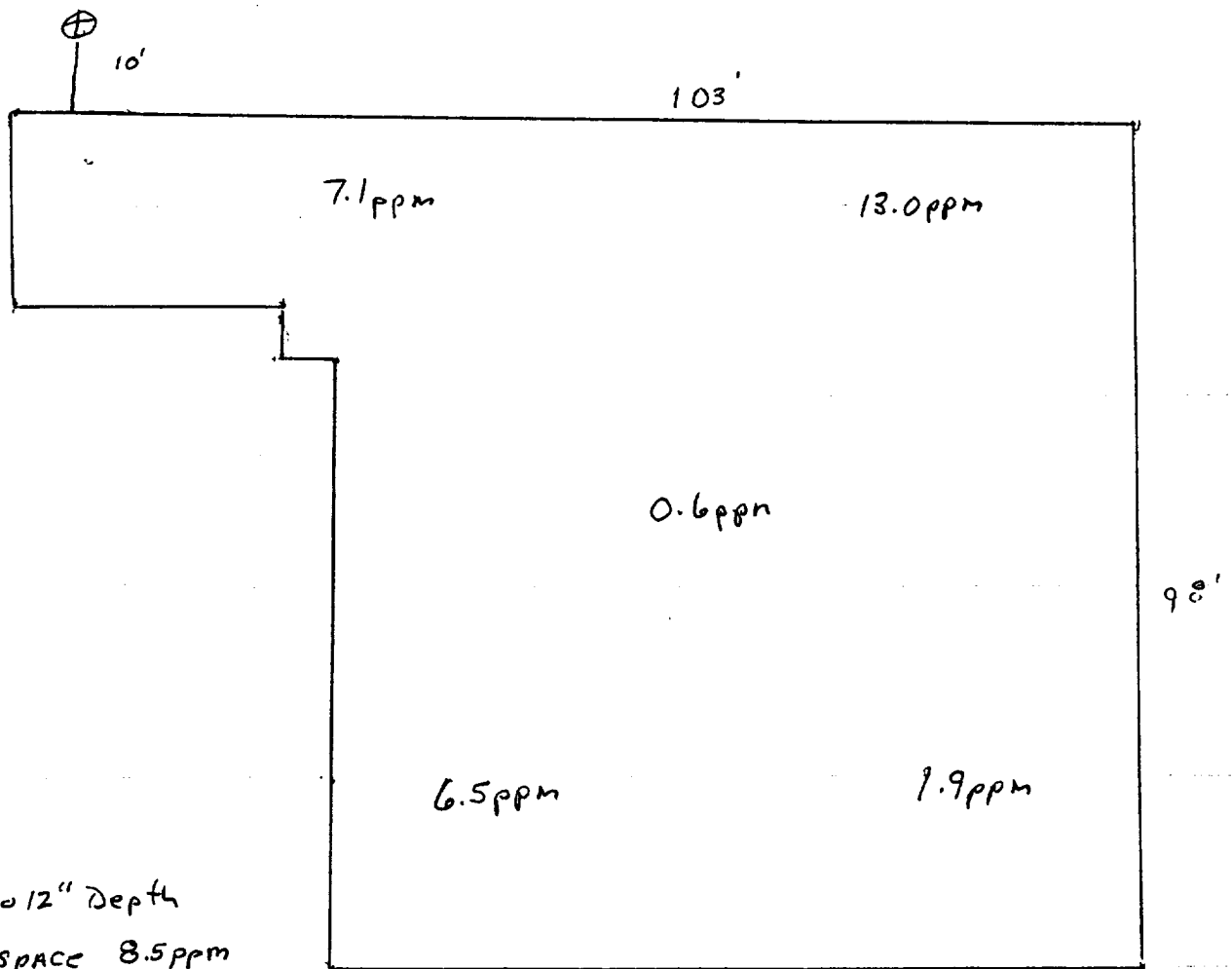

2" to 12" Depth  
Headspace 8.5 ppm  
Sample # 9907131003

Not to Scale

OFF: (505) 325-5667



LAB: (505) 325-1556

**On Site Technologies, LTD.**

**Date: 28-Jul-99**

---

**CLIENT:** PNM - Public Service Company of NM  
**Project:** PNM Pit Remediation Landfarms  
**Lab Order:** 9907033

---

## **CASE NARRATIVE**

Samples were analyzed using the methods outlined in the following references:

Test Methods for Evaluating Solid Waste, Physical/Chemical Methods, SW846, 3rd Edition

All method blanks, laboratory spikes, and/or matrix spikes met quality assurance objectives.



OFF: (505) 325-5667



LAB: (505) 325-1556

## ANALYTICAL REPORT

Date: 28-Jul-99

<b>Client:</b>	PNM - Public Service Company of NM	<b>Client Sample Info:</b>	Culpepper Martin 1E LF
<b>Work Order:</b>	9907033	<b>Client Sample ID:</b>	9907131003; 5pt. Comp
<b>Lab ID:</b>	9907033-02A	<b>Matrix:</b>	SOIL
<b>Project:</b>	PNM Pit Remediation Landfarms	<b>Collection Date:</b>	7/13/99 10:03:00 AM
		<b>COC Record:</b>	7733

Parameter	Result	PQL	Qual	Units	DF	Date Analyzed
<b>DIESEL RANGE ORGANICS</b>		<b>SW8015B</b>				Analyst: DC
T/R Hydrocarbons: C10-C28	25	25		mg/Kg	1	7/26/99

**Qualifiers:**

- PQL - Practical Quantitation Limit
- ND - Not Detected at Practical Quantitation Limit
- J - Analyte detected below Practical Quantitation Limit
- B - Analyte detected in the associated Method Blank

- S - Spike Recovery outside accepted recovery limits
- R - RPD outside accepted recovery limits
- E - Value above quantitation range
- Surr: - Surrogate

1 of 1

P.O. BOX 2606 • FARMINGTON, NM 87499

- TRAINING AND RESEARCH PROVIDED WITH THE GOVERNMENT -

Culpepper Martin #1E

Sec.-31 T-32N R-12W

Burlington

Landfarm #2 Drawing

Head Space - 5.7ppm

Sample # - 9908120845

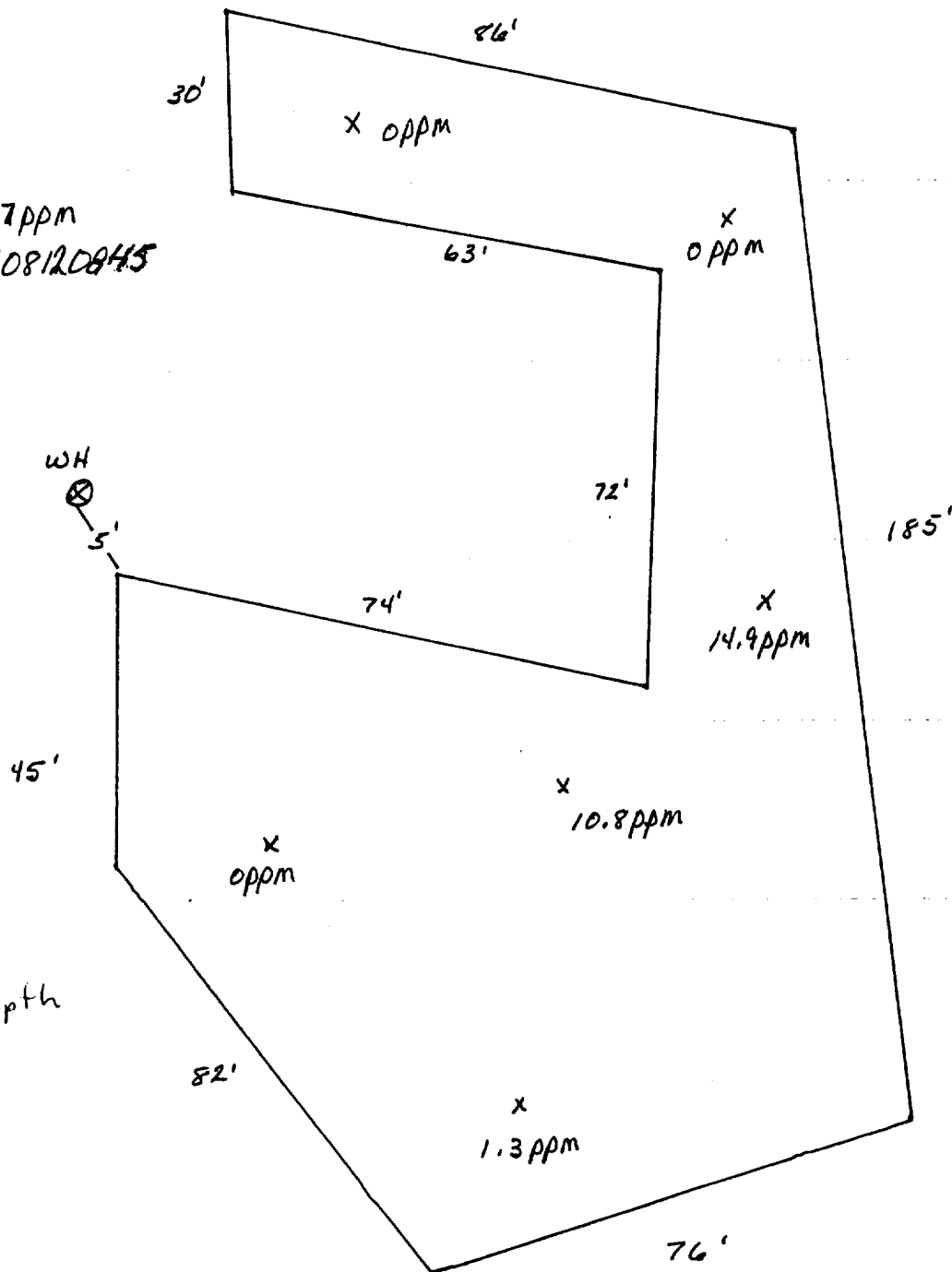

2" to 12" Depth

Not to Scale

OFF: (505) 325-5667



LAB: (505) 325-1556

**On Site Technologies, LTD.**

**Date:** 17-Aug-99

---

**CLIENT:** PNM - Public Service Company of NM  
**Project:** PNM Pit Remediation Landfarms  
**Lab Order:** 9908034

---

**CASE NARRATIVE**

Samples were analyzed using the methods outlined in the following references:

Test Methods for Evaluating Solid Waste, Physical/Chemical Methods, SW846, 3rd Edition

All method blanks, laboratory spikes, and/or matrix spikes met quality assurance objectives.

OFF: (505) 325-5667



LAB: (505) 325-1556

## ANALYTICAL REPORT

Date: 17-Aug-99

<b>Client:</b>	PNM - Public Service Company of NM	<b>Client Sample Info:</b>	Culpepper Martin 1E LF #2
<b>Work Order:</b>	9908034	<b>Client Sample ID:</b>	9908120845; 6pt Comp
<b>Lab ID:</b>	9908034-01A	<b>Matrix:</b>	SOIL
<b>Project:</b>	PNM Pit Remediation Landfarms	<b>Collection Date:</b>	08/12/1999 8:45:00 AM
		<b>COC Record:</b>	7653

Parameter	Result	PQL	Qual	Units	DF	Date Analyzed
<b>DIESEL RANGE ORGANICS</b>		<b>SW8015B</b>				Analyst: DC
T/R Hydrocarbons: C10-C28	ND	25		mg/Kg	1	08/13/1999

**Qualifiers:**

PQL - Practical Quantitation Limit

ND - Not Detected at Practical Quantitation Limit

J - Analyte detected below Practical Quantitation Limit

B - Analyte detected in the associated Method Blank

S - Spike Recovery outside accepted recovery limits

R - RPD outside accepted recovery limits

E - Value above quantitation range

Surr: - Surrogate

1 of 1

P.O. BOX 2606 • FARMINGTON, NM 87499

- TECHNOLOGY BLENDING INDUSTRY WITH THE ENVIRONMENT -