

30-045-25483

Form C-101
Revised 1-1-65

NEW MEXICO OIL CONSERVATION COMMISSION

NO. OF COPIES RECEIVED	
DISTRIBUTION	
SANTA FE	
FILE	
U.S.G.S.	
LAND OFFICE	
OPERATOR	

5A. Indicate Type of Lease	
STATE <input type="checkbox"/>	FEE <input checked="" type="checkbox"/>
5. State Oil & Gas Lease No.	

APPLICATION FOR PERMIT TO DRILL, DEEPEN, OR PLUG BACK

1a. Type of Work		7. Unit Agreement Name	
b. Type of Well OIL WELL <input type="checkbox"/> GAS WELL <input checked="" type="checkbox"/> OTHER <input type="checkbox"/>		8. Farm or Lease Name Moore	
2. Name of Operator SOUTHLAND ROYALTY COMPANY		9. Well No. 4	
3. Address of Operator P. O. Drawer 570, Farmington, New Mexico 87499		10. Field and Pool, or Wildcat Under Fruitland Ext. Blanco Pictured Cliffs	
4. Location of Well UNIT LETTER <u>N</u> LOCATED <u>1070</u> FEET FROM THE <u>South</u> LINE AND <u>1530</u> FEET FROM THE <u>West</u> LINE OF SEC. <u>25</u> TWP. <u>32N</u> RGE. <u>12W</u> NMPM		11. County San Juan	
19. Proposed Depth 3200'		20. Rotary or C.T. Rotary	
21. Elevations (Show whether DF, RT, etc.) 6443' GL		22. Approx. Date Work will start October 31, 1982	

PROPOSED CASING AND CEMENT PROGRAM

SIZE OF HOLE	SIZE OF CASING	WEIGHT PER FOOT	SETTING DEPTH	SACKS OF CEMENT	EST. TOP
12-1/4"	9-5/8"	32.30#, K-55	200'	130 cu. ft.	to surface
7-7/8"	2-7/8"	6.5 #, J-55	3000'	260 cu. ft.	
7-7/8"	2-7/8"	6.5 #, J-55	3200'	644 cu. ft.	

Surface formation is Nacimiento.

Top of Ojo Alamo sand is at 812'.

Top of Pictured Cliffs sand is at 2971'.

Fresh water mud will be used to drill from surface to Total Depth.

It is anticipated that and IEL will be run from Total Depth to surface casing and

GR-CNLFDC be run from Total Depth to 1000'.

No abnormal pressures or poisonous gases are anticipated in this well.

It is expected that this well will be drilled before December 31, 1982.

This depends on time required for approvals, rig availability and the weather.

Gas is dedicated.

APPROVAL VALID
FOR 90 DAYS UNLESS
DRILLING COMMENCED,

EXPIRES 7-19-83

IN ABOVE SPACE DESCRIBE PROPOSED PROGRAM: IF PROPOSAL IS TO DEEPEN OR PLUG BACK, GIVE DATA ON PRESENT PRODUCTIVE ZONE AND PROPOSED NEW PRODUCTIVE ZONE. GIVE BLOWOUT PREVENTER PROGRAM, IF ANY.

I hereby certify that the information above is true and complete to the best of my knowledge and belief.

Signed Frank T. Chavez Title District Engineer Date October 13, 1982

(This space for State Use)

Original Signed by FRANK T. CHAVEZ

SUPERVISOR DISTRICT # 3

APPROVED BY _____ TITLE _____ DATE OCT 19 1982

CONDITIONS OF APPROVAL, IF ANY:

All distances must be from the outer boundaries of the Section.

Operator SOUTHLAND ROYALTY COMPANY			Lease MOORE		Well No. 4
Unit Letter N	Section 25	Township 32N	Range 12W	County San Juan	
Actual Footage Location of Well: 1070 feet from the South line and 1530 feet from the West line					
Ground Level Elev. 6443	Producing Formation Fruitland/Pictured Cliffs		Pool Glades Ext. Undesignated/Blanco		Dedicated Acreage: 160 Acres

1. Outline the acreage dedicated to the subject well by colored pencil or hachure marks on the plat below.
2. If more than one lease is dedicated to the well, outline each and identify the ownership thereof (both as to working interest and royalty).
3. If more than one lease of different ownership is dedicated to the well, have the interests of all owners been consolidated by communitization, unitization, force-pooling, etc?

☐ Yes ☐ No If answer is "yes," type of consolidation communitization

If answer is "no," list the owners and tract descriptions which have actually been consolidated. (Use reverse side of this form if necessary.)

No allowable will be assigned to the well until all interests have been consolidated (by communitization, unitization, forced-pooling, or otherwise) or until a non-standard unit, eliminating such interests, has been approved by the Commission.

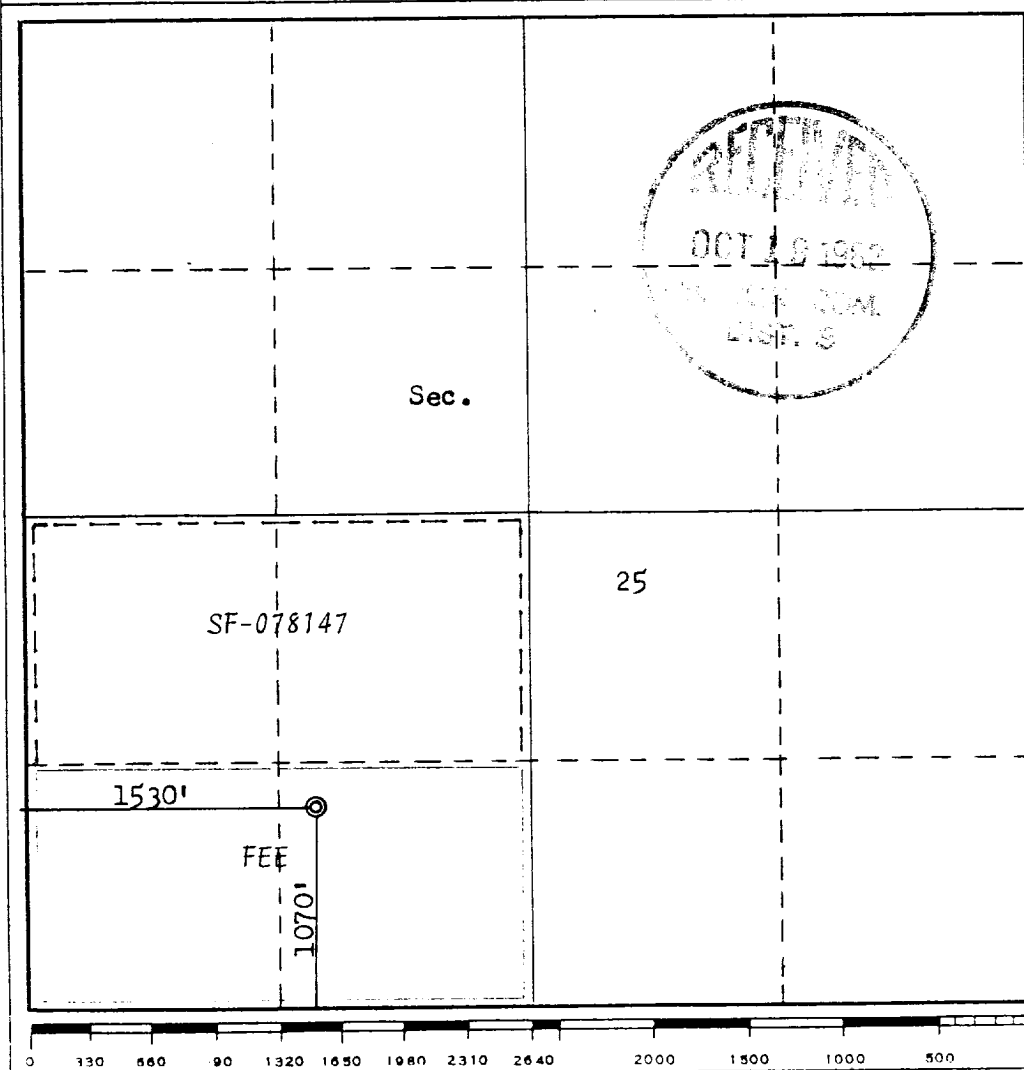

CERTIFICATION

I hereby certify that the information contained herein is true and complete to the best of my knowledge and belief.

R. E. Fielder
Name

R. E. Fielder
Position

District Engineer
Company

Southland Royalty Company
Date

October 13, 1982

I hereby certify that the well location shown on this plat was plotted from field notes of actual surveys made by me or under my supervision, and that the same is true and correct to the best of my knowledge and belief.

Date Surveyed

August 20, 1982
Registered Professional Engineer
and/or Land Surveyor

Fred B. Kerr Jr.
Certificate No.

3950

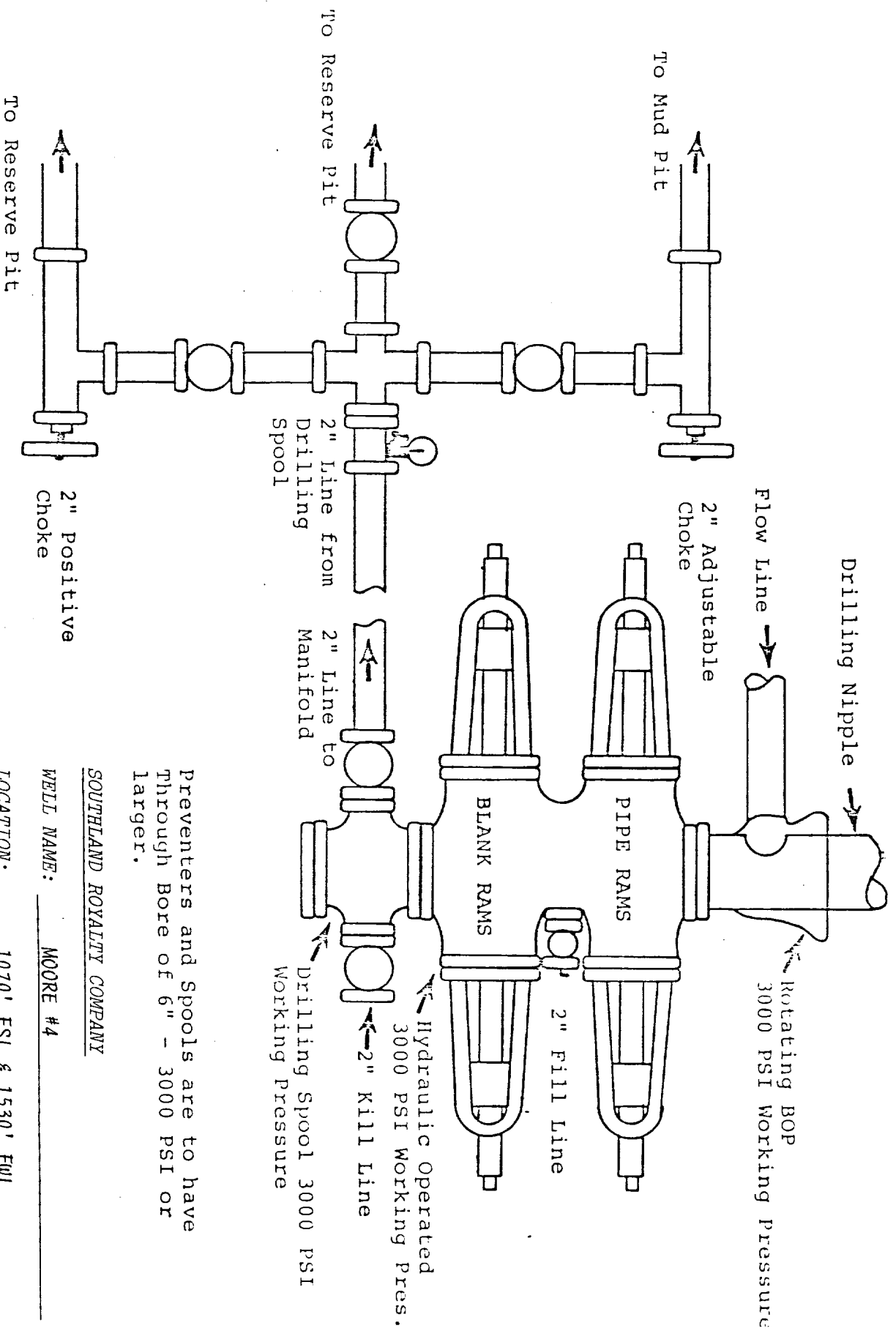

Preventers and Spools are to have
Through Bore of 6" - 3000 PSI or
larger.

SOUTHLAND ROYALTY COMPANY

WELL NAME: MOORE #4

LOCATION: 1070' FSL & 1530' FWL

Section 25, T32N, R12W

COUNTY: San Juan

STATE: New Mexico

