

District I
P.O. Box 1980, Hobbs, NM

District II
P.O. Drawer DD, Artesia, NM 88221

District III
1000 Rio Brazos Rd, Aztec, NM 87410

State of New Mexico
Energy, Minerals and Natural Resources Department

OIL CONSERVATION DIVISION

2040 South Pacheco Street
Santa Fe, New Mexico 87505

SUBMIT 1 COPY TO
APPROPRIATE
DISTRICT OFFICE
AND 1 COPY TO
SANTA FE OFFICE

OK

PIT REMEDIATION AND CLOSURE REPORT

Operator: <u>PNM Gas Services (Energen)</u>		Telephone: <u>324-3764</u>	
Address: <u>603 W. Elm Street Farmington, NM 87401</u>			
Facility or Well Name: <u>Wright State Com #1E South Pit</u>			
Location:	Unit <u>I</u>	Sec <u>36</u>	T <u>32 N</u> R <u>13 W</u> County <u>San Juan</u>
Pit Type:	Separator <input type="checkbox"/>	Dehydrator <input checked="" type="checkbox"/>	Other <u> </u>
Land Type:	BLM <input type="checkbox"/>	State <input type="checkbox"/>	Fee <input checked="" type="checkbox"/> Other <u> </u>
Pit Location:	Pit dimensions: length <u>18</u> ' width <u>18</u> ' depth <u>3</u> '		
(Attach diagram)	Reference:	wellhead <input checked="" type="checkbox"/>	other <u> </u>
	Footage from reference: <u>81</u> ' <u> </u>		
	Direction from reference:	<u>50</u> Degrees <input checked="" type="checkbox"/> East	North <input checked="" type="checkbox"/>
		<input type="checkbox"/> West	South <input type="checkbox"/>
Depth to Ground Water:		Less than 50 feet (20 points)	
(Vertical distance from contaminants to seasonal high water elevation of ground water)		50 feet to 99 feet (10 points)	
		Greater than 100 feet (0 points)	<u>0</u>
Wellhead Protection Area:		Yes (20 points)	
(Less than 200 feet from a private domestic water source, or, less than 1,000 feet from all other water sources)		No (0 points)	<u>0</u>
Distance to Surface Water:		Less than 200 feet (20 points)	
(Horizontal distance to perennial lakes, ponds, rivers, streams, creeks, irrigation canals and ditches)		200 feet to 1,000 feet (10 points)	
		Greater than 1,000 feet (0 points)	<u>10</u>
RANKING SCORE (TOTAL POINTS) :			<u>10</u>

Wright State Com #1E South Pit

Date Remediation Started: 04/22/1999

Date Completed: 04/27/1999

Remediation Method: Excavation ☒

Approx. Cubic Yard 1334

(Check all appropriate sections)

Landfarmed ☒

Amount Landfarmed (cubic yds) 1254

Other 80 cu yds clean overburden.

Remediation Location:

Onsite ☒

Offsite

(i.e., landfarmed onsite, name and location of offsite facility)

Backfill Material Location:

General Description of Remedial Action:

Excavated contaminated soil to a pit size of 65.5' X 27.5' X 20' and landfarmed soil onsite within a bermed area at a depth of 6" to 12". Soil was aerated by disking/plowing until soil met regulatory levels.

Ground Water Encountered:

No



Yes



Depth

Final Pit Closure Sampling:

Sample Location 5 pt composite-bottom

(if multiple samples, attach sample result and diagram of sample locations and depths.)

Sample depth 20'

Sample date 04/27/1999

Sample time 10:00:00 AM

Sample Results

Benzene (ppm) < 0.05

Total BTEX (ppm) 3.73

Field headspace (ppm)

TPH (ppm) 180.00

Method 8015B

Vertical Extent (ft)

Risk Analysis form attached Yes



No



Ground Water Sample:

Yes



No



(If yes, see attached Groundwater Site Summary Report)

I HEREBY CERTIFY THAT THE INFORMATION ABOVE IS TRUE AND COMPLETE TO THE BEST OF MY KNOWLEDGE AND MY BELIEF

DATE January 24, 2000

SIGNATURE

Maureen Gannon

PRINTED NAME Maureen Gannon
AND TITLE Project Manager

Wright State Com #1E south pit

(C) 36-32N-13W
ENWYAN
4-22-99

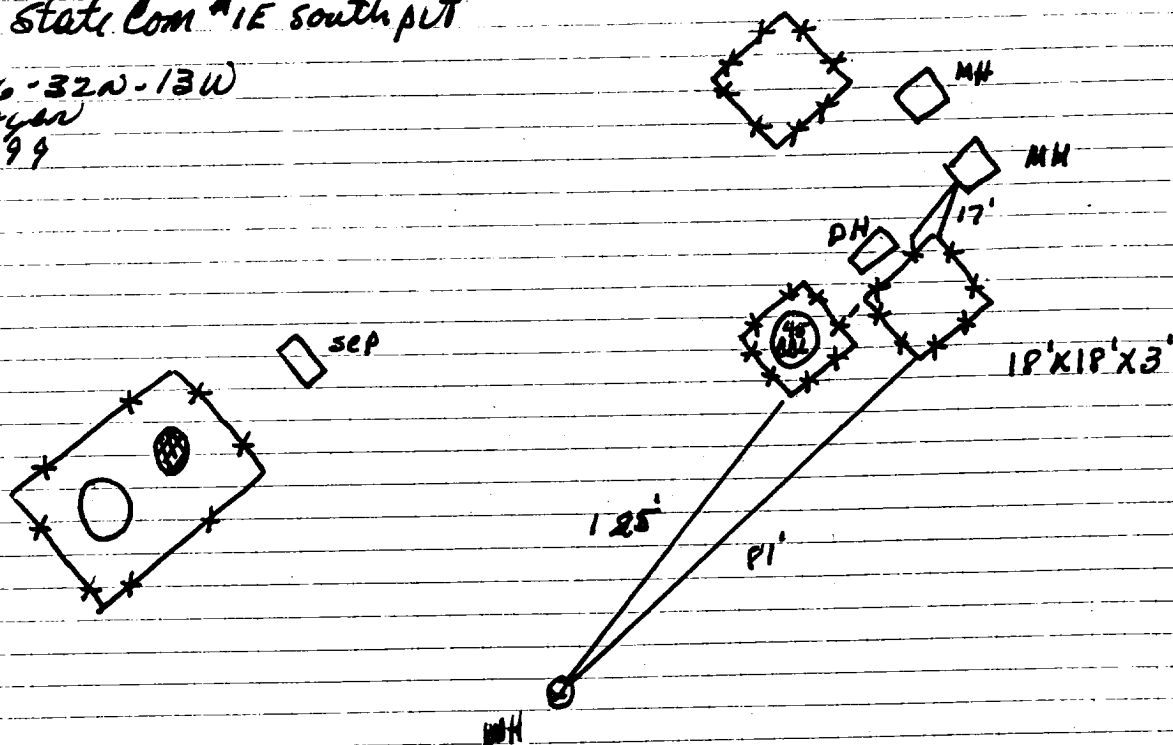

Excavation Sampling

PTD readings

5' - 2994 ppm

10' - 2414 ppm

15' - 2167 ppm

20' - 2003 ppm

west wall head space
at 20' - 0 ppm

north wall head space
at 20' - 30 ppm

east wall head space
at 20' - 21.0 ppm

5 point bottom composite head space
at 20' - 913 ppm

south wall head space
at 20' - 0 ppm

not to scale

OFF: (505) 325-5667



LAB: (505) 325-1556

On Site Technologies, LTD.

Date: 07-May-99

CLIENT: PNM - Public Service Company of NM
Project: PNM Pit Remediation
Lab Order: 9904057

CASE NARRATIVE

Samples were analyzed using the methods outlined in the following references:

Test Methods for Evaluating Solid Waste, Physical/Chemical Methods, SW846, 3rd Edition

All method blanks, laboratory spikes, and/or matrix spikes met quality assurance objectives.

RH

OFF: (505) 325-5667



LAB: (505) 325-1556

ANALYTICAL REPORT

Date: 07-May-99

Client:	PNM - Public Service Company of NM	Client Sample Info:	Wright State Com #1E S. Pit
Work Order:	9904057	Client Sample ID:	9904271000; 5pt. Bottom Comp
Lab ID:	9904057-01A	Matrix:	SOIL
Project:	PNM Pit Remediation	Collection Date:	4/27/99 10:00:00 AM
		COC Record:	5793

Parameter	Result	PQL	Qual	Units	DF	Date Analyzed
DIESEL RANGE ORGANICS		SW8015B				Analyst: DC
T/R Hydrocarbons: C10-C28	180	25		mg/Kg	1	5/6/99
AROMATIC VOLATILES BY GC/PID		SW8021B				Analyst: DC
Benzene	ND	50		µg/Kg	50	4/29/99
Toluene	170	100		µg/Kg	50	4/29/99
Ethylbenzene	60	50		µg/Kg	50	4/29/99
m,p-Xylene	2400	100		µg/Kg	50	4/29/99
o-Xylene	1100	50		µg/Kg	50	4/29/99

3730
3.730 ppm

Qualifiers:

PQL - Practical Quantitation Limit

ND - Not Detected at Practical Quantitation Limit

J - Analyte detected below Practical Quantitation Limit

B - Analyte detected in the associated Method Blank

S - Spike Recovery outside accepted recovery limits

R - RPD outside accepted recovery limits

E - Value above quantitation range

Surr: - Surrogate

P.O. BOX 2606 • FARMINGTON, NM 87499

- TECHNICAL SERVICES SERVING INDUSTRY WITH THE ENVIRONMENT -

OFF: (505) 325-5667



LAB: (505) 325-1556

ANALYTICAL REPORT

Date: 07-May-99

Client:	PNM - Public Service Company of NM	Client Sample Info:	Wright State Com #1E S. Pit
Work Order:	9904057	Client Sample ID:	9904271010; 4 Wall Comp
Lab ID:	9904057-02A	Matrix:	SOIL
Project:	PNM Pit Remediation	Collection Date:	4/27/99 10:10:00 AM
		COC Record:	5793

Parameter	Result	PQL	Qual	Units	DF	Date Analyzed
DIESEL RANGE ORGANICS		SW8015B				Analyst: DC
T/R Hydrocarbons: C10-C28	ND	25		mg/Kg	1	4/30/99

Qualifiers:

PQL - Practical Quantitation Limit

S - Spike Recovery outside accepted recovery limits

ND - Not Detected at Practical Quantitation Limit

R - RPD outside accepted recovery limits

J - Analyte detected below Practical Quantitation Limit

E - Value above quantitation range

B - Analyte detected in the associated Method Blank

Surr: - Surrogate

1 of 1

P.O. BOX 2606 • FARMINGTON, NM 87499

- TECHNOLOGY SERVING INDUSTRY WITH THE ENVIRONMENT -

Wright State Com 1E
Sec 36 T-32N R-13W 4C0
Emergen

Landfarm Drawing

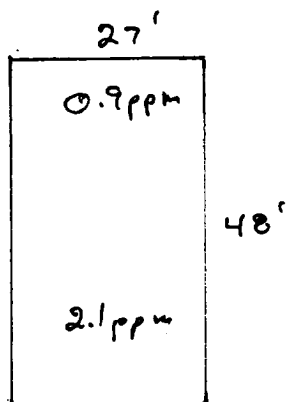

App 1254 cu yds

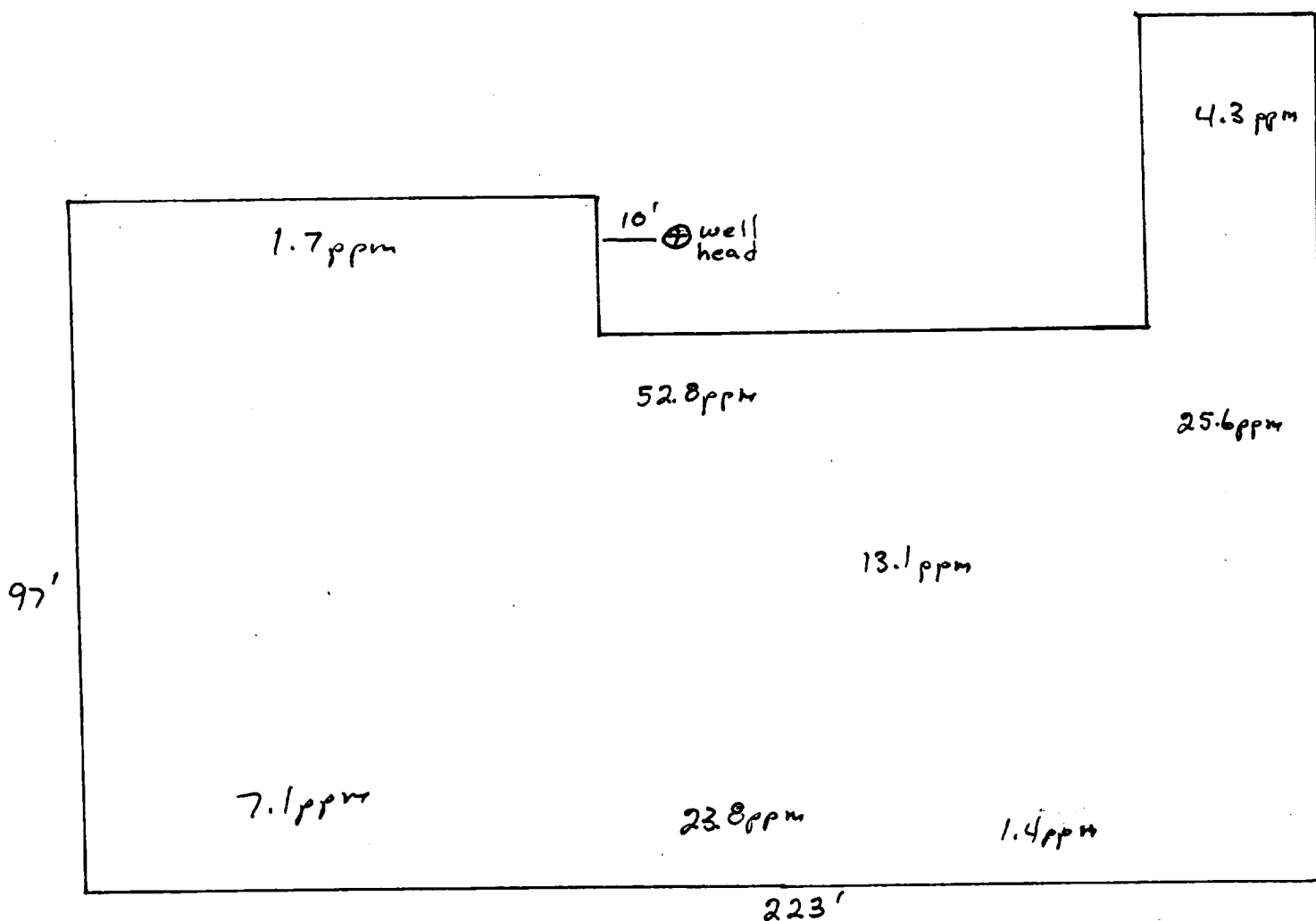

2" to 12" Depth
Headspace 386 ppm
Sample # 990713/248

OFF: (505) 325-5667



LAB: (505) 325-1556

On Site Technologies, LTD.

Date: 21-Jul-99

CLIENT: PNM - Public Service Company of NM
Project: PNM Pit Remediation Landfarms
Lab Order: 9907034

CASE NARRATIVE

Samples were analyzed using the methods outlined in the following references:

Test Methods for Evaluating Solid Waste, Physical/Chemical Methods, SW846, 3rd Edition

All method blanks, laboratory spikes, and/or matrix spikes met quality assurance objectives.

OFF: (505) 325-5667



LAB: (505) 325-1556

Date: 21-Jul-99

ANALYTICAL REPORT

Client:	PNM - Public Service Company of NM	Client Sample Info:	Wright State Com #1E LF
Work Order:	9907034	Client Sample ID:	9907131248; 10pt. Comp
Lab ID:	9907034-01A	Matrix:	SOIL
Project:	PNM Pit Remediation Landfarms	Collection Date:	7/13/99 12:48:00 PM
		COC Record:	7734

Parameter	Result	PQL	Qual	Units	DF	Date Analyzed
DIESEL RANGE ORGANICS		SW8015B				Analyst: DC
T/R Hydrocarbons: C10-C28	41	25		mg/Kg	1	7/14/99

Qualifiers:

PQL - Practical Quantitation Limit

ND - Not Detected at Practical Quantitation Limit

J - Analyte detected below Practical Quantitation Limit

B - Analyte detected in the associated Method Blank

S - Spike Recovery outside accepted recovery limits

R - RPD outside accepted recovery limits

E - Value above quantitation range

Surr: - Surrogate

1 of 1

P.O. BOX 2606 • FARMINGTON, NM 87499

- TECHNOLOGY SERVING INDUSTRY WITH THE ENVIRONMENT -