

UNITED STATES  
DEPARTMENT OF THE INTERIOR  
BUREAU OF LAND MANAGEMENT

30-045-28240

APPLICATION FOR PERMIT TO DRILL, DEEPEN, OR PLUG BACK

6. LEASE DESIGNATION AND SERIAL NO.

SE-078147

7. IF INDIAN, ALLOTTEE OR TRIBE NAME

7. UNIT AGREEMENT NAME

8. FARM OR LEASE NAME

Moore "D"

9. WELL NO.

#7

10. FIELD AND POOL, OR WILDCAT

Basin Fruitland Coal Gas

11. SEC., T., R., M., OR R.L.M.  
AND SURVEY OR AREA

Sec. 24, T32N R12W

12. COUNTY OR PARISH 13. STATE

San Juan

NM

17. NO. OF ACRES ASSIGNED  
TO THIS WELL.  
320 acres W/2

20. ROTARY OR CABLE TOOL  
Rotary

22. APPROX. DATE WORK WILL START\*

As soon as permitted

PROPOSED CASING AND CEMENTING PROGRAM

DRILLING OPERATIONS AUTHORIZED ARE  
SUBJECT TO COMPLIANCE WITH ATTACHED  
"GENERAL REQUIREMENTS"

QUANTITY OF CEMENT  
250 cf (cement to surface)  
927 cf (cement to surface)

1a. TYPE OF WORK  
DRILL ☒ DEEPEN ☐ PLUG BACK ☐  
b. TYPE OF WELL  
OIL WELL ☐ GAS WELL ☒ OTHER Coal Seam SINGLE ZONE ☒ MULTIPLE ZONE ☐  
2. NAME OF OPERATOR  
Amoco Production Company ATTN: J. L. Hampton  
3. ADDRESS OF OPERATOR  
P. O. Box 800 Denver, Colorado 80201  
4. LOCATION OF WELL (Report location clearly and in accordance with any State requirements.)\*  
At surface  
1090 FSL, 1680 FWL, SE/SW  
At proposed prod. zone  
Same  
14. DISTANCE IN MILES AND DIRECTION FROM NEAREST TOWN OR POST OFFICE\*  
12 miles - Artec, NM  
15. DISTANCE FROM PROPOSED\*  
LOCATION TO NEAREST  
PROPERTY OR LEASE LINE, FT.  
(Also to nearest dept. unit line, if any)  
1090'  
16. NO. OF ACRES IN LEASE  
2,240.00  
17. PROPOSED DEPTH  
3309' TD  
18. DISTANCE FROM PROPOSED LOCATION\*  
TO NEAREST WELL, DRILLING, COMPLETED,  
OR APPLIED FOR, ON THIS LEASE, FT.  
21. ELEVATIONS (Show whether DF, RT, GR, etc.)  
6547' GR

SIZE OF HOLE	SIZE OF CASING	WEIGHT PER FOOT	SETTING DEPTH
12 1/4"	8 5/8"	24#	250'
7 7/8"	5 1/2"	17#	3309' (TD)

Notice of Staking was submitted: 6/28/90

Lease Description:

T32N-R12W:

Sec. 13: N/2 SW/4, SE/4 SW/4, SE/4  
Sec. 23: NW/4 NE/4, S/2 N/2, NE/4 SW/4, N/2 SE/4, SE/4 SE/4  
Sec. 24: W/2 E/2, W/2  
Sec. 25: W/2 NE/4, NW/4, N/2 W/4  
Sec. 26: S/2 NE/4, W/2, N/2 SE/4  
Sec. 27: E/2

IN ABOVE SPACE DESCRIBE PROPOSED PROGRAM: If proposal is to deepen or plug back, give data on present productive zone and proposed new productive zone. If proposal is to drill or deepen directionally, give pertinent data on subsurface locations and measured and true vertical depths. Give blowout preventer program, if any.

24. J.L. Hampton  
SIGNED J.L. Hampton/ICB TITLE Sr. Staff Admin. Supv. DATE 7/9/90  
(This space for Federal or State office use)

PERMIT NO. \_\_\_\_\_ APPROVAL DATE \_\_\_\_\_  
APPROVED BY \_\_\_\_\_ TITLE \_\_\_\_\_  
CONDITIONS OF APPROVAL, IF ANY: \_\_\_\_\_

APPROVED  
AS AMENDED

SEP 06 1990

NMOCD

\*See Instructions On Reverse Side

AREA MANAGER

Submit to Appropriate  
District Office  
State Lease - 4 copies  
Fee Lease - 3 copies

State of New Mexico  
Energy, Minerals and Natural Resources Department

Form C-102  
Revised 1-1-89

OIL CONSERVATION DIVISION

DISTRICT I  
P.O. Box 1980, Hobbs, NM 88240

P.O. Box 2088

Santa Fe, New Mexico 87504-2088

DISTRICT II  
P.O. Drawer DD, Artesia, NM 88210

DISTRICT III  
1000 Rio Brazos Rd., Aztec, NM 87410

WELL LOCATION AND ACREAGE DEDICATION PLAT

All Distances must be from the outer boundaries of the section

Operator <b>AMOCO PRODUCTION COMPANY</b>			Lease <b>MOORE /D/</b>		Well No. <b># 7</b>
Unit Letter <b>N</b>	Section <b>24</b>	Township <b>32 NORTH</b>	Range <b>12 WEST</b>	County <b>SAN JUAN</b>	

Actual Footage Location of Well:

1090 feet from the		SOUTH line and		1680 feet from the		WEST line	
Ground level Elev. <b>6547</b>	Producing Formation <b>Fruitland Coal</b>		Pool <b>Basin Fruitland Coal Gas</b>		Dedicated Acreage: <b>W/2 320 Acres</b>		

1. Outline the acreage dedicated to the subject well by colored pencil or hatchure marks on the plat below.
2. If more than one lease is dedicated to the well, outline each and identify the ownership thereof (both as to working interest and royalty).
3. If more than one lease of different ownership is dedicated to the well, have the interest of all owners been consolidated by communization, unitization, force-pooling, etc.?  
☐ Yes ☐ No If answer is "yes" type of consolidation \_\_\_\_\_  
If answer is "no" list the owners and tract descriptions which have actually been consolidated. (Use reverse side of this form if necessary).  
No allowable will be assigned to the well until all interests have been consolidated (by communization, unitization, forced-pooling, or otherwise) or until a non-standard unit, eliminating such interest, has been approved by the Division.

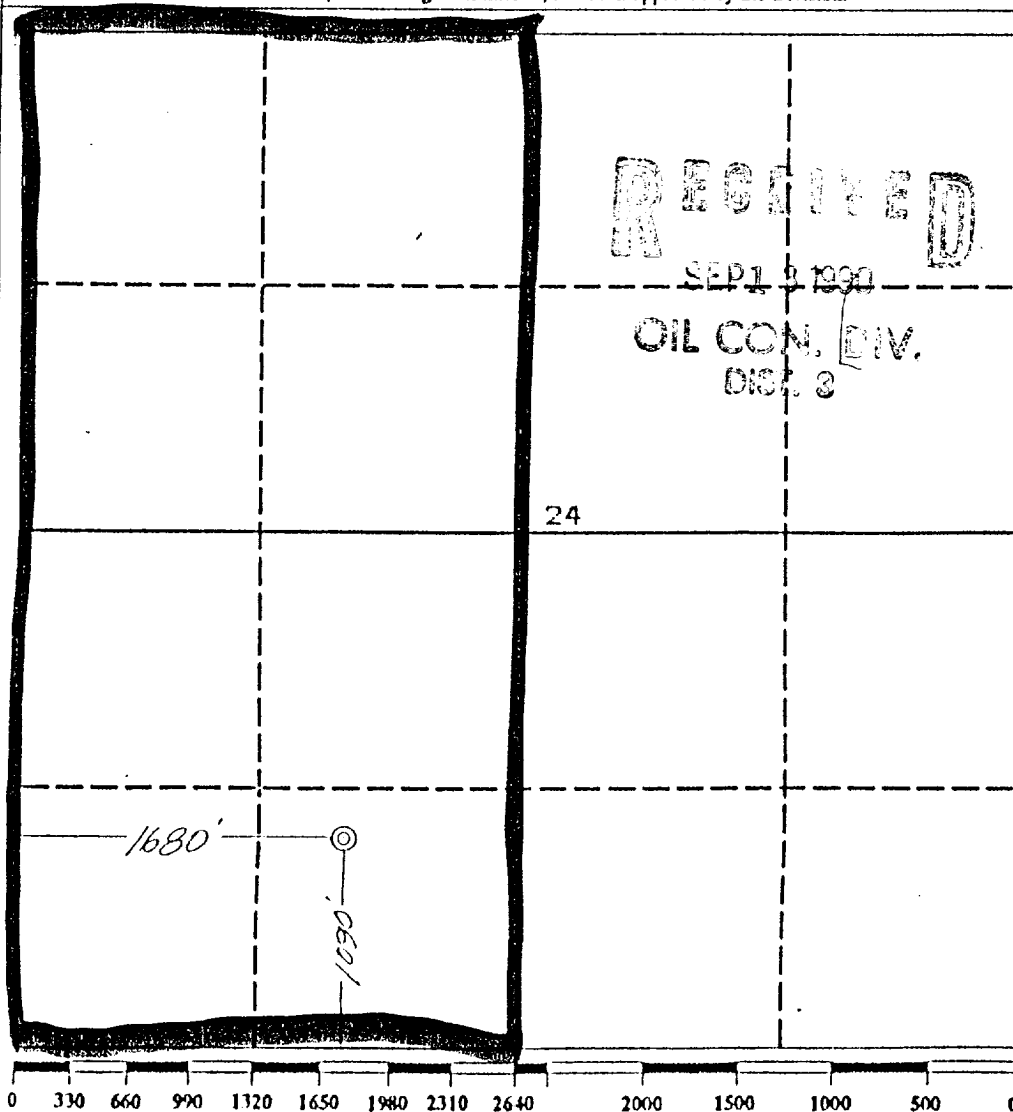

OPERATOR CERTIFICATION

I hereby certify that the information contained herein is true and complete to the best of my knowledge and belief.

Signature **G. L. Hampton/CUB**  
Printed Name **J. L. Hampton**  
Position **Sr Staff Admin Supr**  
Company **Amoco Prod**  
Date **6-15-90**

SURVEYOR CERTIFICATION

I hereby certify that the well location shown on this plat was plotted from field notes of actual surveys made by me or under my supervision, and that the same is true and correct to the best of my knowledge and belief.

Date Surveyed  
**June 6, 1990**

Signature & Seal of  
Professional Surveyor  
**GARY D. VANN**  
**7016**  
Gary  
Certification  
**7016**  
REGISTERED PROFESSIONAL LAND SURVEYOR

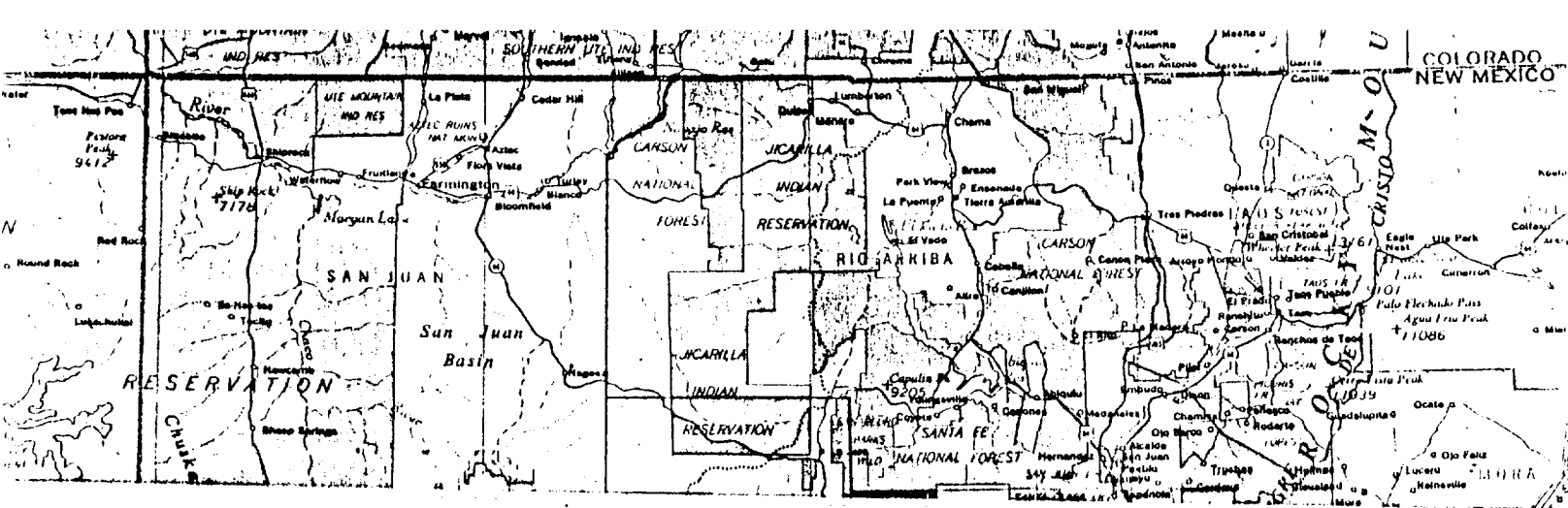

MOORE /D/ # 7  
 1090' F/SL 1680' F/WL  
 SEC. 24, T32N, R12W, NMPM  
 RAIL POINT: 155 miles - Montrose, Co.  
 MUD POINT: 12 miles - Aztec, NM  
 CEMENT POINT: 26 miles - Farmington, NM

