

UNITED STATES
DEPARTMENT OF THE INTERIOR
BUREAU OF LAND MANAGEMENT

36-45-2890

APPLICATION FOR PERMIT TO DRILL, DEEPEN, OR PLUG BACK

1a. TYPE OF WORK

DRILL ☒

DEEPEN ☐

PLUG BACK ☐

b. TYPE OF WELL

OIL
WELL ☐

GAS
WELL ☒

OTHER

SINGLE
ZONE ☒

MULTIPLE
ZONE ☐

2. NAME OF OPERATOR

Emerald Gas Operating Co.

3. ADDRESS OF OPERATOR

570 Turner Drive, Unit B, Durango, CO 81301

4. LOCATION OF WELL (Report location clearly and in accordance with any State requirements.)*

At surface

1837' FNL & 893' FEL

At proposed prod. zone

Same

14. DISTANCE IN MILES AND DIRECTION FROM NEAREST TOWN OR POST OFFICE*

Approximately 12 Miles Northeast of La Plata, NM

15. DISTANCE FROM PROPOSED*

LOCATION TO NEAREST
PROPERTY OR LEASE LINE, FT.
(Also to nearest drlg. unit line, if any)

792'

16. NO. OF ACRES IN LEASE

320

17. NO. OF ACRES ASSIGNED
TO THIS WELL

1/320

18. DISTANCE FROM PROPOSED LOCATION*
TO NEAREST WELL, DRILLING, COMPLETED,
OR APPLIED FOR, ON THIS LEASE, FT.

207'

19. PROPOSED DEPTH

2880'

20. ROTARY OR CABLE TOOLS

Rotary

21. ELEVATIONS (Show whether DF, RT, GR, etc.)

GL: 6468'

22. APPROX. DATE WORK WILL START*

December 11, 1992

23. PROPOSED CASING AND CEMENTING PROGRAM

SIZE OF HOLE	SIZE OF CASING	WEIGHT PER FOOT	SETTING DEPTH	QUANTITY OF CEMENT
12 1/4"	9 5/8"	32.0 - J55	300'	230 sx (Class 'B')
8 3/4"	7"	23.0 - K55	2685'	395 sx (195 sx lead, 200 sx tail)
Cavity	N/A	N/A	2685'-2880'	

Operator proposes to drill the well and complete open hole to test the gas potential of the Fruitland Formation coal seams. The following are attached:

- Exhibit A: Surveyor's Location and Elevation Plat.
- Exhibit B: Drilling Program
- Exhibit C-1, 2 and 3: Blowout Preventer Schematic
- Exhibit D: Surface Use Program
- Exhibit E-1 and 2: Vicinity Map and Existing/Acesss Road Map
- Exhibit F: Radius Map of Field, Showing Existing Wells
- Exhibit G: Drill Pad Layout with Cut/Fill Diagram
- Exhibit H-1 and 2: Drilling Rig Layout and Layout of Anticipated Production Facilities.
- Exhibit I: Surface Damage Agreement

IN ABOVE SPACE DESCRIBE PROPOSED PROGRAM: If proposal is to deepen or plug back, give data on present productive zone and proposed new productive zone. If proposal is to drill or deepen directionally, give pertinent data on subsurface locations and measured and true vertical depths. Give blowout preventer program, if any.

24.

SIGNED

Bradford C. Boyce

TITLE Manager Development/Geology DATE December 2, 1992

(This space for Federal or State office use)

PERMIT NO.

RECEIVED

APPROVAL DATE

APPROVED
AS AMENDED

APPROVED BY

DEC 15 1992

TITLE

DATE

CONDITIONS OF APPROVAL, IF ANY

OIL CON. DIV.
DIST. 3

*See Instructions On Reverse Side

DEC 11 1992
AREA MANAGER

EXHIBIT "A":
SURVEYOR'S LOCATION & DEDICATION PLAT

All Distances must be from the outer boundaries of the section

Actual Footage Location of Well:			
1837	feet from the	North	line and
		893	feet from the
			East
			line
Ground level Elev.	Producing Formation	Pool	Dedicated Acreage:
6468	Fruitland Coals	Basin Fruitland Coal	320 Acres

- No allowable will be assigned to the well until all interests have been consolidated (by communitization, unitization, forced-pooling, or otherwise) or until a non-standard unit, eliminating such interest, has been approved by the Division.

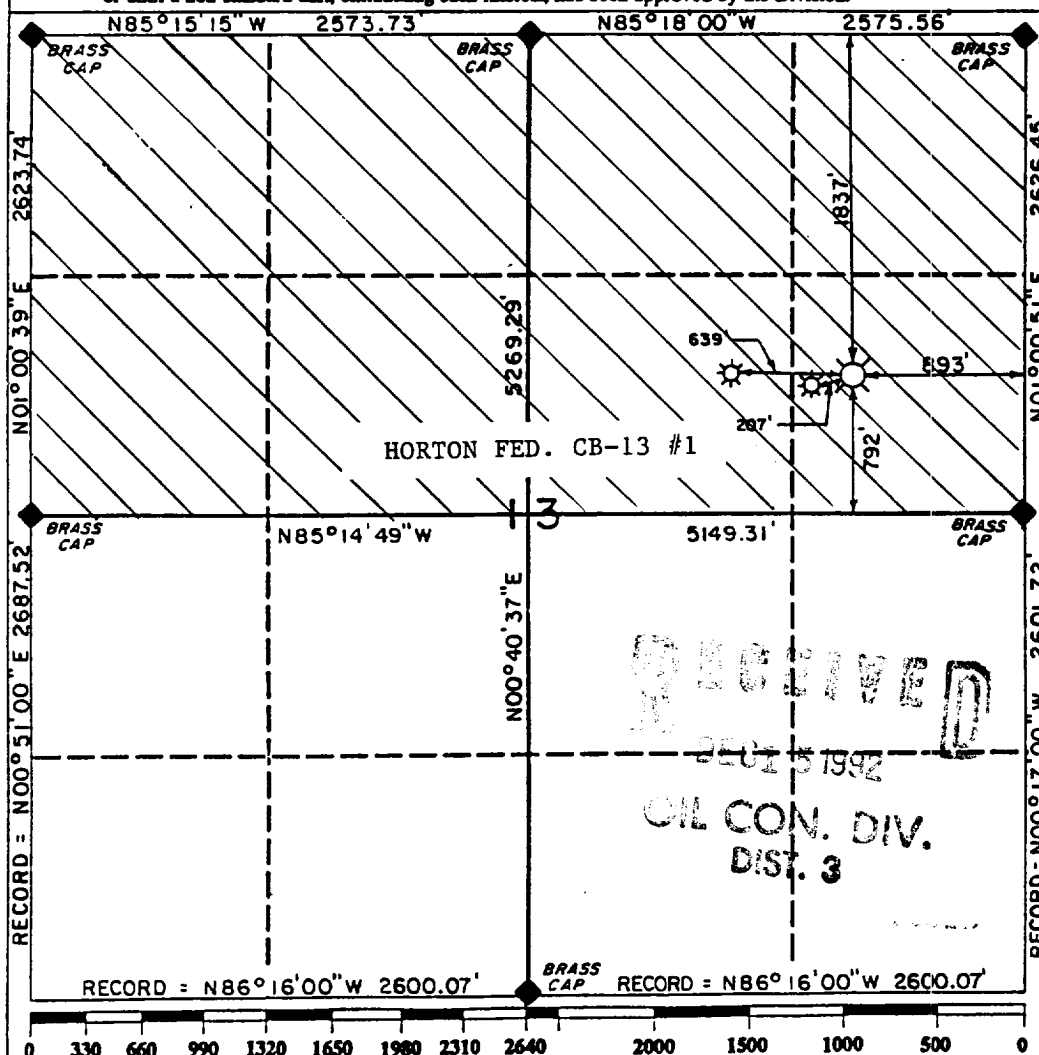

Certificate No
6703

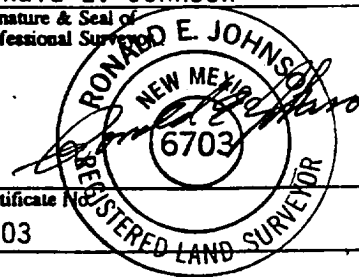

EMERALD GAS OPERATING COMPANY
EXHIBIT "E-2": EXISTING ROAD AND ACCESS MAP

Horton Federal CB-13 #1
SENE, Section 13, T32N-R12W

